

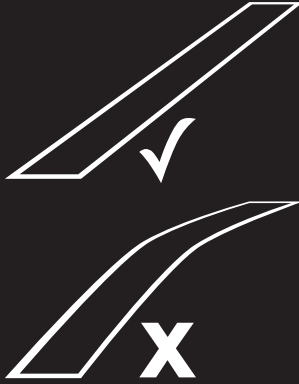

IMPORTANT!

Flatten before installation.



You will need

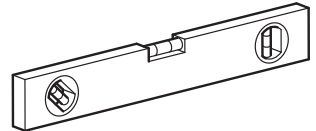
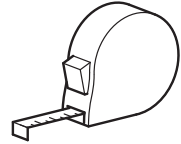
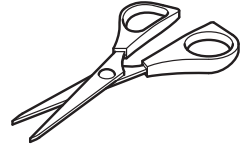
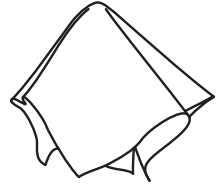

IMPORTANT!

Wall must be clean and dry
before installation.



Video Guide



vimeo.com/462633266



+44 (0) 333 320 0463 (UK)
1-800 667 0808 (USA)

Parts Included

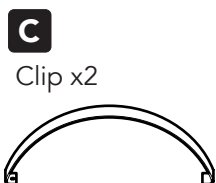
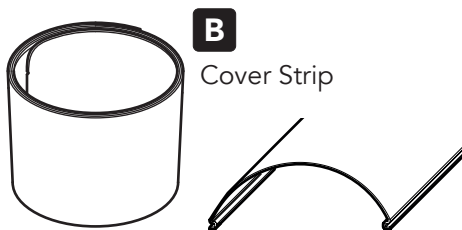

Ensure strips A and B are flat before installing

To Flatten:

Unroll both strips, then roll back up in the opposite direction and place back in the packaging. Leave for at least 30 minutes.

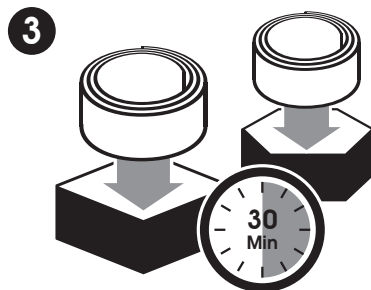
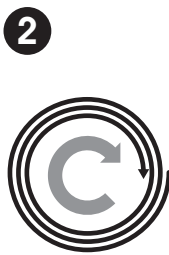
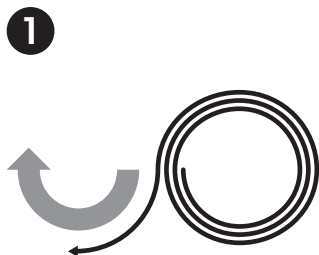

TIP

To avoid creasing, first roll a wider loop, then tighten to fit inside box.



For adhesive to be effective ensure wall is clean and dry

Clean the wall thoroughly using the wipes **D** provided.

Make sure the wall is dry before installation.

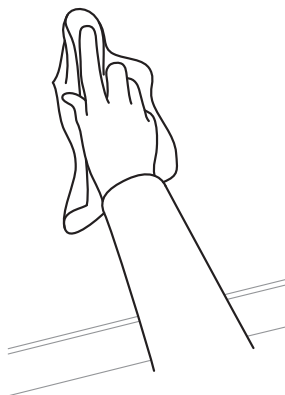
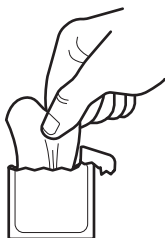

1

Measure and cut strips **A** and **B** to fit your required space.

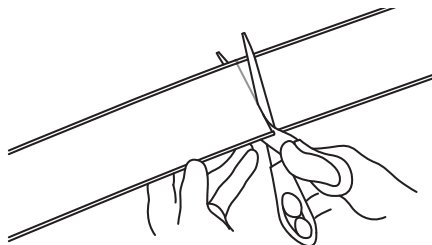
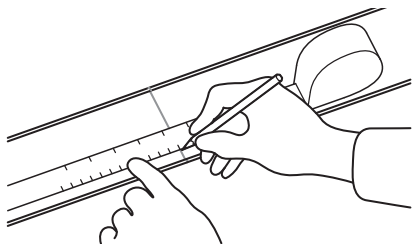

Remove backing paper from adhesive strips on Wall Strip **A**.

Use a spirit level as a guide and apply Wall Strip **A** to the wall.

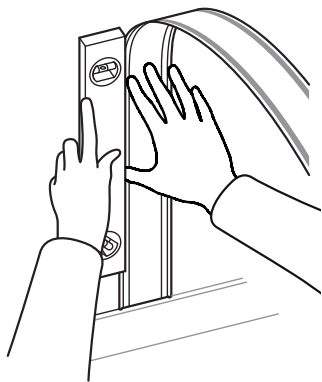

Use a clean, dry cloth to firmly press and rub along the channels.

This will help create a strong bond with your wall.

Repeat after 5 minutes.

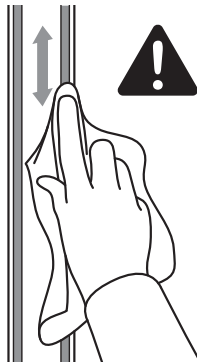

2

With cables in place, hook one side of Cover Strip **B** into Wall Strip **A**.

Working from the top, squeeze Cover Strip **B** until the other side hooks into place, then slide thumb downwards until the rest of Cover Strip **B** is hooked into place.

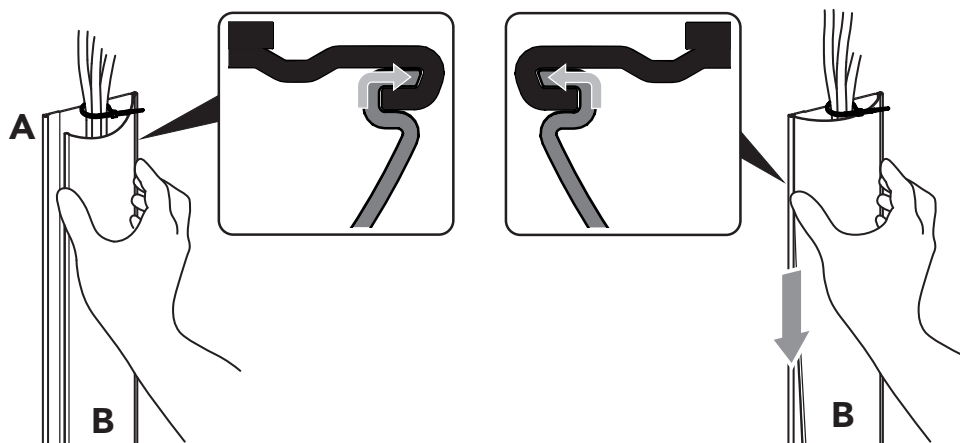

TIP

To make it easier to keep cables in place while attaching Cover Strip **B**, you can wrap tape, or use a cable tie, around your cables at the top and bottom.

3

Secure the cable management strip at the top and bottom using clips **C**.

Push clip **C** over the cable management strip. Make sure it clips into place behind the wall strip.

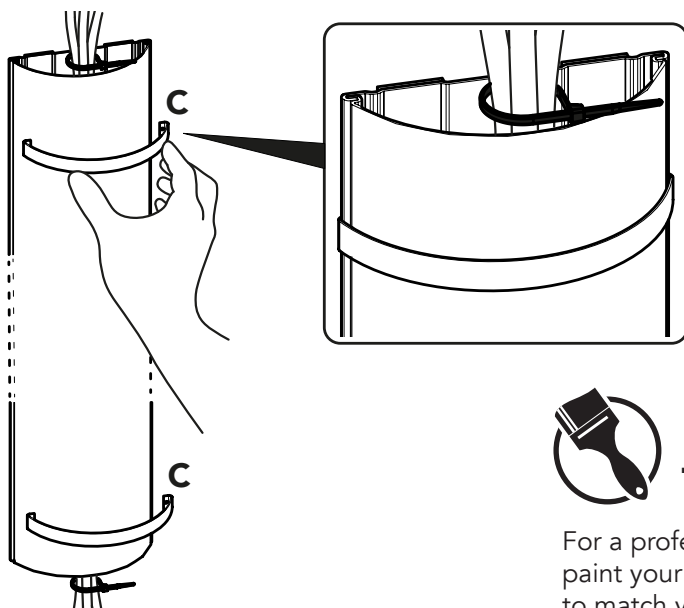

Finishing Touch

For a professional finish, paint your cable management to match your decor.