

You might not need all these parts, so there may be some left over depending upon the specification of your TV Wall Mount. This kit is intended for indoor use only. Use of this kit outdoors could lead to failure and personal injury. It is the responsibility of the installer to ensure that the mounting wall is of a suitable standard and void of any services (eg gas, electricity, water etc). AVF accept no responsibility for any damage or loss caused by installing your TV Wall mount in a substandard wall.

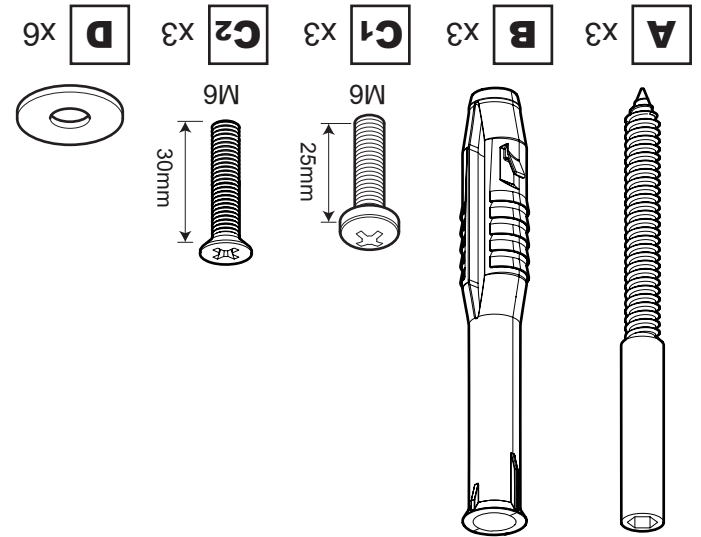

Fixings Included

jl.avfgroup.com

469198 rev01

Dot & Dab Wall Fixing Kit

Use this kit when installing a TV Wall Mount on a Dot and Dab wall.

This fixing kit is suitable for the following John Lewis TV Wall Mounts:

JLP200
JLP204
JLP400
JLP404
JNL202
JNL204

JNL454*
JNL655*
JXPL401*
JXPL601*
JXWL602
JZL4701*

* For these TV Wall Mounts you will need two Dot and Dab Wall Fixing Kits

Step 1 continued over page

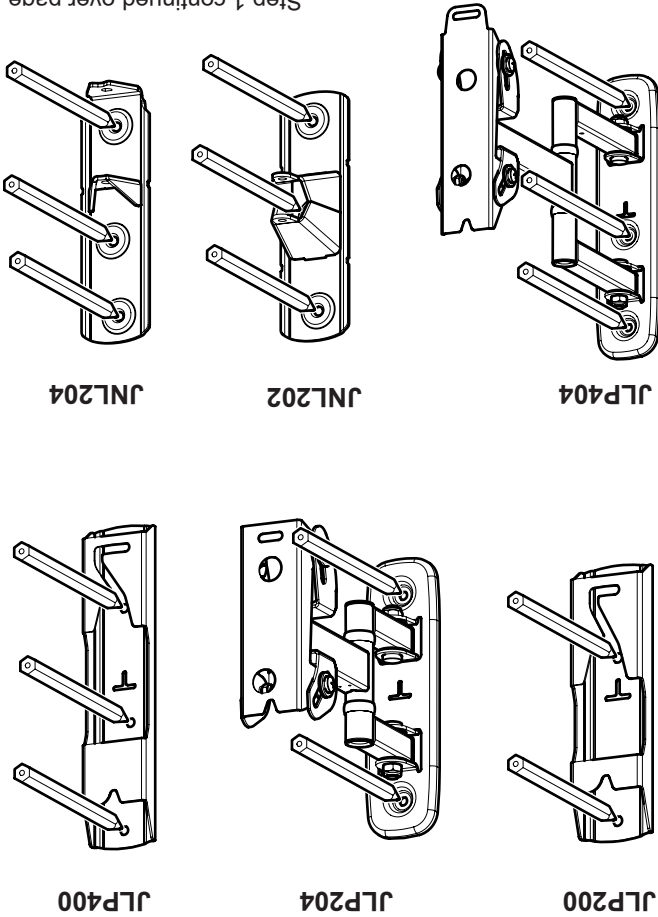

1 Marking Wall for Drill Points

3 Fitting the Wall Bracket

continued

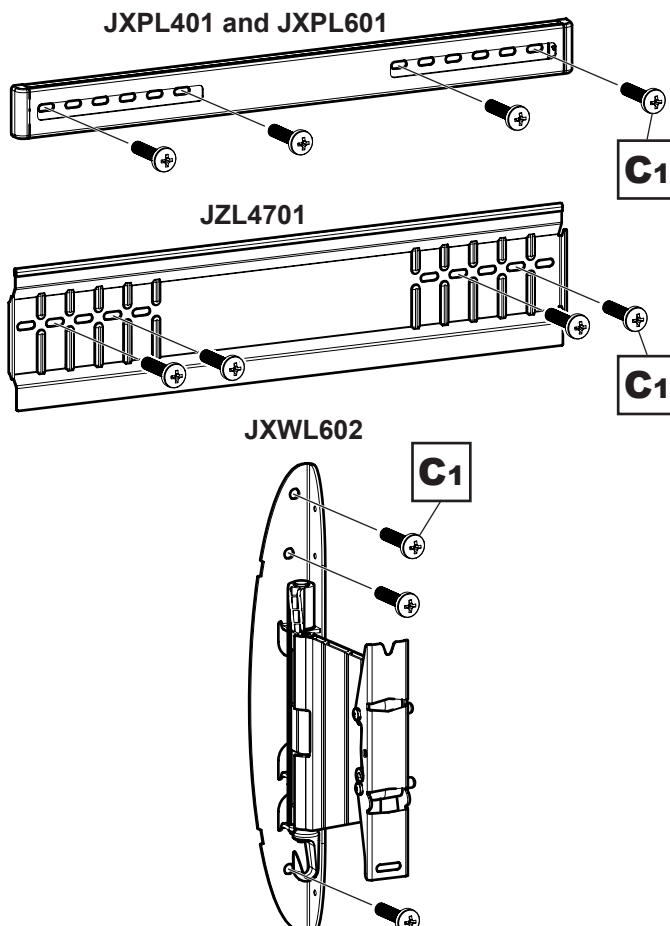

CUSTOMER SERVICES HELPLINE NUMBER: 0333 320 0463 (UK)

1 Marking Wall for Drill Points

continued

JNL454

JNL655

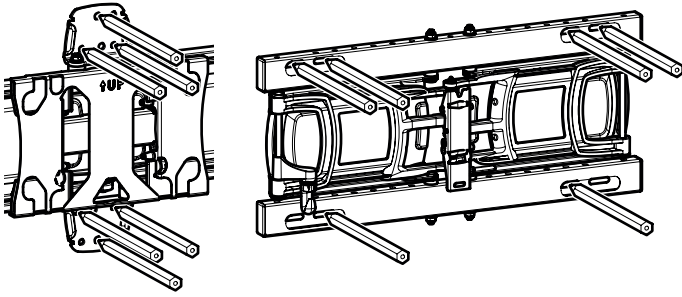

JXPL401 and JXPL601

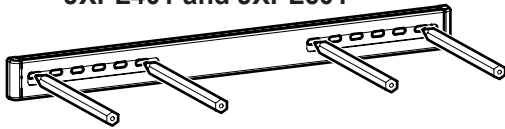

JXWL602

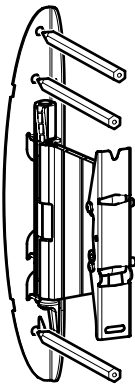

JZL4701

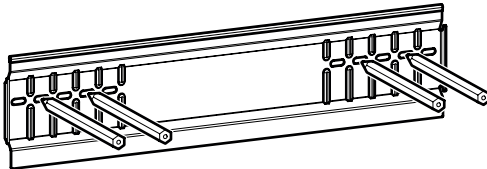

2 Install Wall Plugs and Bolts

i The drill hole pattern shown is an example only. Follow the drill hole markings in Step 1.

40mm (1 9/16")
MAX gap

Remove Dust from Hole.

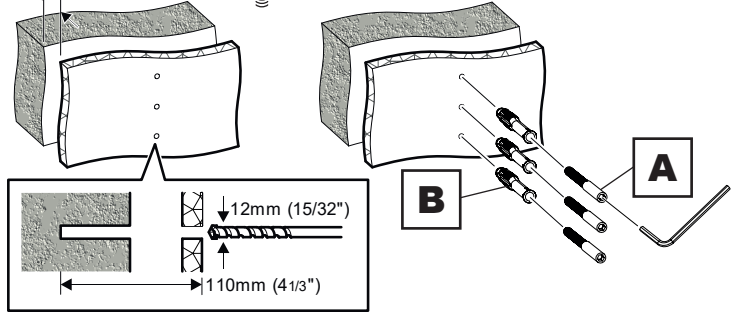

Both Plug **B** and Bolt **A**
MUST be flush with the wall.

Insert Wall Plug **B** and tap
into place with a hammer.

Screw Bolt **A** into Wall
Plug **B** using an allen key.

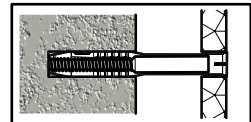
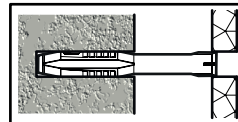
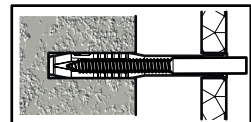
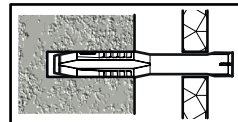
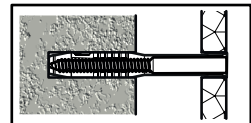
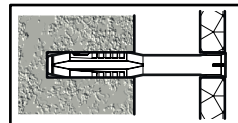

3 Fitting the Wall Bracket

JLP200

JLP204

JLP400

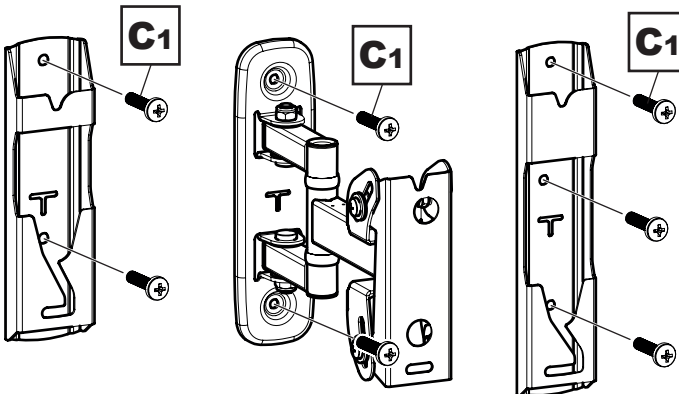

JLP404

JNL202

JNL204

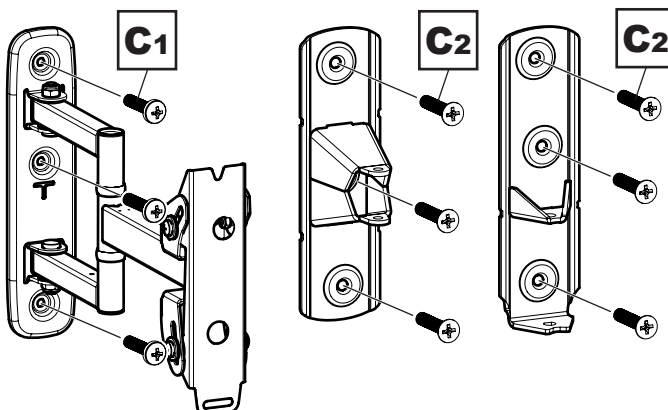

3 Fitting the Wall Bracket

continued

JNL454

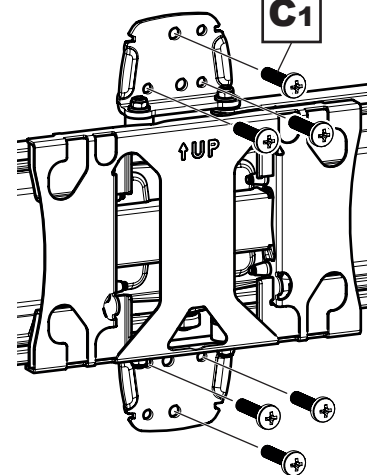

JNL655

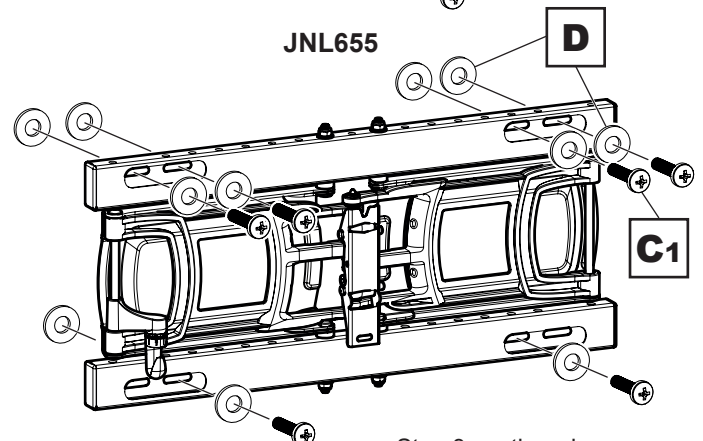

Step 3 continued over page