

Your TV mount fits the following TV fixing sizes
 100 x 100mm, 200 x 100mm
 200 x 200mm, 300 x 300mm
 400 x 200mm, 400 x 400mm
 600 x 100mm, 600 x 200mm
 600 x 400mm

1 Measure the TV fixing holes

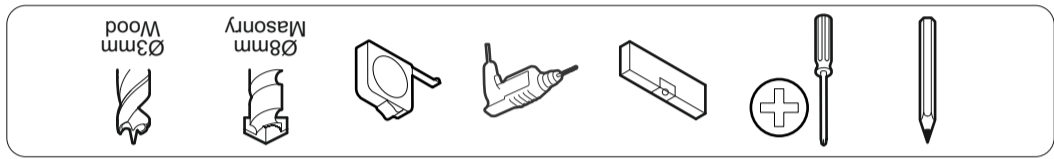
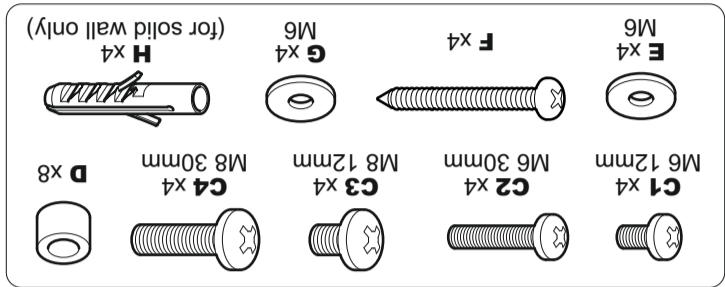
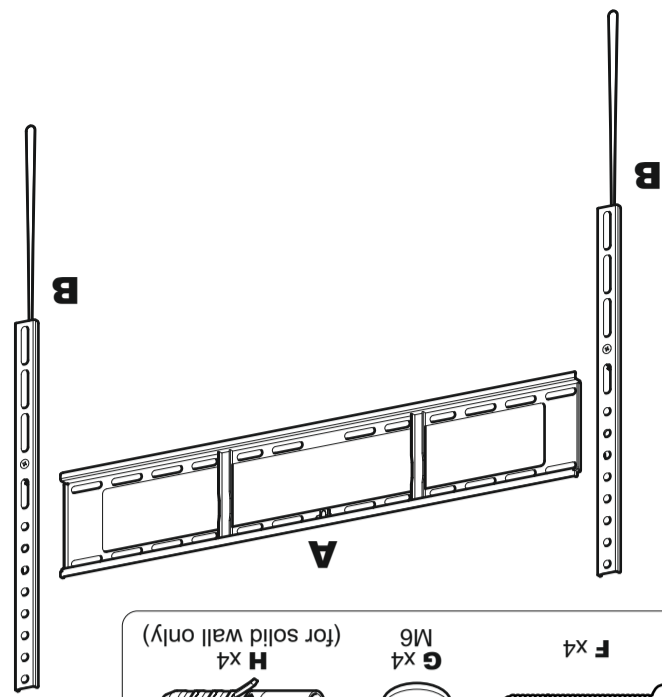

Tools Recommended

IF YOU ARE IN ANY DOUBT, CONSULT A QUALIFIED CONTRACTOR

Periodically check all nuts and bolts are tight.
 Retain all packaging in case the bracket needs to be returned.
 Contents may vary from photography/illustrations.
 You will not need all these parts, so expect there to be some left over depending upon the specification of your TV.
 This product is intended for indoor use only. Use of this product outdoors could lead to failure and personal injury.
 This product is sold as a home DIY product and as such, it is the responsibility of the installer to ensure the product is correctly installed.
 It is the responsibility of the installer to ensure that the mounting wall is of a suitable standard and void of any services (eg gas, electricity, water etc).
 TESCO accept no responsibility for any damage or loss caused by installing this product in a standard wall.

5 Connect TV

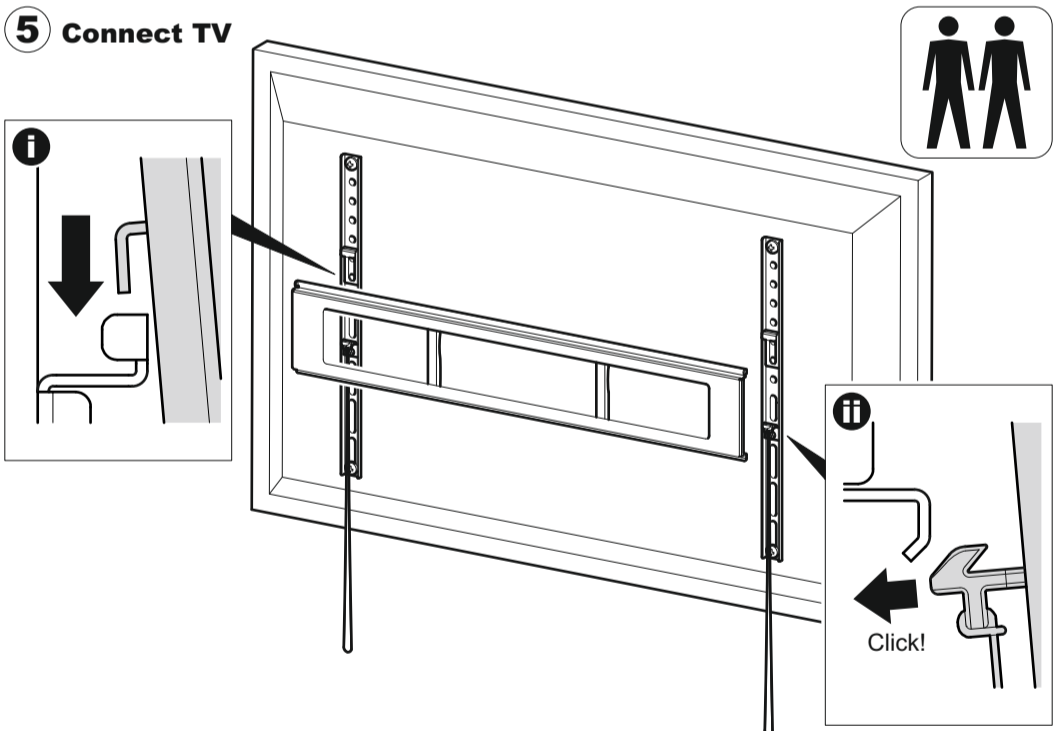

6 Finishing Touch

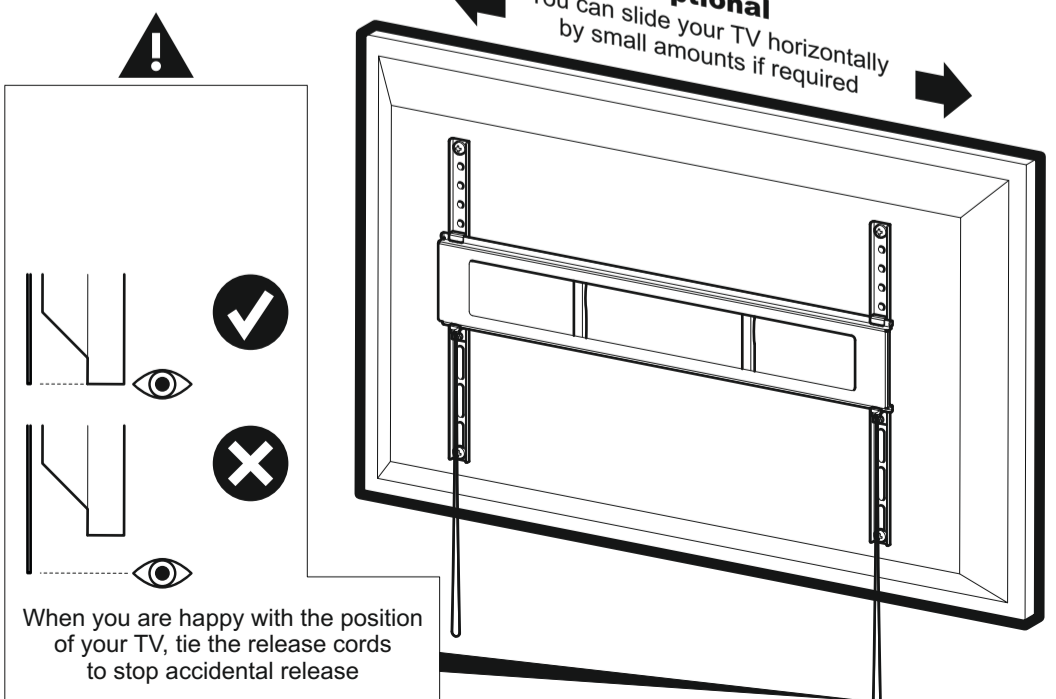

When you are happy with the position of your TV, tie the release cords to stop accidental release

TC4

466320 rev01

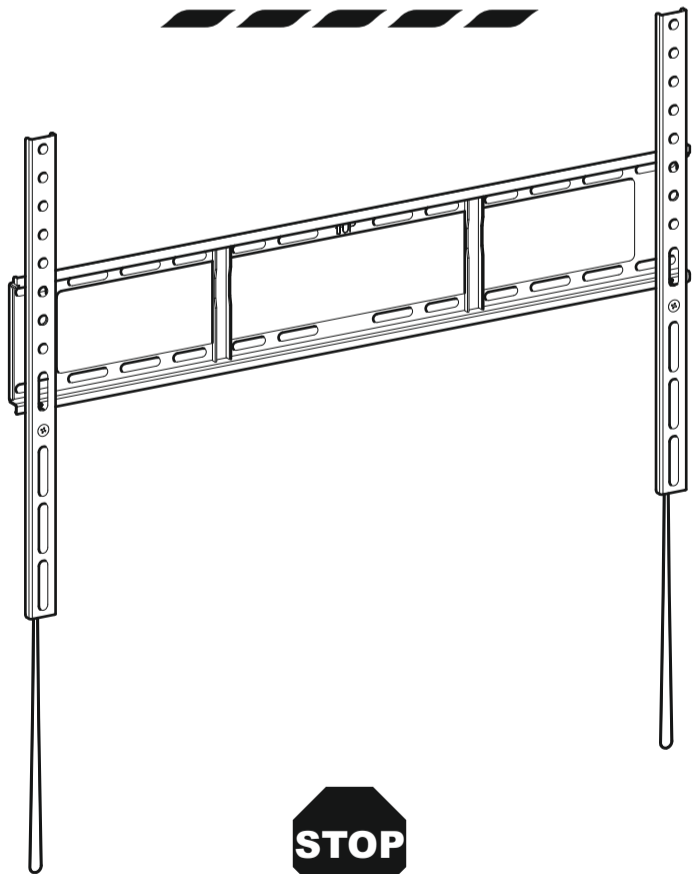

Read the operating instructions and keep them in a safe place. If you have any questions about this product or issues with installation contact the help line before returning this product to the store.

Help Line: **0333 320 8027**

Monday - Thursday 08:30 - 17:00 Friday 08:30 - 16:00
 Calls charged at local rate

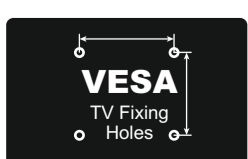

100 x 100mm, 200 x 100mm
 200 x 200mm, 300 x 300mm
 400 x 200mm, 400 x 400mm
 600 x 100mm, 600 x 200mm
 600 x 400mm

2 Deciding the correct screw and spacer combination



When deciding which screw diameter and length is suitable for your TV it is important to **STOP** immediately as soon as you feel any resistance to prevent damage to your TV

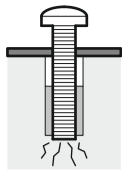

You are provided with 2 diameters of TV fixing screws, **M6** and **M8**. Determine the screw diameter that fits and remember for the next step

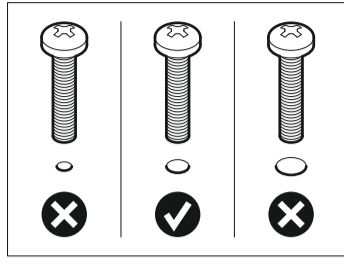
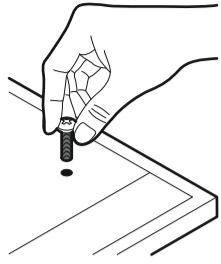

Do I need to use spacers **D** ?

Spacers are provided so that you can achieve the correct fit between the back of your TV and Mounting Plate, please see below for examples of when spacers are required

No
TV has flat back and flush fixing holes

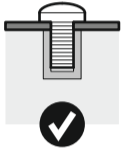
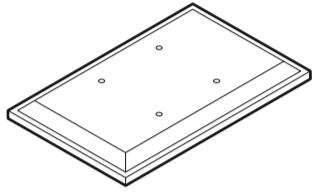

Maybe
TV has flat back with recessed fixing holes

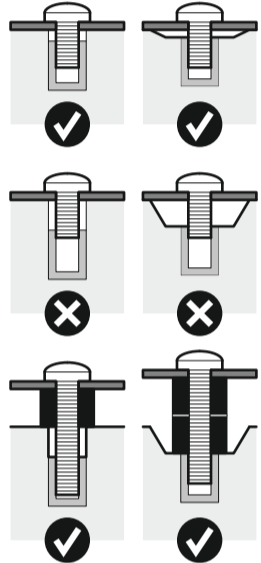
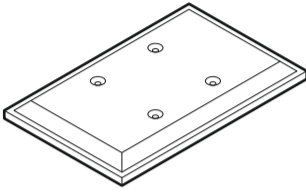

Yes
TV has irregular or obstructed back

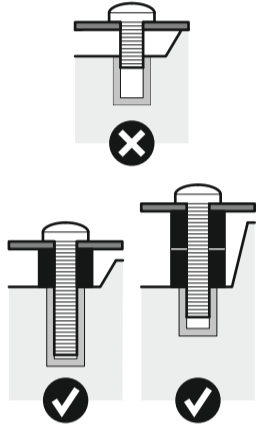
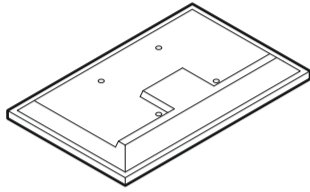

3 Fitting the TV Brackets

C1 or C2
C3 or C4
E only required for certain screws

D x1 or x2 if required

Top

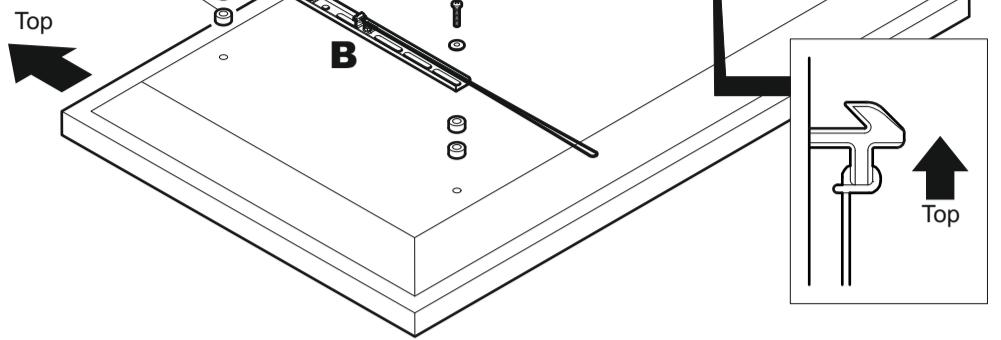

Ensure TV Brackets **B** do not protrude at the top or bottom of your TV

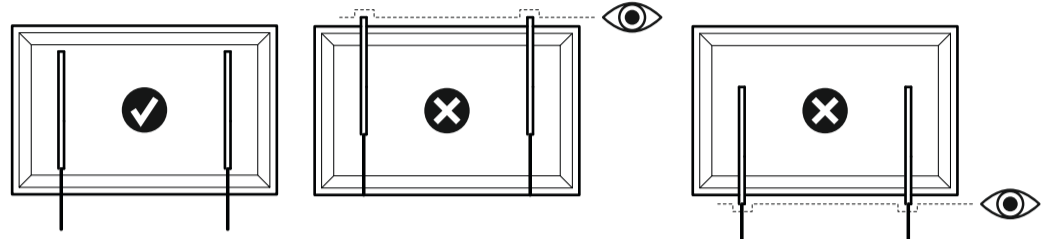

C1
M6 12mm

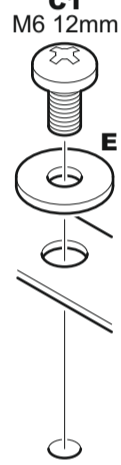

C2
M6 30mm

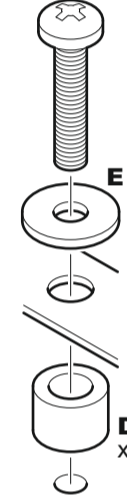

C1
M8 12mm

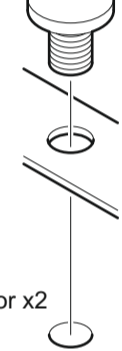

C2
M8 30mm

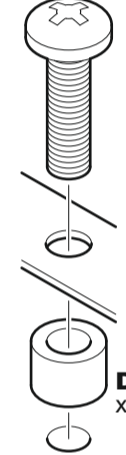

Attach the bracket to the back of your TV using a suitable combination of screw, washer and spacer combinations. **DO NOT OVERTIGHTEN!**



After completing step 3 you will have fittings left over, please keep in a safe place for future reference

4 Solid Wall

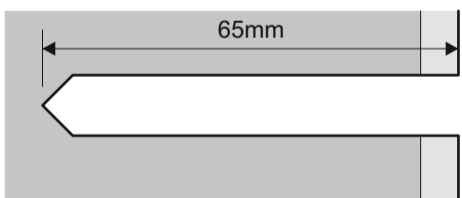
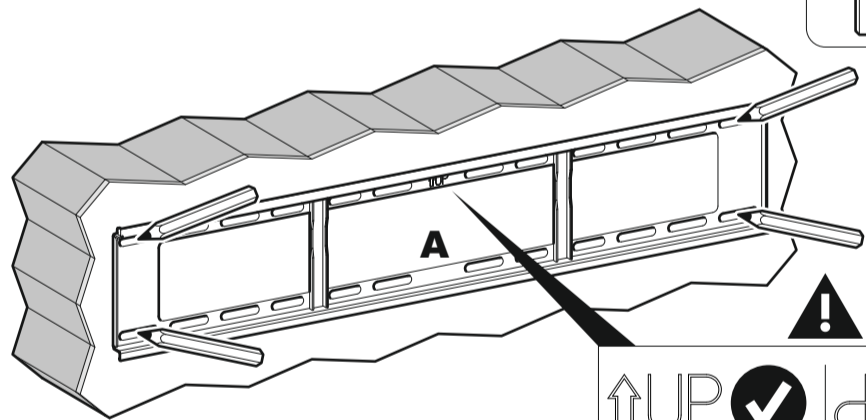

Remove dust from hole

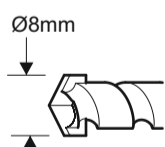

Ø8mm
Masonry

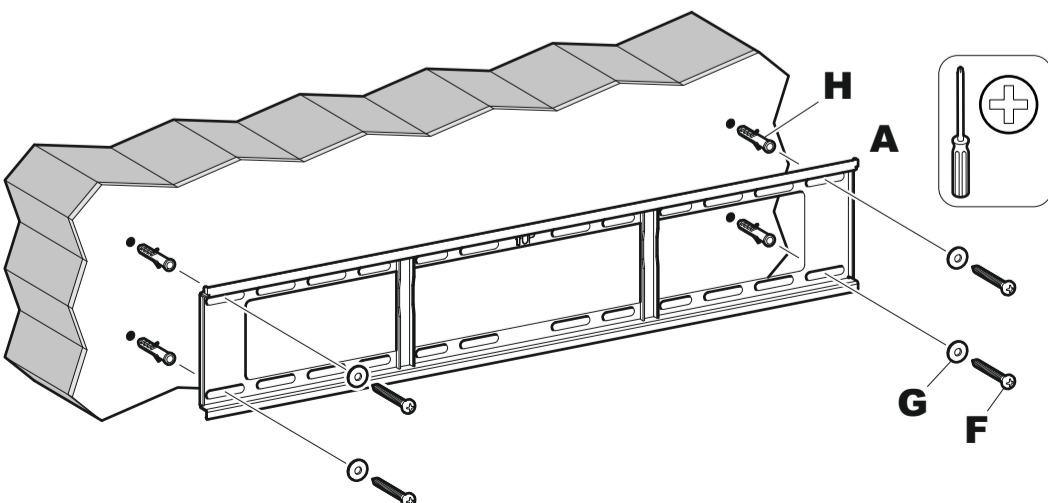

Tighten with hand tools only



Lubricate screw thread with soap

4 Wood Stud

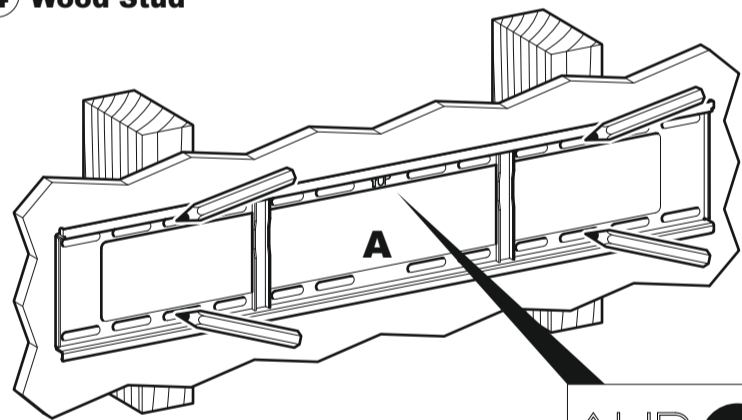

Ensure drill marks are in the centre of the wood stud

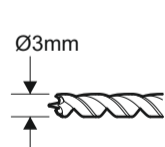
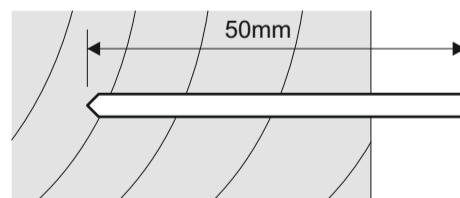

Ø3mm
Wood

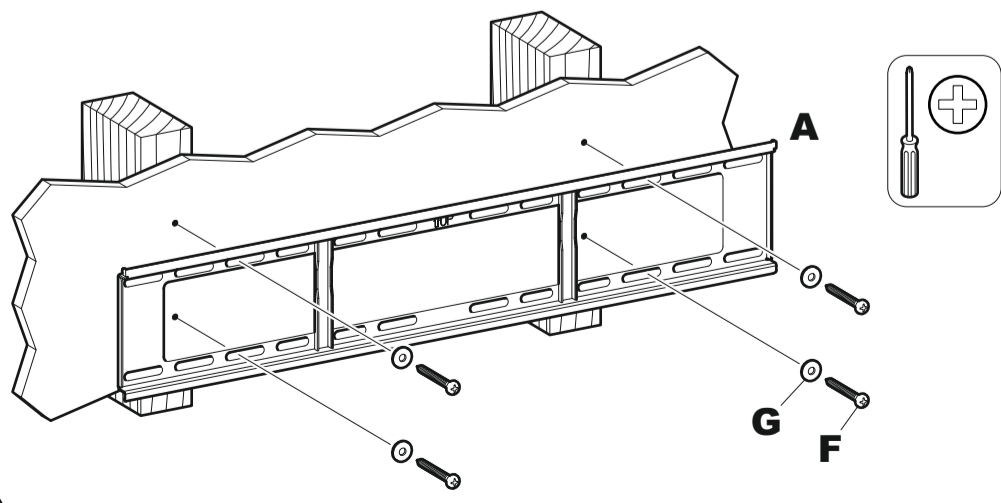

Do not use **H** wall plugs in wood stud

Tighten with hand tools only



Lubricate screw thread with soap