

# JML8401

Leaflet No. **463460** rev01

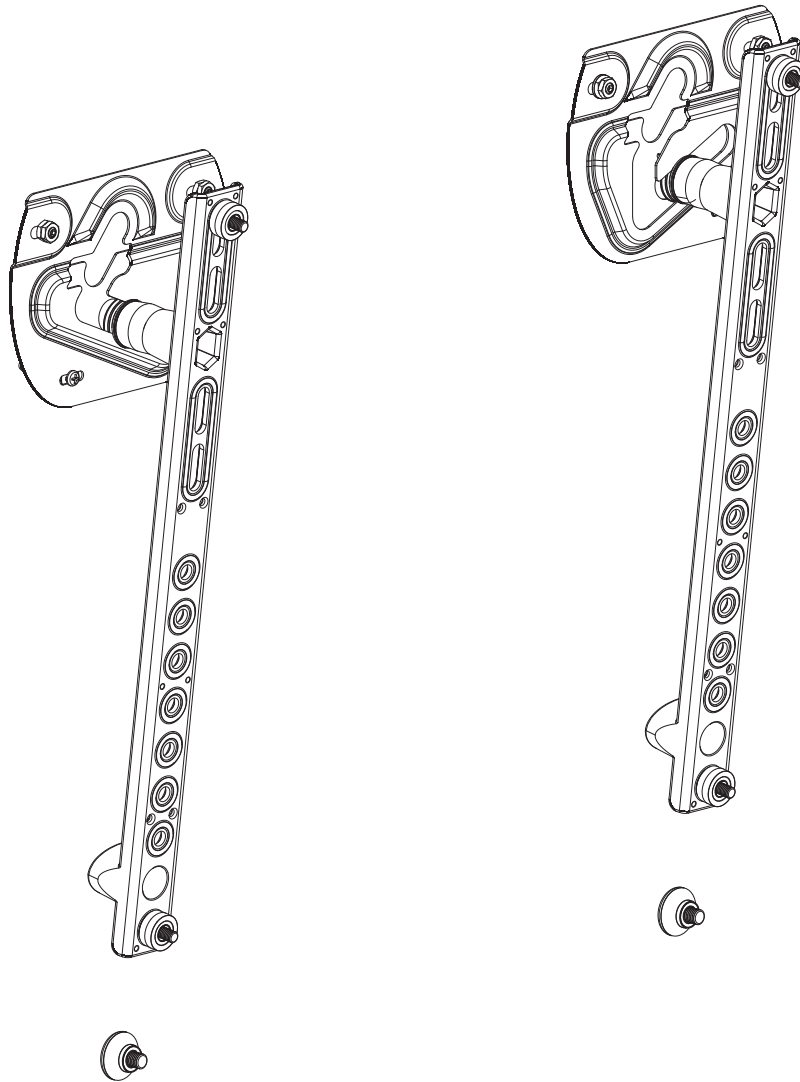

**Read through ALL instructions before commencing installation.**  
***If you have any questions about this product or issues with installation contact the customer services helpline before returning this product to the store. See [jl.avfgroup.com/p/jml8401](http://jl.avfgroup.com/p/jml8401) for more information.***

**CUSTOMER SERVICES HELP LINE NUMBER:**

**01952 670009**



**AVF Group Ltd.** Road 30. Hortonwood Ind Est, Telford, Shropshire, TF1 7YE, England

# 1 Boxed Parts

You will not need all these parts, so expect there to be some left over depending upon the specification of your TV.

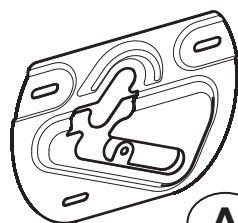

**A** - x1

LH Wall Bracket

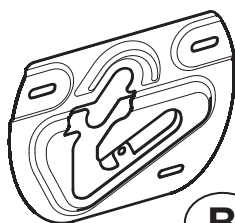

**B** - x1

RH Wall Bracket



**V** - x2

Nyloc Nut

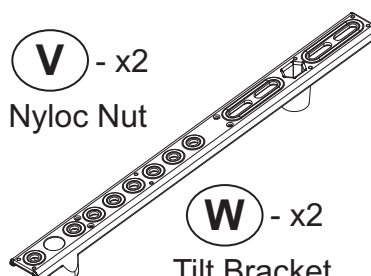

**W** - x2

Tilt Bracket



**C** - x2

Hanger



**D** - x2

Stand-off



**X** - x2

Tilt Spacer

**TV Fixings:** Parts go on the back of the TV (specification of your TV will determine which ones you require - see section 11).



**E1** - x12

Spacer



**E2** - x4

Spacer (Red)



**F1** - x4

M4 Adaptor



**F2** - x4

M5 Adaptor



**F3** - x4

M6 Adaptor



**G1** - x4

M4 16mm



**G2** - x4

M4 25mm

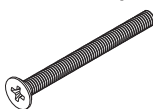

**G3** - x4

M4 45mm



**G4** - x4

M5 16mm



**G5** - x4

M5 25mm

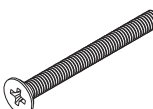

**G6** - x4

M5 45mm



**G7** - x4

M6 16mm



**G8** - x4

M6 25mm

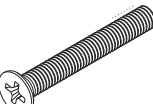

**G9** - x4

M6 45mm



**G10** - x4

M8 16mm

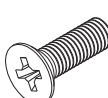

**G11** - x4

M8 25mm

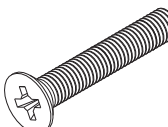

**G12** - x6

M8 45mm

**Wall Fixings:** Parts to attach to the wall (type of wall will determine which fixings you require).

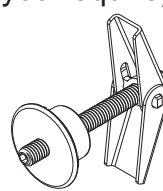

**H** - x4

Wall Fixing

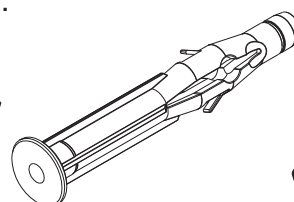

**I** - x4

Long Wall Plug



**J** - x8

Lock Nut Plug

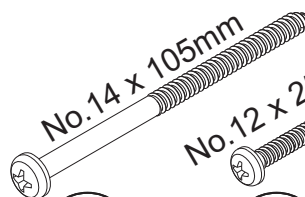

**K** - x4

Long Screw



**L** - x2

Metal Stud Screw

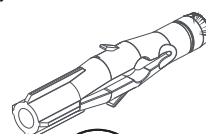

**M** - x4

Wall Plug

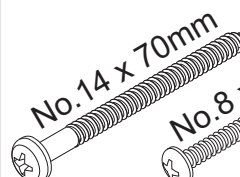

**N** - x4

Screw

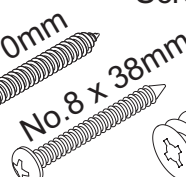

**O** - x2

Screw

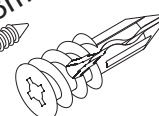

**P** - x2

Screw Plug

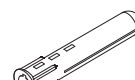

**Q** - x2

Wall Plug

**Included Tools**



**R** - x1

18mm Wood Drill



**S** - x1

3mm Hex Key

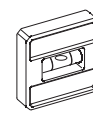

**T** - x1

Level

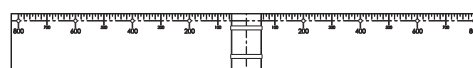

**U1** - x1

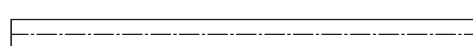

**U2** - x1

Template

## 2 Tools Required

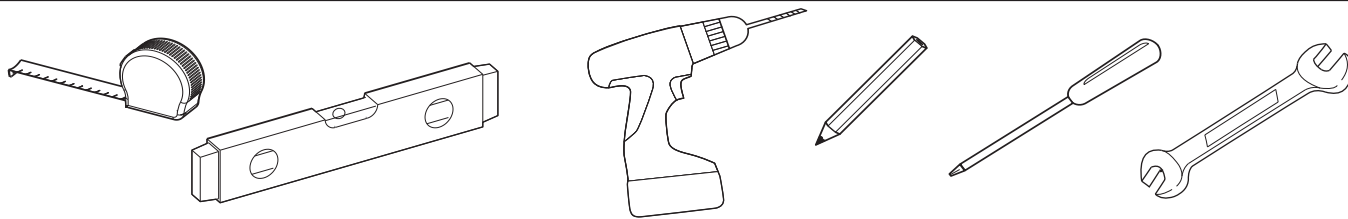

## 3 Determine Correct TV Screw Size

Choose from the TV Fixings selection. You need to determine which length and diameter of screws fits your TV. To determine the correct screw diameter, try screwing (**G1**), (**G4**), (**G7**) & (**G10**) into one of the fixing holes on the back of the screen until you find the one that fits. Note the thread size and ensure you use the appropriate diameter screws.

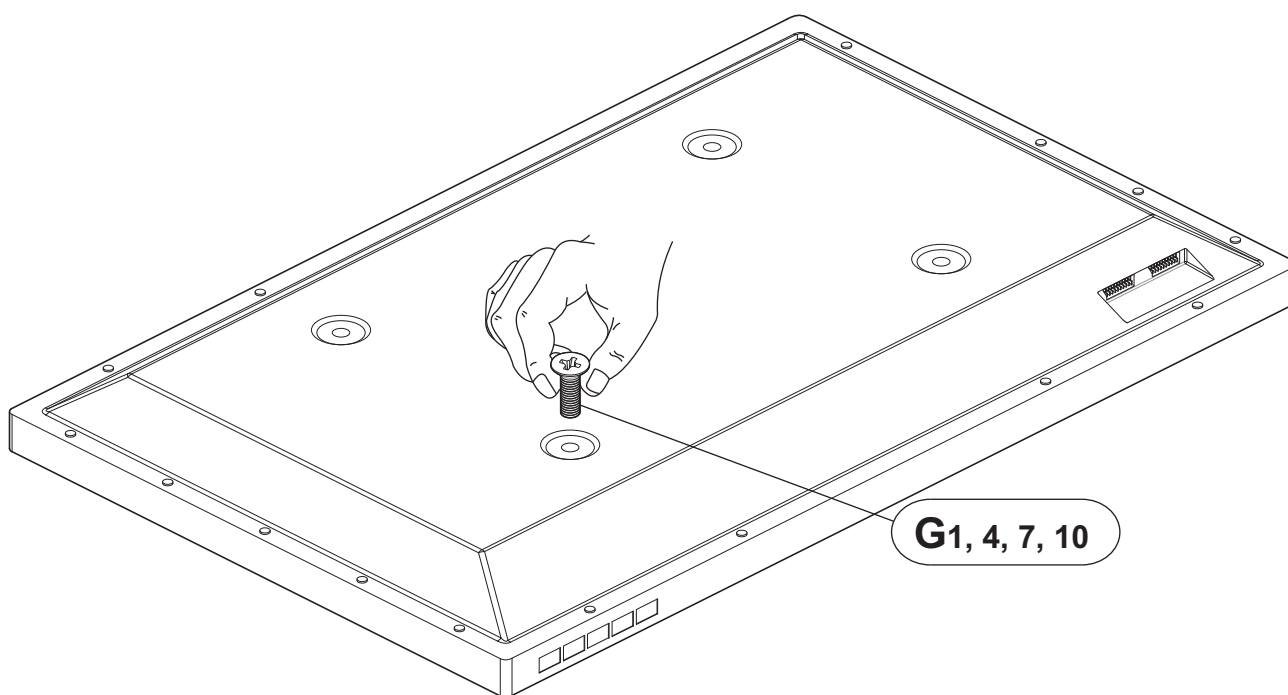

## Flat or Tilt

Before you start please choose if you would like your TV to be either Flat to Wall or in a Tilt position.

### Flat to Wall

Follow steps 4 to 11

### Tilt Position

Follow steps 12 to 20

# Flat Position

You will only need to follow steps 4 to 11 if you have chosen to have your TV in a flat position

## 4 Fit Screen Hangers To TV

Once you have established which screws you need for your TV, you can attach the Hangers (C) and Stand-offs (D) to the back of your TV.

The example shown below is for fixing the TV 12mm from the wall.

The TV Mount can position your TV between 12mm and 40mm from the wall. For alternative configurations see section 11.

You might need to use spacers to increase the clearance of your TV from the wall in order to avoid cables coming out of your TV and improve access and ventilation to the back of your TV, spacers (E1) allow you to increase the clearance to 20mm or 40mm, see section 11.

In certain circumstances it may be necessary to use red spacer (E2) as either a replacement or addition to spacer (E1), for more information please see section 11.

If your TV fixing centres don't fit, STOP installation and contact the customer services helpline.

### Top Fixings

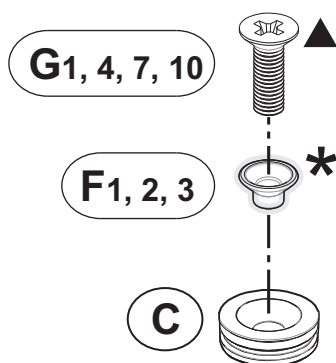

- Use adapter (F1) with screws (G1)
- Use adapter (F2) with screws (G4)
- Use adapter (F3) with screws (G7)
- No adapter required with screws (G10)

TV must be parallel to wall.  
Use spacers / stand-offs as shown.

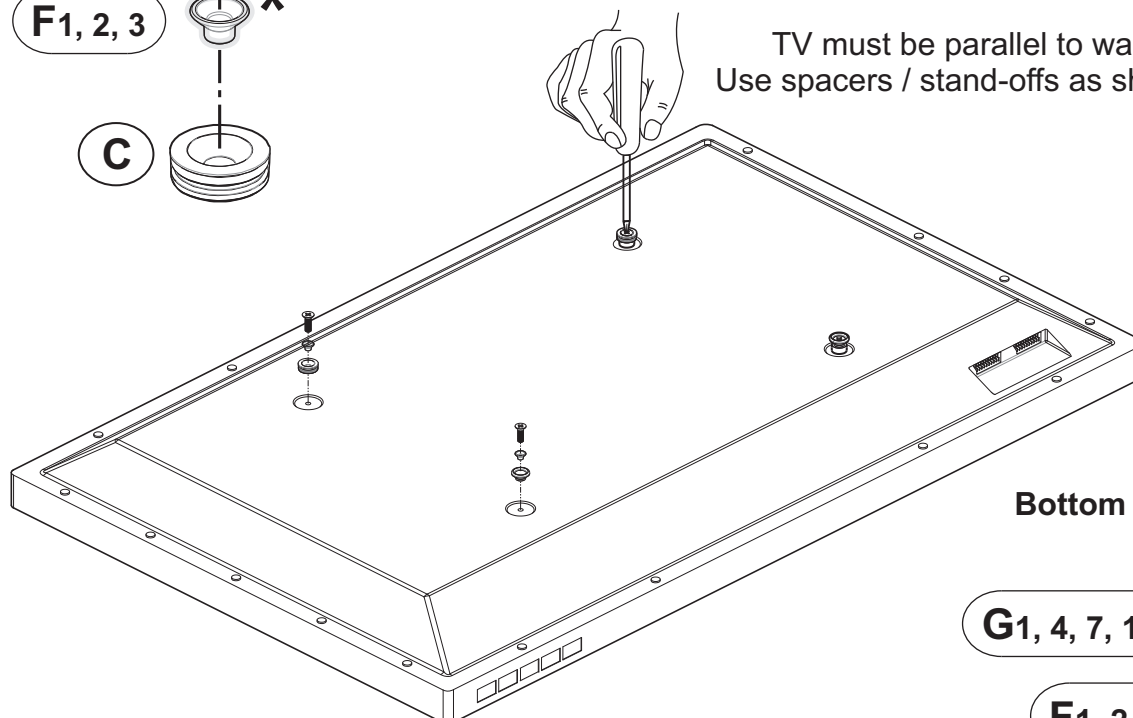

### Bottom Fixings

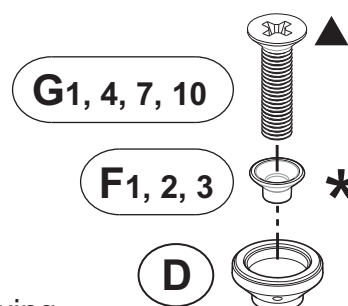

- ▲ If you use screw G1 for top fixing you must use screw G1 for bottom fixing
- ▲ If you use screw G4 for top fixing you must use screw G4 for bottom fixing
- ▲ If you use screw G7 for top fixing you must use screw G7 for bottom fixing
- ▲ If you use screw G10 for top fixing you must use screw G10 for bottom fixing

## 5 Assemble Positioning Template

The horizontal part of the positioning template is used to mark out where you need to drill the mounting holes on your wall. The vertical part is just a guide to allow you to see how high up the wall your TV will be to help you find the perfect position for viewing your screen. Thread template (U<sub>2</sub>) through template (U<sub>1</sub>) as shown.

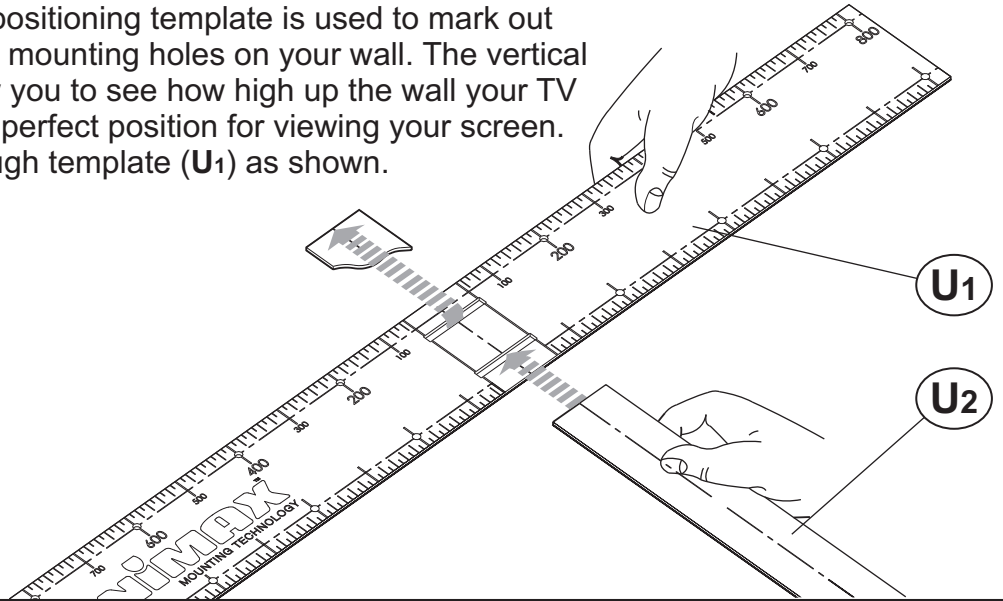

## 6 Determine Bracket Hole Centres

Lay the template on the back of the TV and follow the instructions below.

The centre line of the template represents the centre of your TV.

Line up with top of the screen.

Line up the template with the centre of the screen. Mark off the fixing centres.

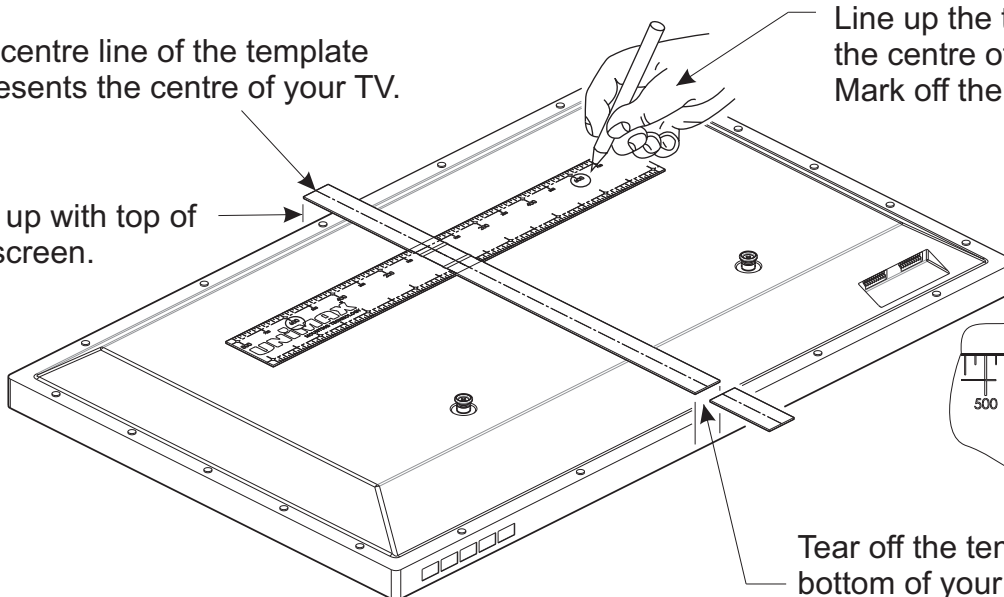

Tear off the template flush with the bottom of your TV so that when the template is on the wall you can see exactly where your TV will be vertically (distance from the floor and ceiling).

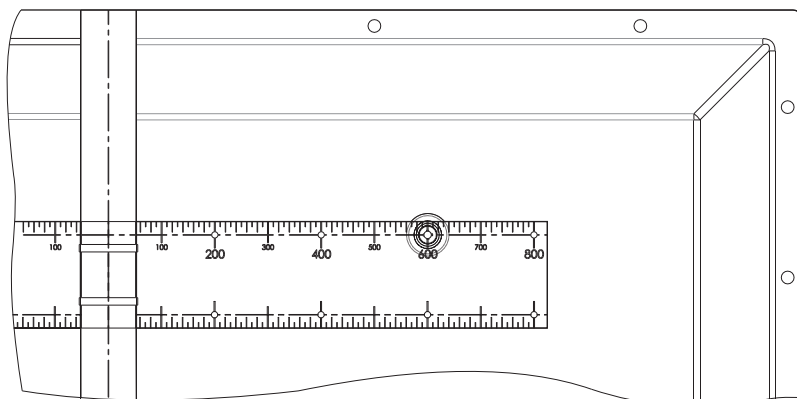

If your screen fixings do not line up with any holes on the template then ensure template is on the centre of the screen, and punch holes to suit your screen fixings centres with a pencil or sharp object.

## 7 Marking Wall For Drill Points

Use your template to mark two points on the wall that correspond with the top fixing centres of your TV.

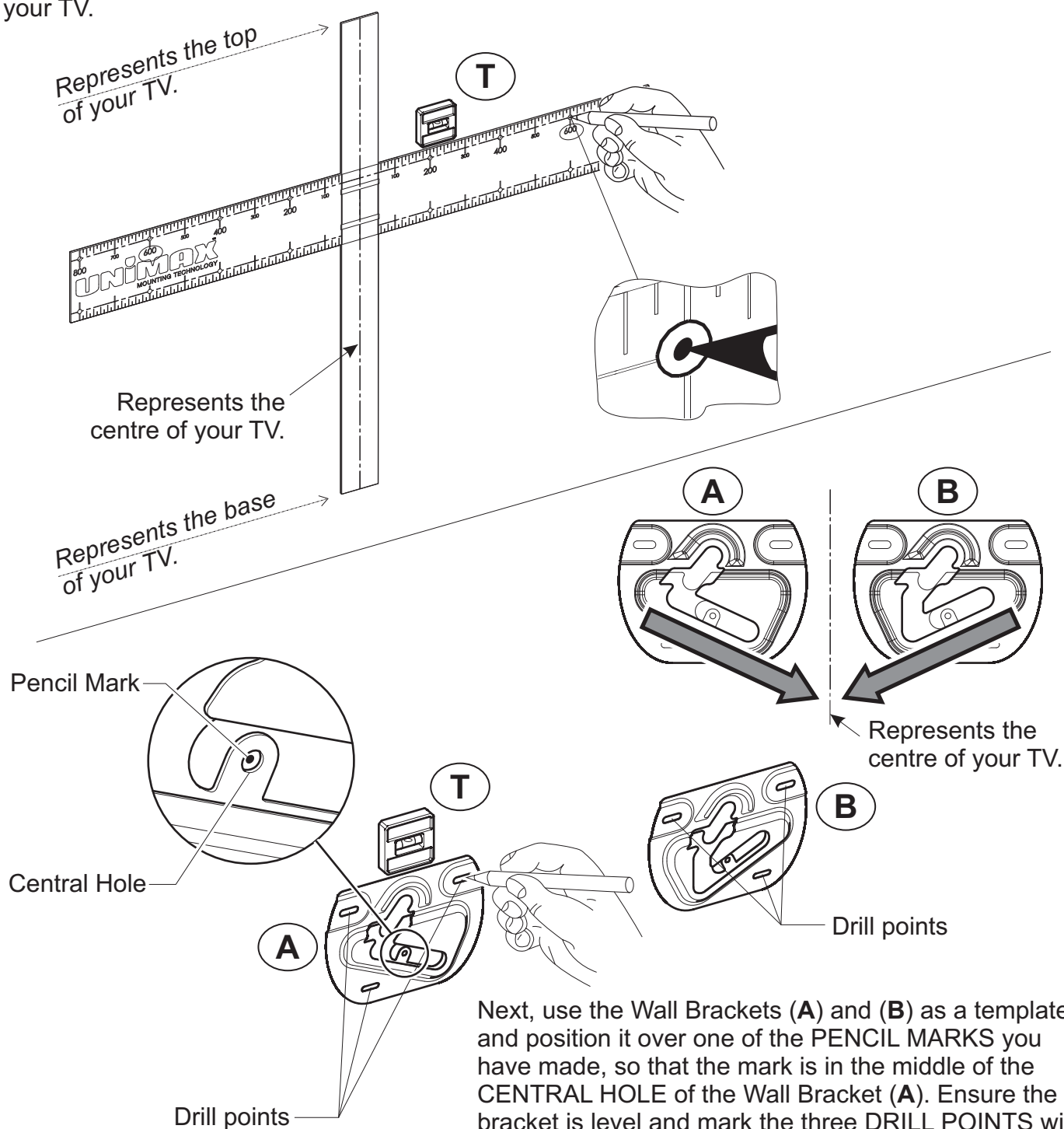

## 8 Planning & Preparation

Determine the wall type that you have (See Section 9).

Ensure the drilling area is free from mains services (Gas/Electric/Water).

Drill six 3mm diameter pilot holes to verify the wall type and select the appropriate fixings (See Section 9).



# 9 Install Wall Fixings

Use the correct fixings for your wall type. Mixing fixing types may be required for installations that span different wall types. DO NOT OVER TIGHTEN SCREWS.

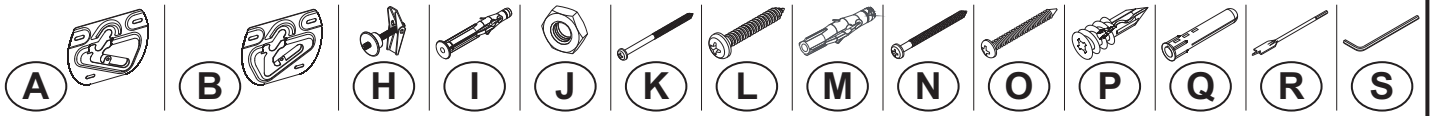

## Solid Wall

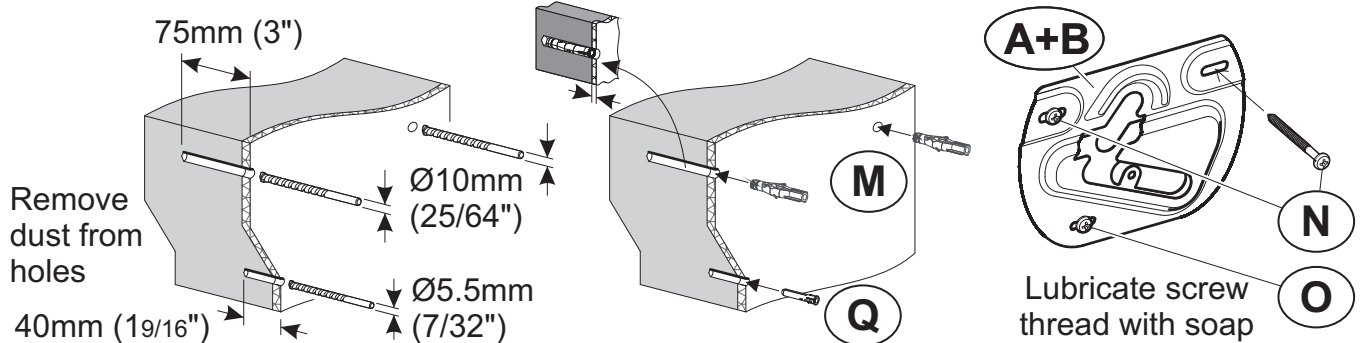

## Dot & Dab

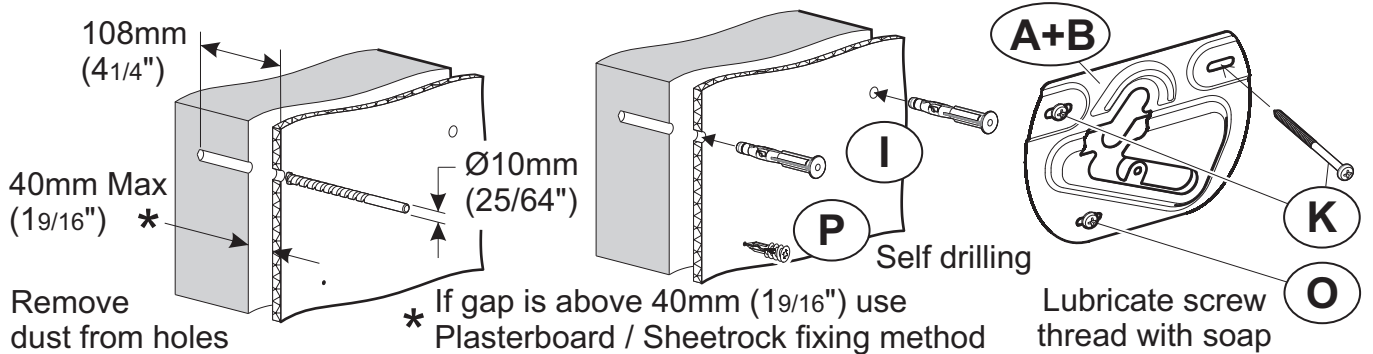

## Plasterboard / Sheetrock

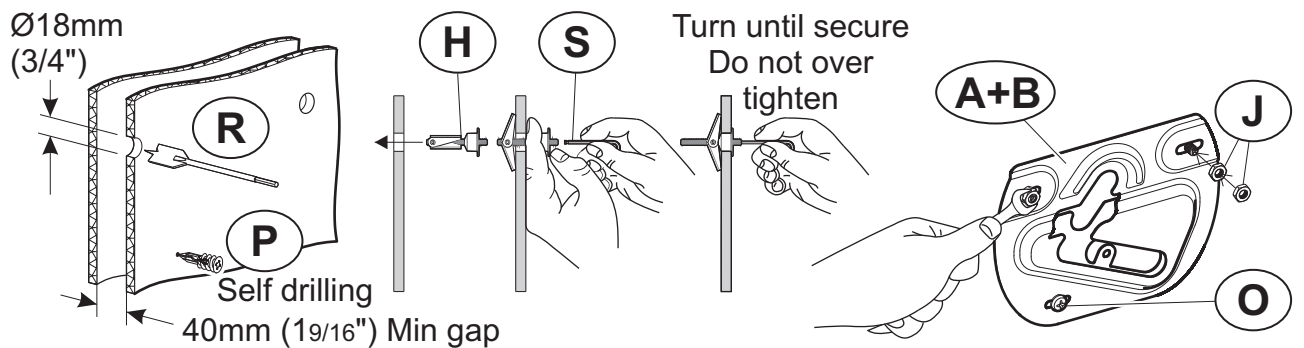

## Wood Stud

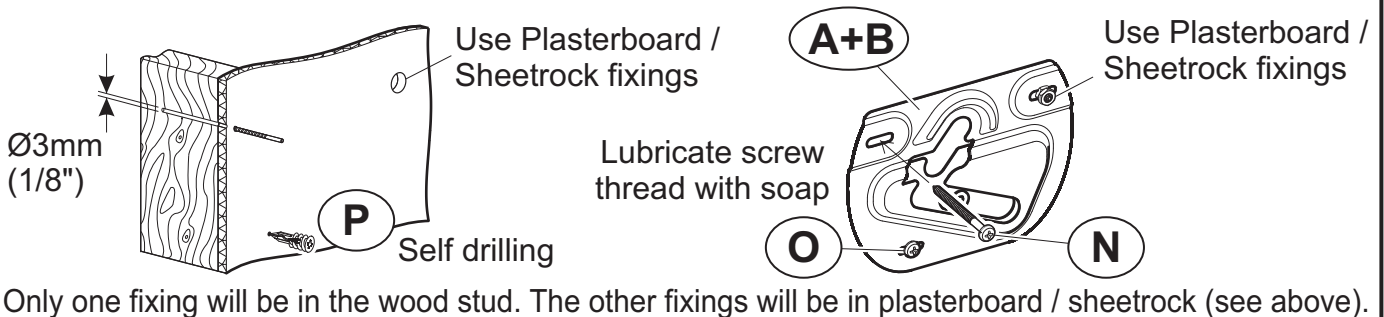

## Metal Stud

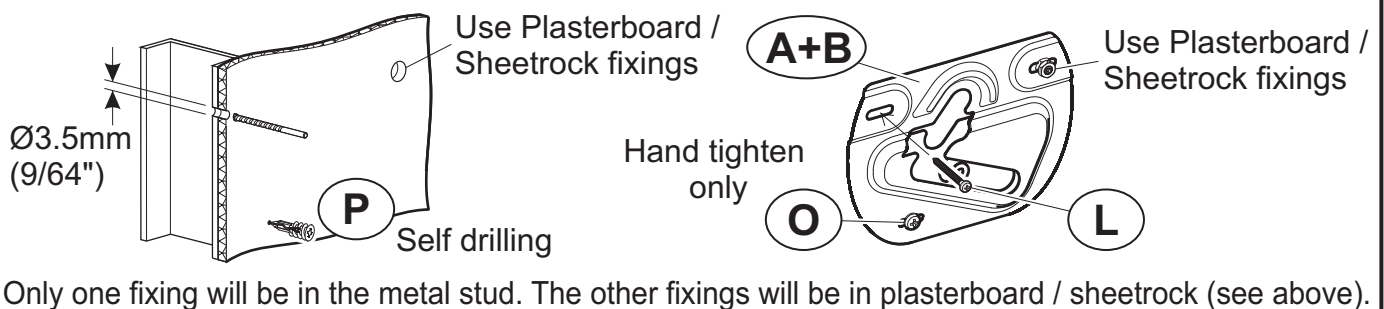

# 10 Hanging The TV

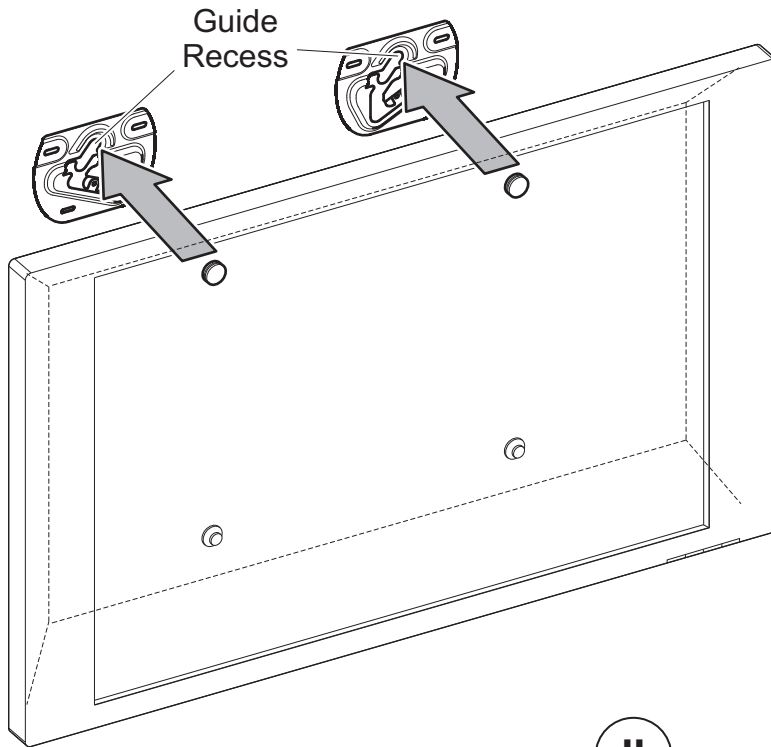

Present the Hangers (on the back of the TV) to the guide recess on the Wall Brackets. Slide down and across into place. Ensure both Hangers are fully engaged.

If cables from the TV prevent the TV resting against the wall then an alternative hanger configuration will be required (See Section 11).

TV must be parallel to wall. Use spacers / stand-offs as shown.

I

II

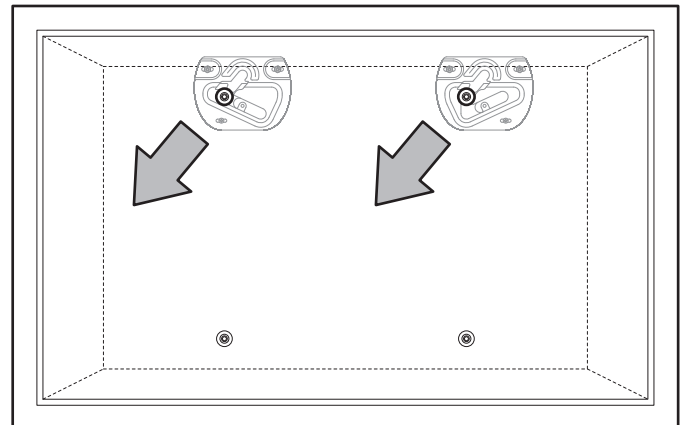
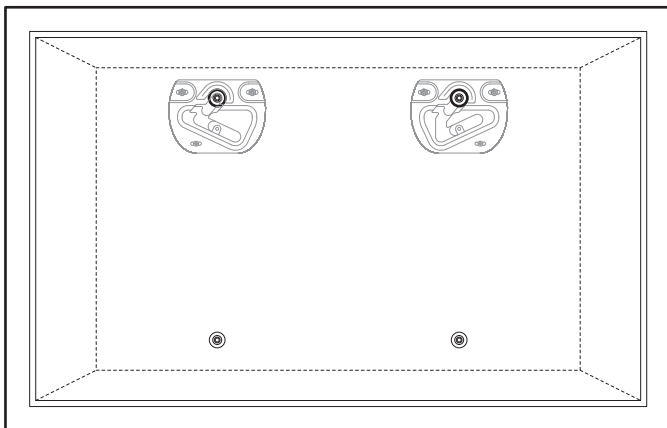

III

IV

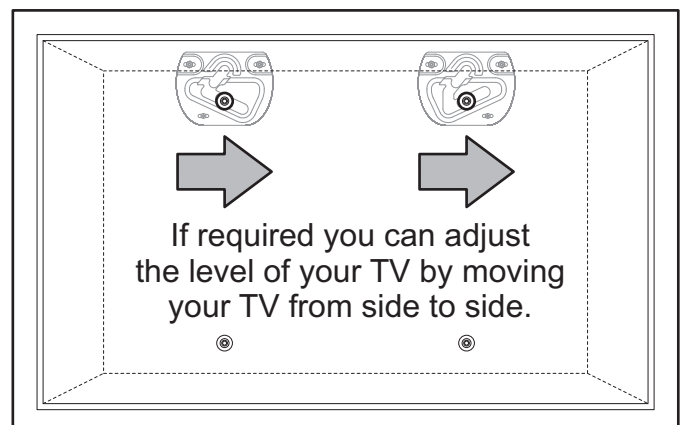
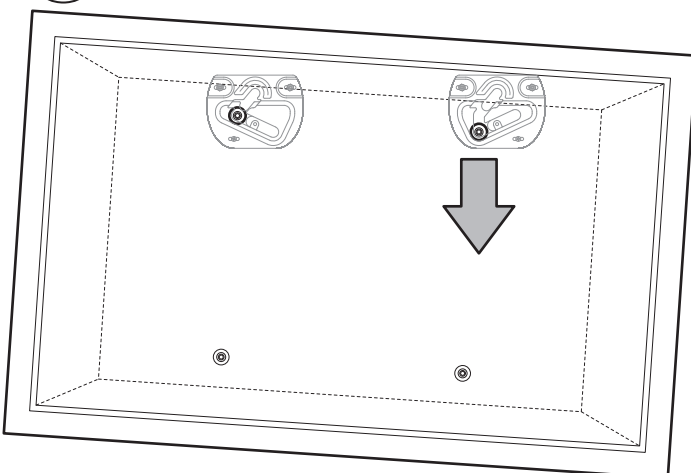

If required you can adjust the level of your TV by moving your TV from side to side.

## Removing the TV

This is a two person job. To remove the TV reverse the movements as shown above.



# 11 Alternative Hanger Configurations

Alternative Wall spacings of 12mm, 20mm & 40mm can be achieved using the spacer / screw combinations listed in this section.

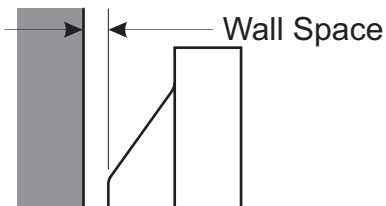

12mm Wall Space  
(as shown in section 4)

## Top Fixings

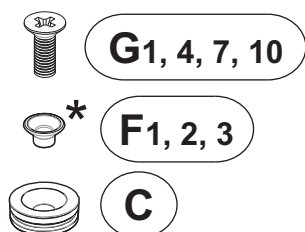

## Bottom Fixings

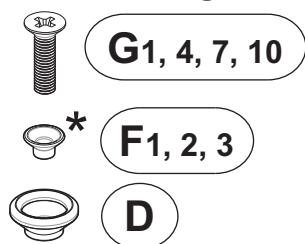

20mm Wall Space

## Top Fixings

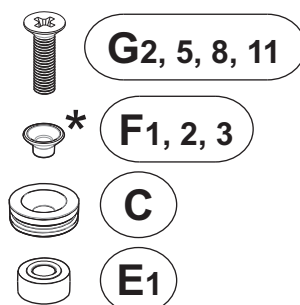

## Bottom Fixings

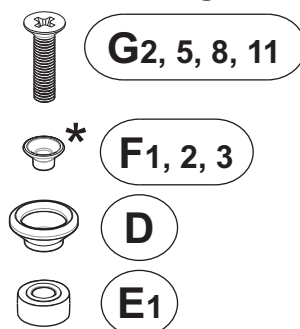

40mm Wall Space

## Top Fixings

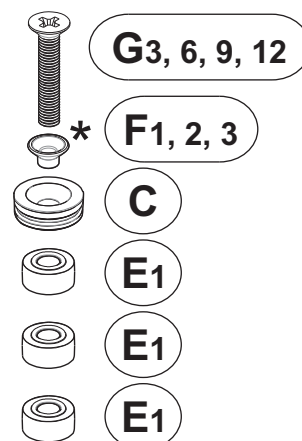

## Bottom Fixings

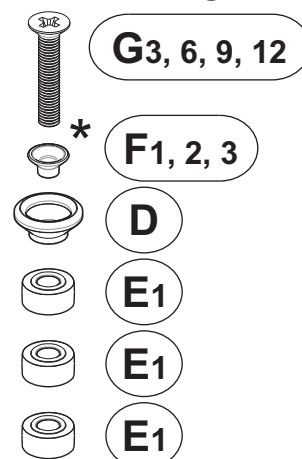

TV must be parallel to wall. Use spacers / stand-offs as shown.

- If using screw (G<sub>1</sub>), (G<sub>2</sub>) or (G<sub>3</sub>) use Adapter (F<sub>1</sub>)
- If using screw (G<sub>4</sub>), (G<sub>5</sub>) or (G<sub>6</sub>) use Adapter (F<sub>2</sub>)
- \* If using screw (G<sub>7</sub>), (G<sub>8</sub>) or (G<sub>9</sub>) use Adapter (F<sub>3</sub>)
- If using screw (G<sub>10</sub>), (G<sub>11</sub>) or (G<sub>12</sub>) No Adapter required

When is it necessary to use red spacers?



(E<sub>2</sub>) - x4

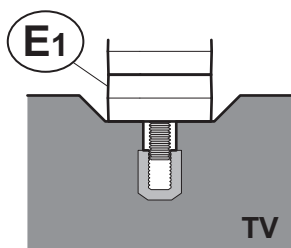

**Problem**  
Not enough  
screw engagement

It is recommended that when fitting Hangers (C) and Stand-offs (D) to your TV you have at least 5-10mm of screw engagement. In certain circumstances you may need to use red spacers (E<sub>2</sub>) as either a replacement, or together with spacers (E<sub>1</sub>) to achieve this. Whenever you use red spacers (E<sub>2</sub>) you must use all 4 provided.

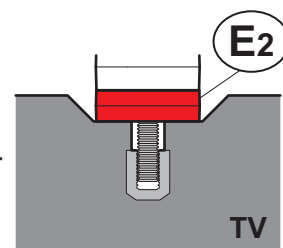

**Solution**  
Red spacer (E<sub>2</sub>) has  
replaced spacer (E<sub>1</sub>)

# Tilt Position

You will only need to follow steps 12 to 20 if you have chosen to have your TV in a tilted position

## 12 Choose Tilt

You can choose between 2 different tilt positions, either 4° or 8°.

### 4° tilt

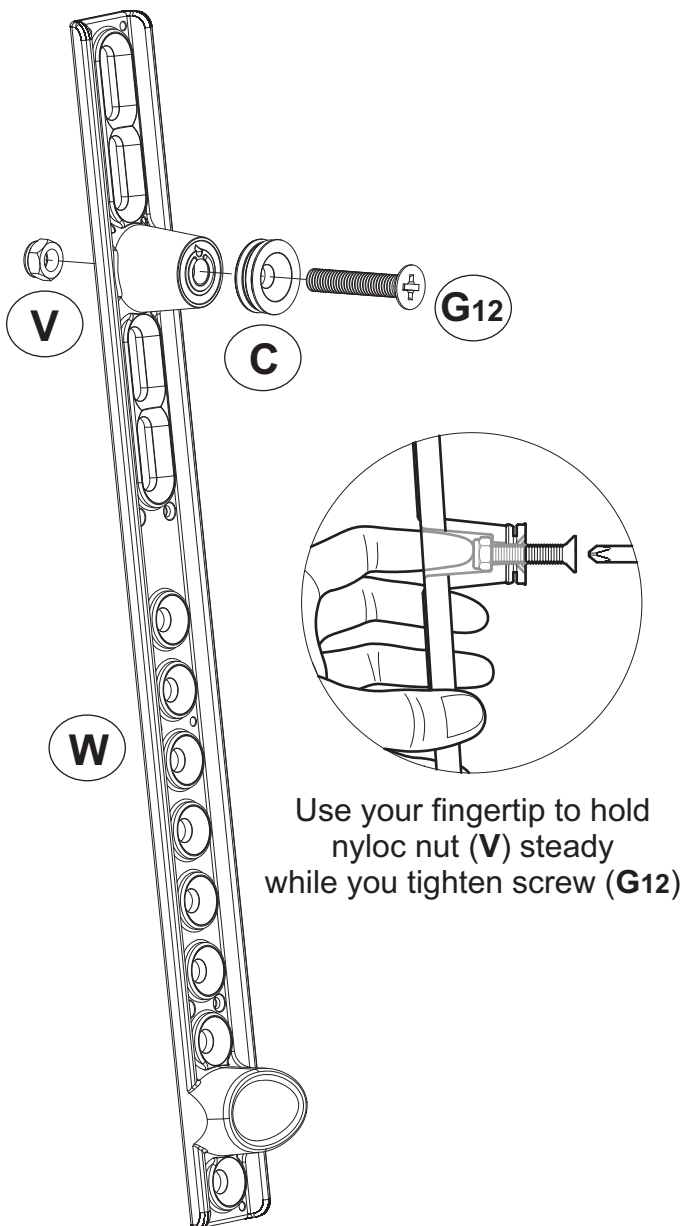

### 8° tilt

Ensure a flush fit between tilt bracket (W) and spacer (X) by lining up the notch and pip correctly

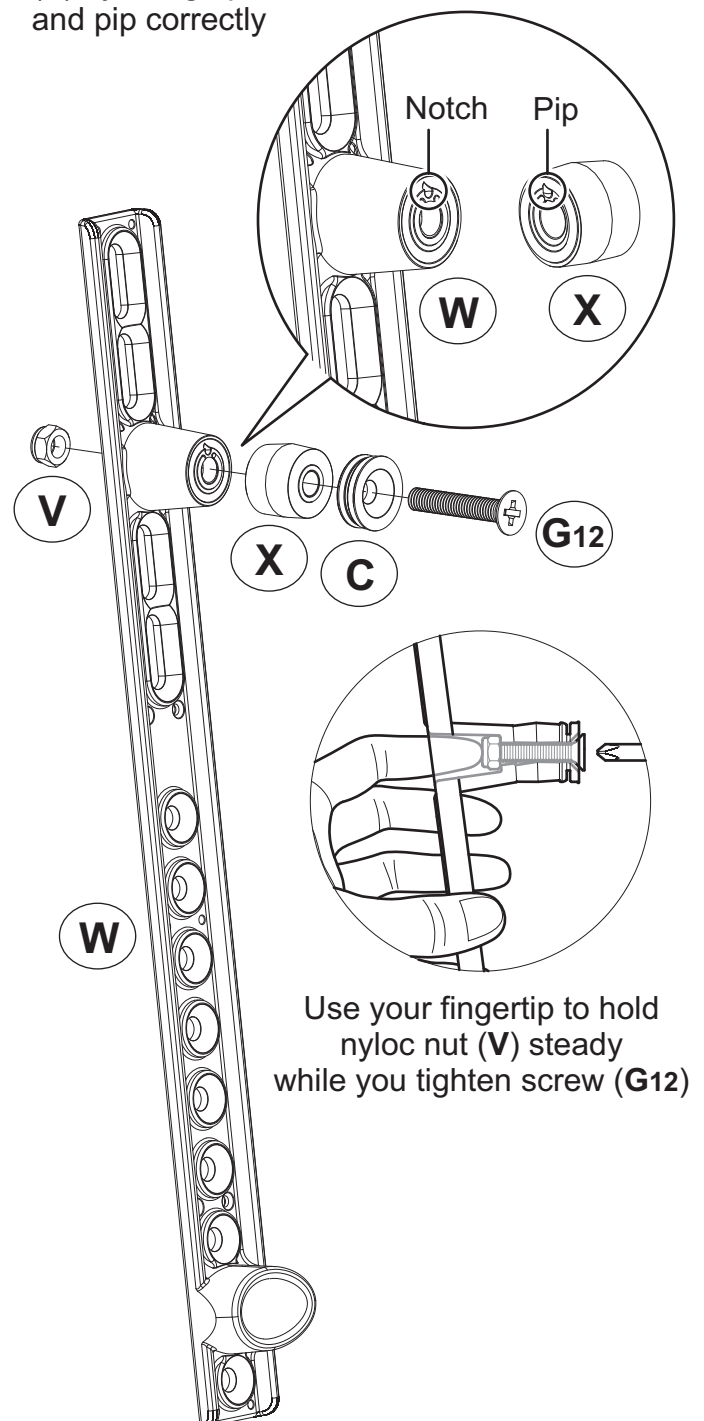

# 13 Assemble Positioning Template

The horizontal part of the positioning template is used to mark out where you need to drill the mounting holes on your wall. The vertical part is just a guide to allow you to see how high up the wall your TV will be to help you find the perfect position for viewing your screen. Thread template (U<sub>2</sub>) through template (U<sub>1</sub>) as shown.

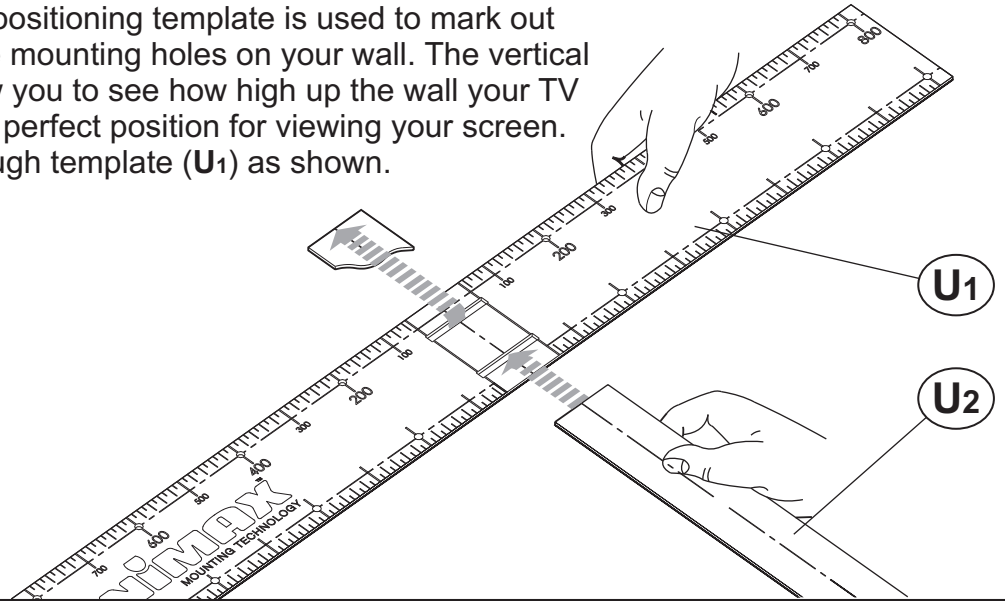

# 14 Determine Bracket Hole Centres

Lay the template on the back of the TV and follow the instructions below.

The centre line of the template represents the centre of your TV.

Line up with top of the screen.

Line up the template with the centre of the screen. Mark off the fixing centres using the **top row** of numbers.

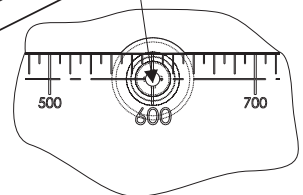
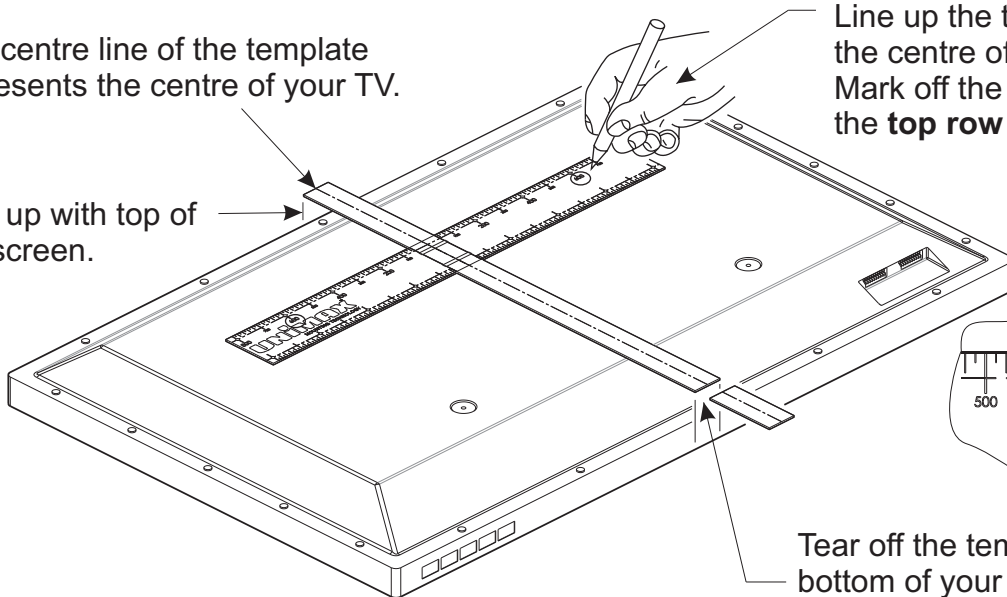

Tear off the template flush with the bottom of your TV so that when the template is on the wall you can see exactly where your TV will be vertically (distance from the floor and ceiling).

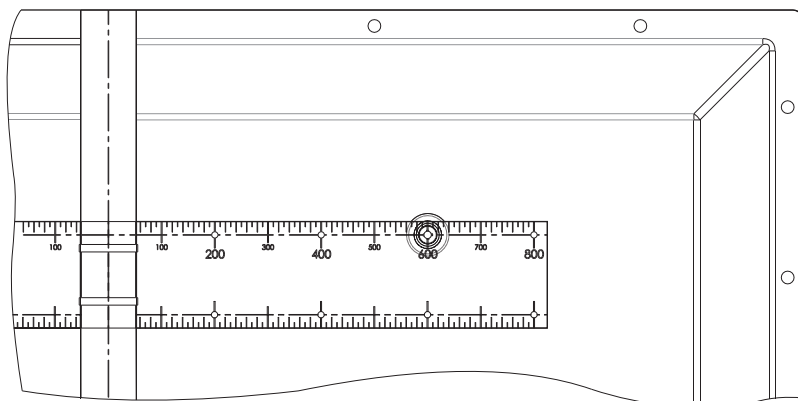

If your screen fixings do not line up with any holes on the template then ensure template is on the centre of the screen, and punch holes to suit your screen fixings centres with a pencil or sharp object.

# 15 Fit Tilt Brackets to TV

Once you have established which screws you need for your TV you can attach Tilt brackets (**W**) to the back of your TV.

Example shown below is only for TV's with a flat back. If your TV has a curved back/obstructions or you require more space for cables and to improve access and ventilation to the back of your TV you will need to add spacers (**E1**), see section 20.

In certain circumstances it may be necessary to use red spacer (**E2**) in addition to the fixings below, for more information see section 20.

If your TV fixing centres don't fit, STOP installation and contact the customer services helpline.

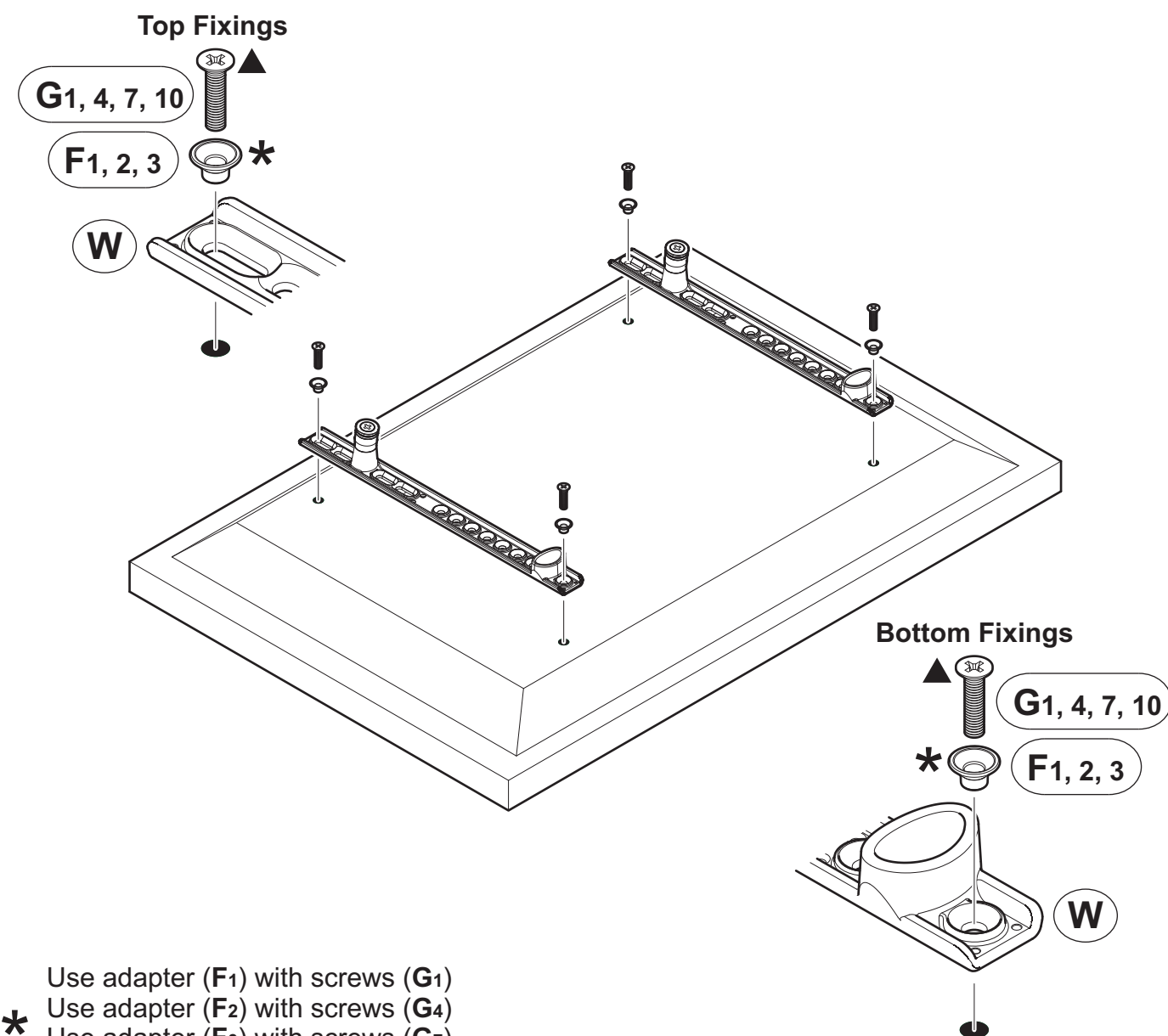

- Use adapter (**F1**) with screws (**G1**)
- \* Use adapter (**F2**) with screws (**G4**)
- Use adapter (**F3**) with screws (**G7**)
- No adapter required with screws (**G10**)

- ▲ If you use screw **G1** for top fixing you must use screw **G1** for bottom fixing
- ▲ If you use screw **G4** for top fixing you must use screw **G4** for bottom fixing
- ▲ If you use screw **G7** for top fixing you must use screw **G7** for bottom fixing
- ▲ If you use screw **G10** for top fixing you must use screw **G10** for bottom fixing

# 16 Marking Wall For Drill Points

Using the marks on the **top row** that you made in step 14 make the same marks on the **bottom row** and use these to mark two points for drilling.

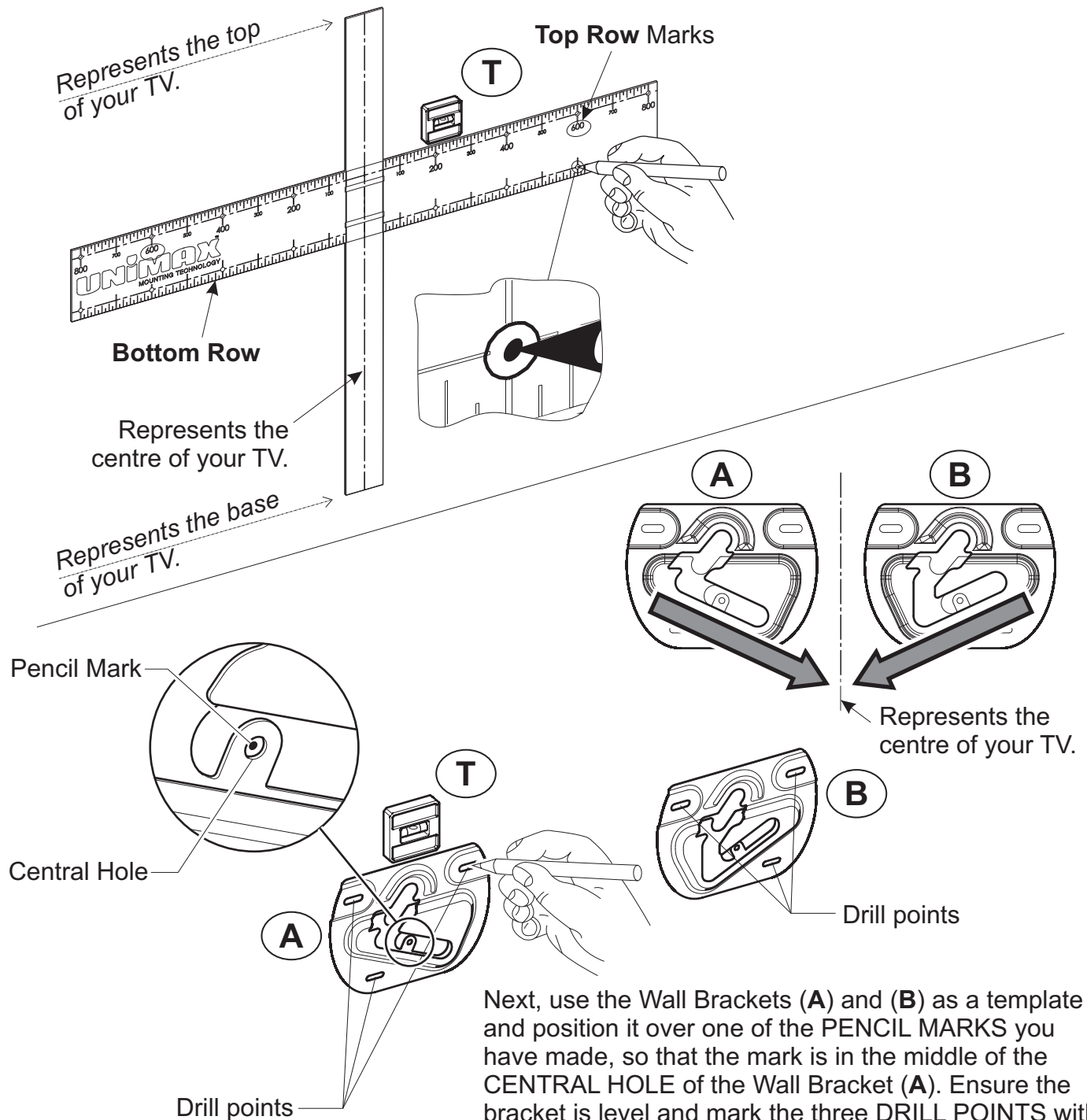

Next, use the Wall Brackets (A) and (B) as a template and position it over one of the PENCIL MARKS you have made, so that the mark is in the middle of the CENTRAL HOLE of the Wall Bracket (A). Ensure the bracket is level and mark the three DRILL POINTS with a pencil. Repeat for both brackets.

# 17 Planning & Preparation

Determine the wall type that you have (See Section 18).

Ensure the drilling area is free from mains services (Gas/Electric/Water).

Drill six 3mm diameter pilot holes to verify the wall type and select the appropriate fixings (See Section 18).



# 18 Install Wall Fixings

Use the correct fixings for your wall type. Mixing fixing types may be required for installations that span different wall types. **DO NOT OVER TIGHTEN SCREWS.**

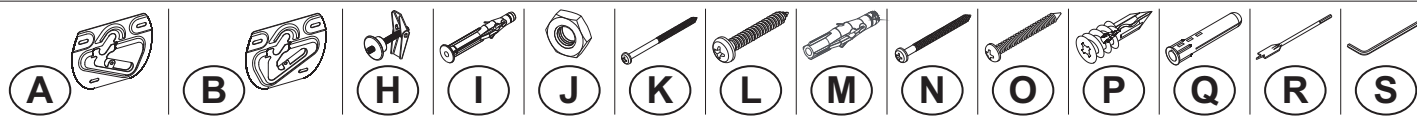

## Solid Wall

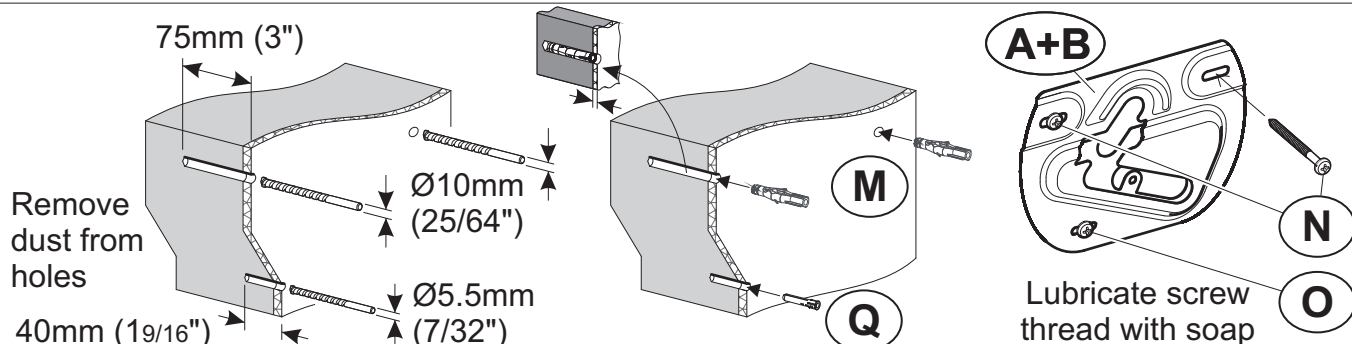

## Dot & Dab

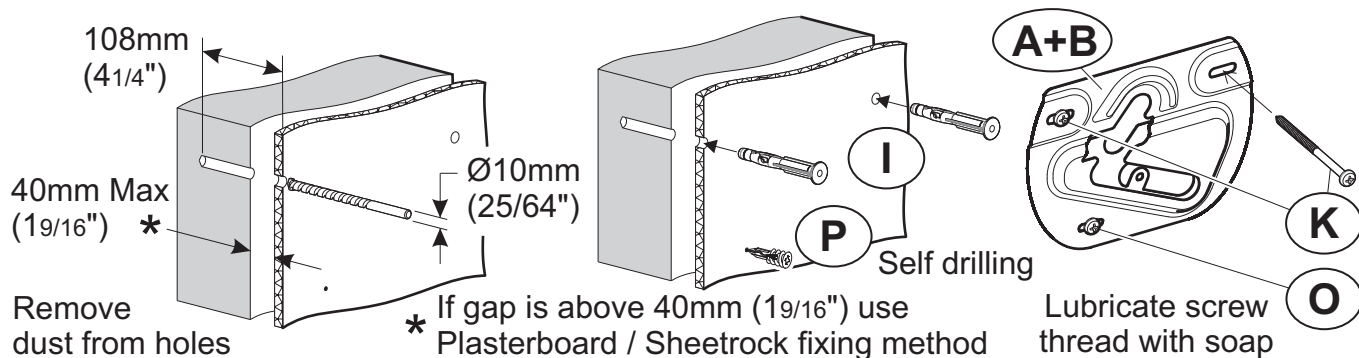

## Plasterboard / Sheetrock

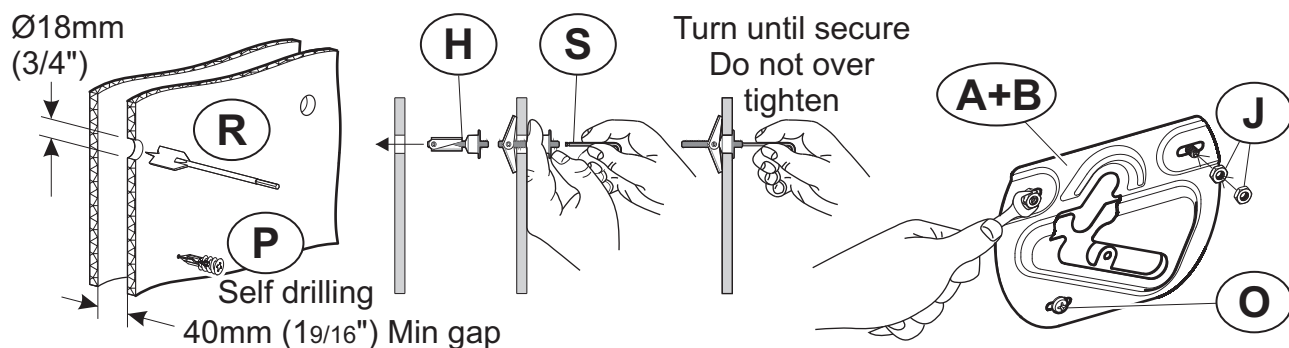

## Wood Stud

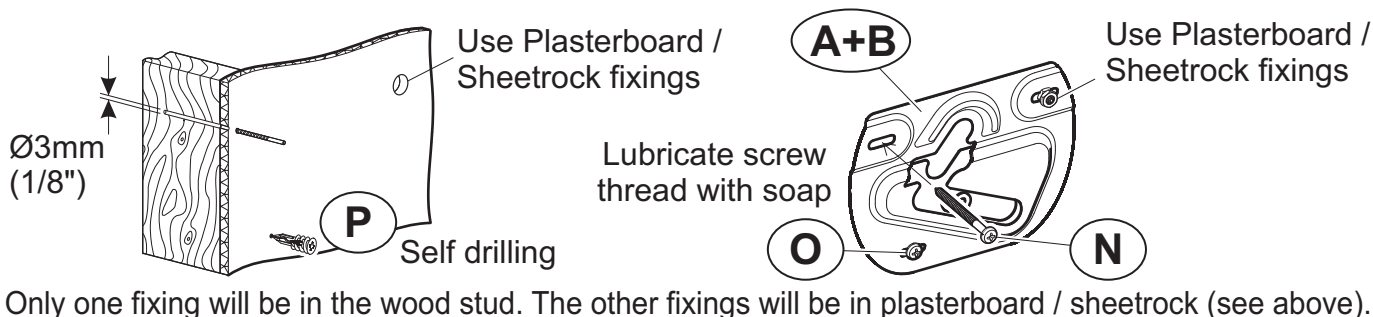

## Metal Stud

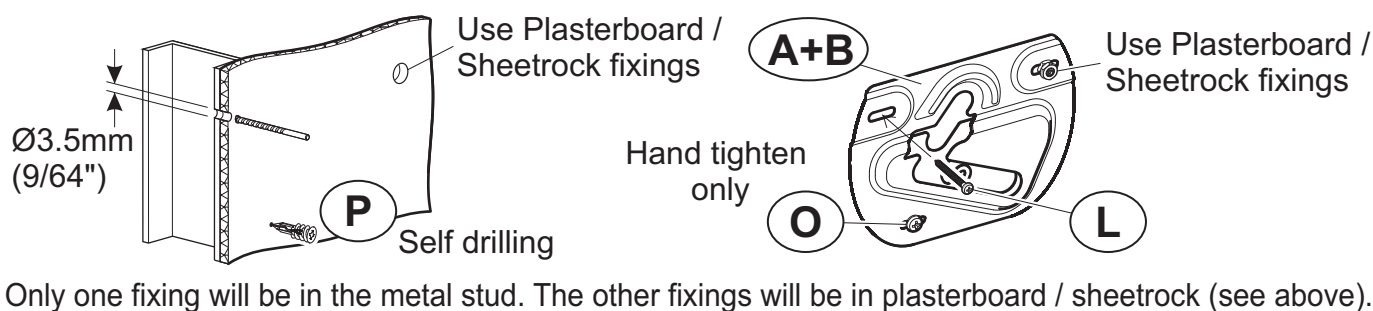



# 19 Hanging The TV

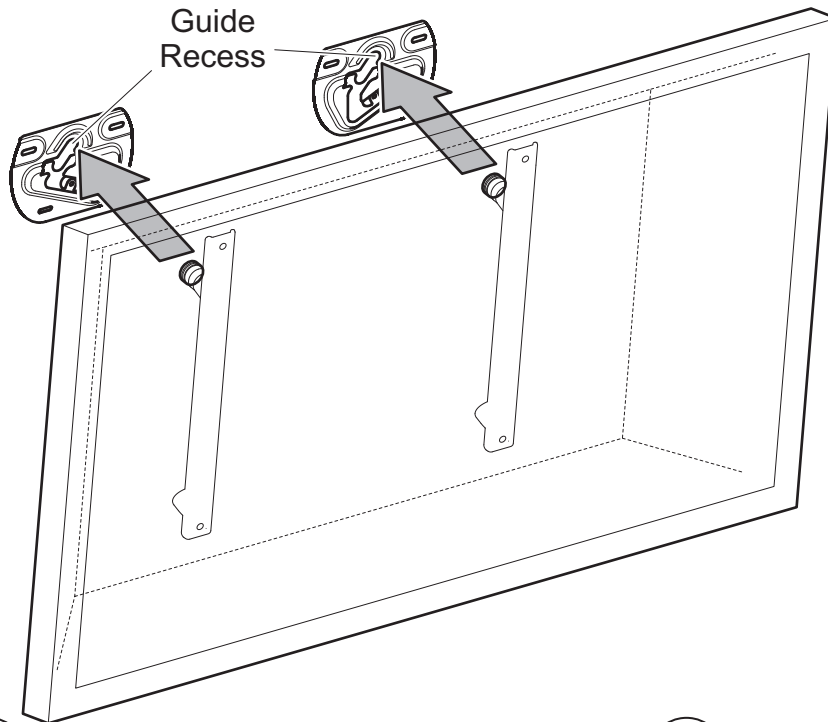

Present the Hangers (on the back of the TV) to the guide recess on the Wall Brackets. Slide down and across into place. Ensure both Hangers are fully engaged. If cables from the TV prevent the TV resting against the wall then an alternative hanger configuration will be required (See Section 20).

I

II

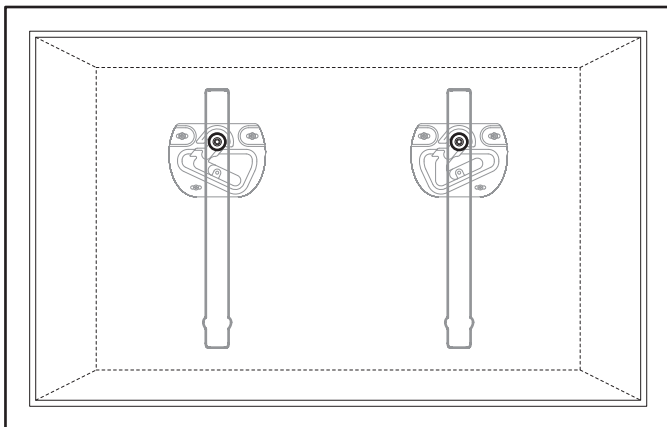

III

IV

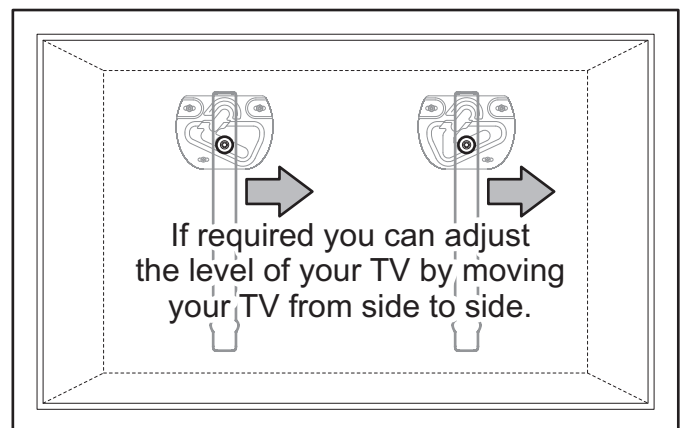
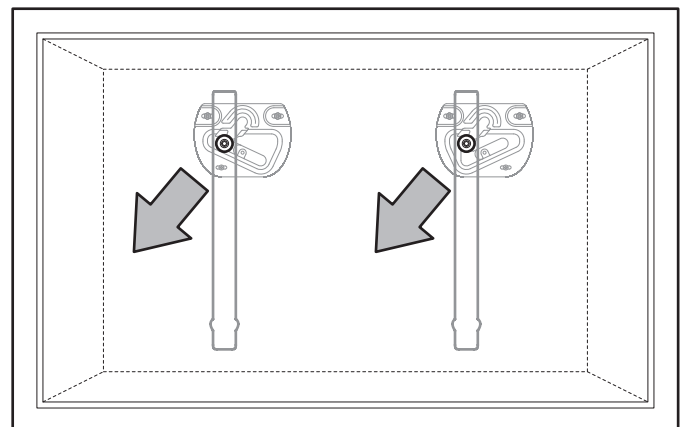

If required you can adjust the level of your TV by moving your TV from side to side.

## Removing the TV

This is a two person job. To remove the TV reverse the movements as shown above.

# 20 Alternative Hanger Configurations

Alternative spacings can be achieved using the spacer / screw combinations shown in this section.

No Spacer Combination  
(as shown in section 13)

**Top Fixings**

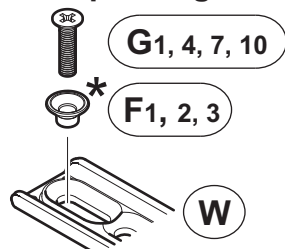

**Bottom Fixings**

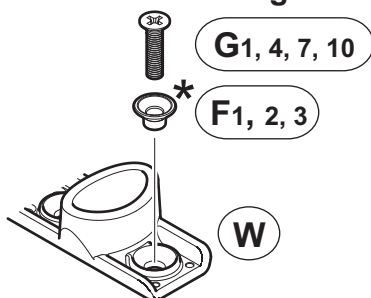

1 Spacer Combination

**Top Fixings**

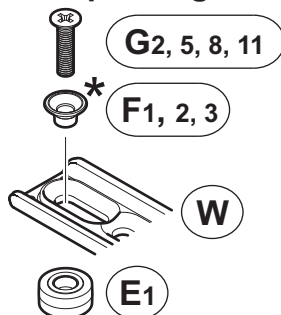

**Bottom Fixings**

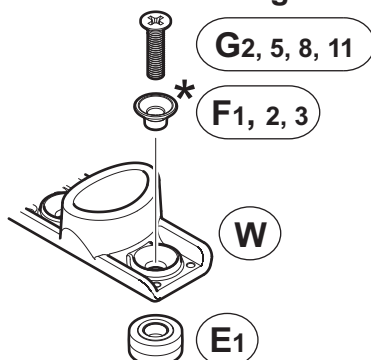

3 Spacer Combination

**Top Fixings**

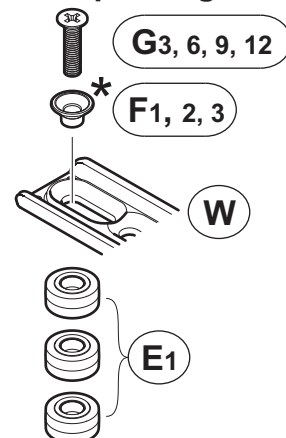

**Bottom Fixings**

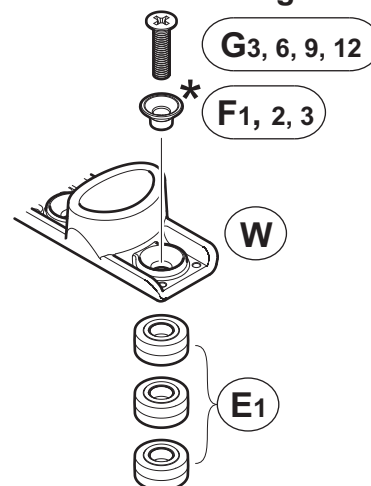

- Use adapter (F1) with screws (G1), (G2) & (G3)
- \* Use adapter (F2) with screws (G4), (G5) & (G6)
- Use adapter (F3) with screws (G7), (G8) & (G9)
- No adapter required with screws (G10), (G11) & (G12)

**When is it necessary to use red spacers?**



**E2** - x4

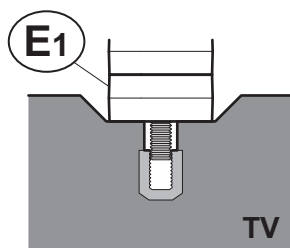

**Problem**

Not enough  
screw engagement

It is recommended that when fitting Tilt Brackets (W) to your TV you have at least 5-10mm of screw engagement. In certain circumstances you may need to use red spacers (E2) as either a replacement, or together with spacers (E1) to achieve this. Whenever you use red spacers (E2) you must use all 4 provided.

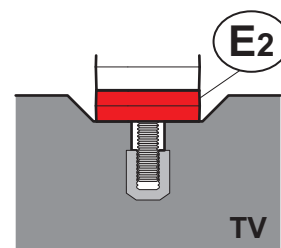

**Solution**

Red spacer (E2) has  
replaced spacer (E1)