

Instructions

472513 Rev00



up to 70" / up to 178 cm



600 x 400 max



70 kg / 154 lb.

Please read these instructions thoroughly before installation.

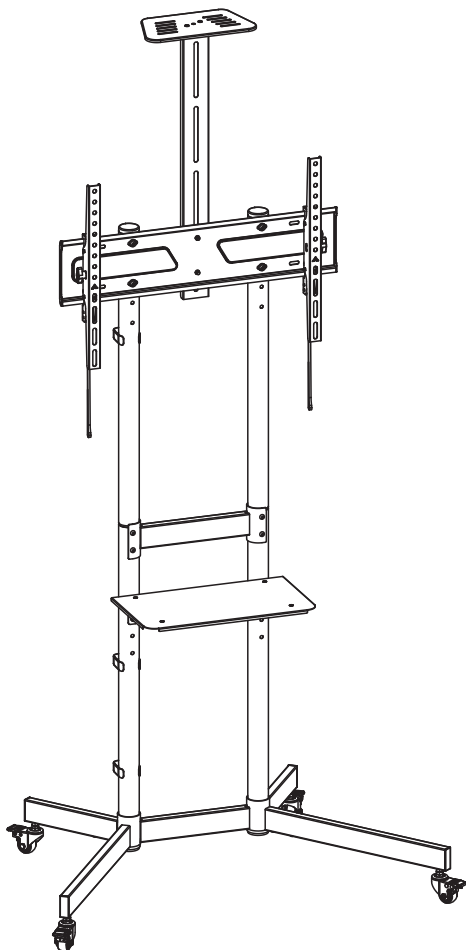

You will need



Customer Helpline



0333 320 0463 (UK)
1-800 667 0808 (USA)

Online Support

[www.avfgroup.com](http://www.avfgroup.com/support)
/support

Parts Included



A
x2



B
x2

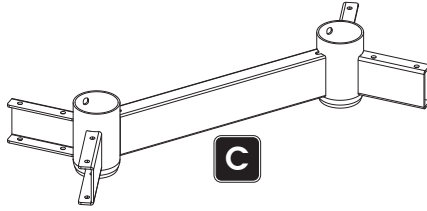

C

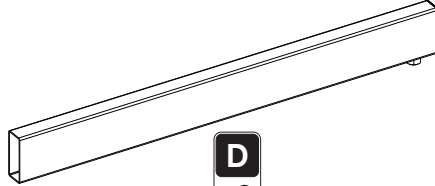

D
x2



E
x2

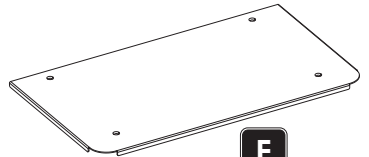

F

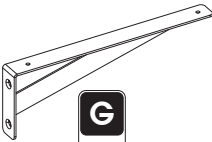

G
x2

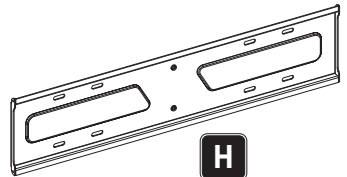

H

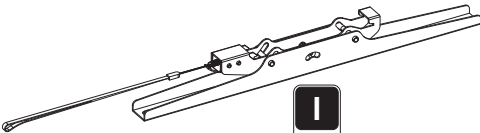

I
x2

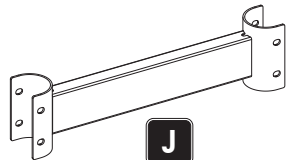

J



K
x3

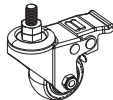

L
x4

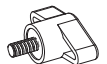

M
x2

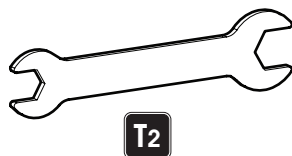
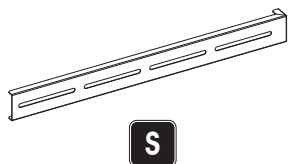
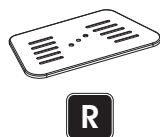
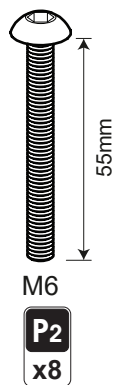

TV Screws, Reducers and Spacers

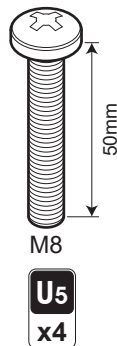
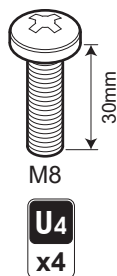
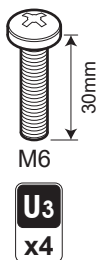
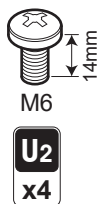

1

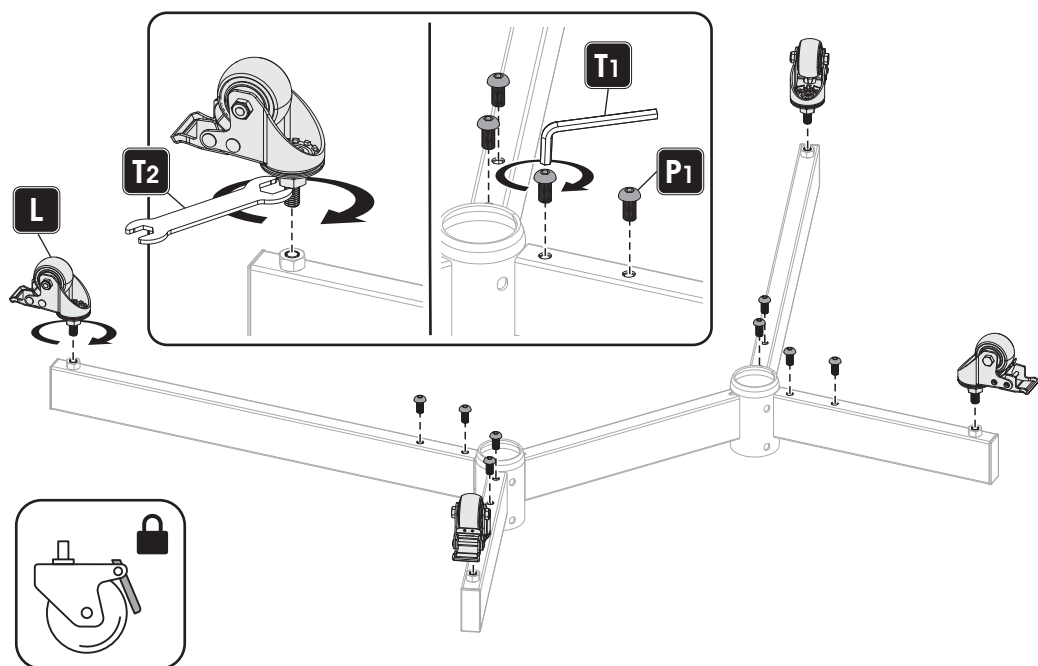
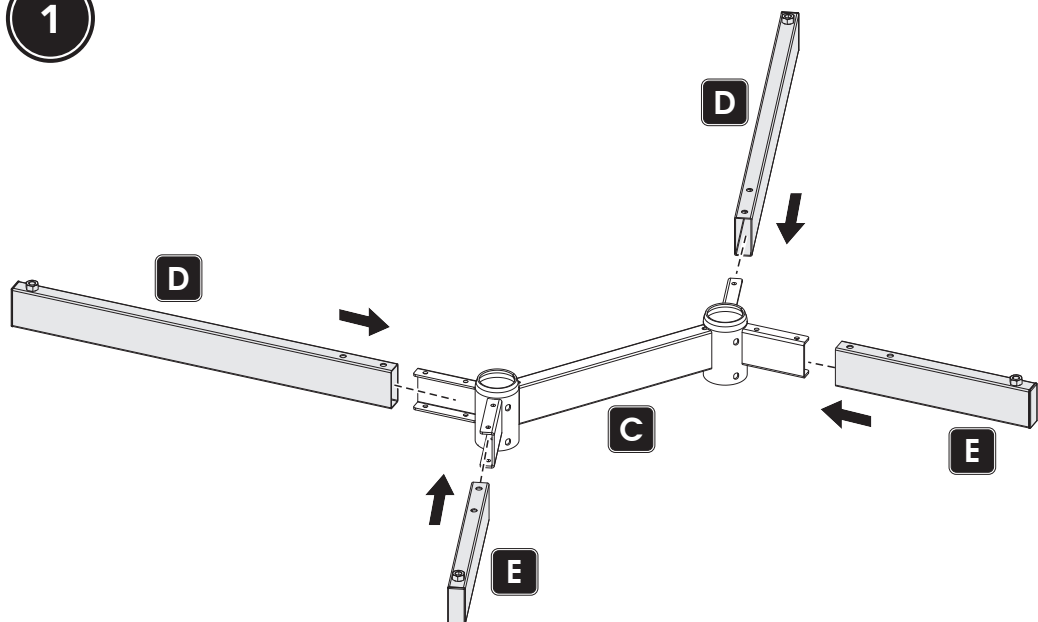

2

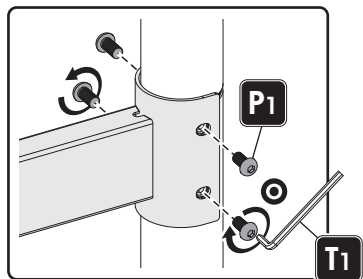
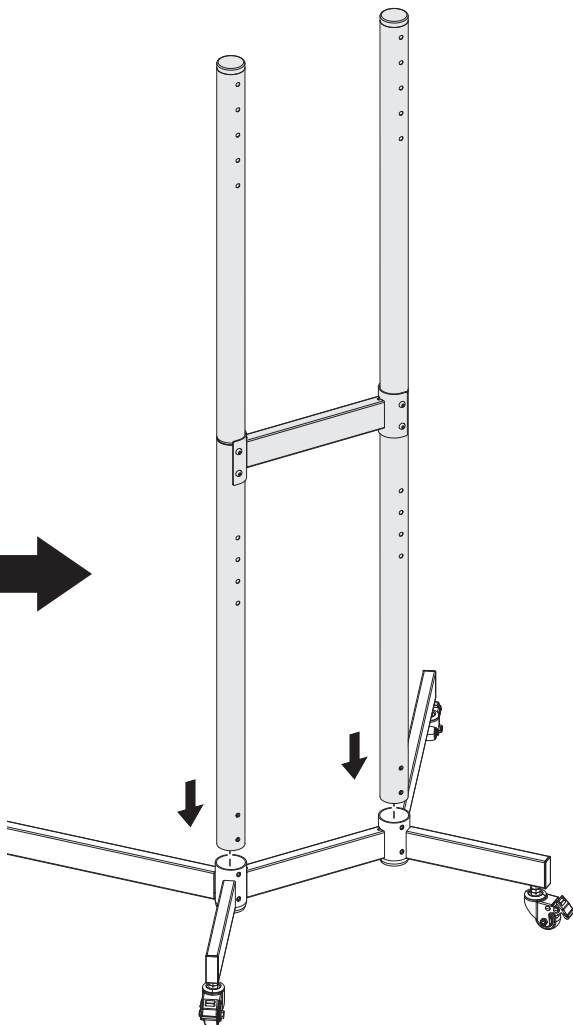
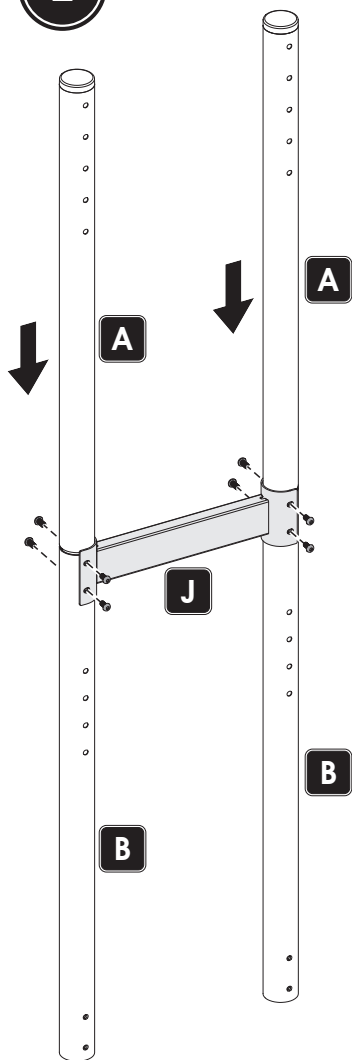

i DO NOT fully tighten

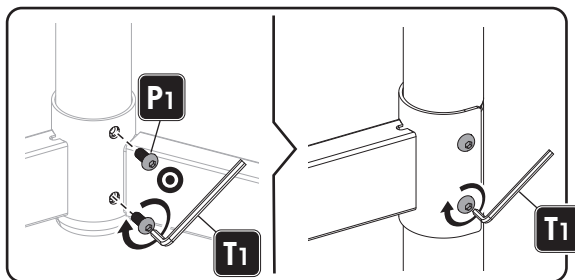

i When the columns are secured to the base, fully tighten the crossbar.

3

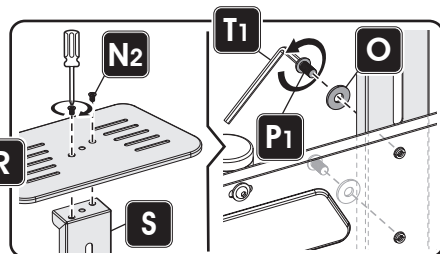
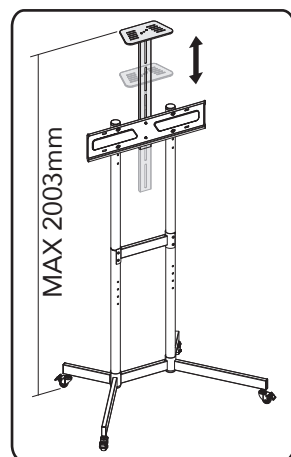
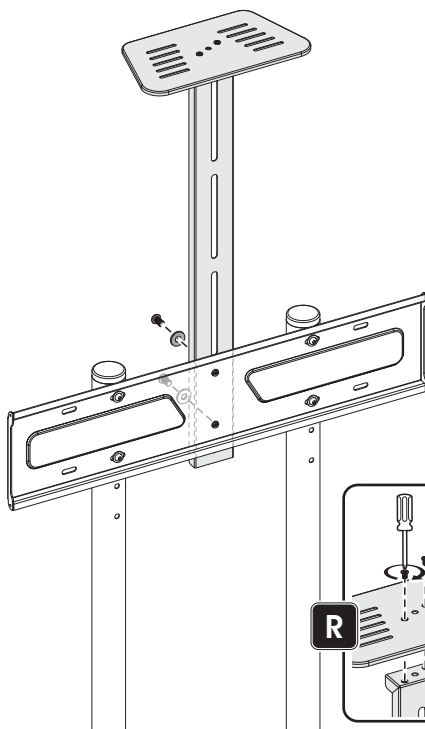
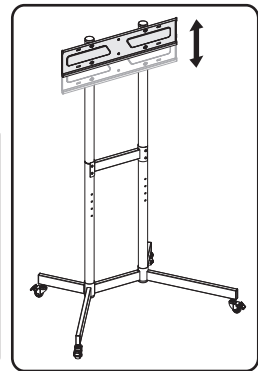
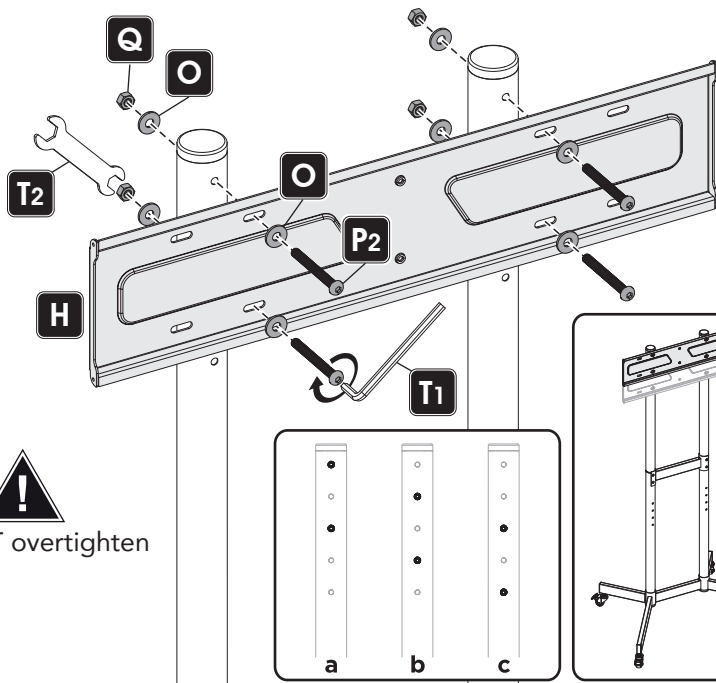

4

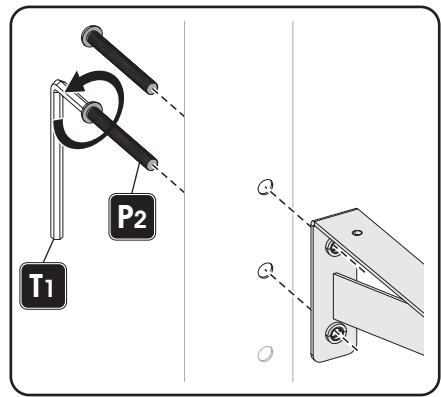

i DO NOT fully tighten

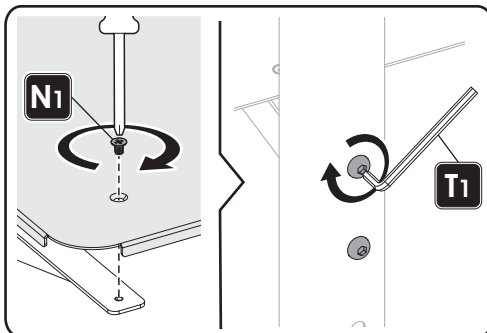
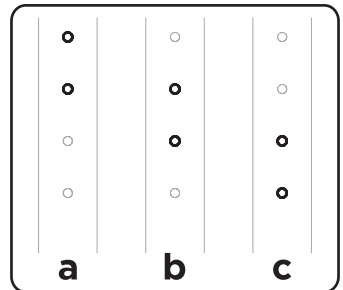
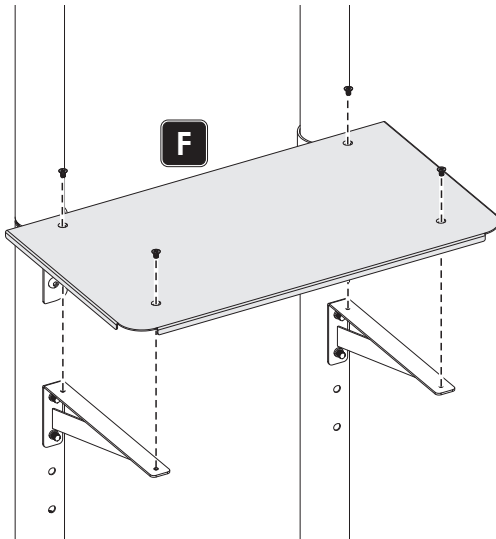

i When the shelf is secured, fully tighten the screws holding the shelf support arms.

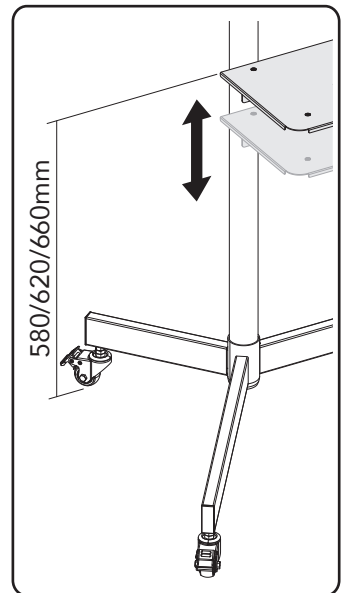

5

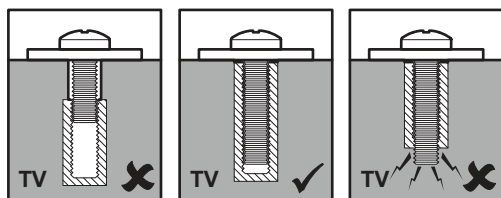
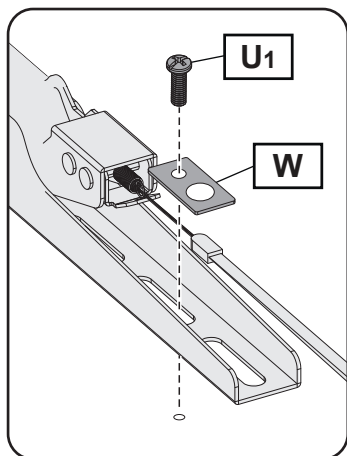

U1 to U5

Select the correct screw to fit your TV.

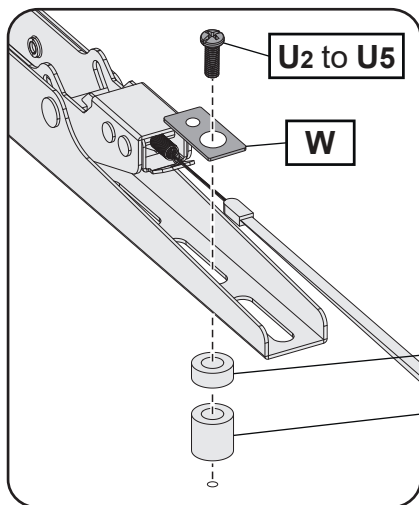
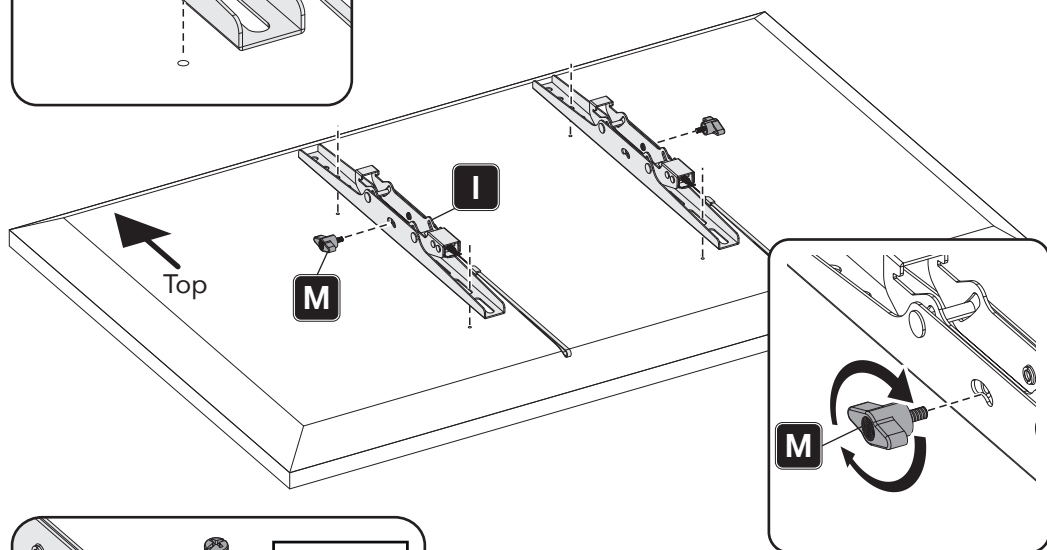

You may need to use Spacers **V1** or **V2** if the screws are too long or the back of your TV is not flat.

V1

V2

If required

6

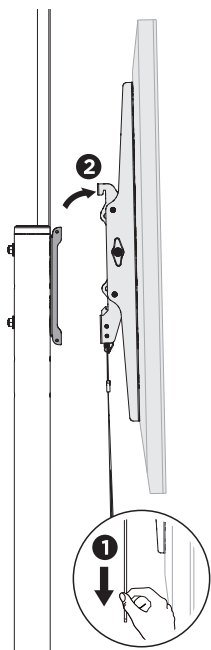
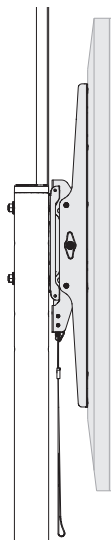
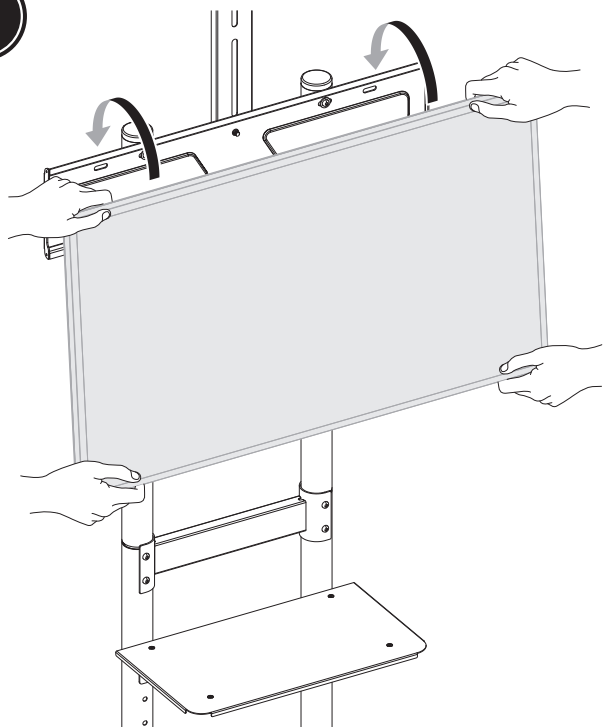

To remove the TV first pull the release cords then lift the TV clear of the mounting plate.

7



If the caster doesn't touch the ground loosen the lower nut, adjust the caster and then tighten the upper nut.

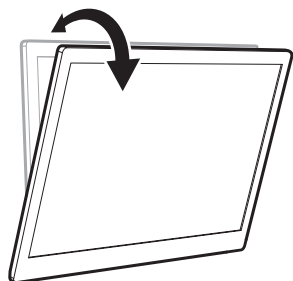
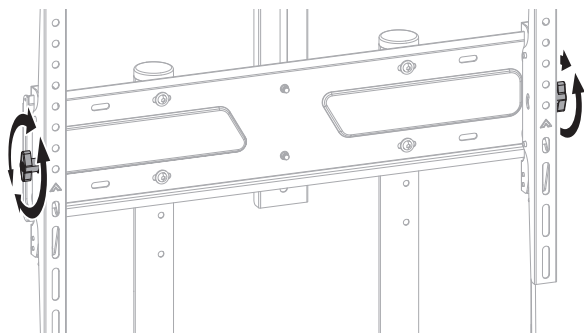
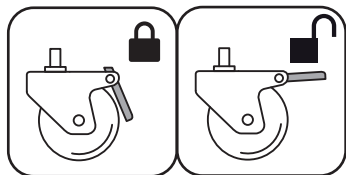
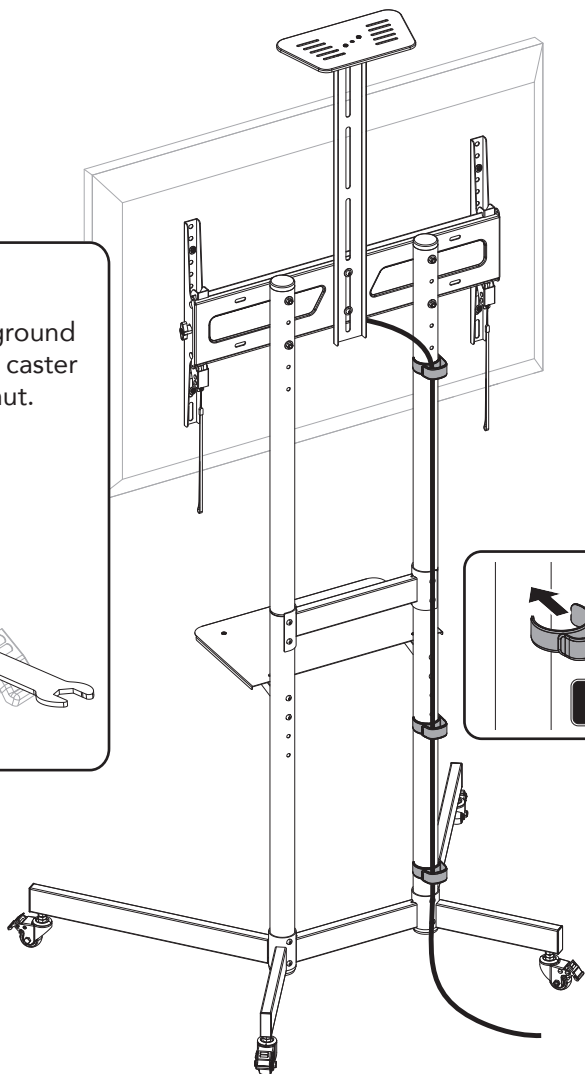
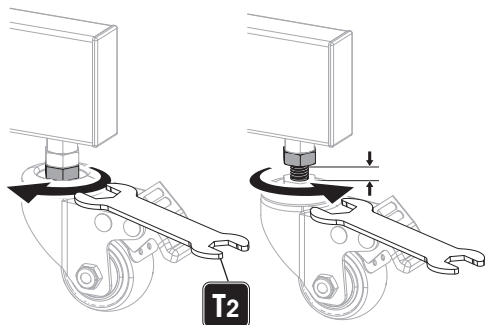

Loosen the knob to adjust the display to the desired angle. Tighten the knob to secure.

10 YEAR WARRANTY

AVF warrants that the product is free from defects in material and workmanship, as long as the product is owned by the original consumer purchaser. If, during the stated warranty of this product, it proves to be defective, AVF will remedy the defect by either repairing or replacing the defective part or, replacing the entire product. Proof of original purchase is required and should be retained.

AVF reserve the right to substitute replacement products to others of similar value and design (Usually in the event of discontinued product models).

AVF accept no responsibility for failures / loss which result from misuse, negligence, accident, improper assembly or installation or other causes beyond AVF's reasonable control and also excludes and will not pay any incidental and consequential damages.



PLEASE REVIEW ALL NOTES AND PRODUCT INSTRUCTIONS BEFORE COMMENCING THE INSTALLATION.

INSTALLATION: This product is sold as a home DIY product and as such, it is the responsibility of the installer to ensure that the product is correctly installed. AVF accept no responsibility if the product is incorrectly installed.

This product is intended for indoor use only. Use of this product outdoors could lead to failure and personal injury.

IF YOU ARE IN ANY DOUBT, CONSULT A QUALIFIED CONTRACTOR.

NOTES

DO

- Retain all packaging in case the mount needs to be returned.
- Check the strength of the installation before fitting the TV.
- Periodically check strength of installation, signs of corrosion, damage or loose components.
- Make sure the supporting surface will safely support the combined weight of the product and all attached hardware and components.

DON'T

- Do not over tighten screws.
- Do not use with products heavier than the maximum weight rating indicated as this may result in instability and cause possible injury.

TV HANGING

Must be carried out using the manufacturers threaded holes intended for this purpose. All variables of TV hanging screws are supplied within the product box (Because of the universal nature of this product, expect to have excess parts left over following your installation).

It is the responsibility of the installer to ensure the correct TV hanging screws are selected. If in doubt consult the TV manufacturer. AVF accept no responsibility for any damage caused by the use of the incorrect TV hanging screw or the use of incorrect fixing holes.