

472510 Rev02

Please read these instructions thoroughly before installation.

You will need

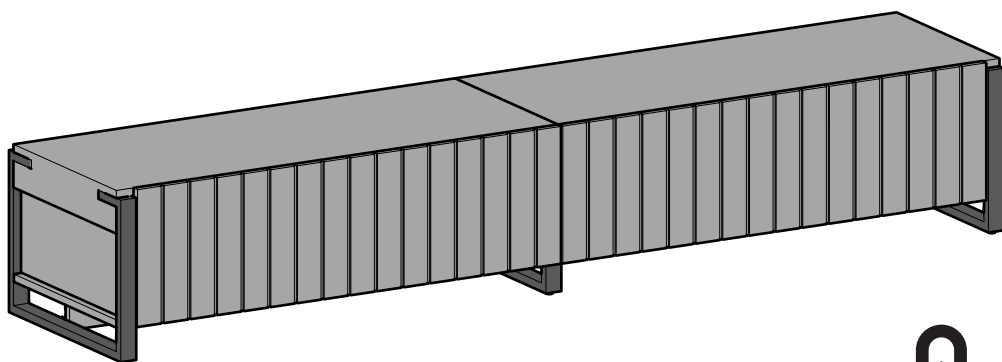

**100kg
220lb**

Helpline



0333 320 0463 (UK)

1300 762 219 (Australia)

(+64) 9 306 1020 (New Zealand)

UK - AVF Group Ltd. Hortonwood 30, Telford, Shropshire, TF1 7YE, England

Australia - Arisit P/L · 40-50 Mark Anthony Drive · Dandenong · South Victoria · 3175

IMPORTANT INFORMATION!

We advise that before starting the assembly of this product that you familiarise yourself with the instructions and the parts list in this leaflet.

Do not's

Do not overtighten any part of this assembly.

Do not place hot or cold objects on to or next to any wood surface unless the object is sufficiently insulated to prevent contact.

Do not strike the wood with hard or pointed items.

Do not sit, stand or climb upon any part of this furniture.

Do not use washing powders or other substances containing abrasives when cleaning the wood.

Do's

Do use a soft cloth with a suitable furniture polish when cleaning wooden panels.

Check all nuts and bolts from time to time.

Be careful when moving the unit and try to avoid any stress on the centre of the unit.

Maximum TV weight and shelf capacities

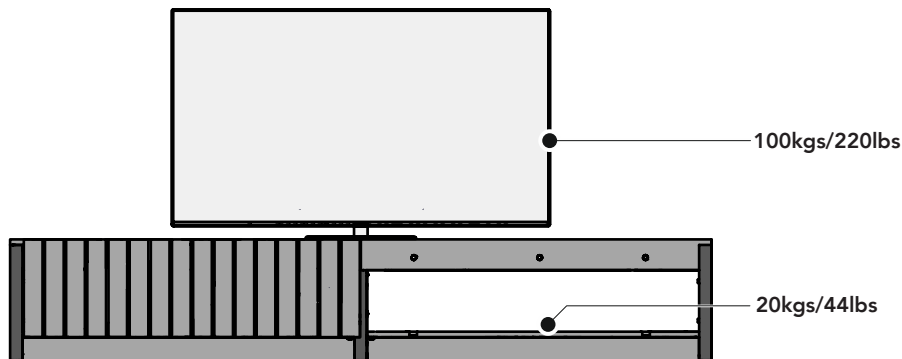

WARNING: Wherever possible distribute weight evenly.

 WARNING	
	
<p>Children have died from furniture tipover.</p> <ul style="list-style-type: none">• NEVER allow children to stand, climb or hang on drawers, doors, or shelves.• ALWAYS secure your television with an anchor device or mount the television on a wall. <p>Ask staff for more information or visit https://www.productsafety.gov.au</p>	

Boxed Parts

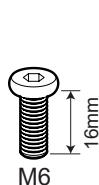
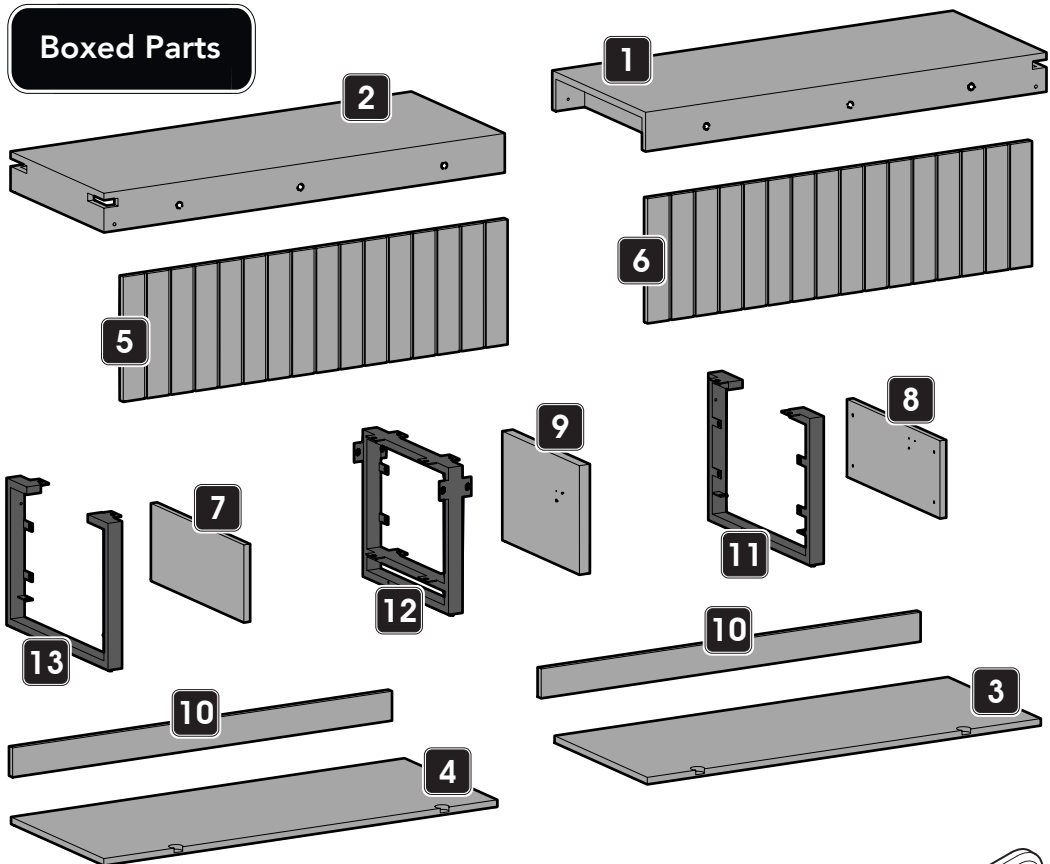

A
x52

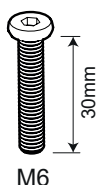

B
x4



C
x56

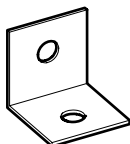

D
x6

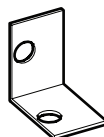

E
x4

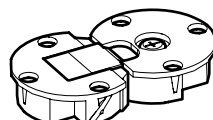

F
x4



G
x1

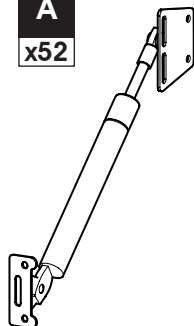

H
x4



I
x56



J
x8

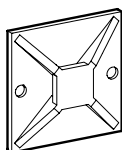

K
x8



L
x4



M
x8

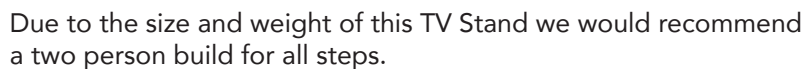

1



When assembling, place a piece of material under the wooden top to prevent any damage.

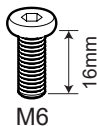

M6

A

x8



C

x8



4mm

G

x1

2

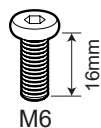
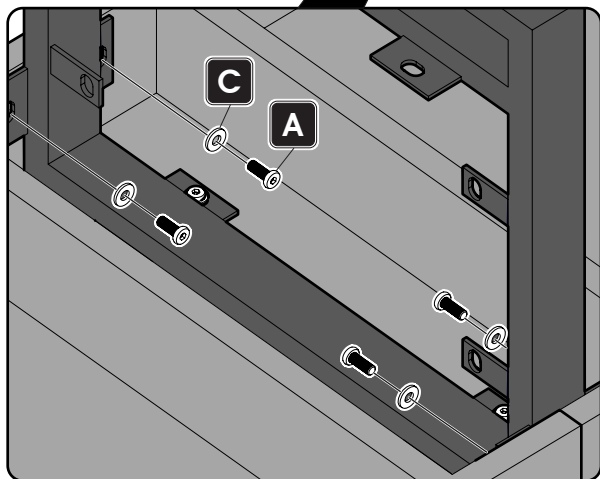
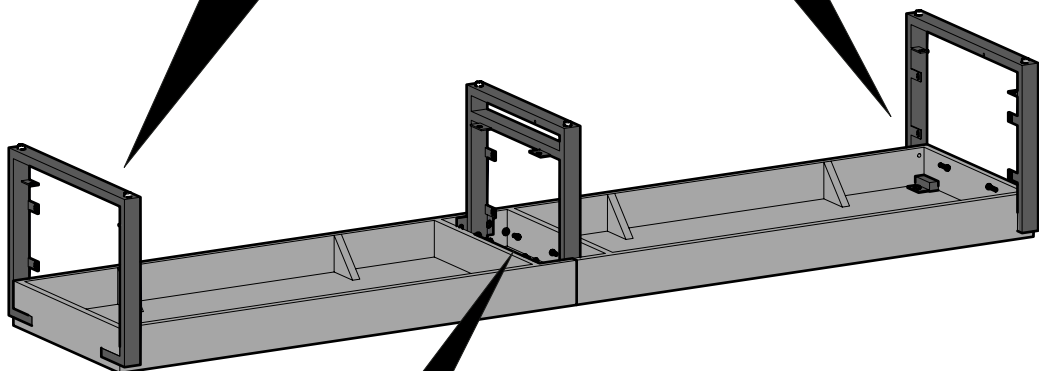
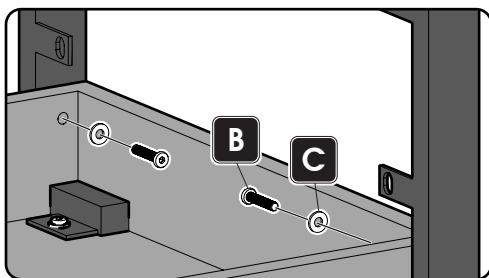
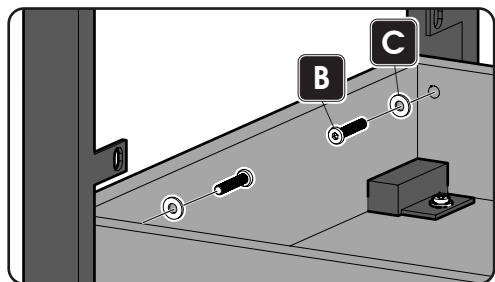

A
x4



C
x8

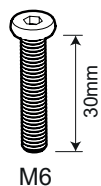

B
x4



G
x1

3

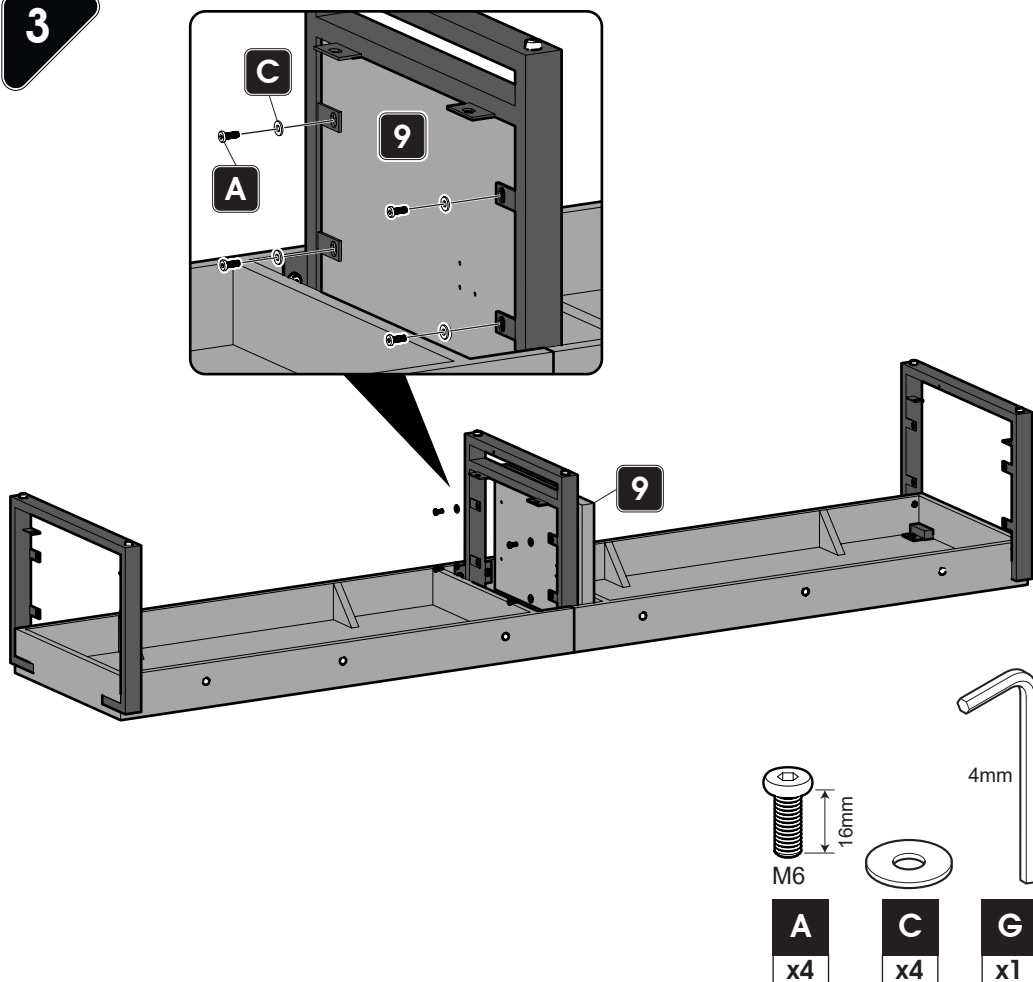

4



Remove screw and mounting plate before assembly.
Keep in a safe place until Steps 10 and 11.

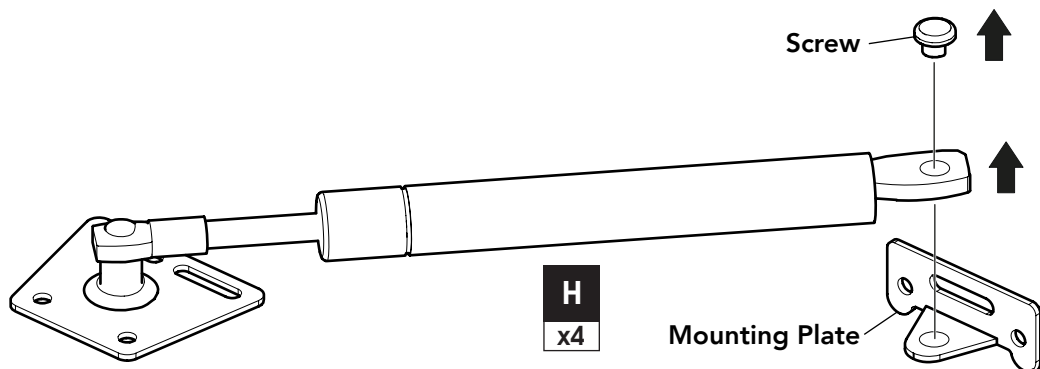

5

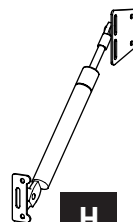
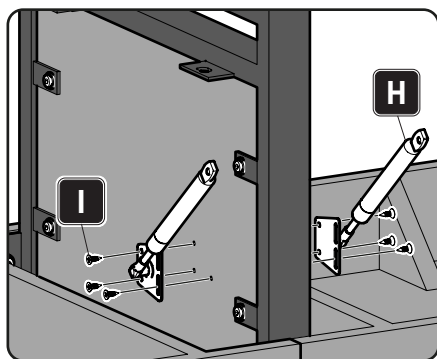

H
x2



I
x6

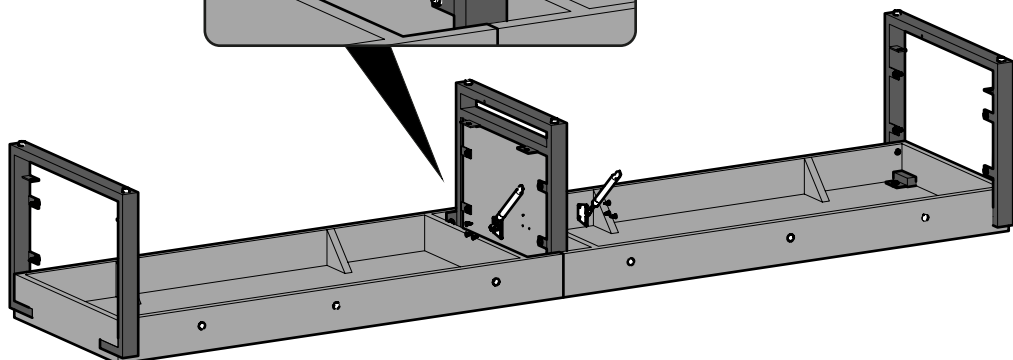

6

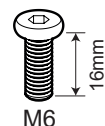
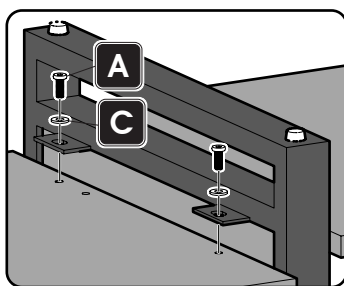
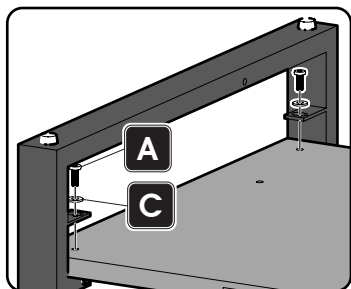

16mm

M6

A
x8



4mm



C
x8

G
x1

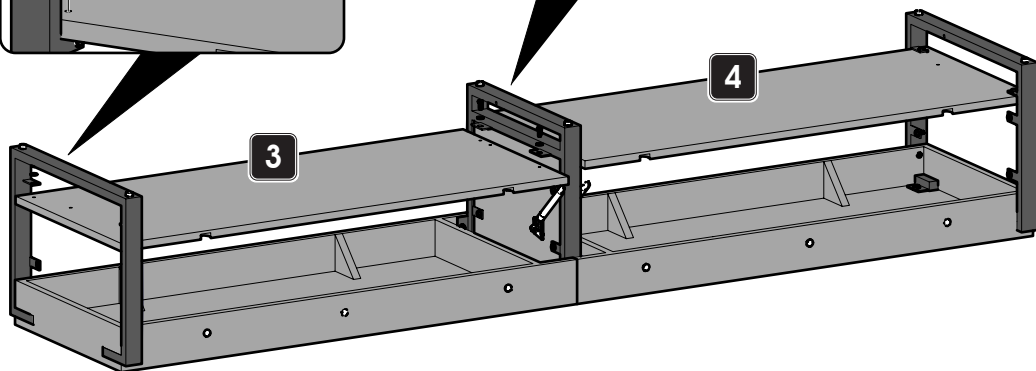

7



Leave screws loose until all screws are in place. Then fully tighten.

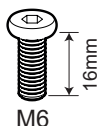
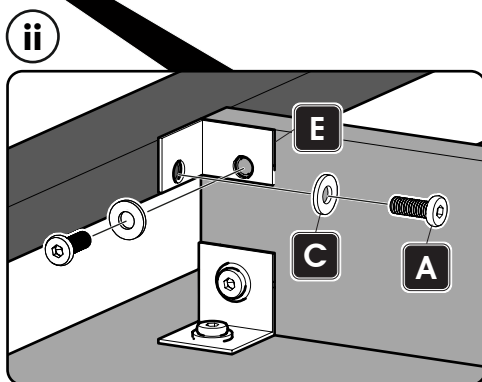
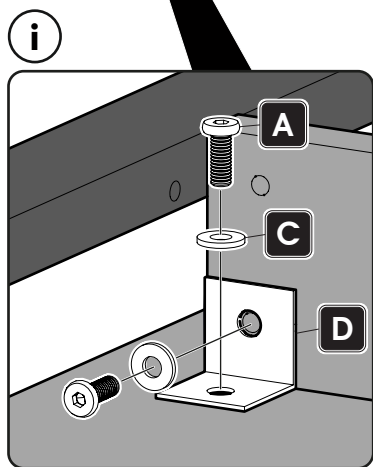
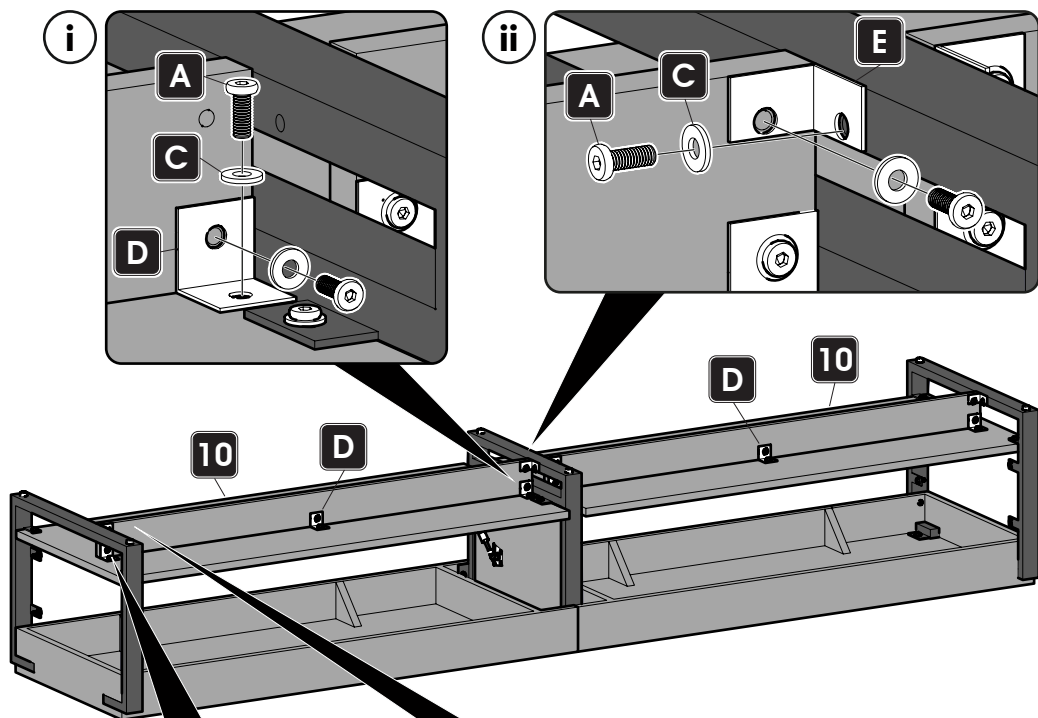

A
x20



C
x20

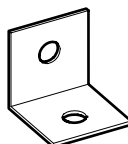

D
x6

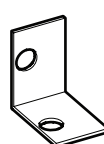

E
x4



G
x1

8

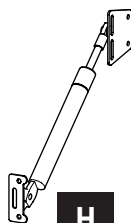
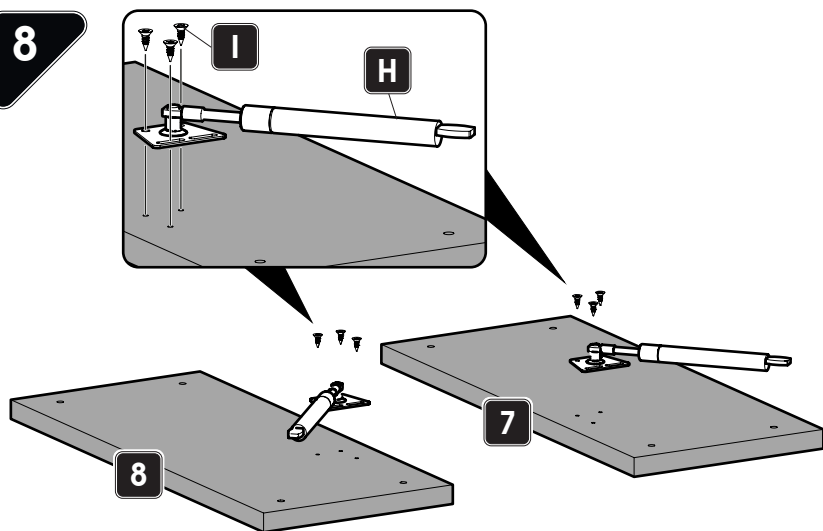

H

x2



I

x6

9

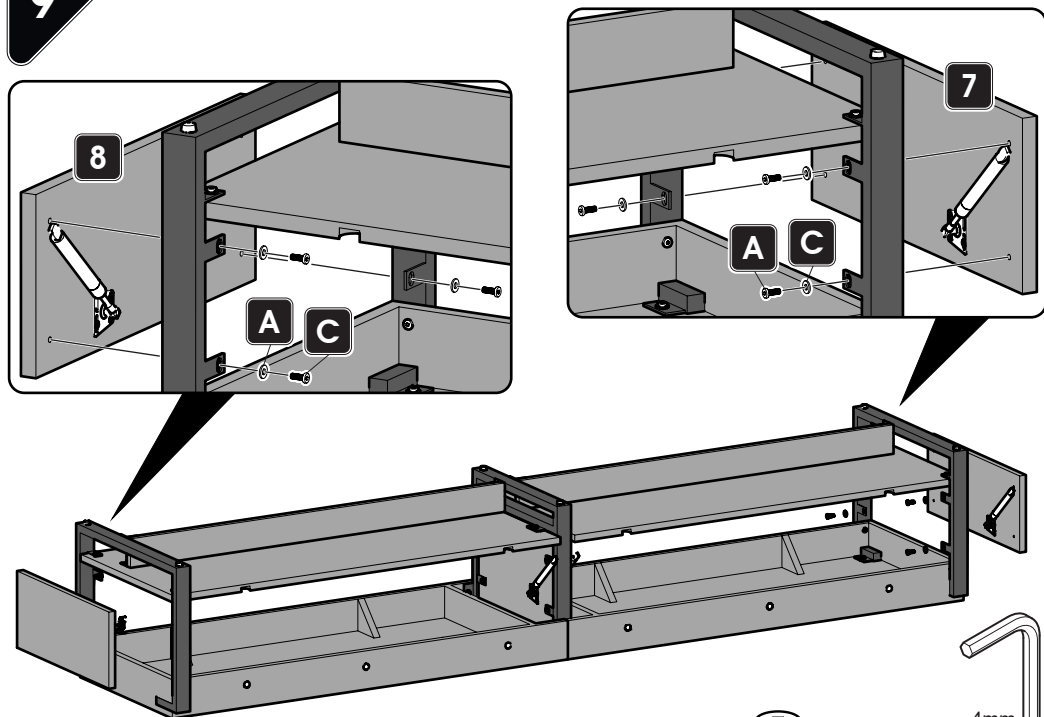

7

8

A

C

A

C

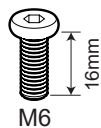

M6

A

x8



C

x8



4mm

G

x1

10



Fit the mounting plate removed from H at Step 4.

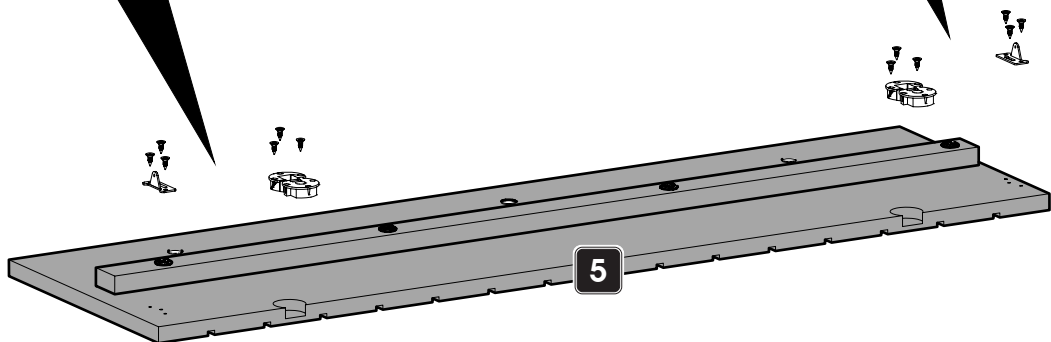
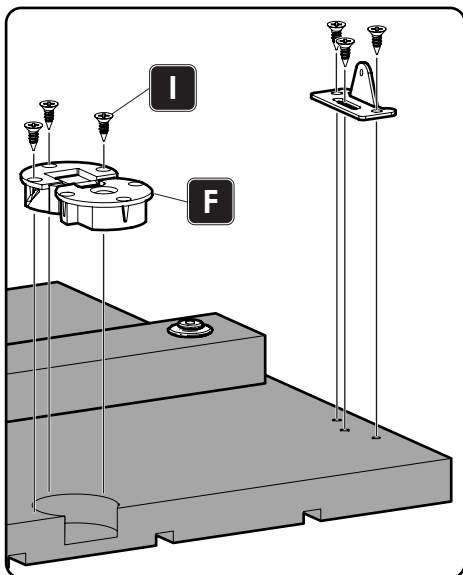
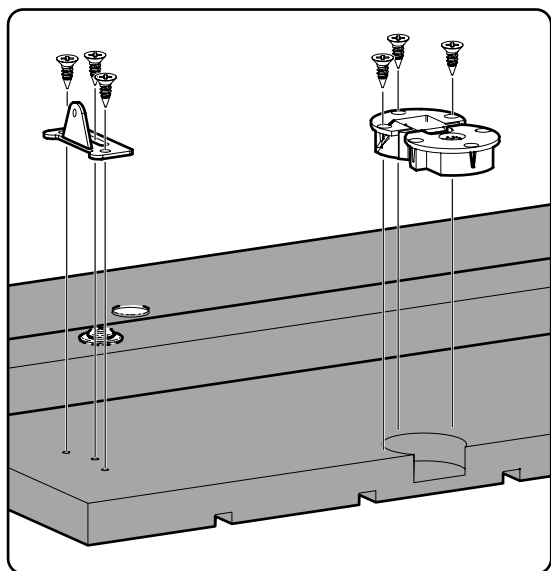

Repeat the process for door 6.



I
x24

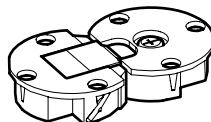

F
x4

11



Support the weight of both doors until all four door stays (Part H) have been connected to the doors.



Use the screw removed from H at Step 4.

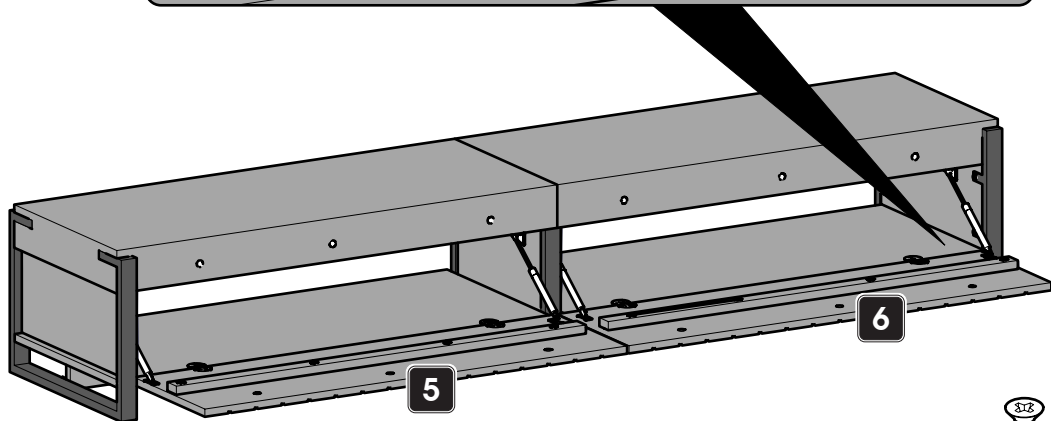
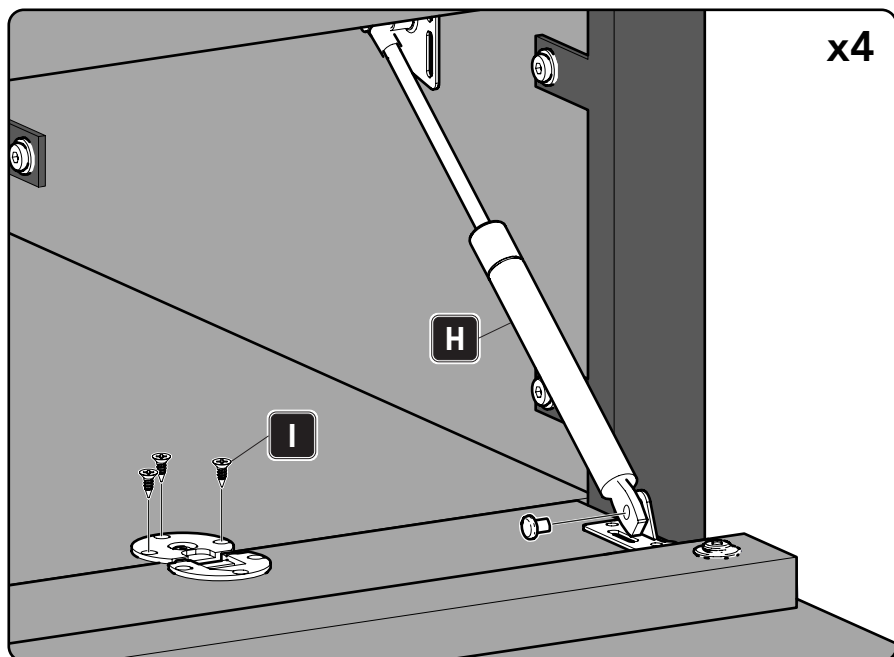

If the doors don't close properly or don't align fully, adjust the door hinge alignment screws small amounts until they do.



I
x12

Securing to a wall

