

# 472510 Rev00

Please read these instructions thoroughly before installation.

## You will need

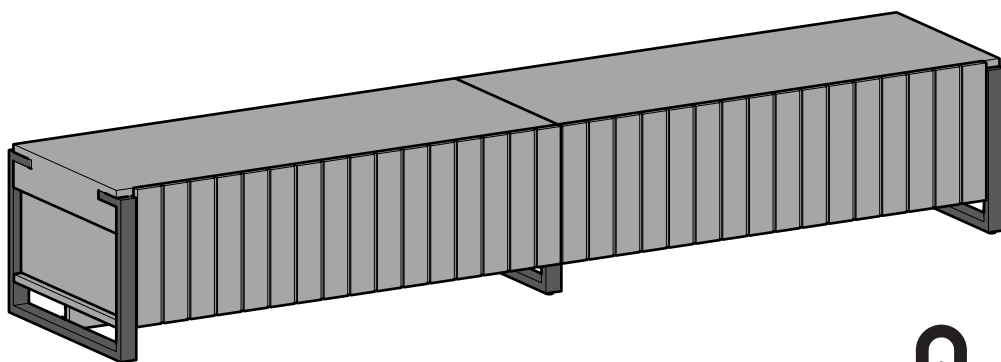

100kg  
220lb

## Helpline



0333 320 0463 (UK)

1300 762 219 (Australia)

(09) 9302 0077 (New Zealand)

**UK** - AVF Group Ltd. Hortonwood 30, Telford, Shropshire, TF1 7YE, England  
**Australia** - Arisit P/L · 40-50 Mark Anthony Drive · Dandenong · South Victoria · 3175  
**New Zealand** - Arisit P/L · 1a Howe Street · Newton · Auckland · 1145 · New Zealand

## IMPORTANT INFORMATION!

We advise that before starting the assembly of this product that you familiarise yourself with the instructions and the parts list in this leaflet.

### Do not's

Do not overtighten any part of this assembly.

Do not place hot or cold objects on to or next to any wood surface unless the object is sufficiently insulated to prevent contact.

Do not strike the wood with hard or pointed items.

Do not sit, stand or climb upon any part of this furniture.

Do not use washing powders or other substances containing abrasives when cleaning the wood.

### Do's

Do use a soft cloth with a suitable furniture polish when cleaning wooden panels.

Check all nuts and bolts from time to time.

Be careful when moving the unit and try to avoid any stress on the centre of the unit.

## Maximum TV weight and shelf capacities

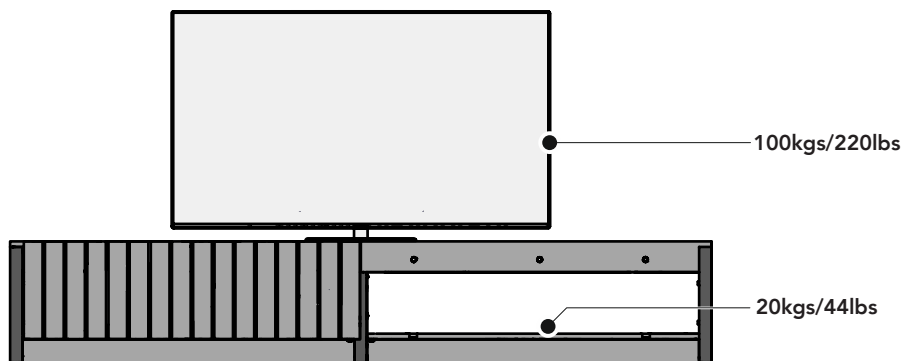

**WARNING:** Wherever possible distribute weight evenly.

 <b>WARNING</b>	
	
<p><b>Children have died from furniture tipover.</b></p> <ul style="list-style-type: none"><li>• NEVER allow children to stand, climb or hang on drawers, doors, or shelves.</li><li>• ALWAYS secure your television with an anchor device or mount the television on a wall.</li></ul> <p>Ask staff for more information or visit <a href="https://www.productsafety.gov.au">https://www.productsafety.gov.au</a></p>	

## Boxed Parts

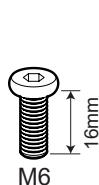
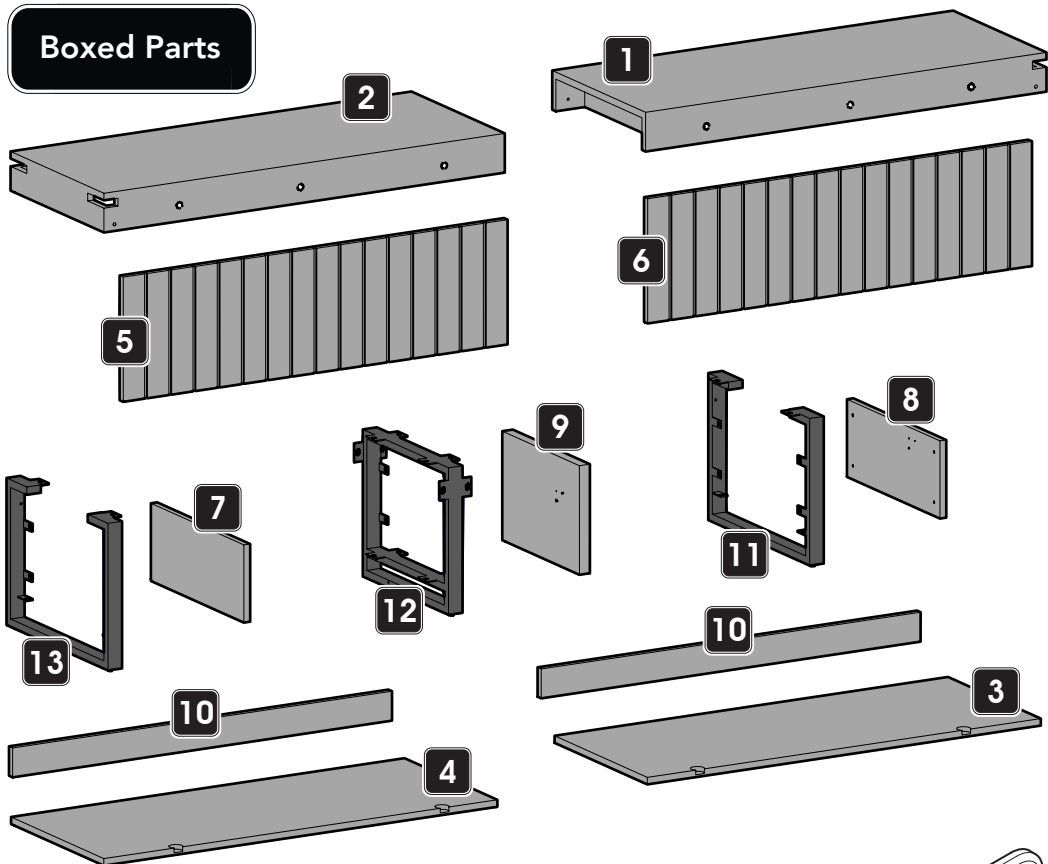

**A**  
x52

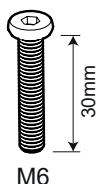

**B**  
x4



**C**  
x56

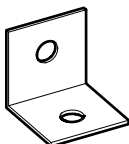

**D**  
x6

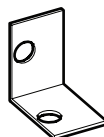

**E**  
x4

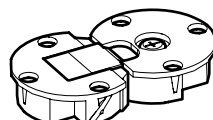

**F**  
x4



**G**  
x1

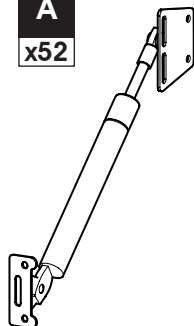

**H**  
x4



**I**  
x56



**J**  
x8

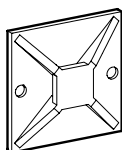

**K**  
x8



**L**  
x4



**M**  
x8



Due to the size and weight of this TV Stand we would recommend a two person build for all steps.

1



When assembling, place a piece of material under the wooden top to prevent any damage.

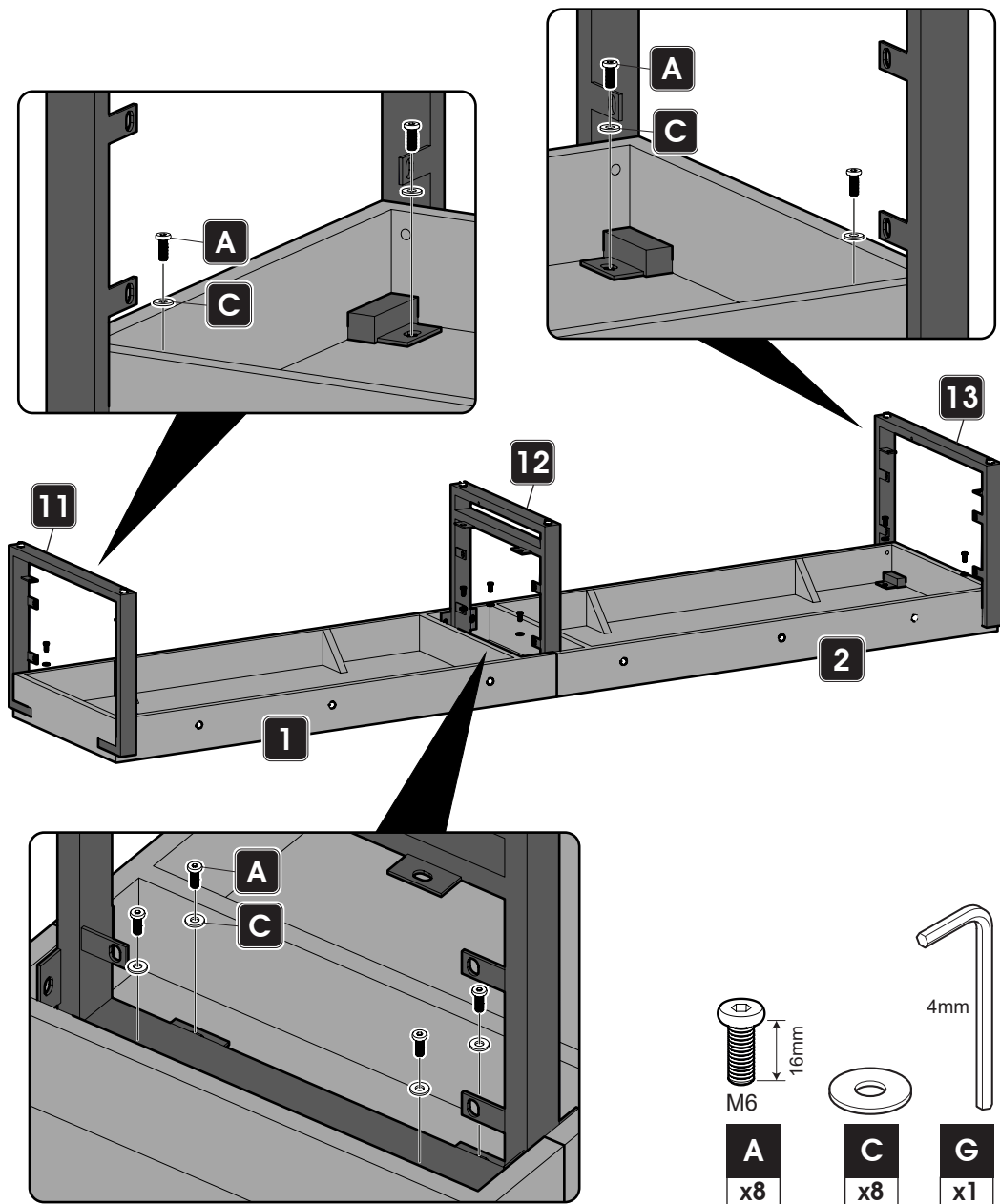

2

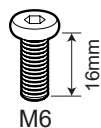
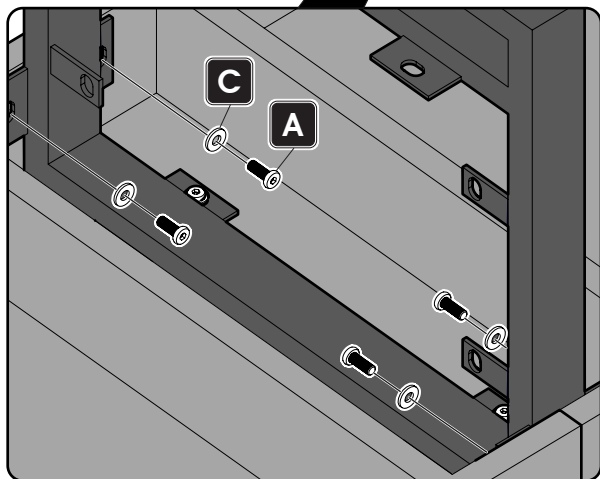
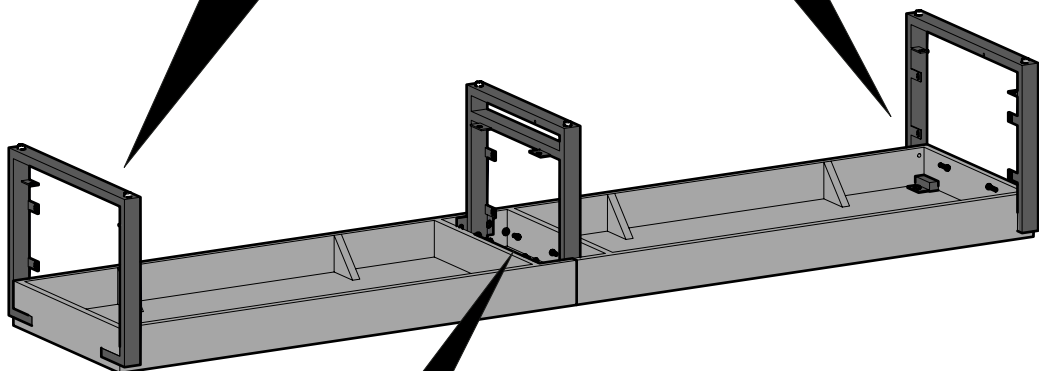
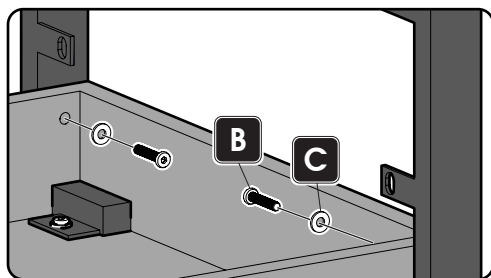
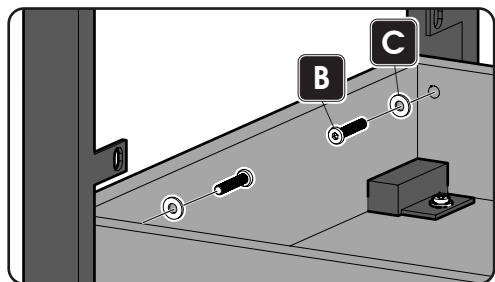

**A**  
x4



**C**  
x8

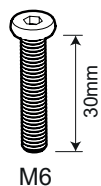

**B**  
x4



**G**  
x1

3

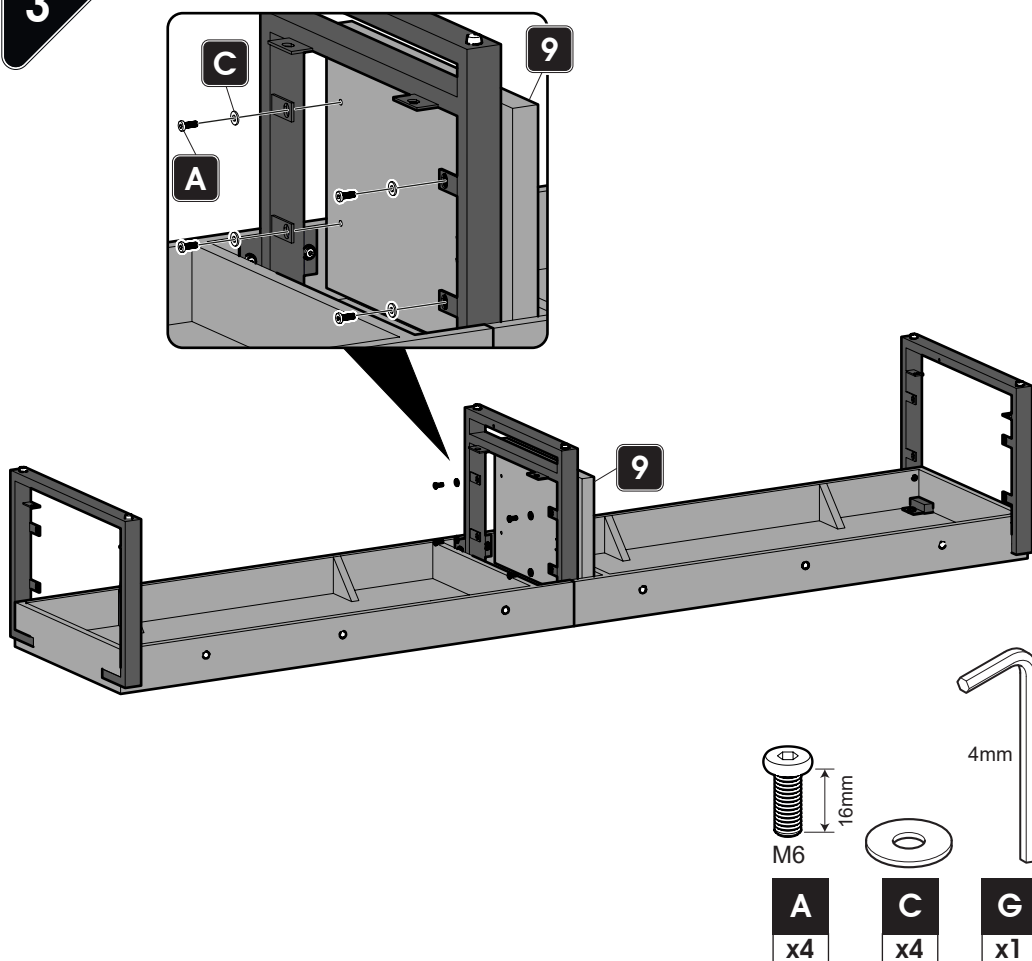

4



Remove screw and mounting plate before assembly.  
Keep in a safe place until Steps 9 and 10.

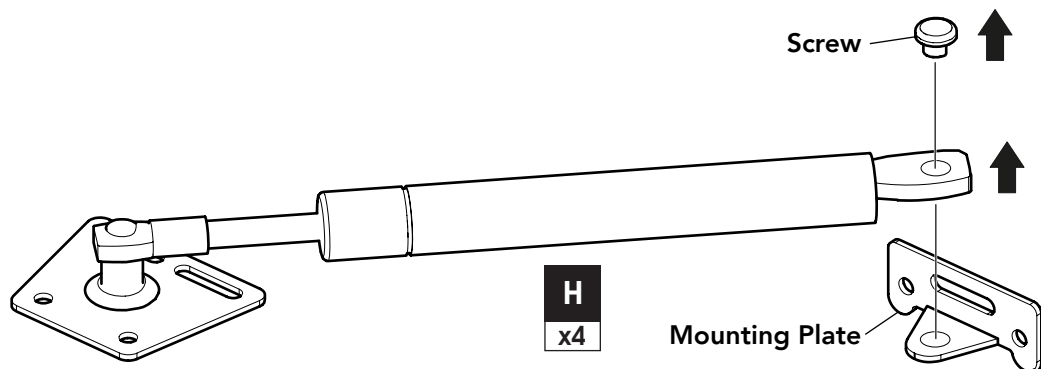

5

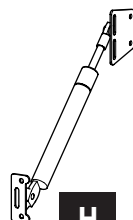
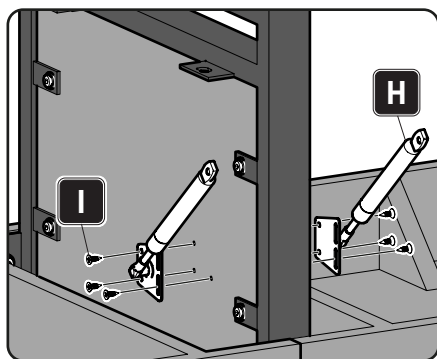

H  
x2



I  
x6

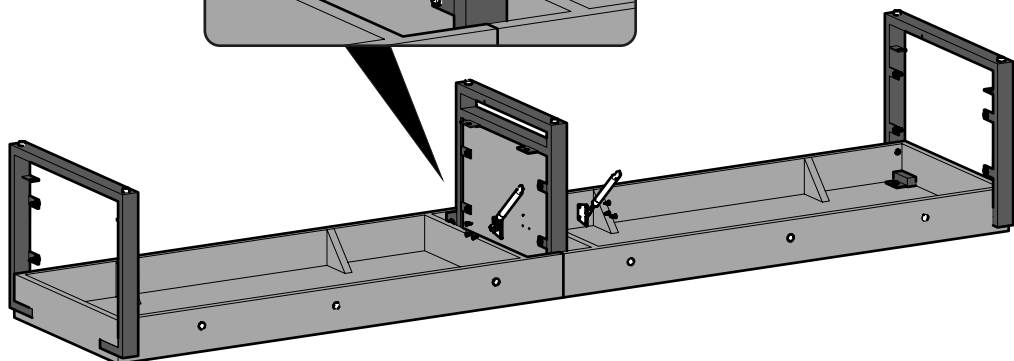

6

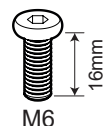
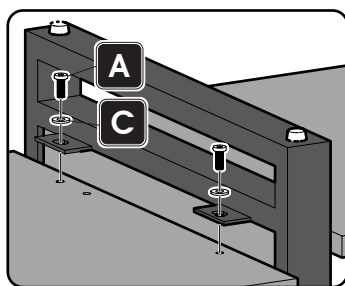
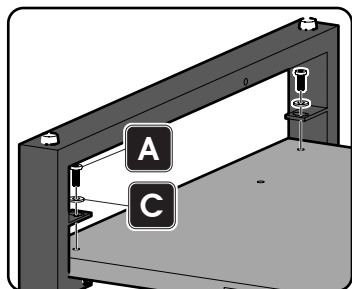

16mm

M6

A  
x8



4mm



C  
x8

G  
x1

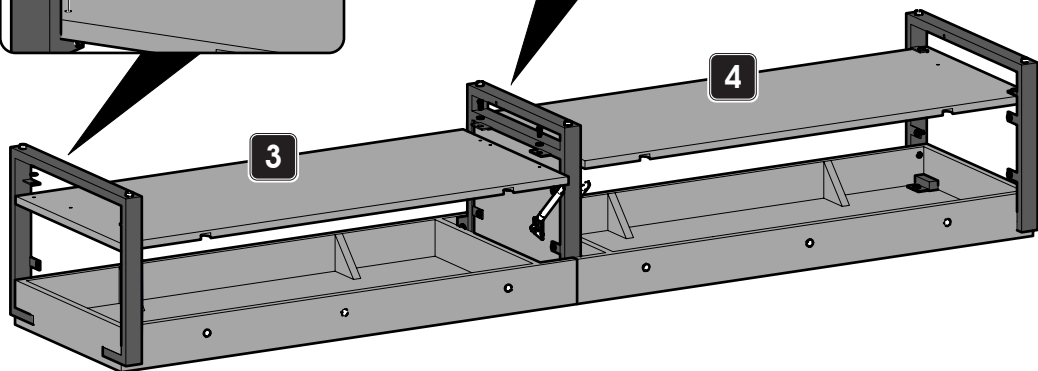

7

i

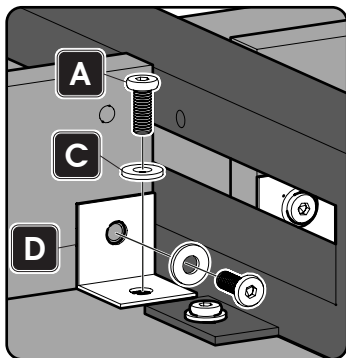

ii

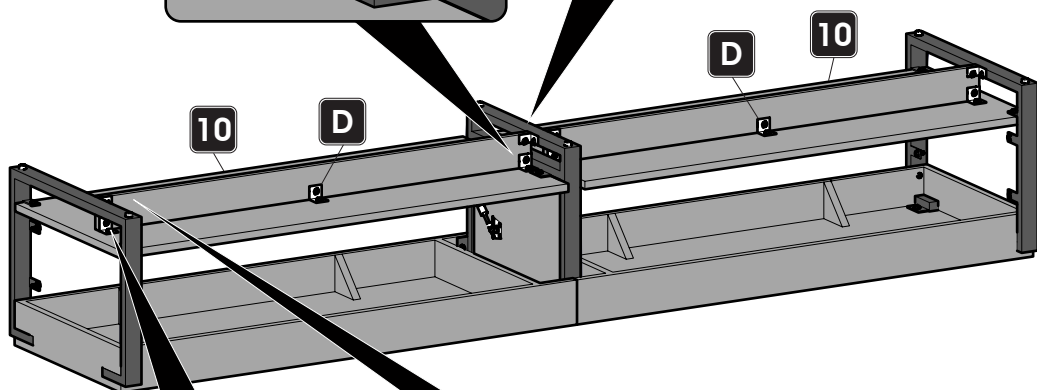
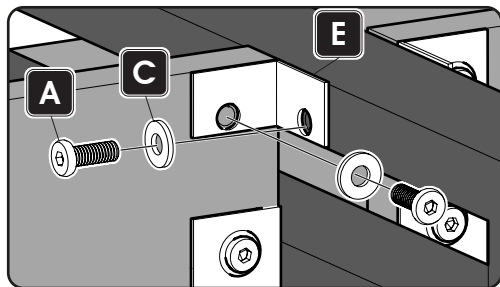

i

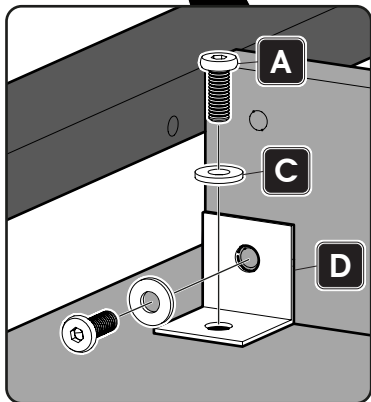

ii

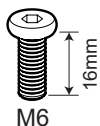
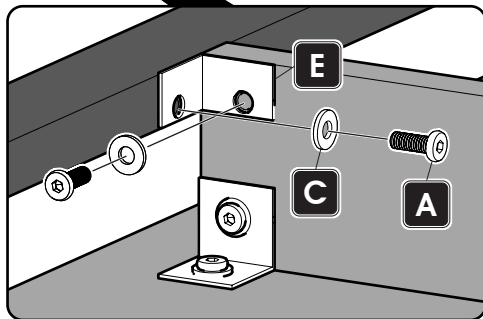

A  
x20



C  
x20

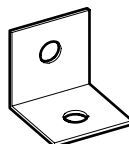

D  
x6

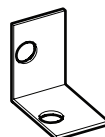

E  
x4



G  
x1



8

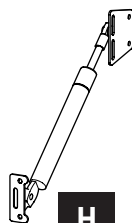
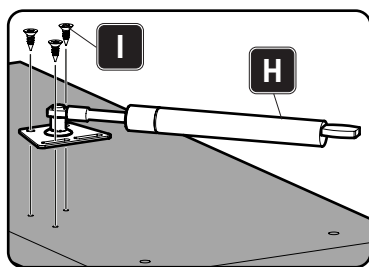

H

x2



I

x6

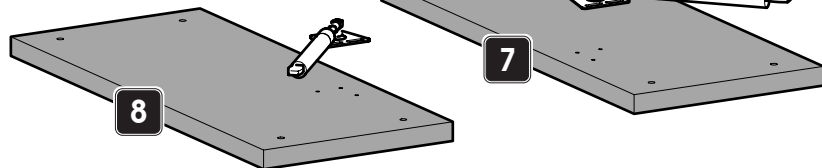

9

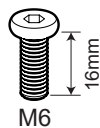
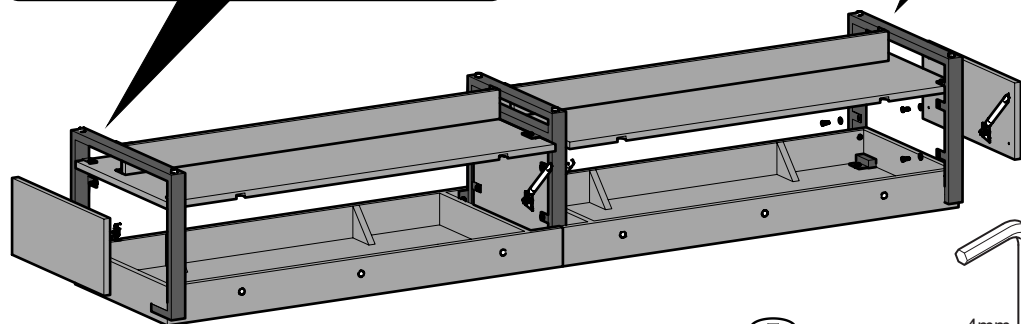
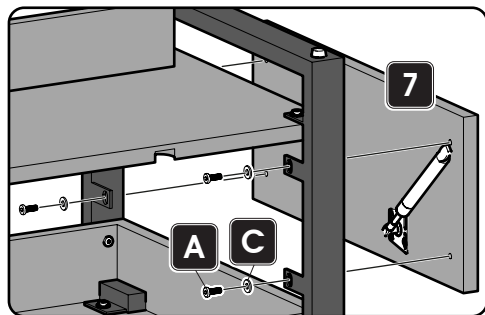
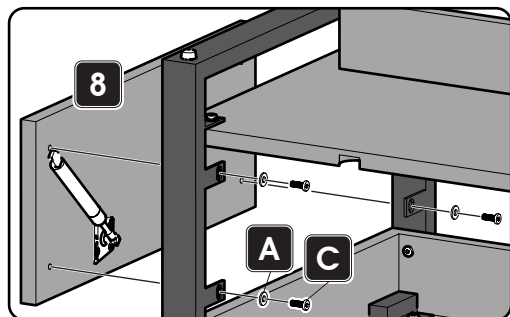

M6

16mm



A

x8

C

x8

G

x1



4mm

9



Fit the mounting plate removed from **H** at Step 4.

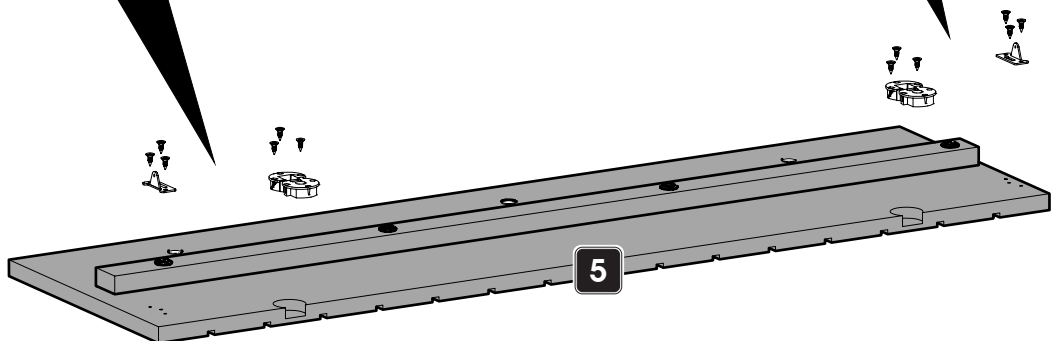
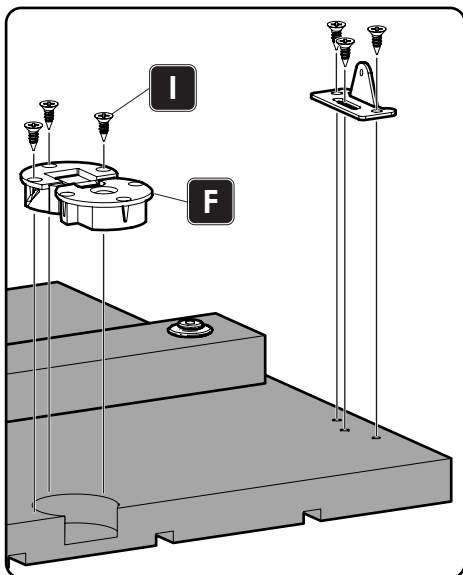
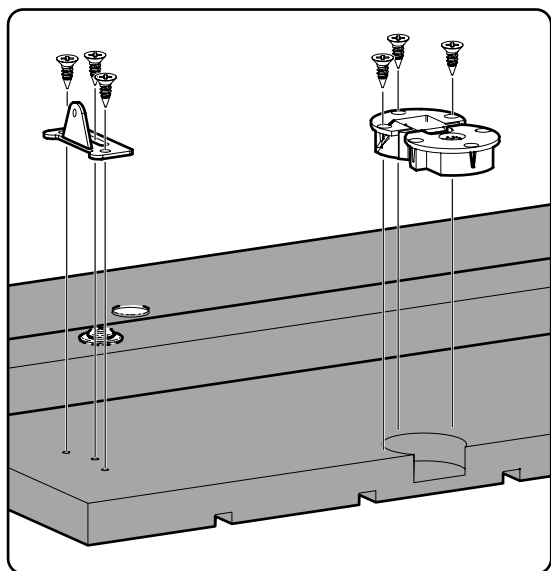

Repeat the process for door **6**.



**I**  
x24

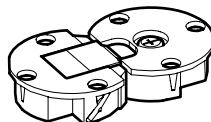

**F**  
x4

10



Use the screw removed from H at Step 4.

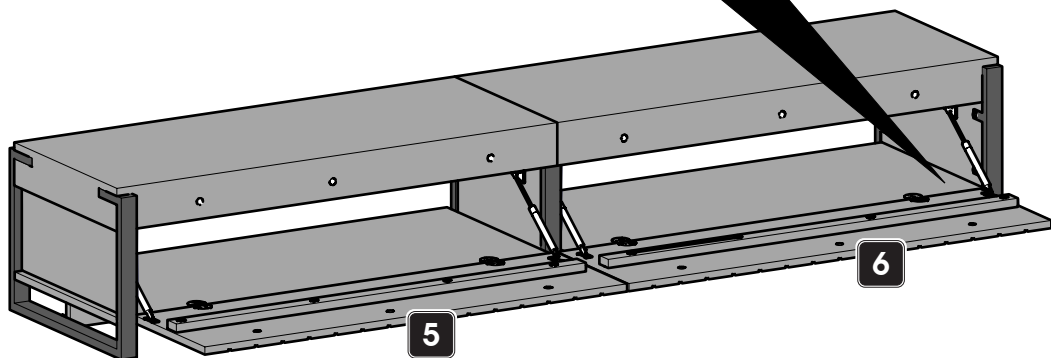
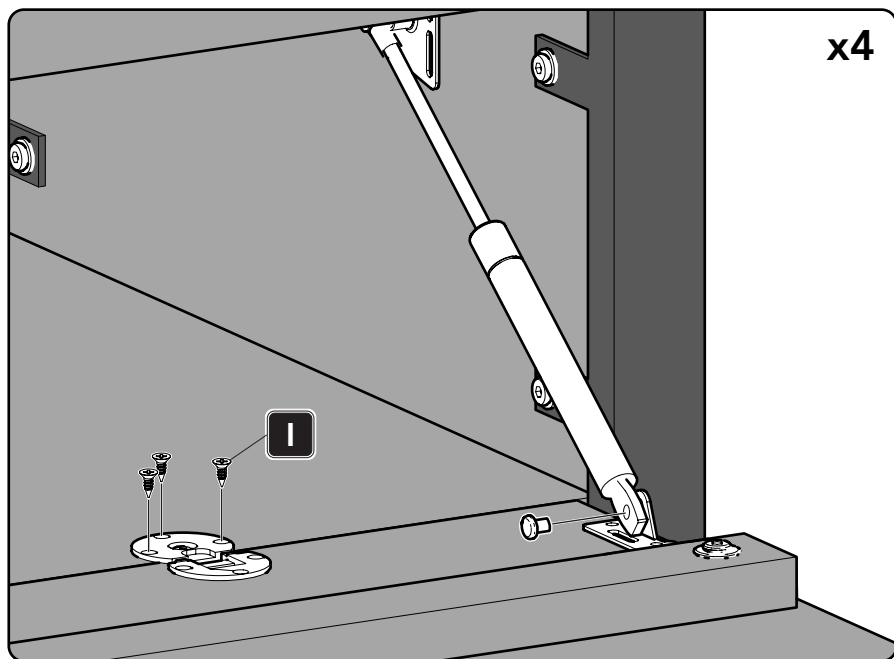

If the doors don't close properly or don't align fully, adjust the door hinge alignment screws small amounts until they do.



I  
x12

## Securing to a wall

