

472509 Rev00

Please read these instructions thoroughly before installation.

You will need

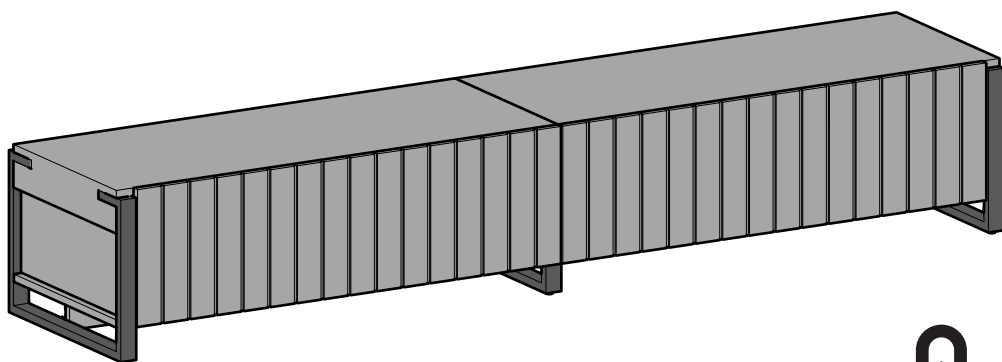

**100kg
220lb**

Customer Helpline

0333 320 0463

Helpline Open Mon to Thurs 9am - 5pm, Fri 9am - 4pm

Online Support

www.avfgroup.com/support

AVF Group Ltd. Hortonwood 30, Telford, Shropshire, TF1 7YE, England

IMPORTANT INFORMATION!

We advise that before starting the assembly of this product that you familiarise yourself with the instructions and the parts list in this leaflet.

Do not's

Do not overtighten any part of this assembly.

Do not place hot or cold objects on to or next to any wood surface unless the object is sufficiently insulated to prevent contact.

Do not strike the wood with hard or pointed items.

Do not sit, stand or climb upon any part of this furniture.

Do not use washing powders or other substances containing abrasives when cleaning the wood.

Do's

Do use a soft cloth with a suitable furniture polish when cleaning wooden panels.

Check all nuts and bolts from time to time.

Be careful when moving the unit and try to avoid any stress on the centre of the unit.

Maximum TV weight and shelf capacities

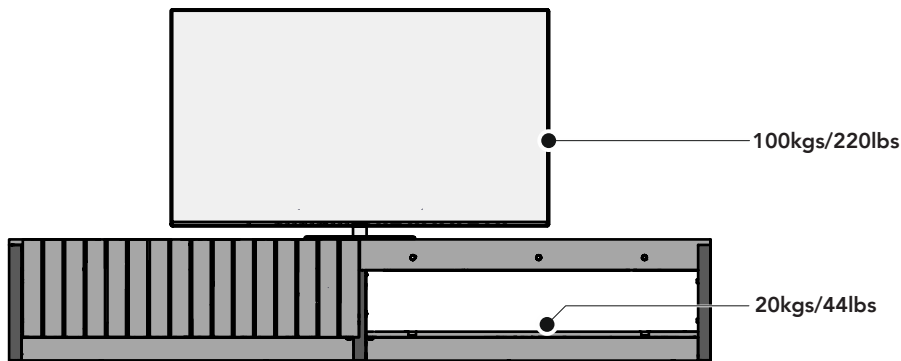

WARNING: Wherever possible distribute weight evenly.

Boxed Parts

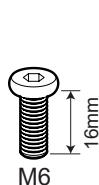
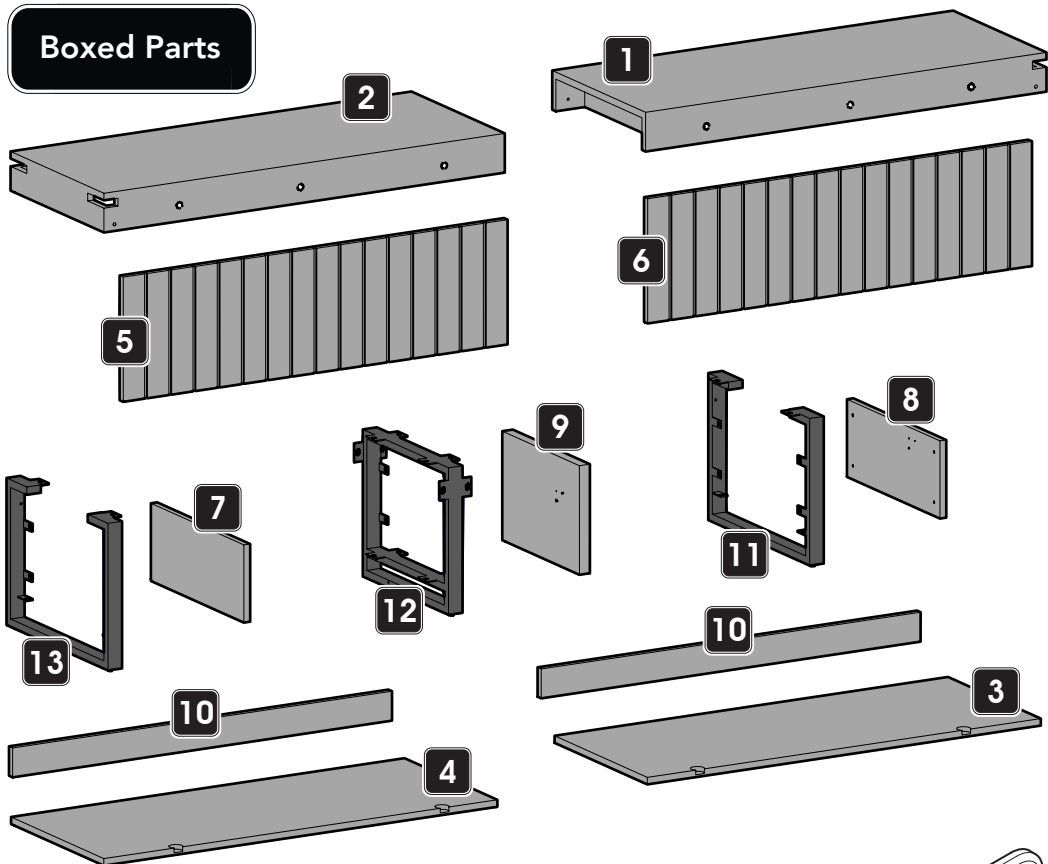

A
x52

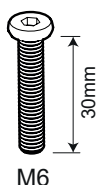

B
x4



C
x56

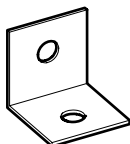

D
x6

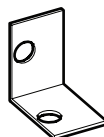

E
x4

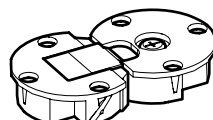

F
x4



G
x1

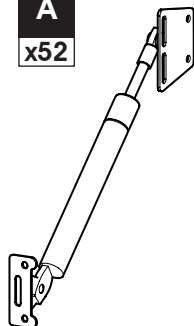

H
x4



I
x56



J
x8

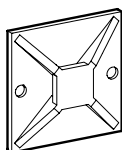

K
x8



L
x4



M
x8



Due to the size and weight of this TV Stand we would recommend a two person build for all steps.

1



When assembling, place a piece of material under the wooden top to prevent any damage.

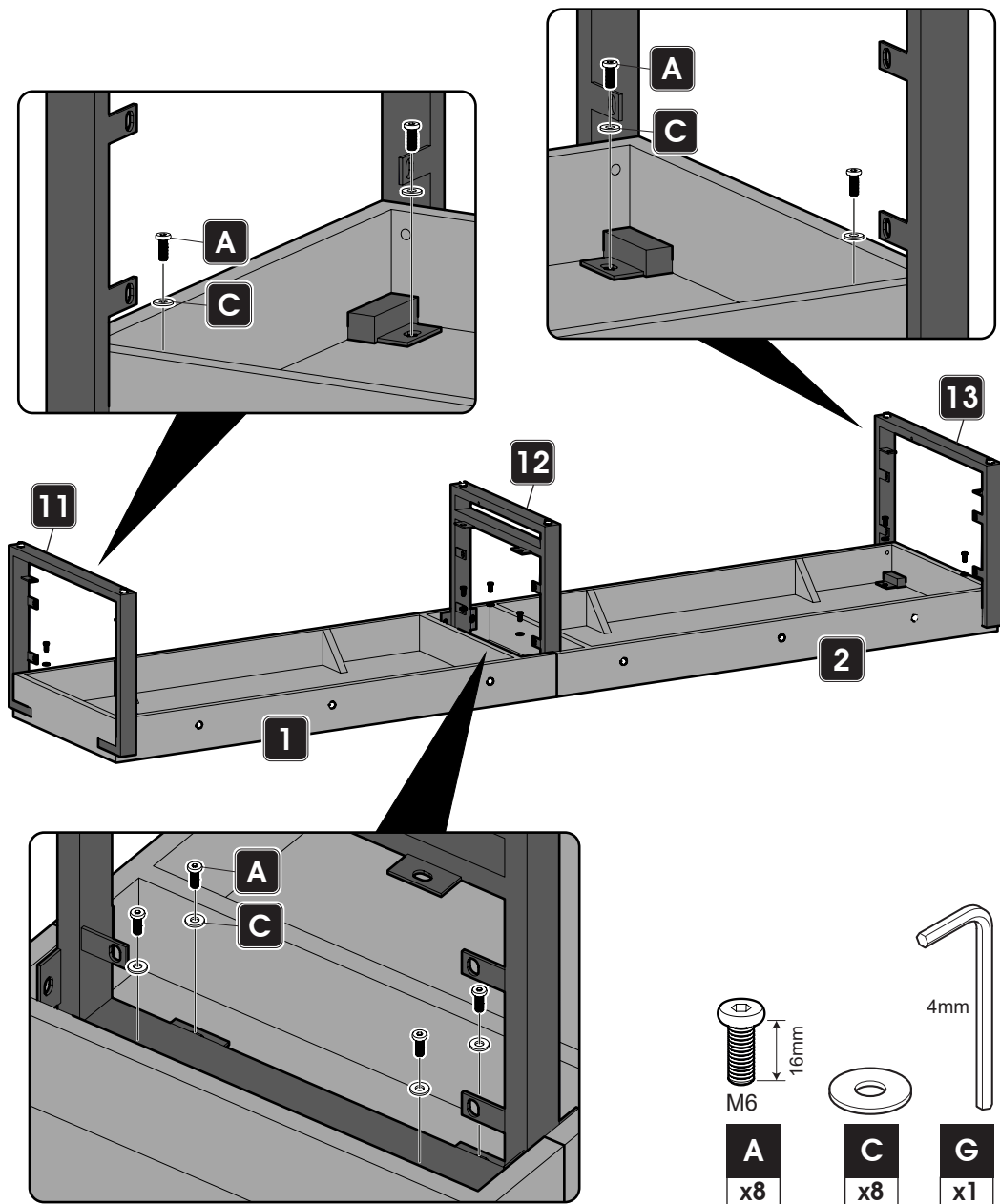

2

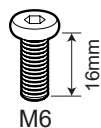
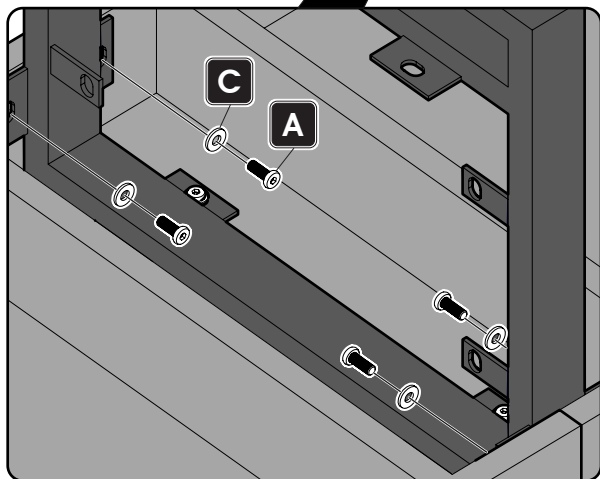
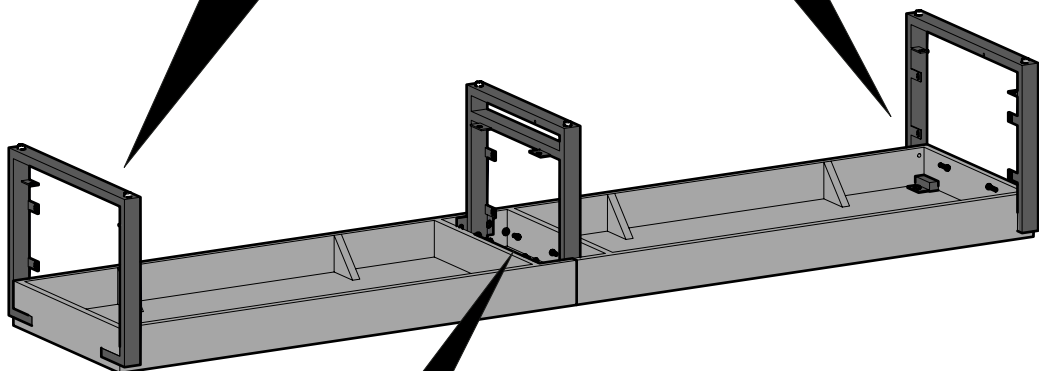
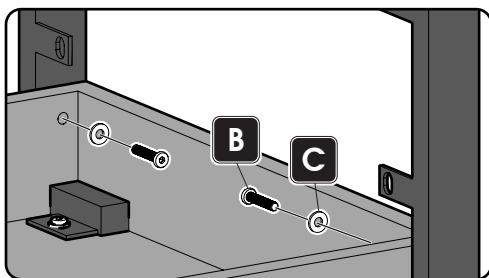
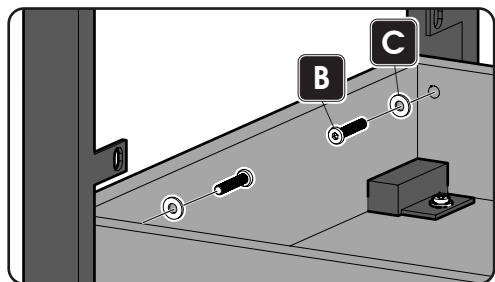

A
x4



C
x8

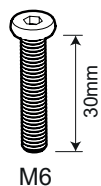

B
x4



G
x1

3

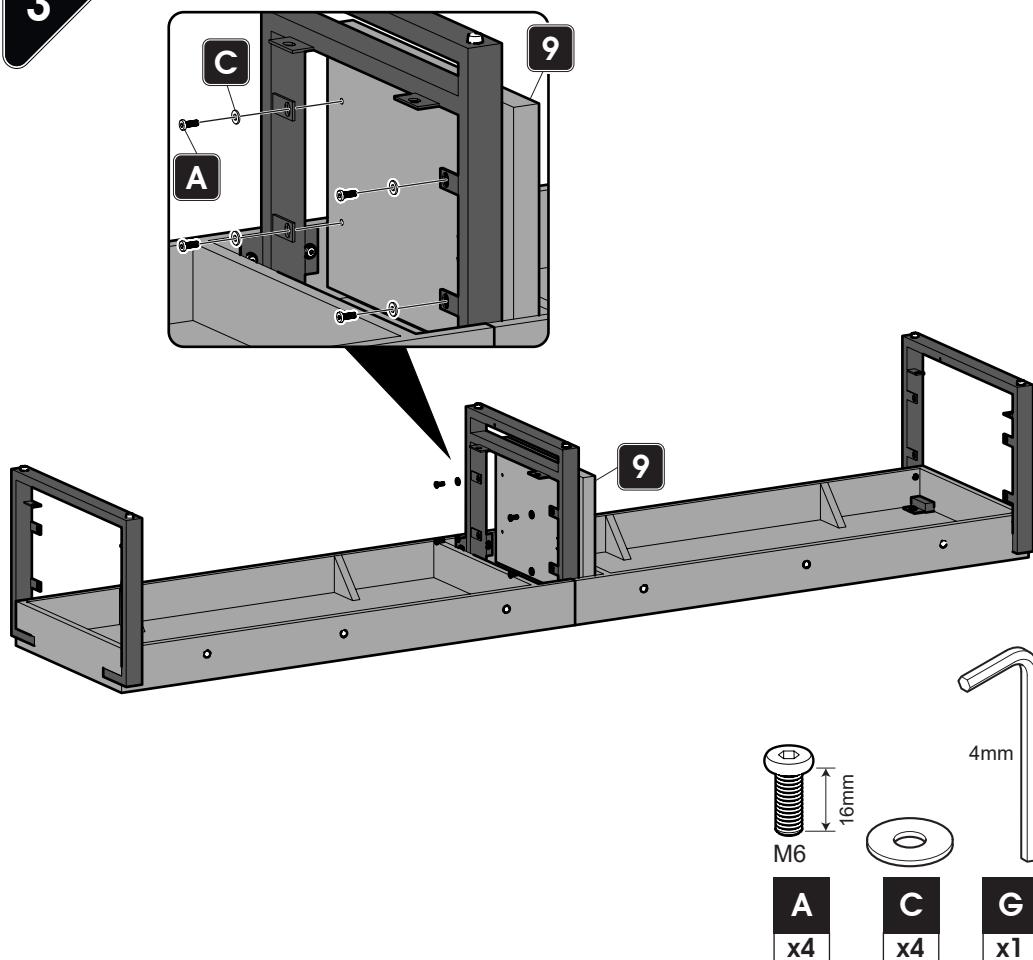

4



Remove screw and mounting plate before assembly. Keep in a safe place until Steps 9 and 10.

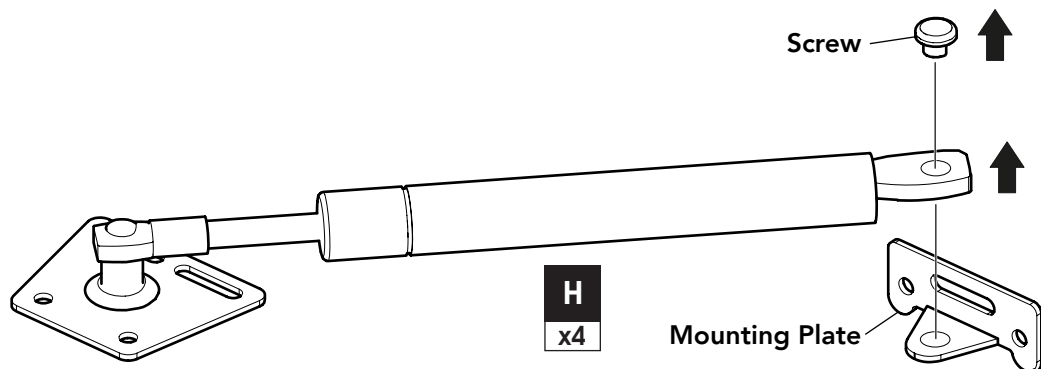

5

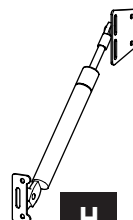
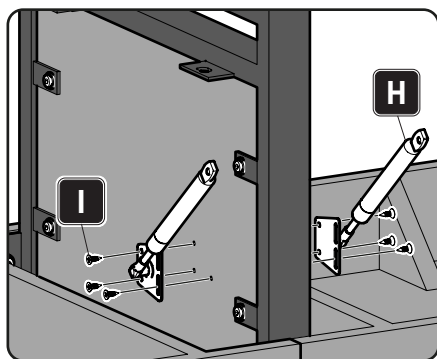

H
x2



I
x6

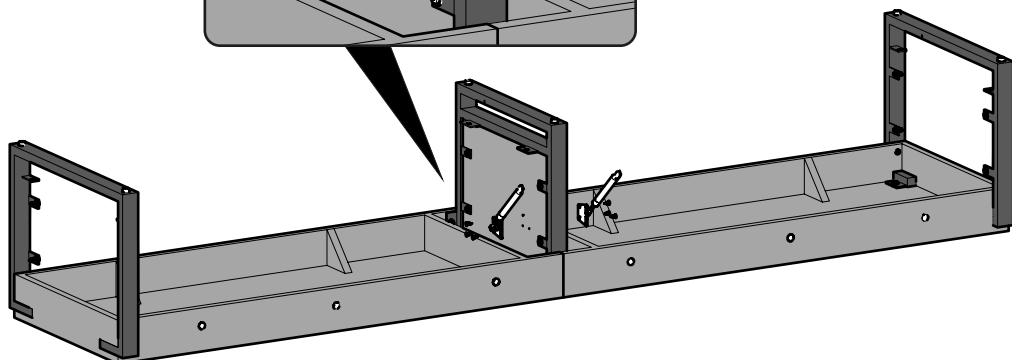

6

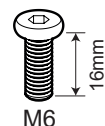
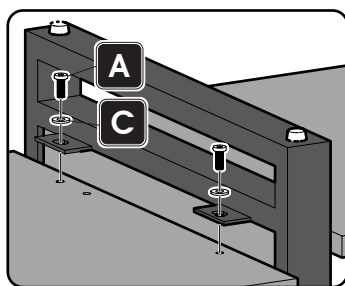
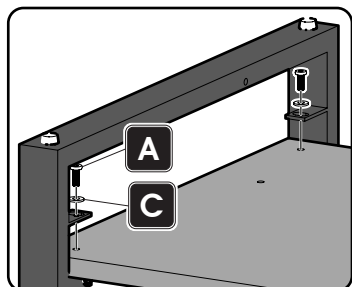

16mm

M6

A
x8



4mm



C
x8

G
x1

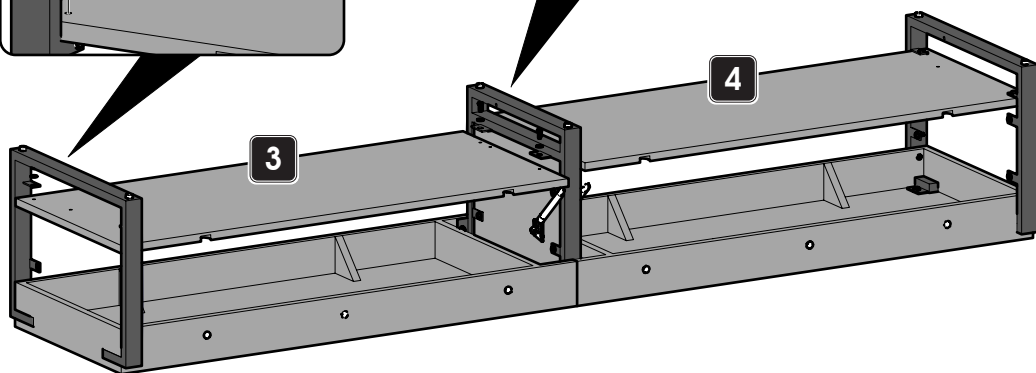

7

i

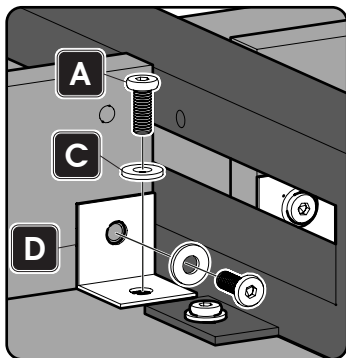

ii

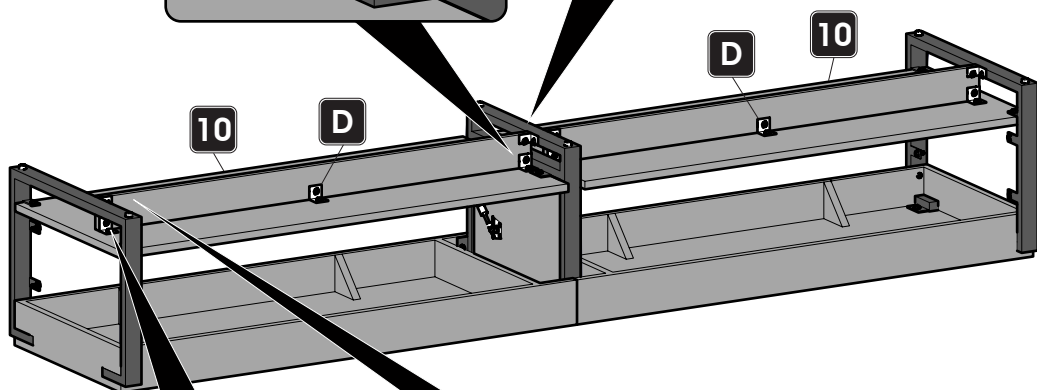
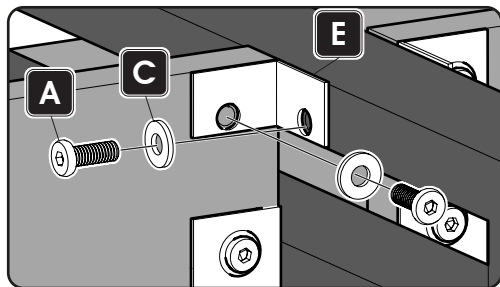

i

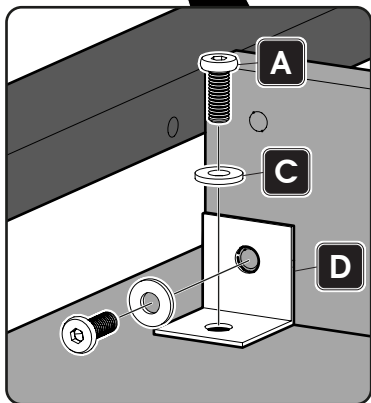

ii

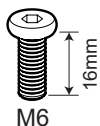
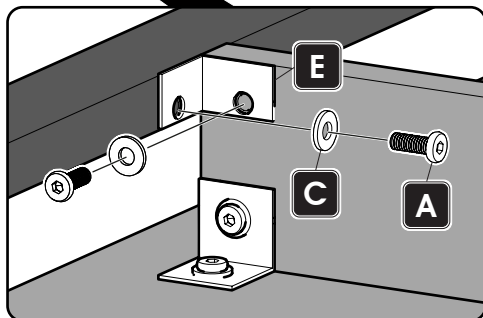

A
x20



C
x20

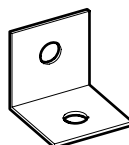

D
x6

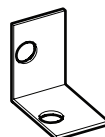

E
x4



G
x1

8

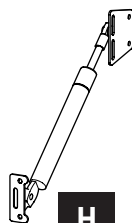
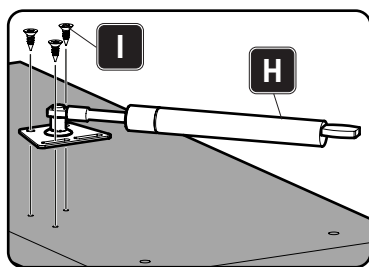

H

x2



I

x6

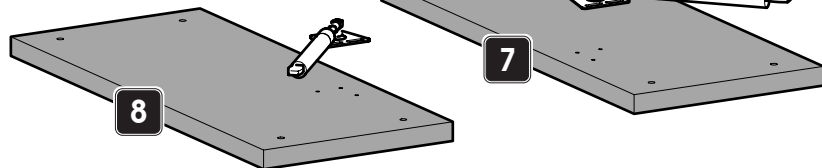

9

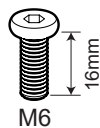
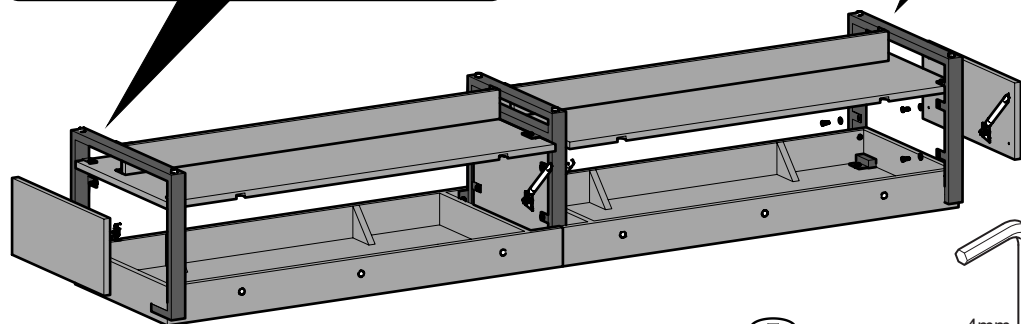
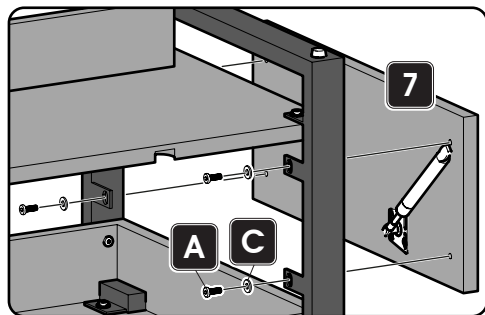
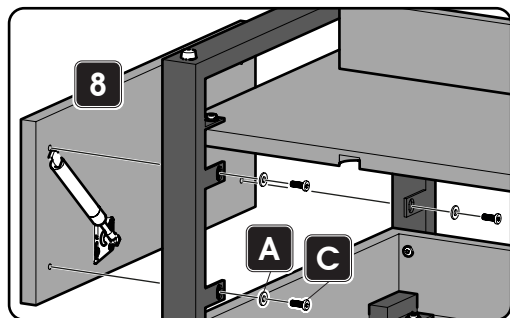

M6

16mm



A

x8

C

x8

G

x1



4mm

9



Fit the mounting plate removed from **H** at Step 4.

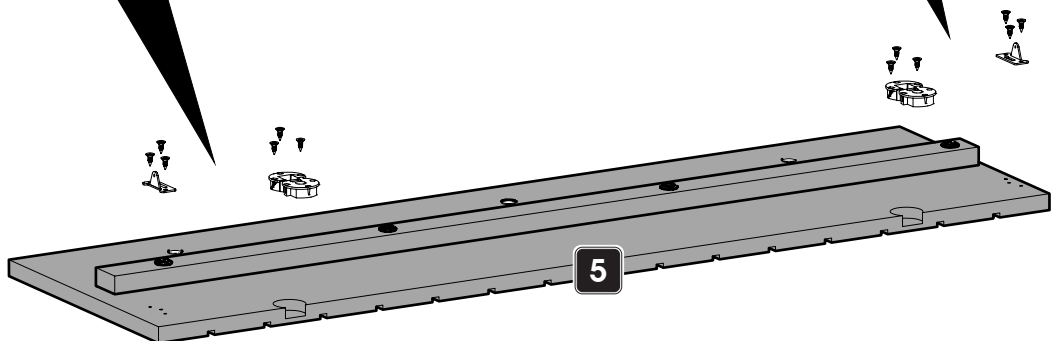
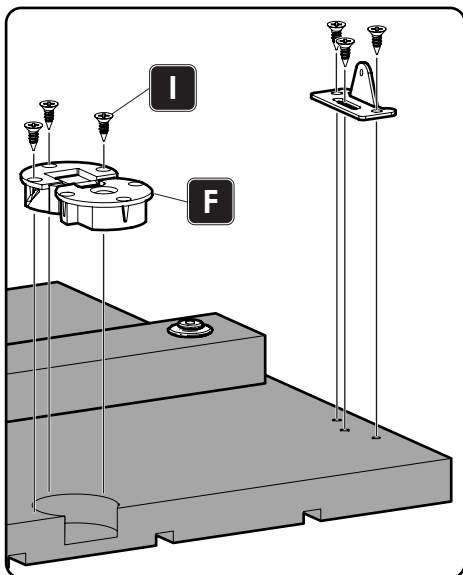
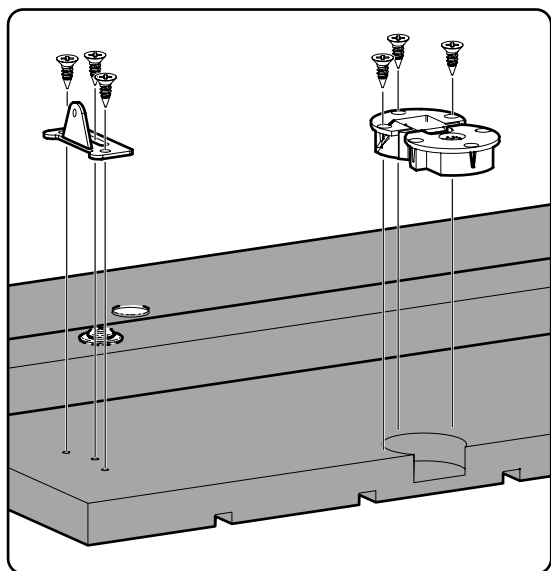

Repeat the process for door **6**.



I
x24

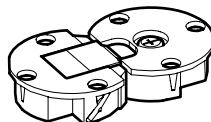

F
x4

10



Use the screw removed from H at Step 4.

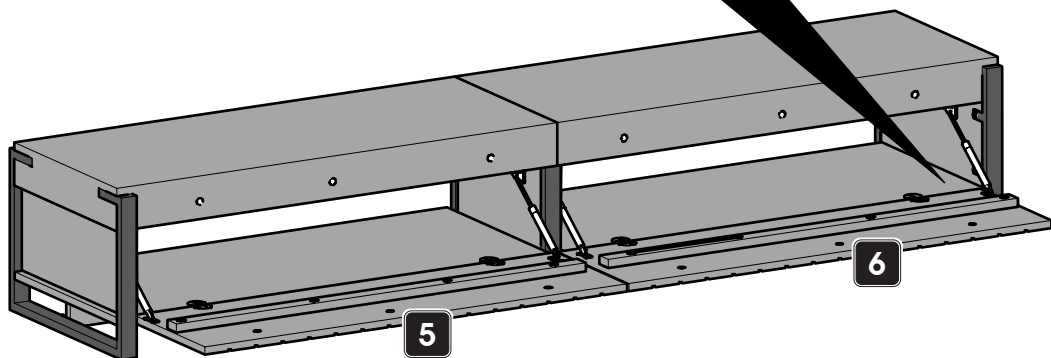
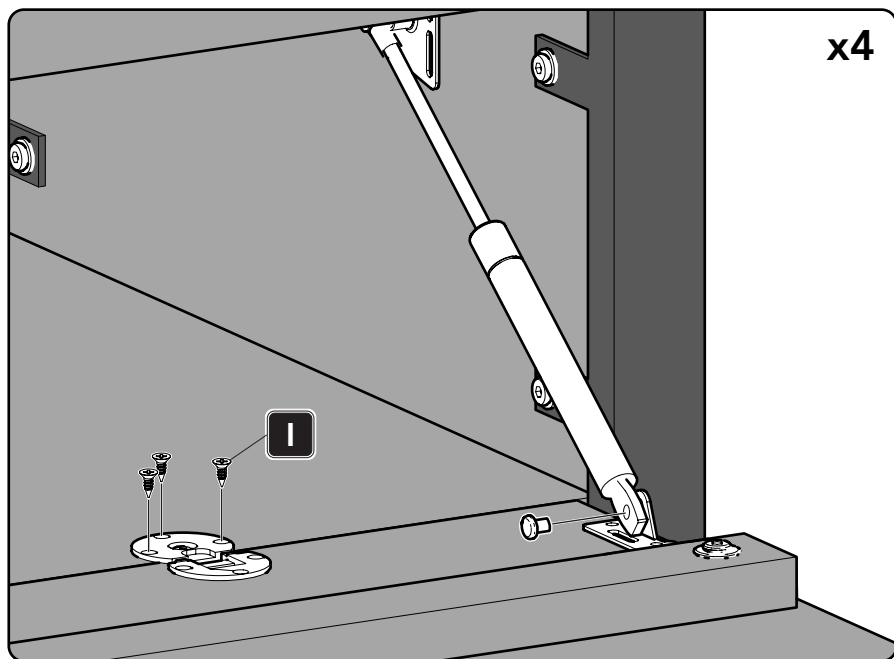

If the doors don't close properly or don't align fully, adjust the door hinge alignment screws small amounts until they do.



I
x12

Securing to a wall

