

Please read these instructions thoroughly before installation.

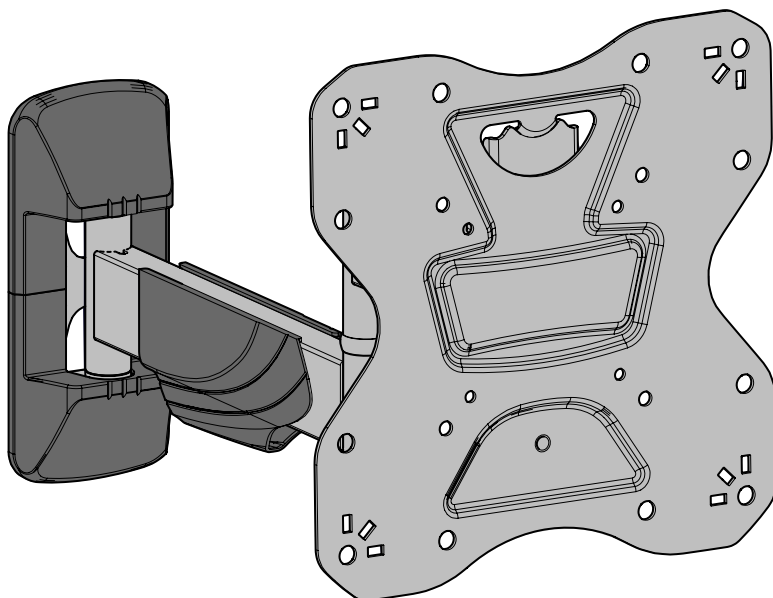

40kg  
88lb

**Please don't return me to the store**

If you are unsure or need advice  
please contact our **UK-based support team:**



**0333 320 0463 | avfgroup.com**

Phone lines open Mon-Fri during AVF office hours

Retain all packaging in case the bracket needs to be returned.

Contents may vary from photography/illustrations.

You will not need all these parts, so expect there to be some left over depending upon the specification of your TV.

This product is intended for indoor use only. Use of this product outdoors could lead to failure and personal injury.

It is the responsibility of the installer to ensure that the mounting wall is of a suitable standard and void of any services (eg gas, electricity, water etc).

AVF accept no responsibility for any damage or loss caused by installing this product in a sub standard wall.



## 10 YEAR WARRANTY



This product comes with a 10 Year Warranty.

This will be honoured as long as the product is owned by the original consumer purchaser. Proof of purchase is required.

For detailed warranty information please visit: [www.avfgroup.com/uk/warranties](http://www.avfgroup.com/uk/warranties)

### You will need

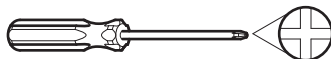
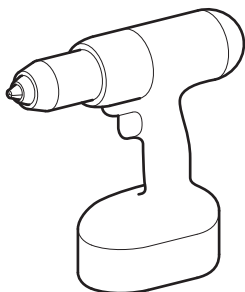
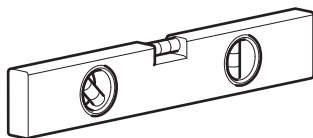
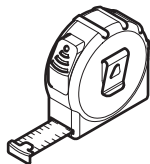

Ø3mm (1/8") Wood



Ø10mm (25/64") Masonry

Boxed Parts

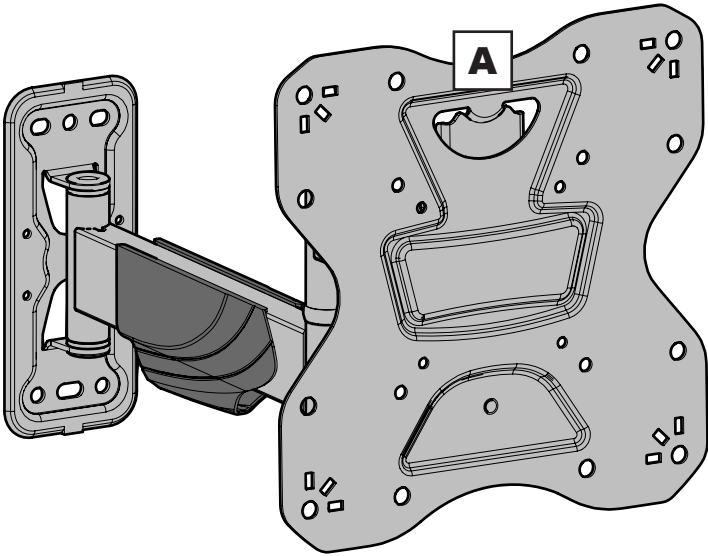
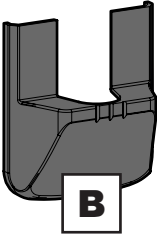
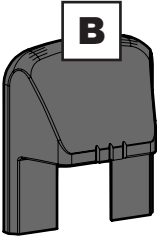

You won't need all these screws. A range of TV Screws and extra Wall Fixings are provided. Keep left over screws in a safe place.



**C**

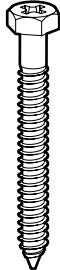

**W1**

x4

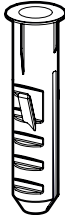

**W2**

x4



**W3**

x4



M4

**J1**

x4

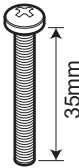

M4

**J2**

x4

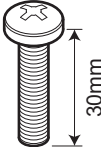

M6

**J3**

x4

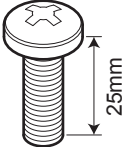

M8

**J4**

x4

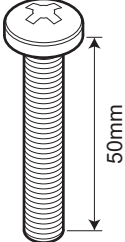

M8

**J5**

x4



**K1**

x4



**K2**

x4



**L1**

x8



**L2**

x4

1

## Measure your VESA fixings and select TV Screws

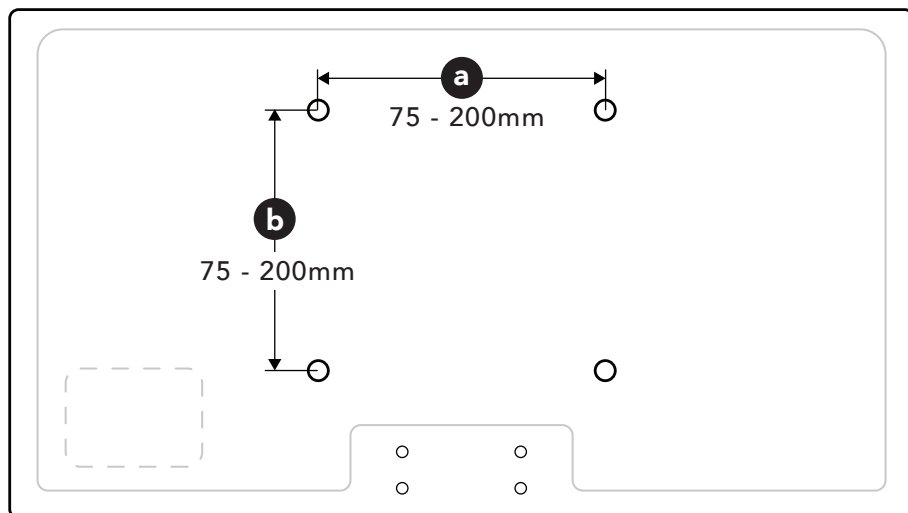

If width **a** is greater than 200mm or height **b** greater than 200mm  
STOP installation now and contact the customer helpline.

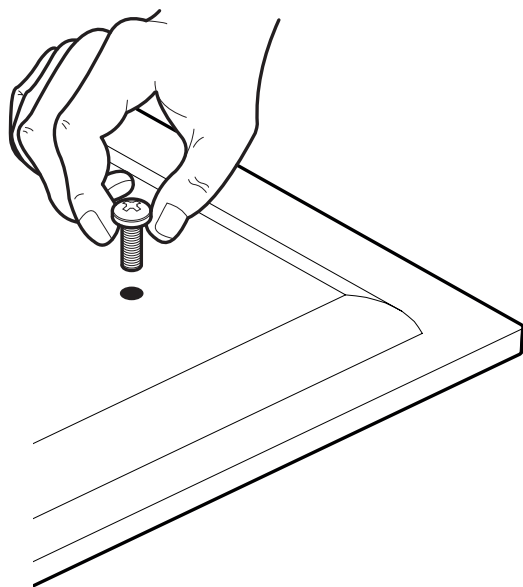

Determine which diameter TV Screws  
fit your TV and put them to one side.

**M4, M6 or M8**

We will select the correct length later.

## 2

## Preparing the TV Mounting Plate

Before you can attach the TV mounting plate to your TV you need to remove the plate from your wall mount.

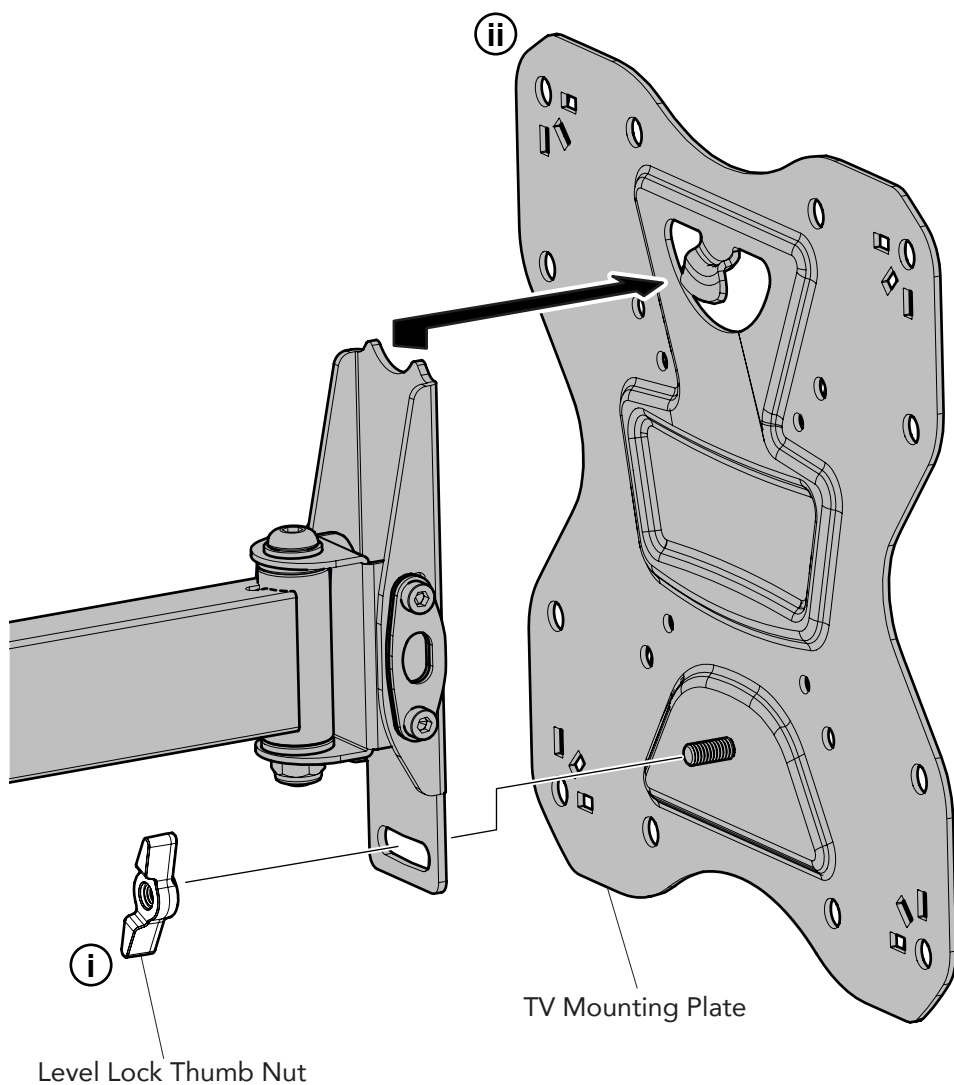

**i** Remove the Level Lock Thumb Nut and safely keep for step 6.

**ii** Remove the TV Mounting Plate.

# 3

## Fitting the TV Mounting Plate



After completing this step, you will have lots of TV screws left over. Keep them in a safe place in case you require them in future.

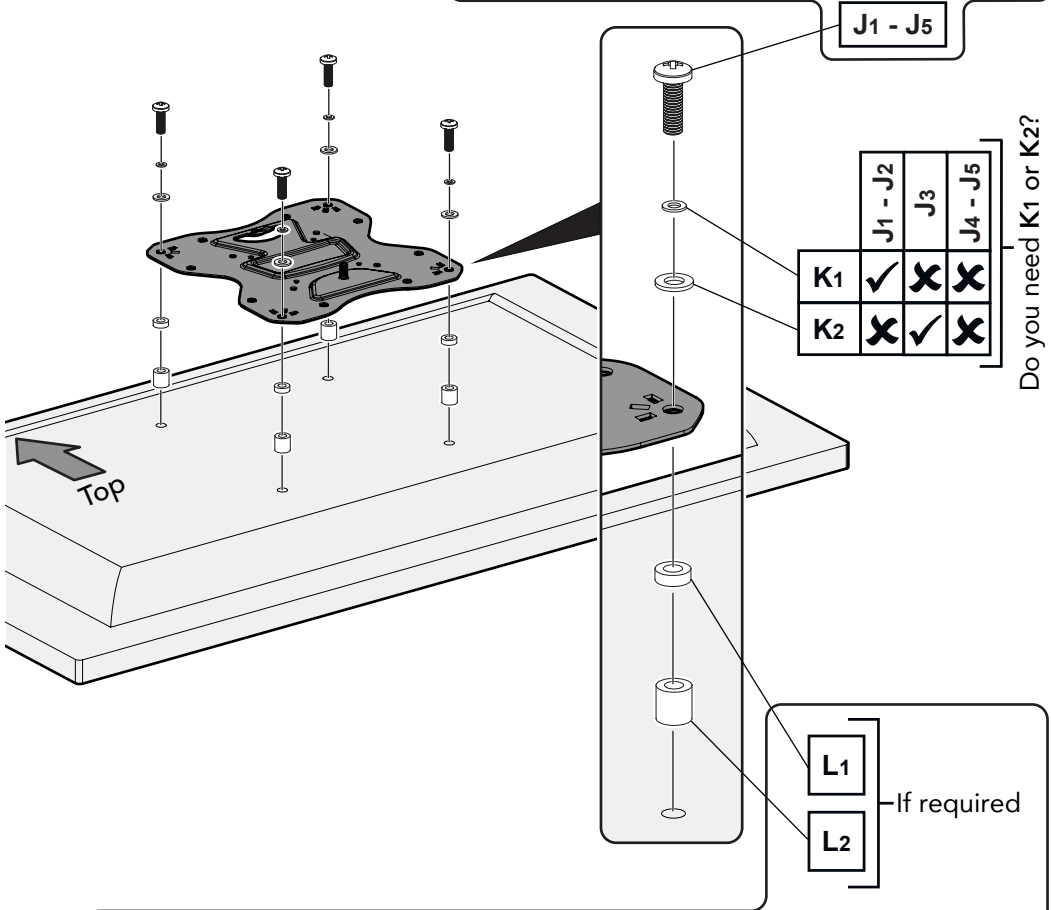
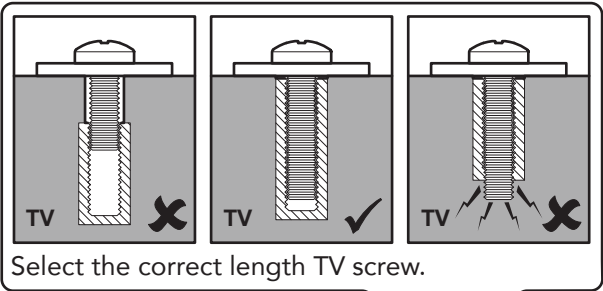

You may need to use Spacers **L1** or **L2** if the screws are too long or the back of your TV is not flat.

You can also use longer screws and the spacers to help avoid cabling or plug sockets on your wall.

You can use any combination and quantity of **L1** and **L2** to achieve the spacing you require.

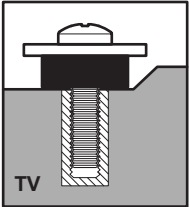

## 4 Fitting the Wall Bracket

### Solid Wall

**i** If fitting to a Wood Stud Wall follow the installation instructions on the next page.

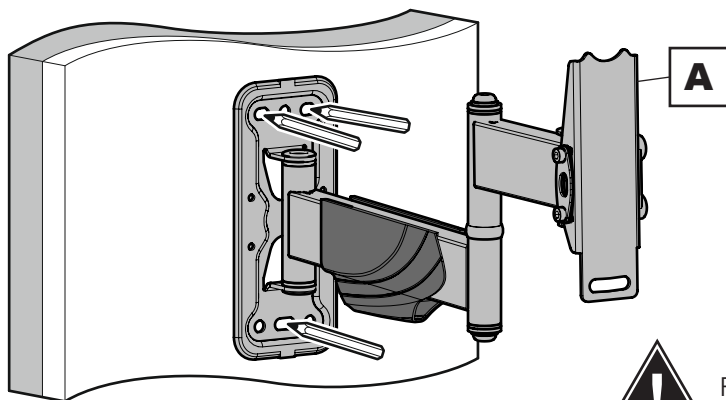

Remove Dust from Hole

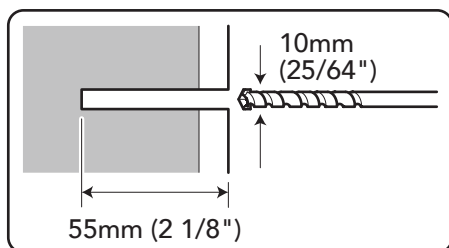

Lubricate screw thread with soap

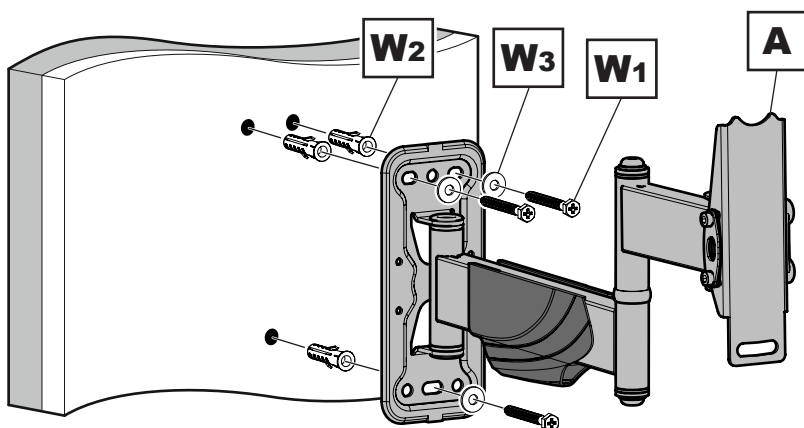

DO NOT overtighten screws.  
Tighten screws by hand only.

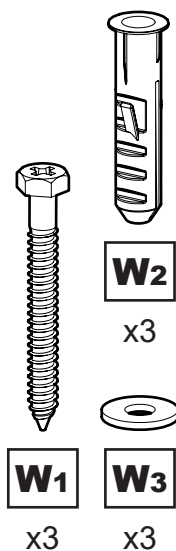

Wood Stud Wall

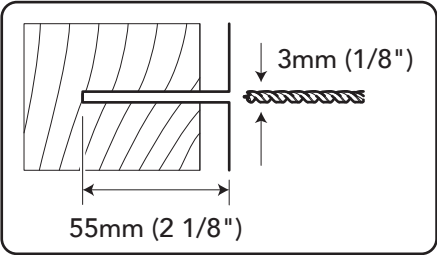
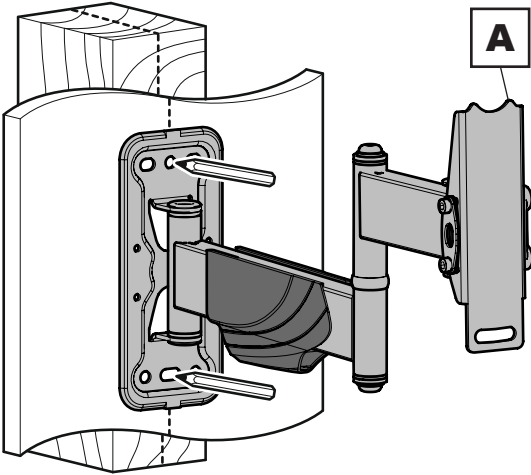

Ensure drill holes are in the centre of the wood studs.

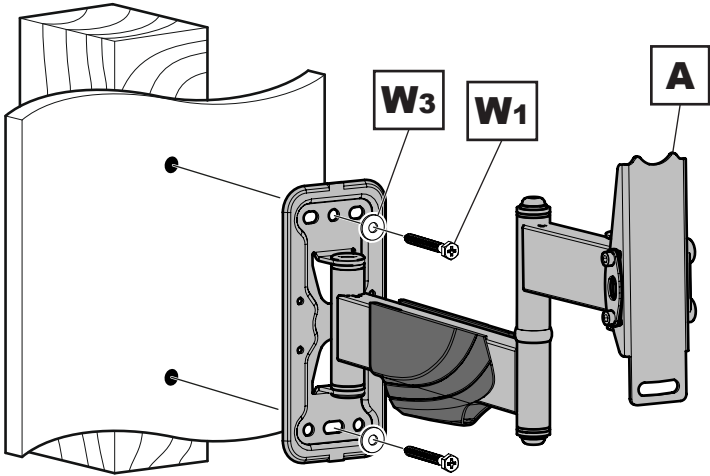

DO NOT overtighten screws.  
Tighten screws by hand only.

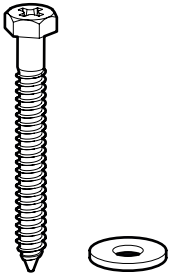

**W1**

x2

**W3**

x2



**5****Fitting the Wall Bracket Covers**

Align prongs on **B** with holes in wall bracket.  
Push to clip cover in to place.

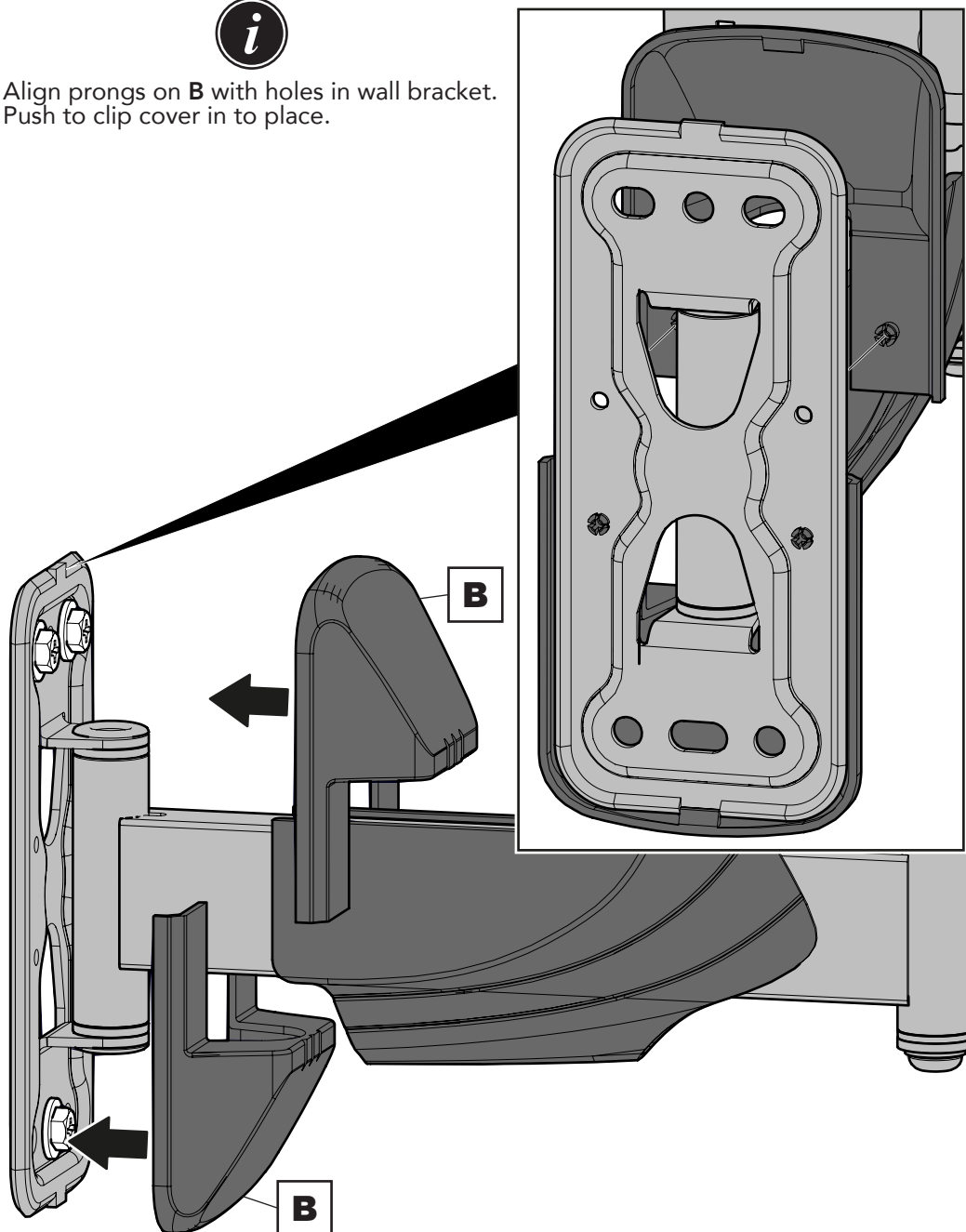

6

## Hanging the TV

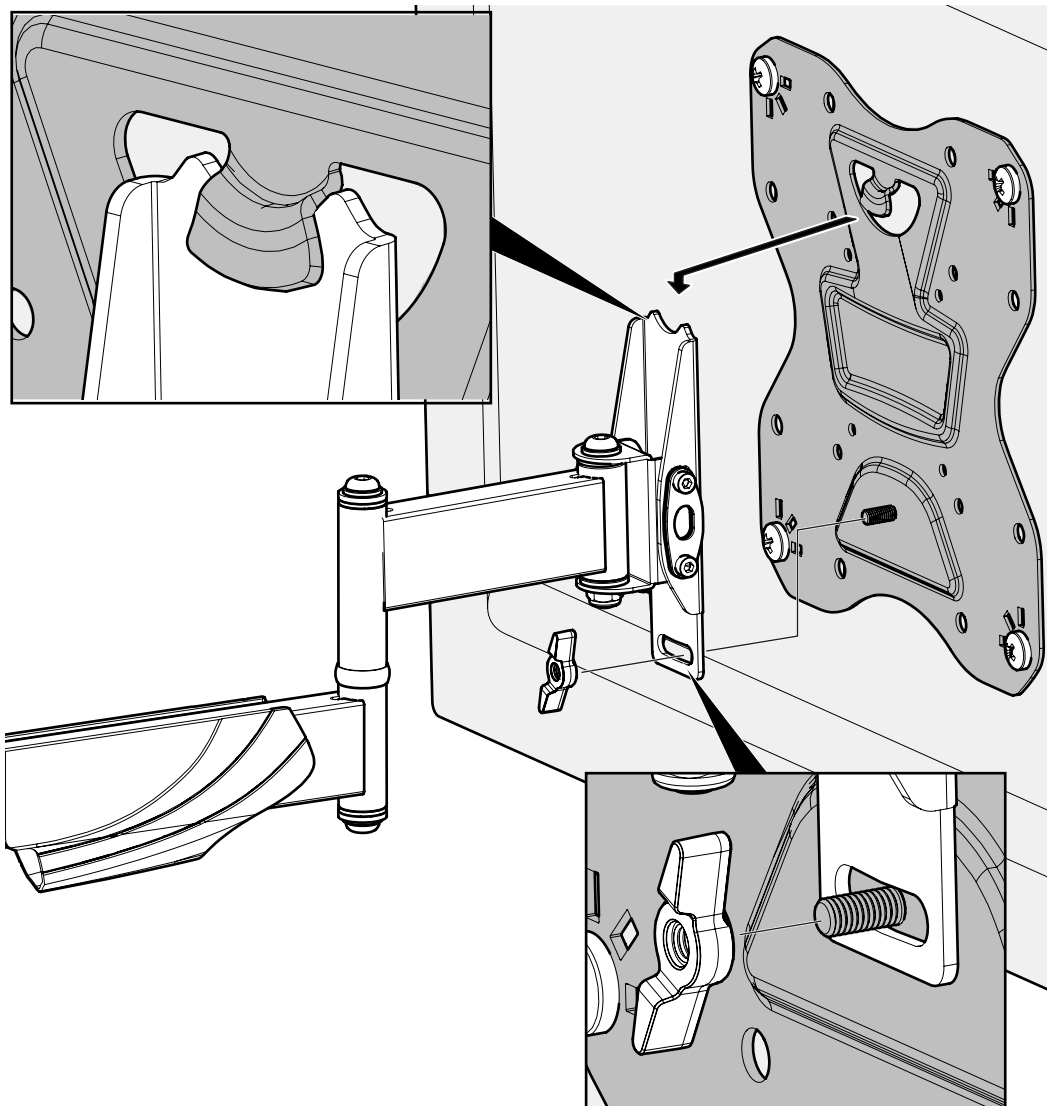

Reuse the Level Lock Thumb Nut saved in step 2.



When the TV is level, ensure the thumb nut is fully tightened.



To remove the TV, reverse this procedure.

## 7 Cable Management



Snap ON-OFF Covers

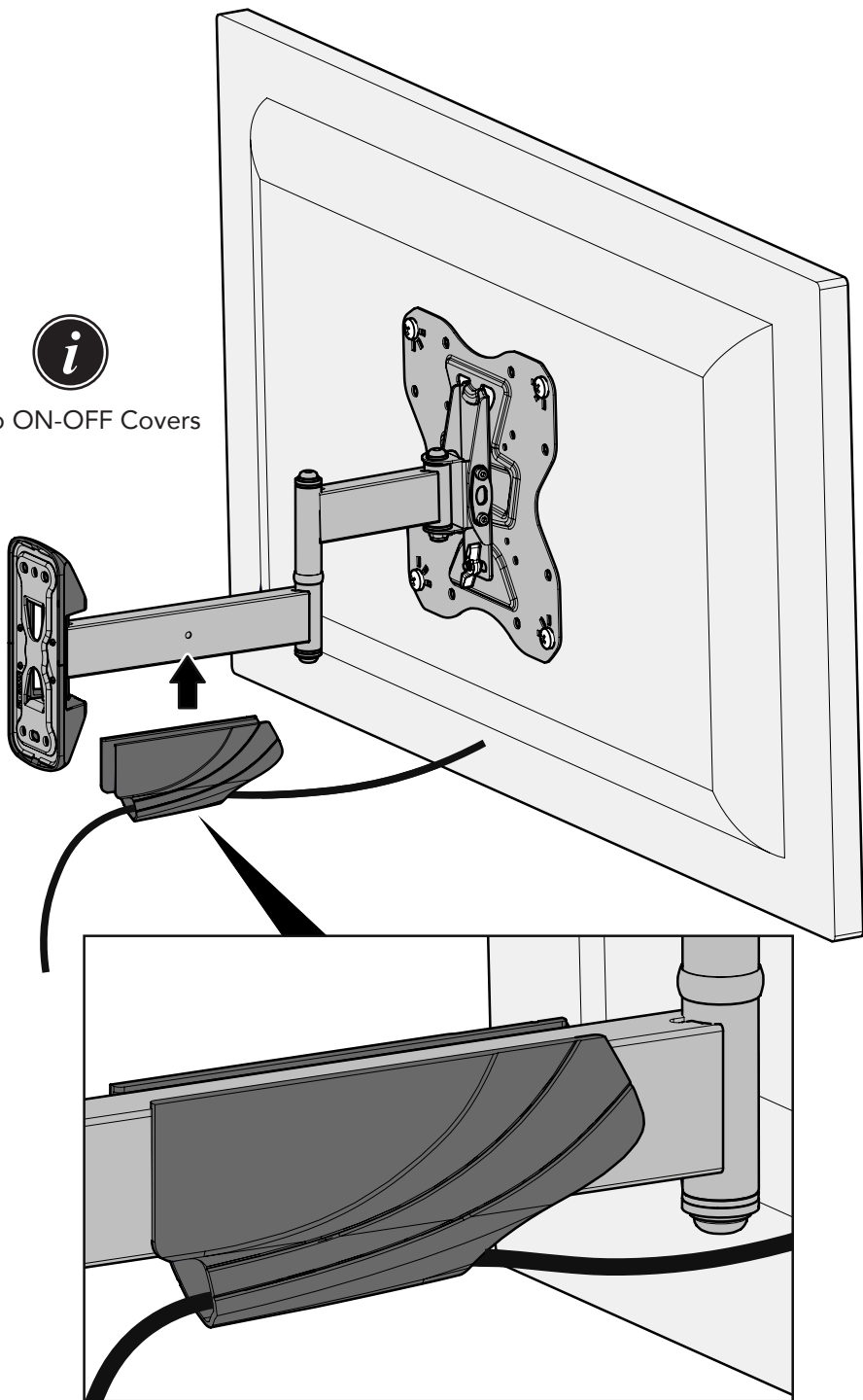

## 8 TV Levelling

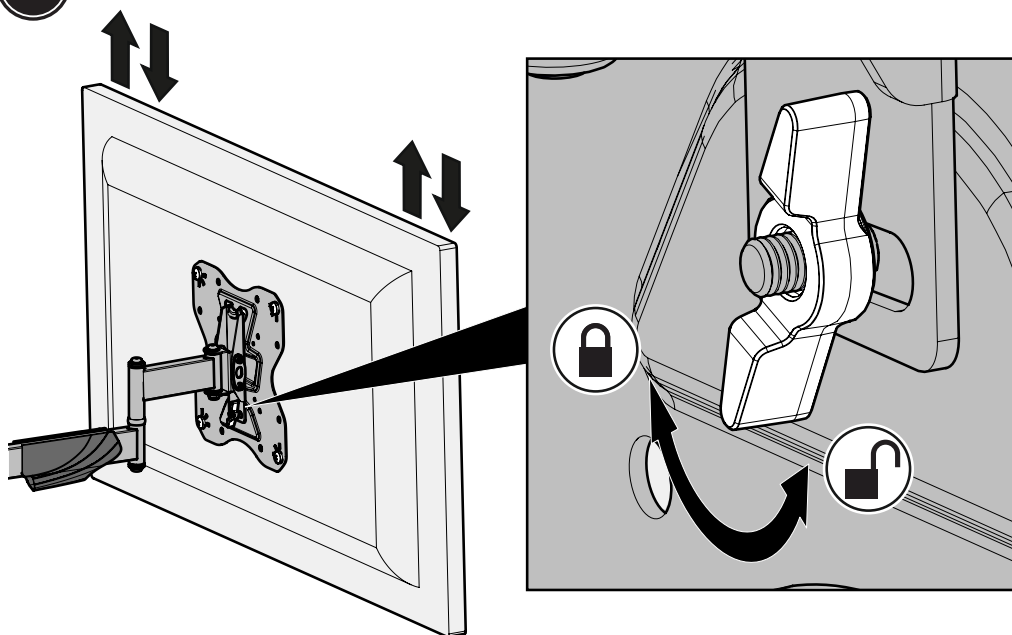

Loosen the Level Lock Thumb Nut, adjust your TV until it is level, then re-tighten the thumb nut.

## 9 Tilt Adjustment

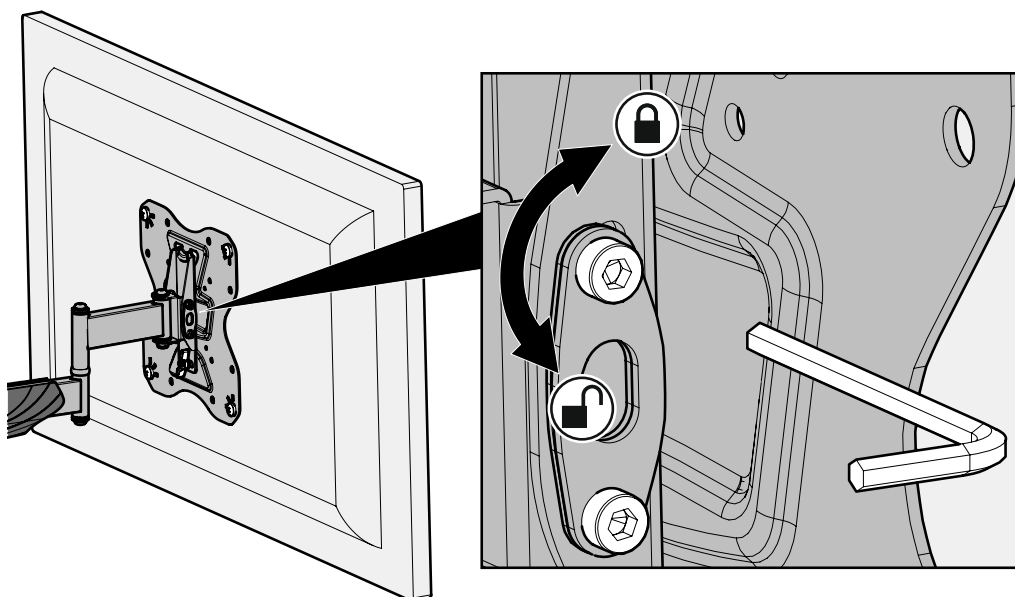

Adjust screws to achieve perfect tilt resistance if required. You must adjust both screws equally. You can also lock the tilt if required.