

STOP

Read the operating instructions and keep them in a safe place.
If you have any questions about this product or issues with installation
contact the help line before returning this product to the store.

Installation video guide and TV Height Calculator
tool at myTVMount.com

Help Line: **0333 320 8027**
Monday - Thursday 08:30 - 17:00 Friday 08:30 - 16:00
Calls charged at local rate

20 KG

39" MAX

VESA
TV Fixing
Holes

75 x 75mm
100 x 100mm
200 x 100mm
200 x 200mm

3 Deciding the correct screw and spacer combination

! When deciding which screw diameter and length is suitable for your TV it is important to **STOP** immediately as soon as you feel any resistance to prevent damage to your TV

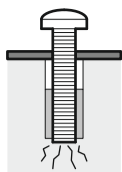

You are provided with 4 diameters of TV fixing screws, **M4, M5, M6** and **M8**. Determine the screw diameter that fits and remember for the next step

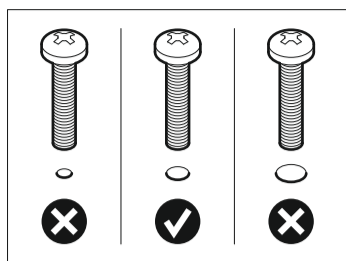
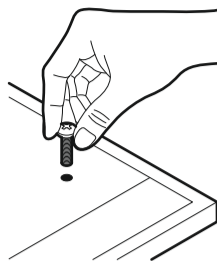

Do I need to use spacers T11 or T12?

Spacers are provided so that you can achieve the correct fit between the back of your TV and Mounting Plate, please see below for examples of when spacers are required

No

TV has flat back and flush fixing holes

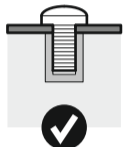
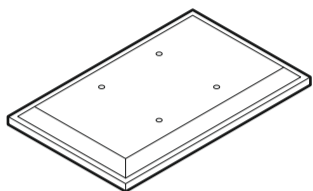

Maybe

TV has flat back with recessed fixing holes

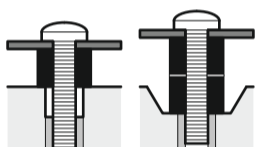
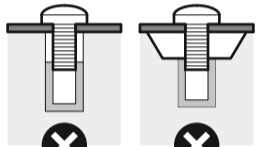
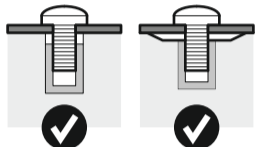
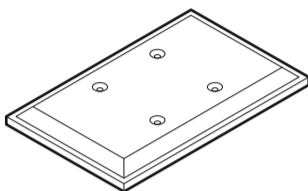

Yes

TV has irregular or obstructed back

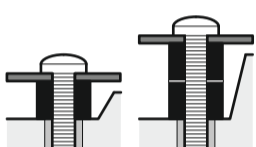
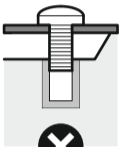
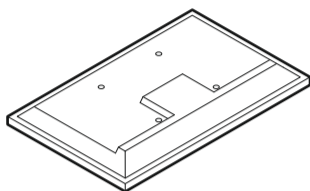

4 Fitting the TV Mounting Plate

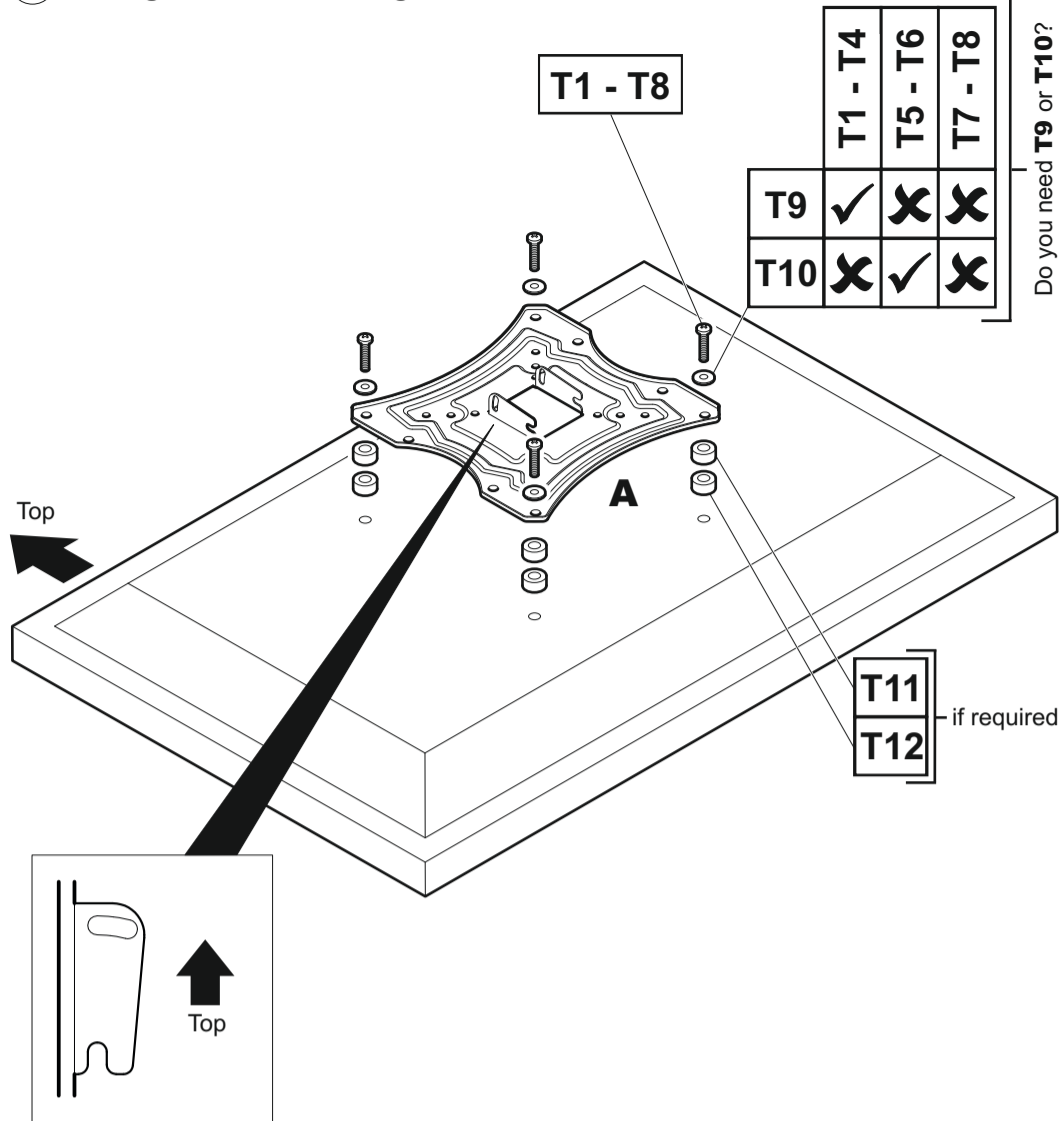

	T1 - T4	T5 - T6	T7 - T8
T9	✓	✗	✗
T10	✗	✓	✗

! Attach the bracket to the back of your TV using a suitable combination of screw, washer and spacer combinations. **DO NOT OVERTIGHTEN!**

💡 After completing step 4 you will have fittings left over, please keep in a safe place for future reference

5 Solid Wall

! Get it right with our easy to use online TV Height Calculator at myTVMount.com

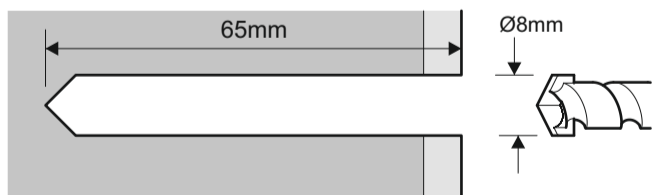
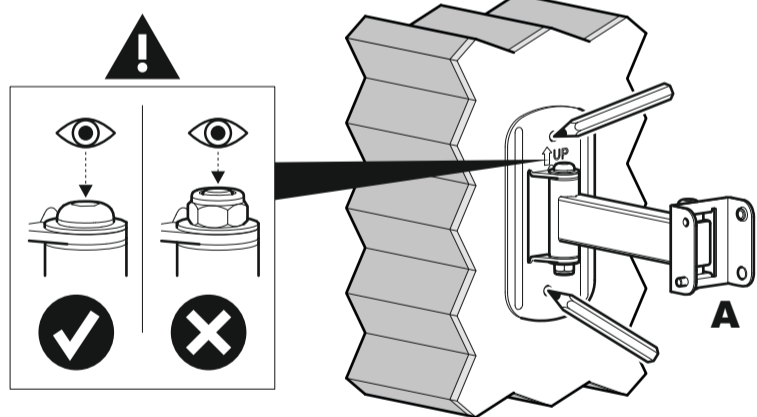
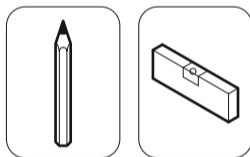

Remove dust from hole

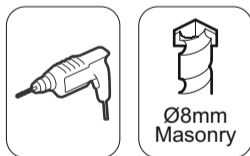

Ø8mm Masonry

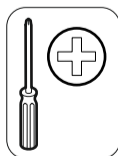

! Tighten with hand tools only

💡 Lubricate screw thread with soap

5 Wood Stud

! Get it right with our easy to use online TV Height Calculator at myTVMount.com

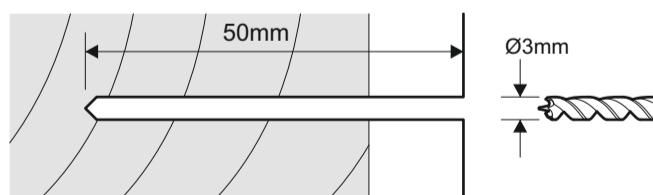
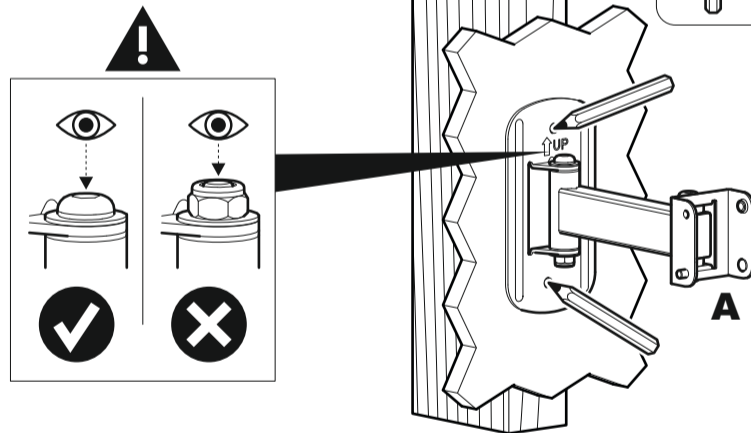
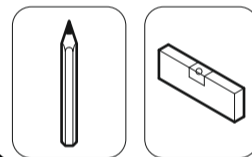

Ø3mm Wood

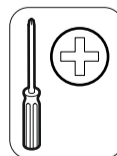

! Do not use **W2** wall plugs in wood stud

! Tighten with hand tools only

💡 Lubricate screw thread with soap