

2 Deciding the correct screw and spacer combination

! When deciding which screw diameter and length is suitable for your TV it is important to **STOP** immediately as soon as you feel any resistance to prevent damage to your TV

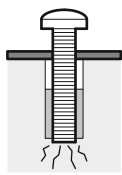

You are provided with 4 diameters of TV fixing screws, **M4, M5, M6** and **M8**. Determine the screw diameter that fits and remember for the next step

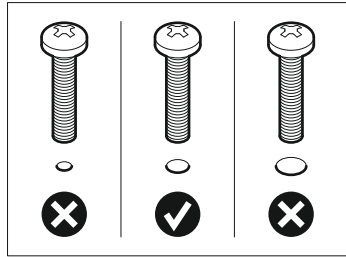
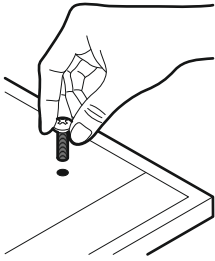

Do I need to use spacers T11 or T12?

Spacers are provided so that you can achieve the correct fit between the back of your TV and Mounting Plate, please see below for examples of when spacers are required

No
TV has flat back and flush fixing holes

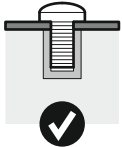
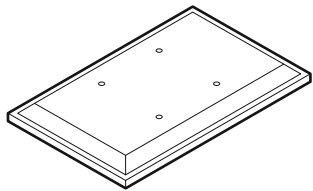

Maybe
TV has flat back with recessed fixing holes

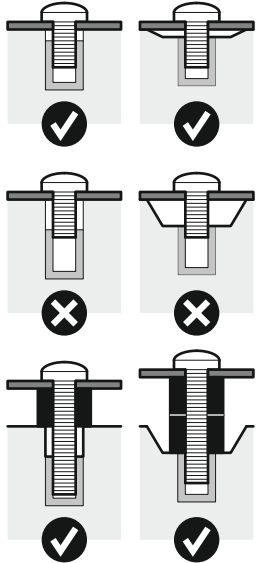
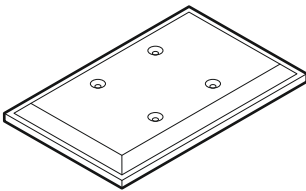

Yes
TV has irregular or obstructed back

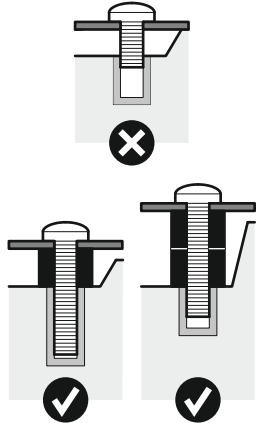
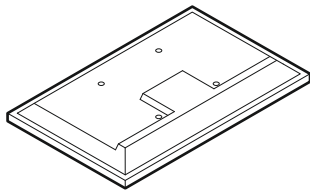

3 Fitting the TV Brackets

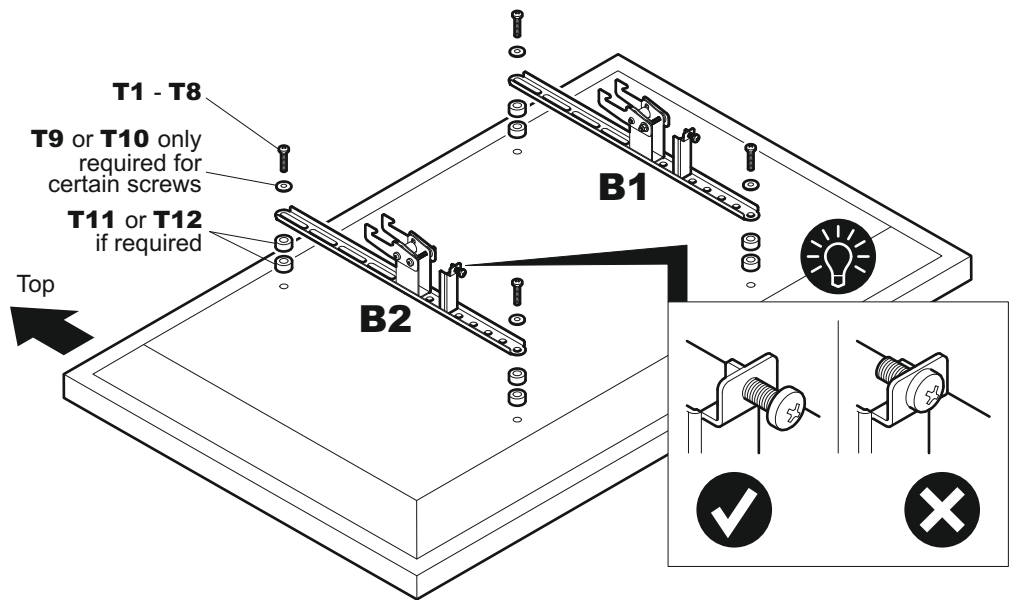

Ensure TV Brackets **B1** and **B2** do not protrude at the top or bottom of your TV

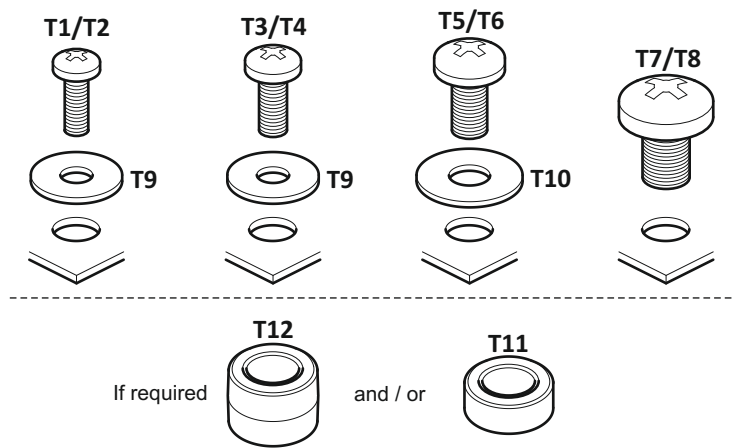
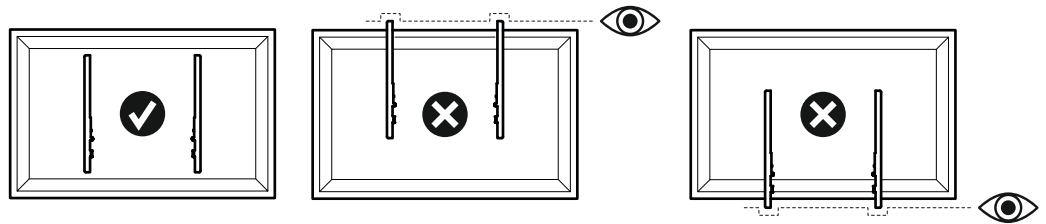

! Attach the bracket to the back of your TV using a suitable combination of screw, washer and spacer combinations. **DO NOT OVERTIGHTEN!** After completing step 3 you will have fittings left over, please keep in a safe place for future reference

4 Solid Wall

! Get it right with our easy to use online TV Height Calculator at myTVMount.com

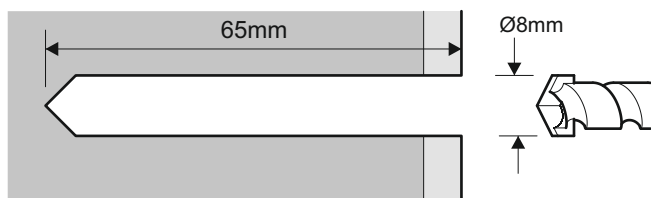
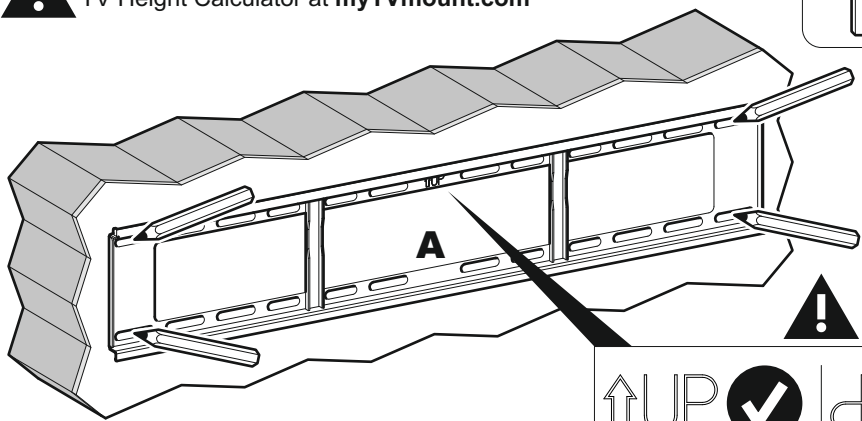
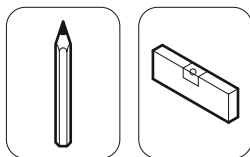

Remove dust from hole

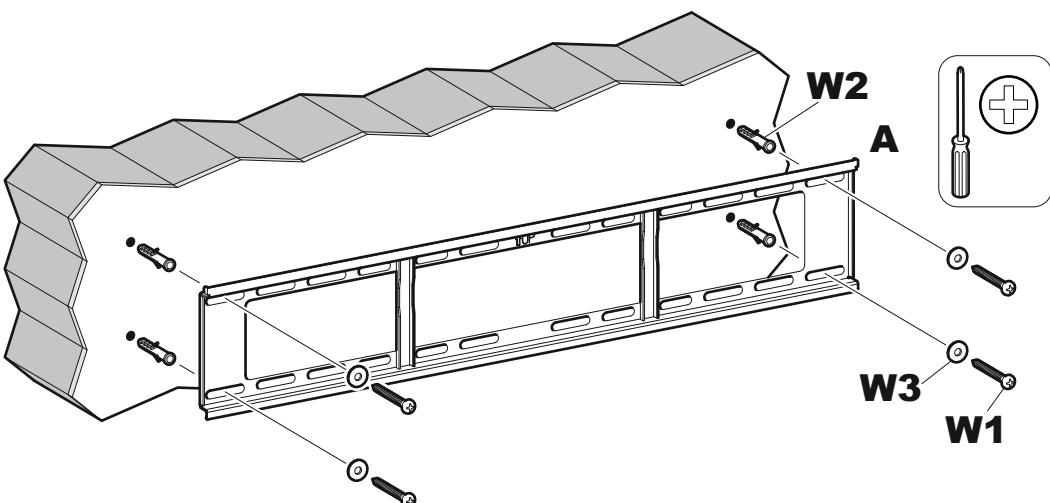
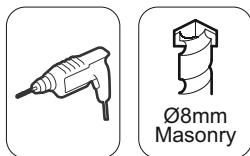

! Tighten with hand tools only **!** Lubricate screw thread with soap

4 Wood Stud

! Get it right with our easy to use online TV Height Calculator at myTVMount.com

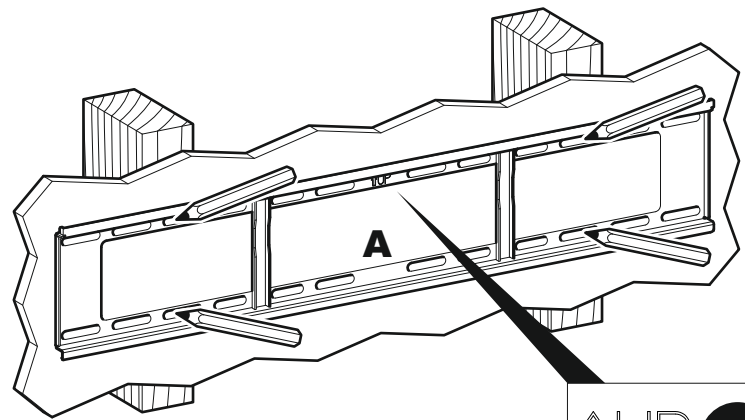
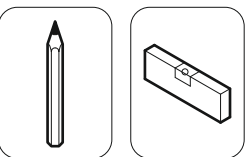

! Ensure drill marks are in the centre of the wood stud

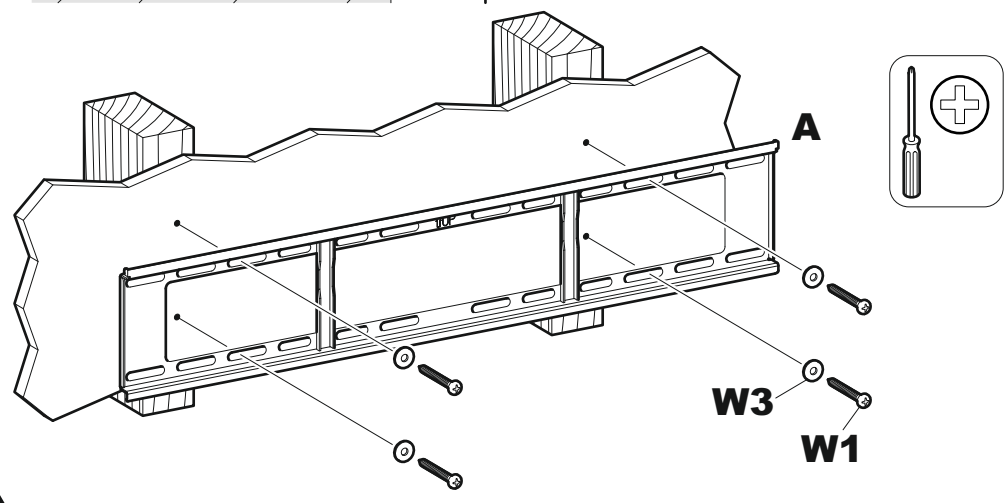
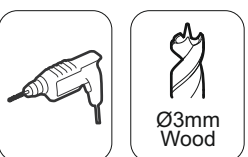
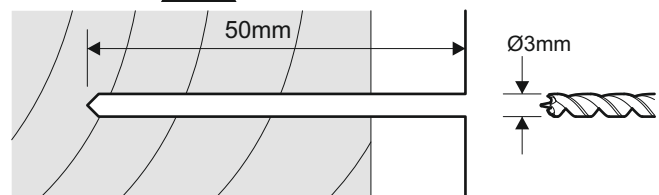

! Do not use **W2** wall plugs in wood stud **!** Tighten with hand tools only **!** Lubricate screw thread with soap