

467940 rev00

IMPORTANT INFORMATION!

We advise that before starting the assembly of this product that you familiarise yourself with the instructions and the parts list in this leaflet.

Do not's

Do not over tighten any part of this assembly.

Do not place hot or cold objects on to or close next to any surface unless the object is sufficiently insulated to prevent contact.

Do not strike the glass with hard or pointed items.

Do not sit or stand on this product.

Do not use washing powders or other substances containing abrasives when cleaning the glass

Do's

Do use a damp cloth with diluted washing up liquid for cleaning the glass surfaces.

Do use a soft cloth with a suitable furniture polish when cleaning the wood panels.

Maximum TV size and weight capacity

Maximum load for this product should not exceed 85kg in total.

Maximum load for the top shelf is 50kg.

Maximum load for the other shelves is 10kg.

Maximum load for the drawer is 4kg.

Caution: Do not load drawer without TV in position.

WARNING:

Wherever possible distribute weight evenly.

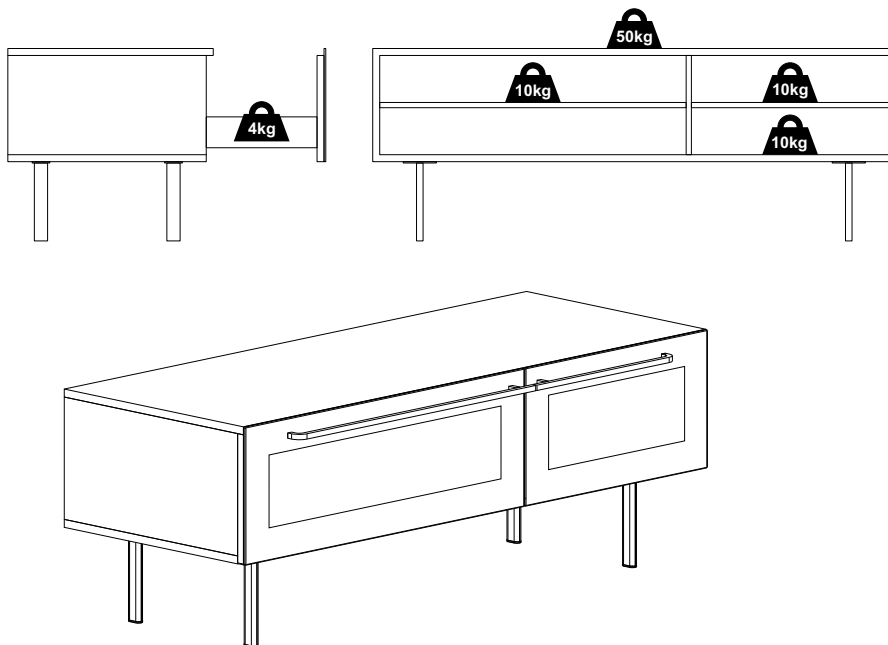

Boxed Parts

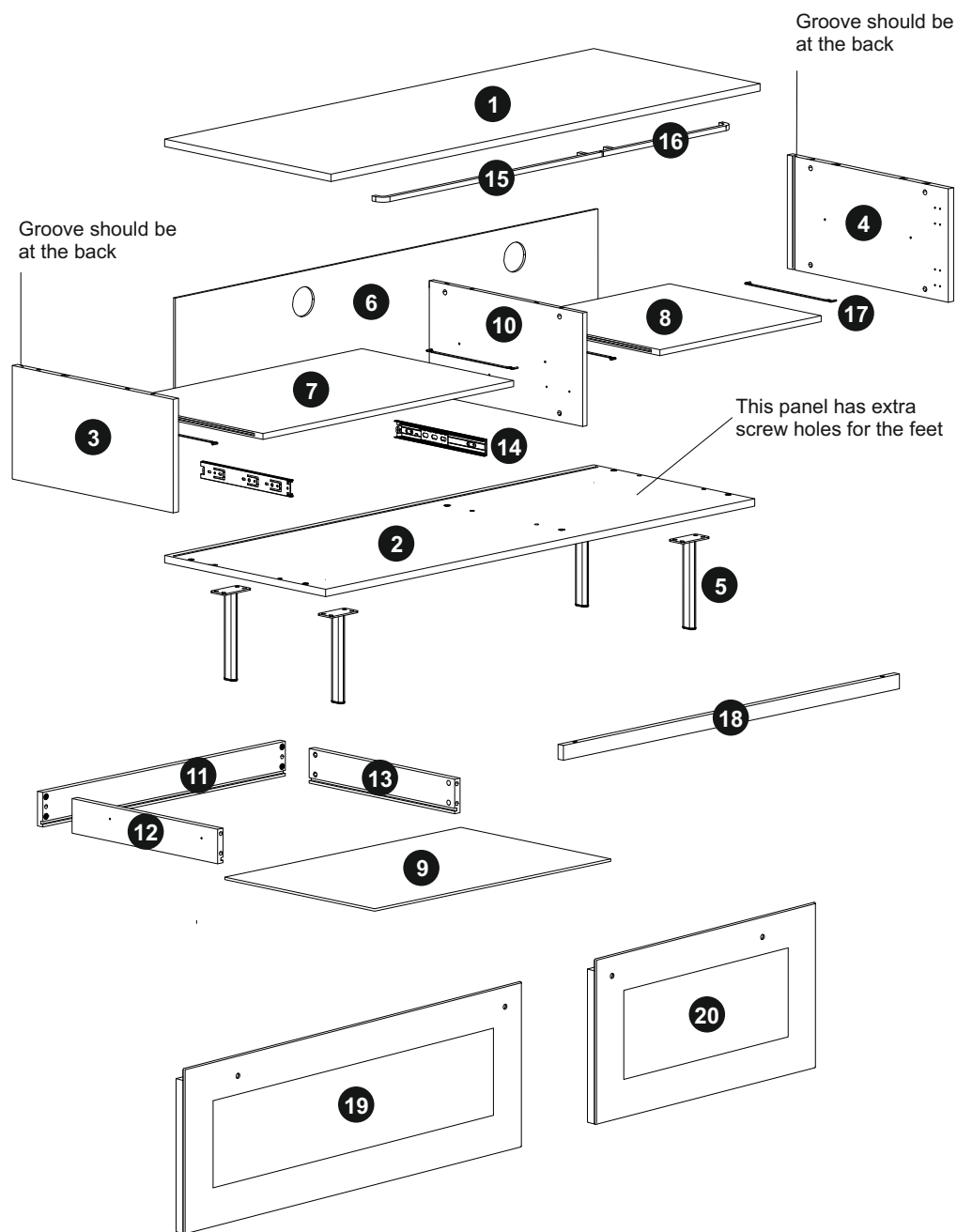

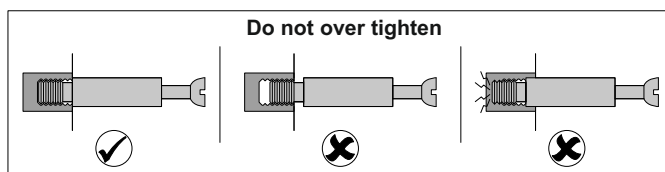
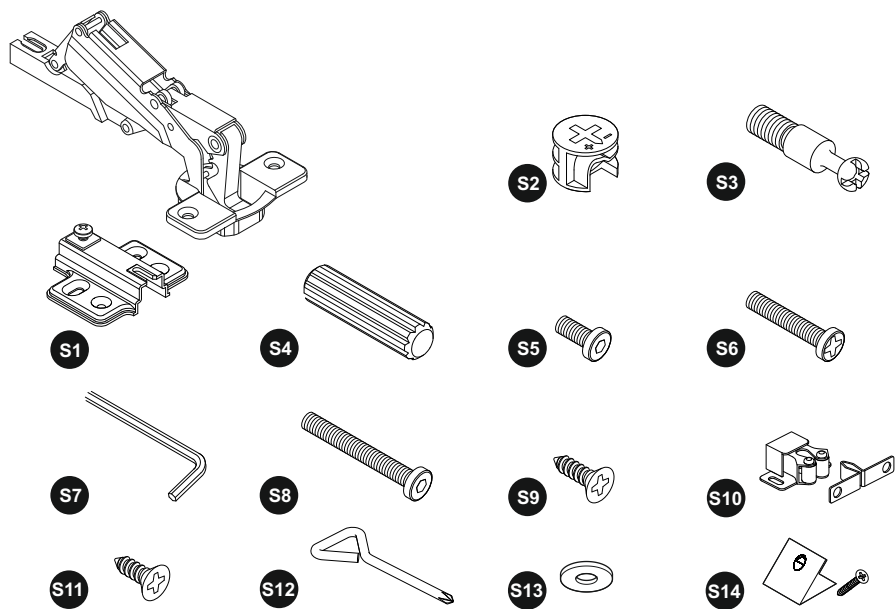

Put a piece of material underneath the panels to prevent damage

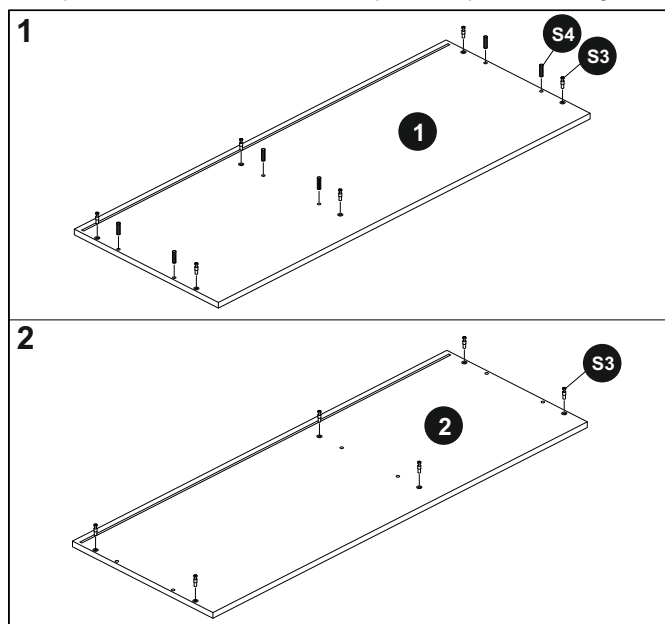

Separate drawer runners **14**

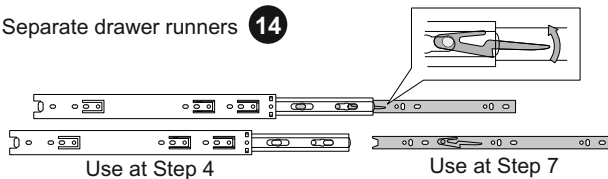

3

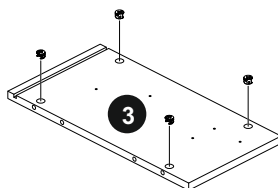
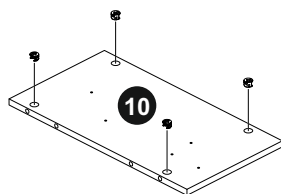
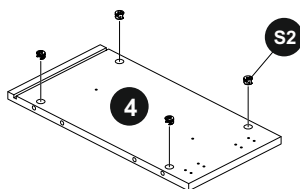
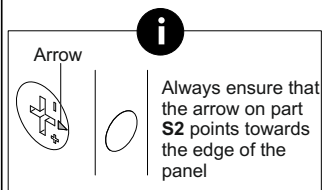

4

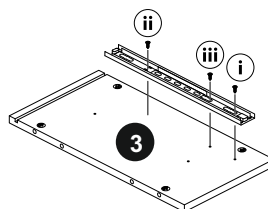
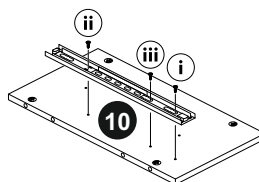
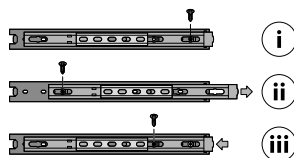
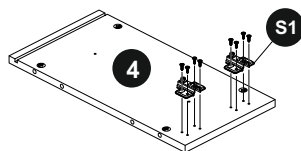

5

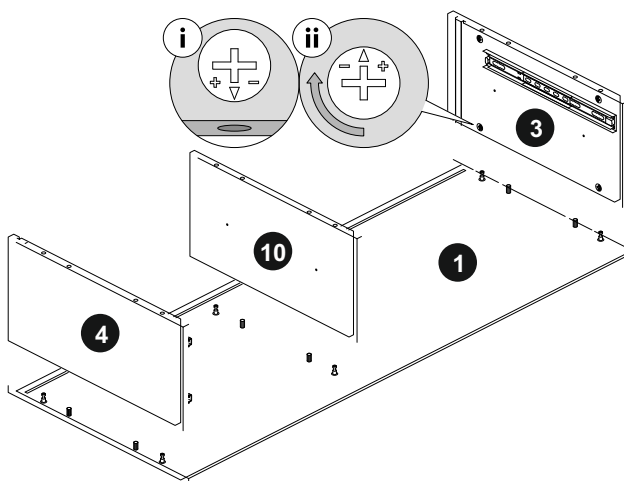

6

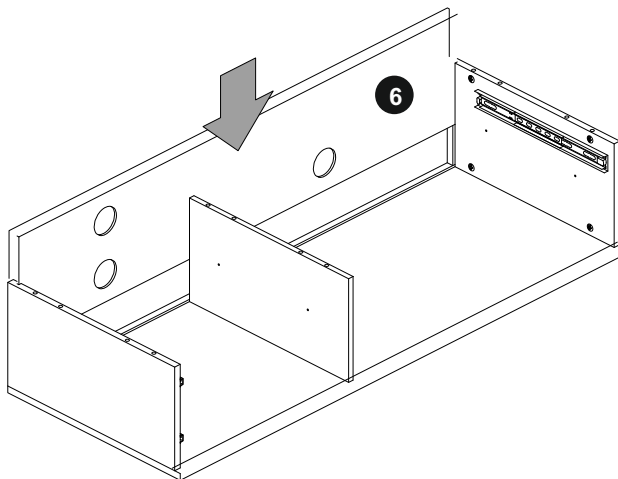

9

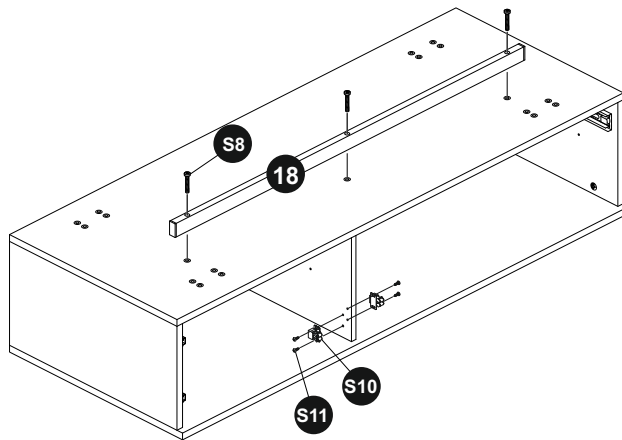

10

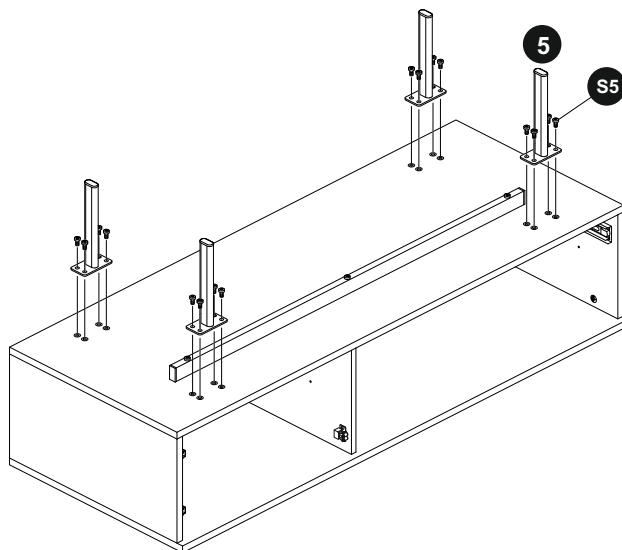

11

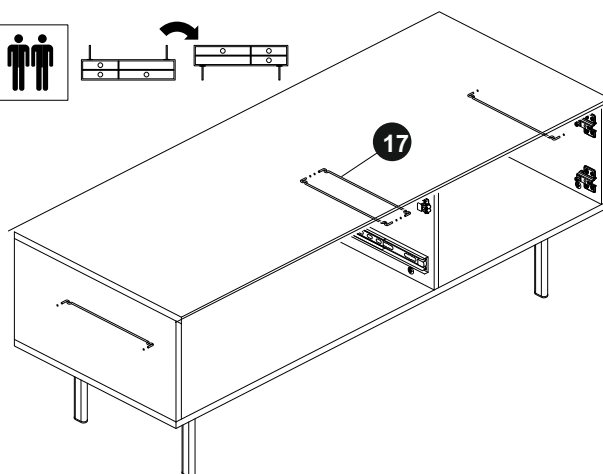
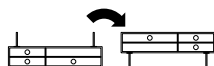

12

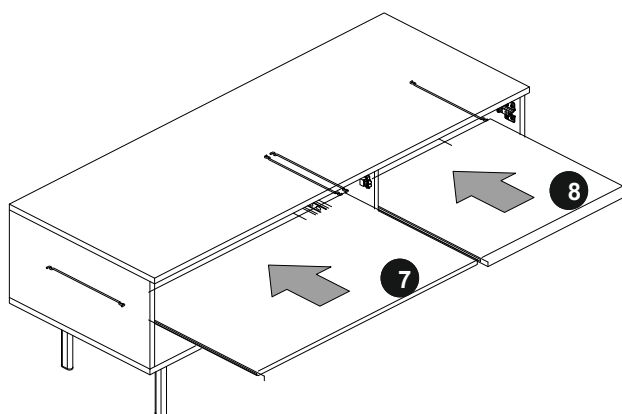

13



Do not over tighten

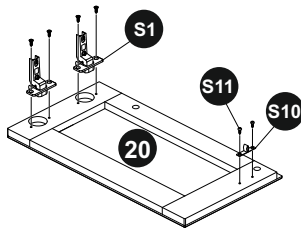

14



Do not over tighten

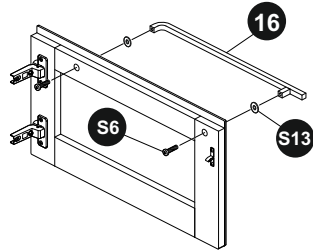

15



See back page for
adjustment tips

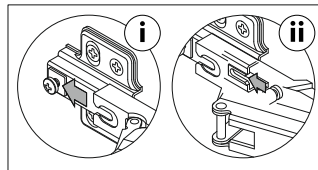
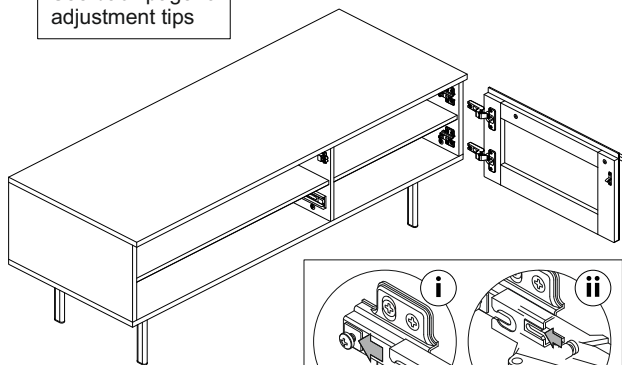

16



Do not over tighten

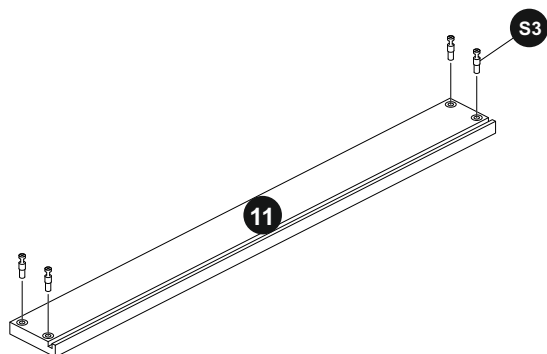

17



Do not over tighten

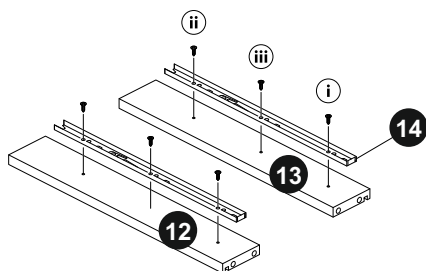
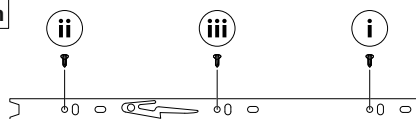

18

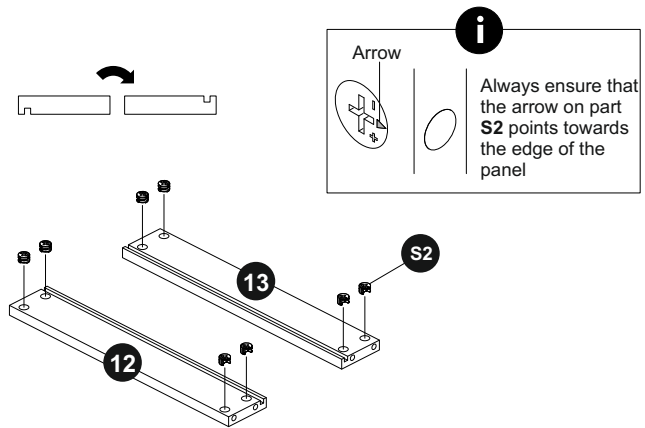

19

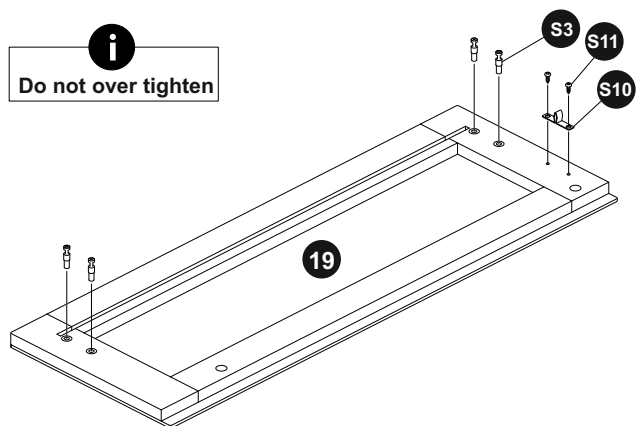

20

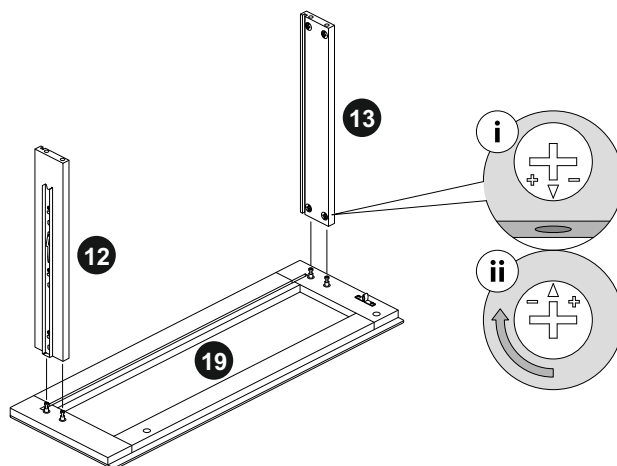

21

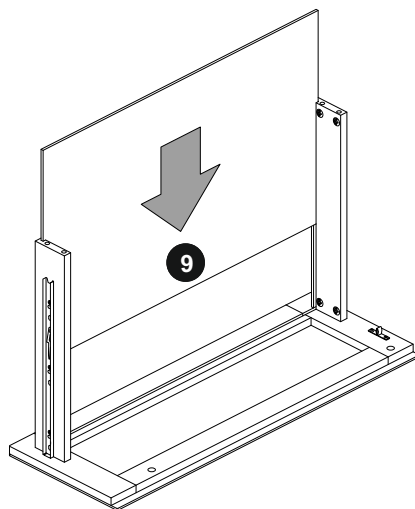

22

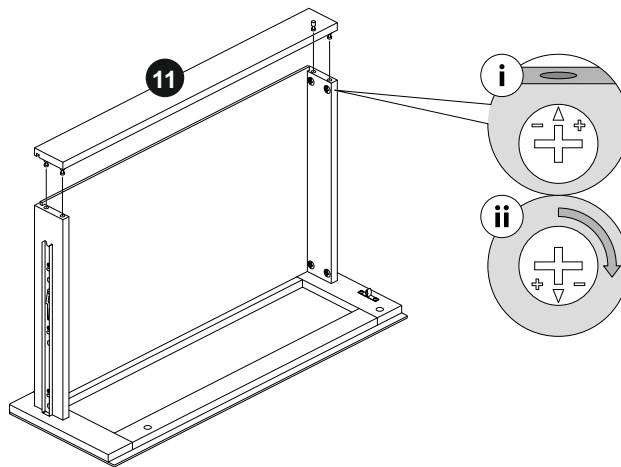

23

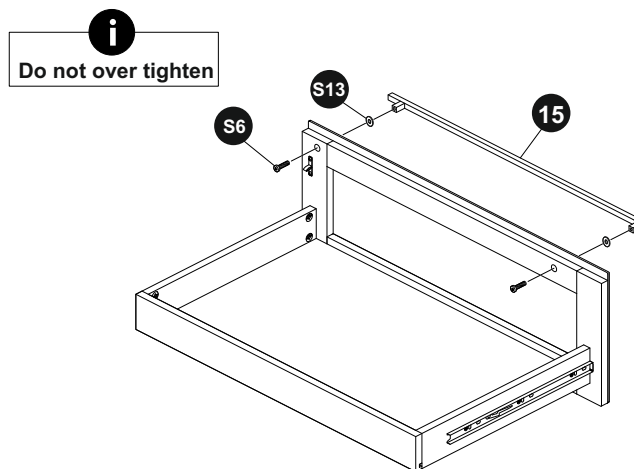

24

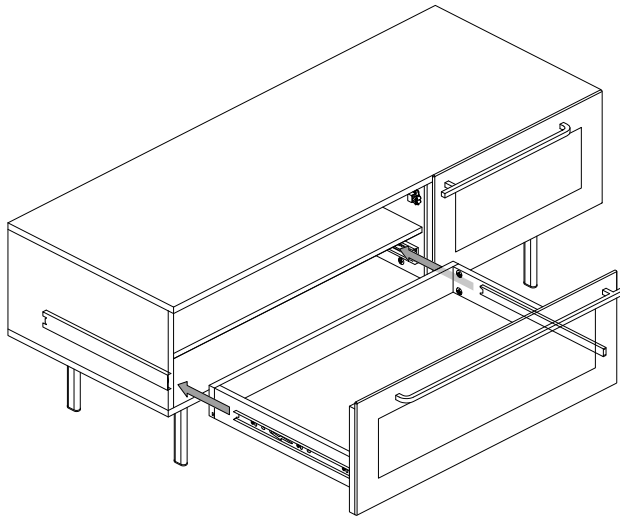

To remove drawer:

Push clip on left hand side up and push clip on right hand side down and slide the drawer out.

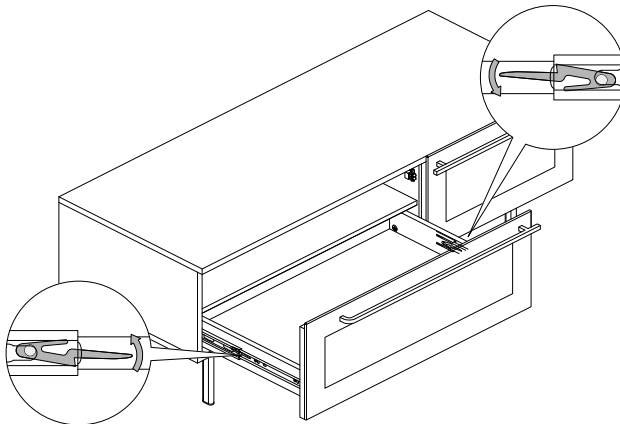

25

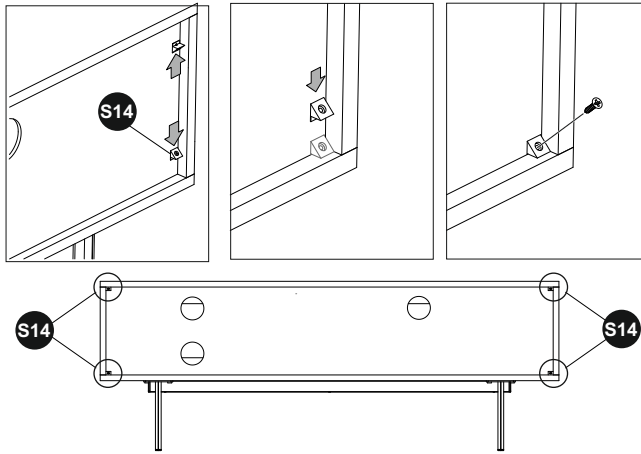

Door adjustment:

Screws **A** and **B** adjust the door to ensure it fits perfectly straight.

