

466324 rev06

TC6

STOP

Read the operating instructions and keep them in a safe place.

If you have any questions about this product or issues with installation contact the help line before returning this product to the store.

Installation video guide and TV Height Calculator tool at [myTVMount.com](https://mytvmount.com)

Help Line: **0333 320 8027**

Monday - Thursday 08:30 - 17:00 Friday 08:30 - 16:00

Calls charged at local rate

30 KG

32-55" TVs

VESA

TV Fixing Holes

75 x 75mm

100 x 100mm, 200 x 100mm

200 x 200mm, 300 x 300mm

400 x 200mm, 400 x 400mm

4 Deciding the correct screw and spacer combination

! When deciding which screw diameter and length is suitable for your TV it is important to **STOP** immediately as soon as you feel any resistance to prevent damage to your TV

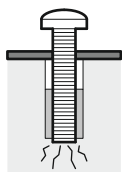

You are provided with 3 diameters of TV fixing screws, **M4**, **M6** and **M8**. Determine the screw diameter that fits and remember for the next step

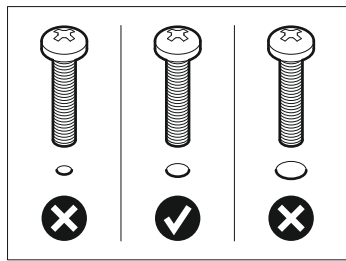
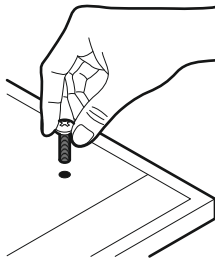

Do I need to use spacers T9 or T10 ?

Spacers are provided so that you can achieve the correct fit between the back of your TV and Mounting Plate, please see below for examples of when spacers are required

No
TV has flat back and flush fixing holes

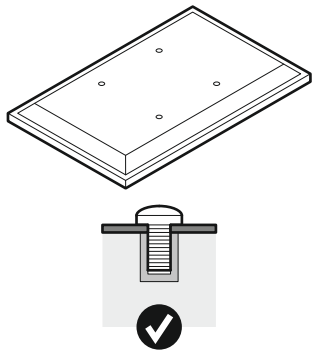

Maybe
TV has flat back with recessed fixing holes

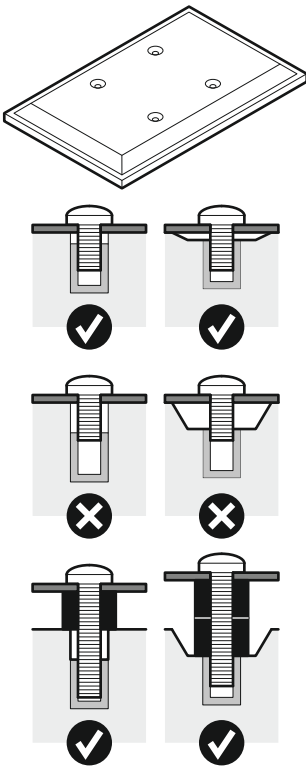

Yes
TV has irregular or obstructed back

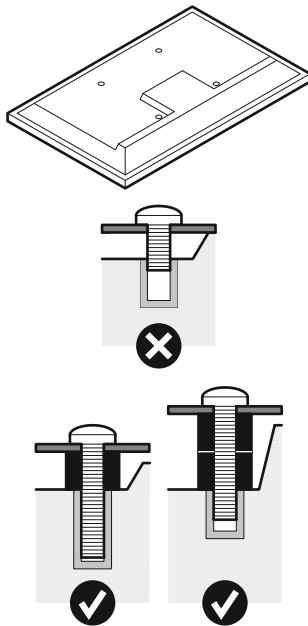

6 Solid Wall

! Get it right with our easy to use online TV Height Calculator at myTVMount.com

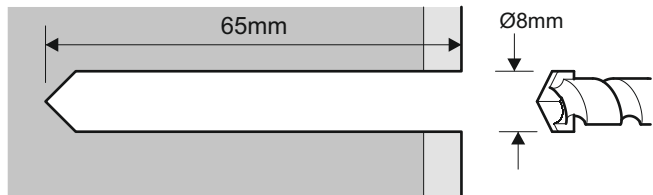
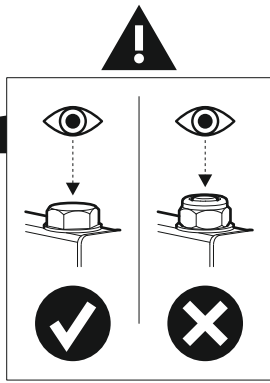
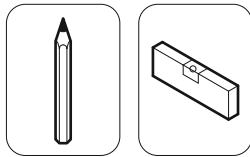
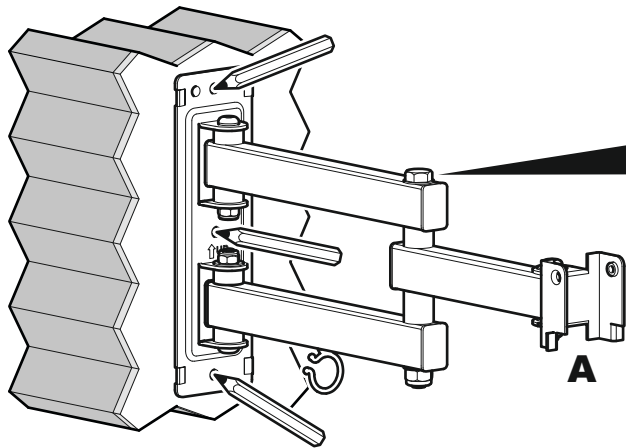

Remove dust from hole

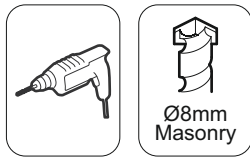

Ø8mm Masonry

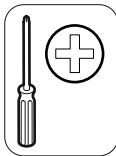
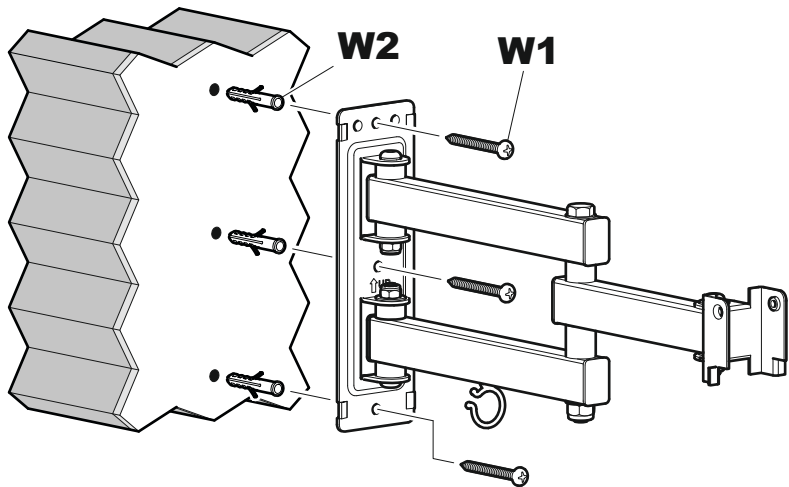

! Tighten with hand tools only

💡 Lubricate screw thread with soap

5 Fitting the TV Mounting Plate

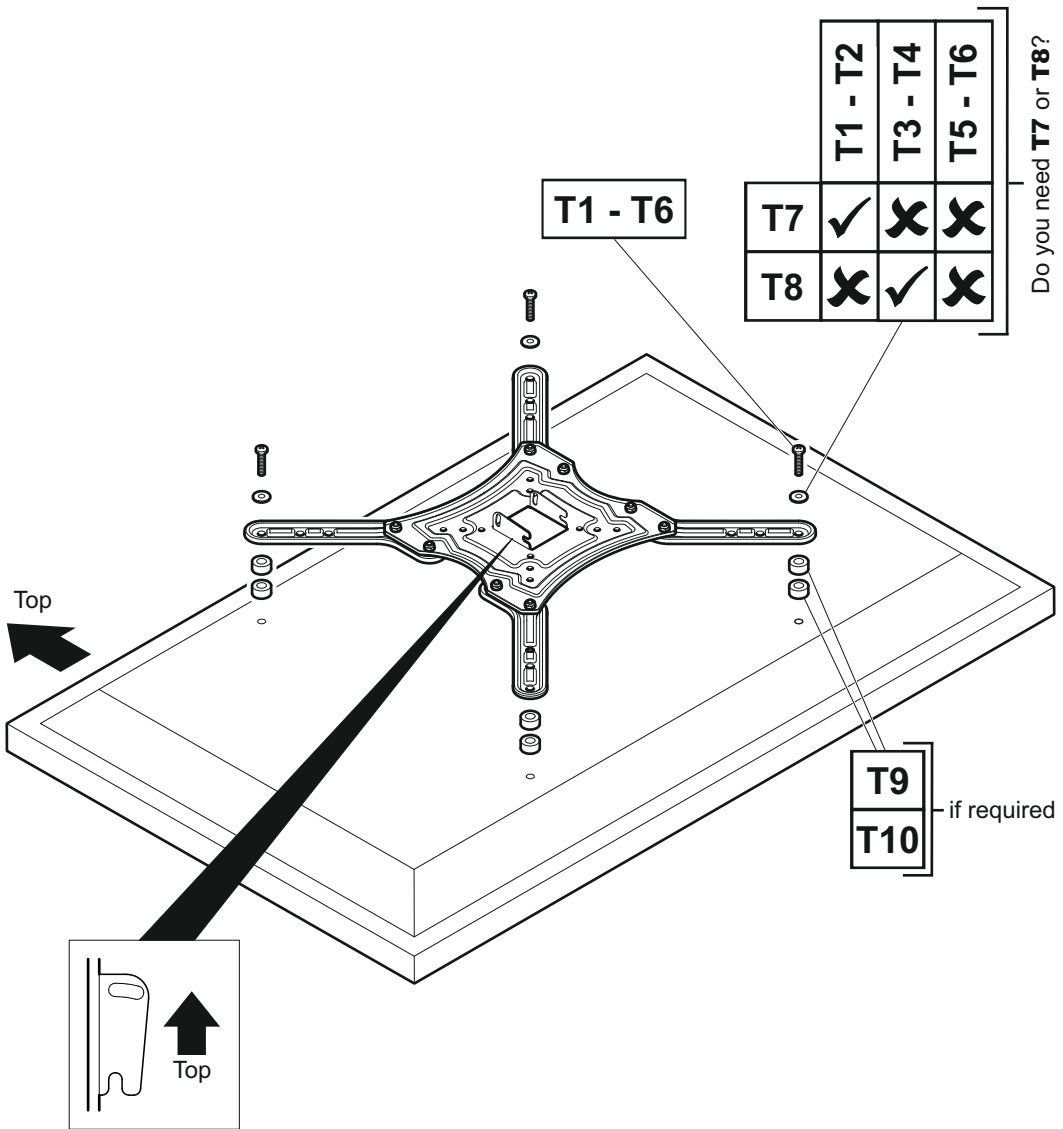

! Attach the bracket to the back of your TV using a suitable combination of screw, washer and spacer combinations. **DO NOT OVERTIGHTEN!**

💡 After completing step 5 you will have fittings left over, please keep in a safe place for future reference

6 Wood Stud

! Get it right with our easy to use online TV Height Calculator at myTVMount.com

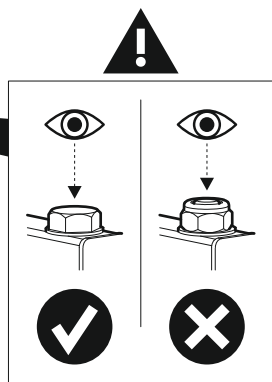
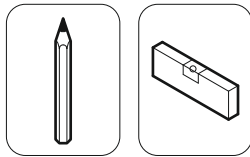
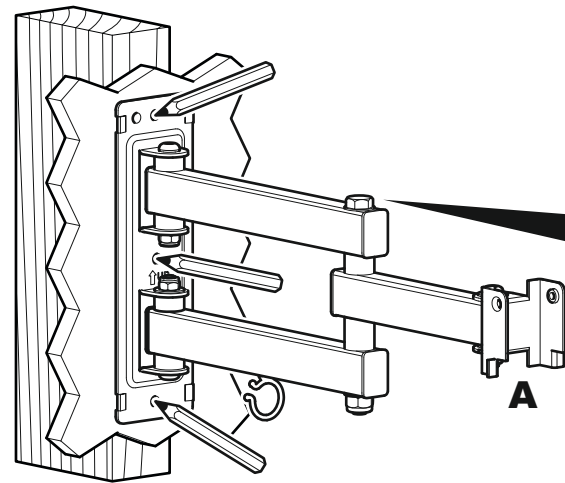

! Ensure drill marks are in the centre of the wood stud

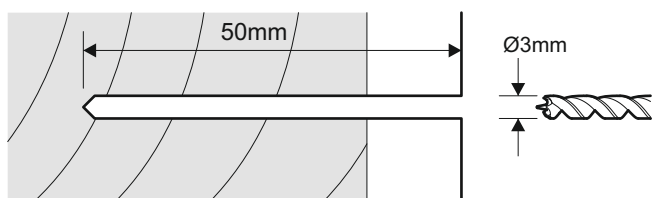

Ø3mm Wood

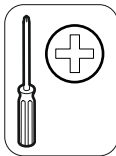
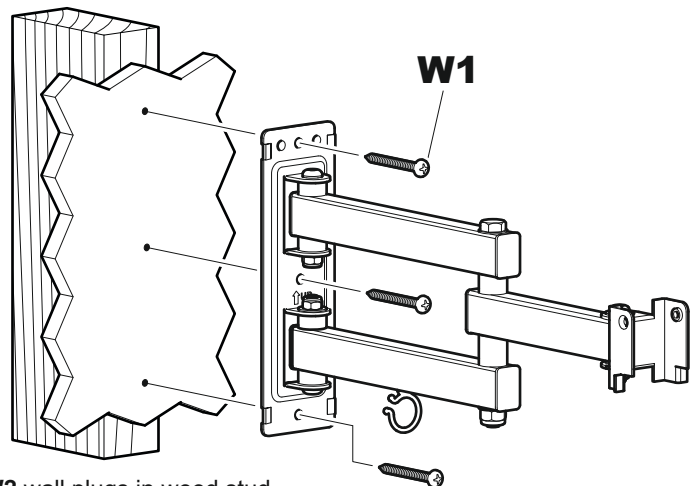

! Do not use W2 wall plugs in wood stud

! Tighten with hand tools only

💡 Lubricate screw thread with soap