

4 Deciding the correct screw and spacer combination

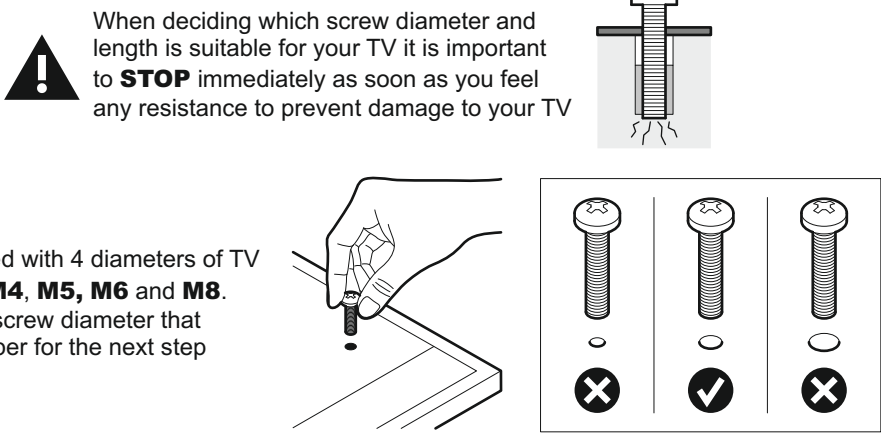

You are provided with 4 diameters of TV fixing screws, **M4, M5, M6** and **M8**. Determine the screw diameter that fits and remember for the next step

Do I need to use spacers T11 or T12 ?

Spacers are provided so that you can achieve the correct fit between the back of your TV and Mounting Plate, please see below for examples of when spacers are required

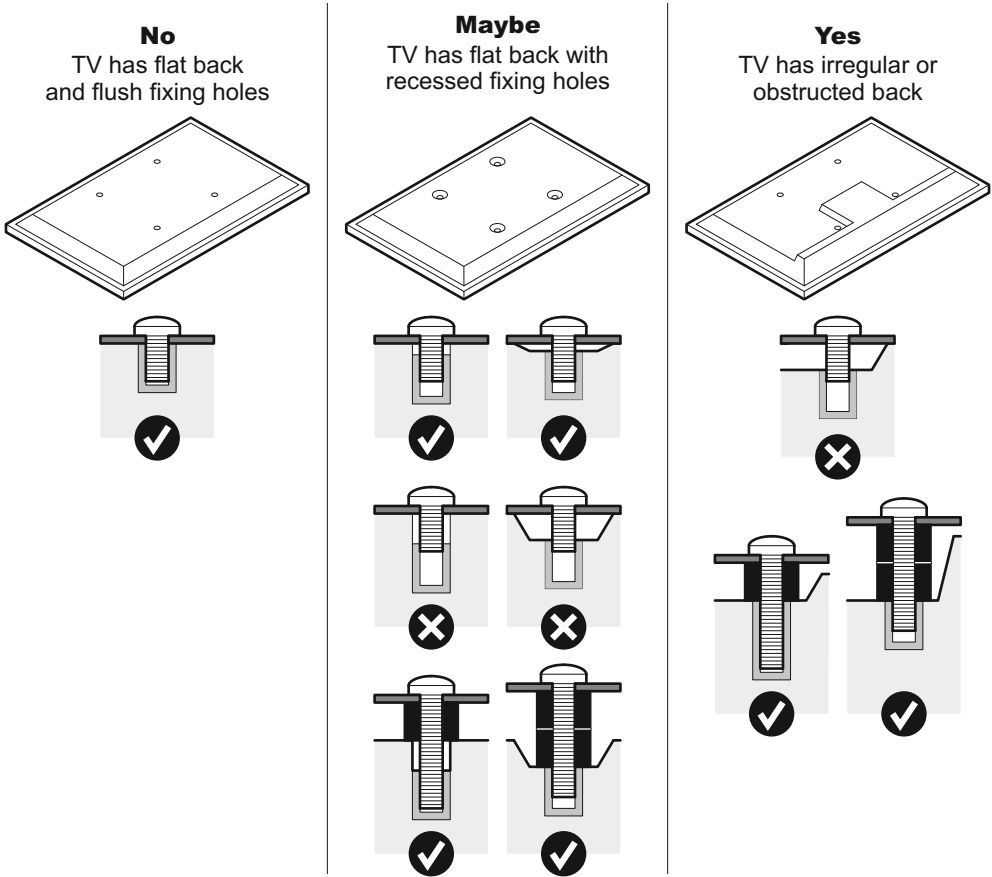

5 Fitting the TV Mounting Plate

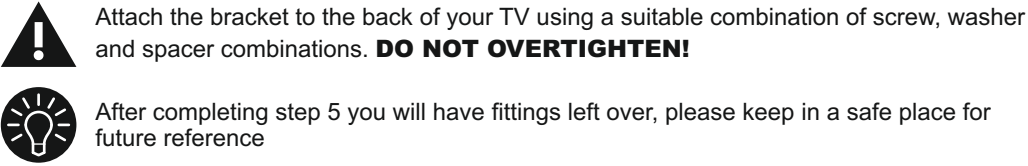
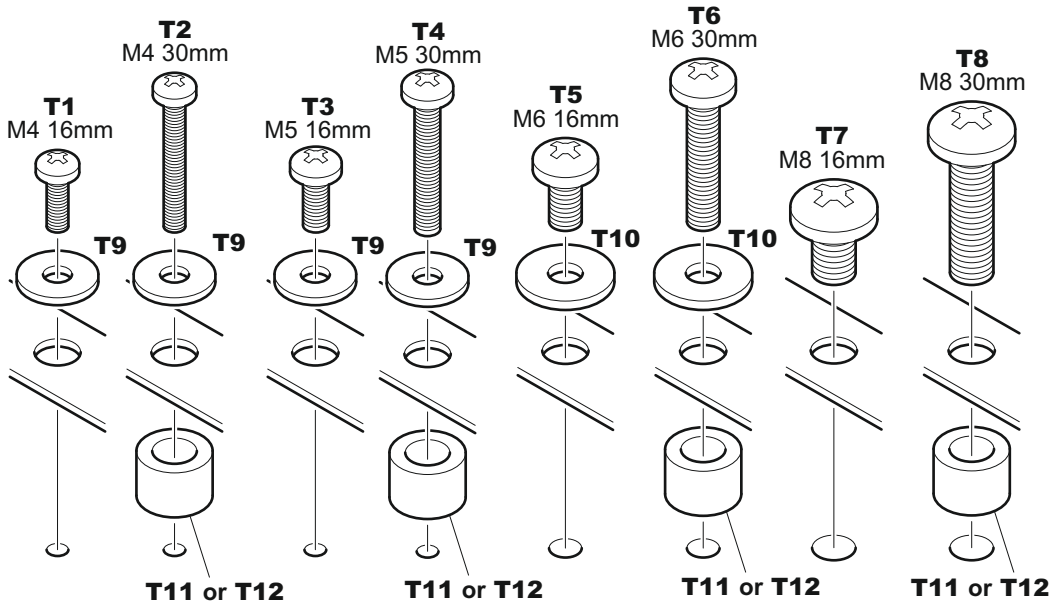
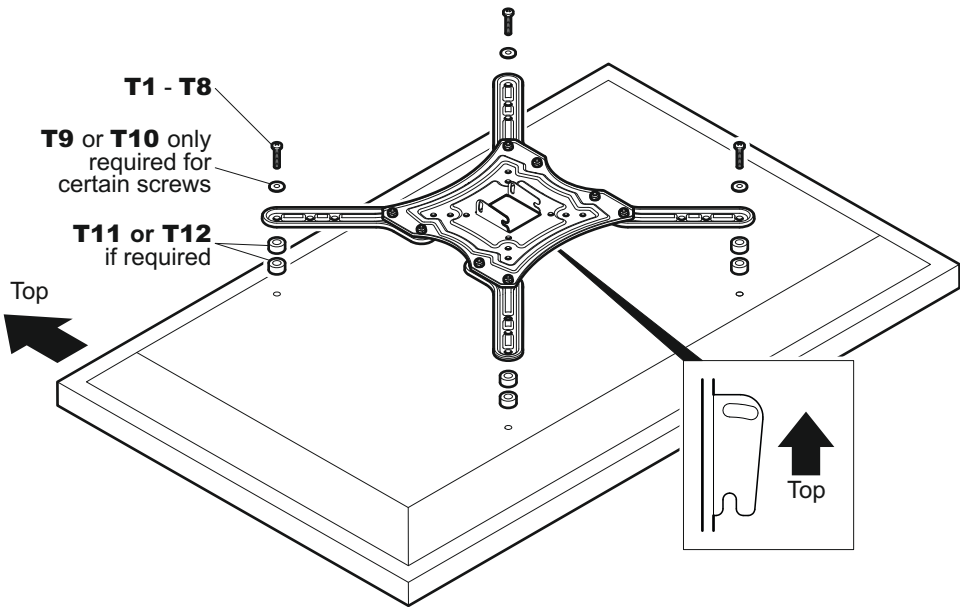

6 Solid Wall

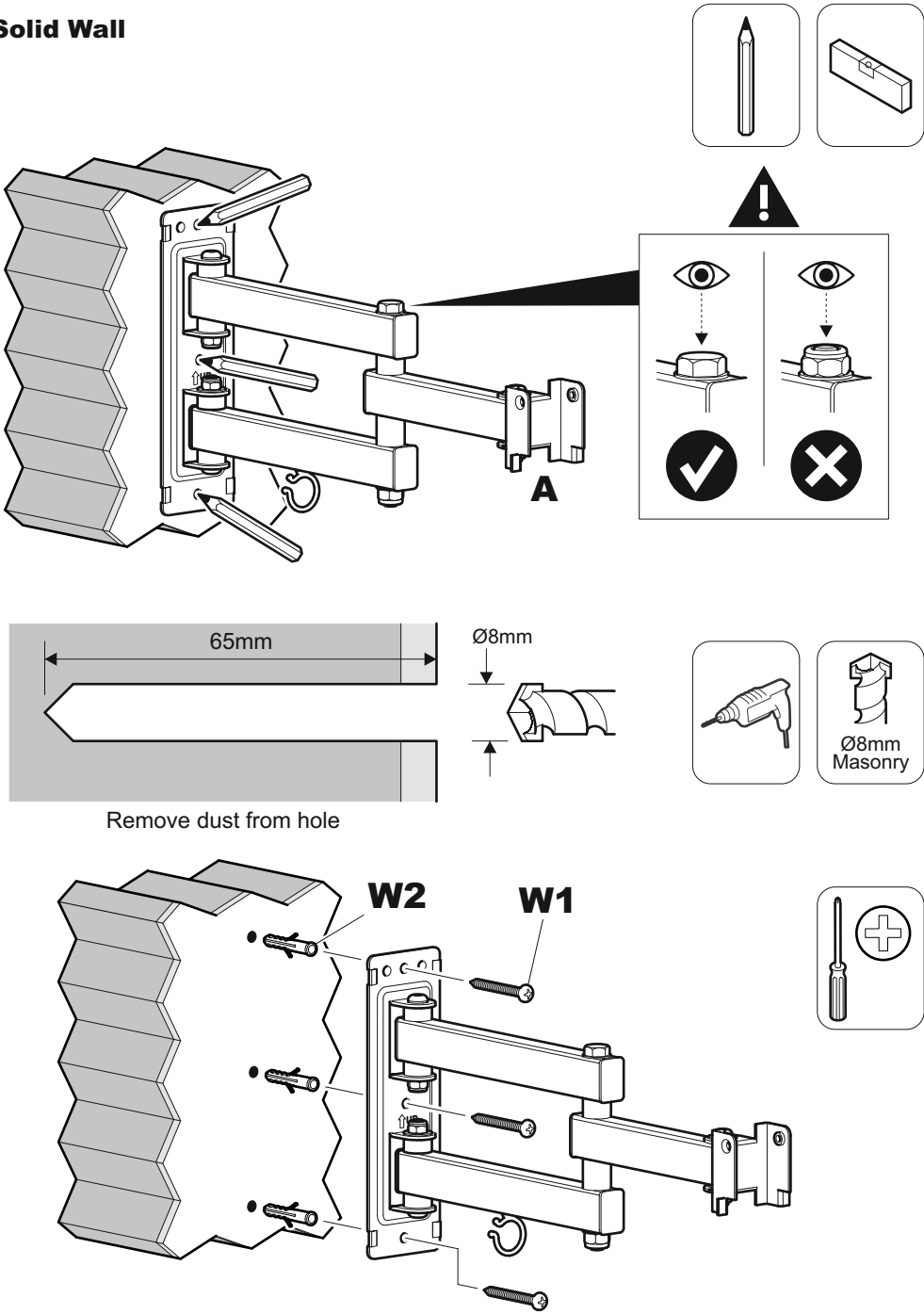

6 Wood Stud

