

IF YOU ARE IN ANY DOUBT, CONSULT A QUALIFIED CONTRACTOR

Periodically check all nuts and bolts are tight.

TESCO accept no responsibility for any damage or loss caused by installing this product in a sub standard wall.

void of any services (eg gas, electricity, water etc).

It is the responsibility of the installer to ensure that the mounting wall is of a suitable standard and ensure the product is correctly installed.

This product is sold as a home DIY product and as such, it is the responsibility of the installer to personal injury.

This product is intended for indoor use only. Use of this product outdoors could lead to failure and specification of your TV.

You will not need all these parts, so expect there to be some left over depending upon the Contents may vary from photograph/illustrations.

Retain all packaging in case the bracket needs to be returned.

TC3

466323 rev06

TESCO

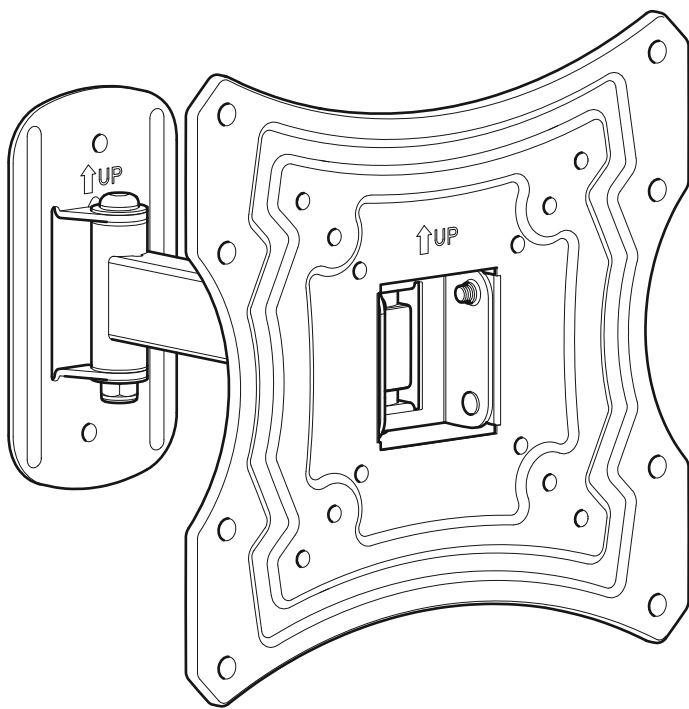

Read the operating instructions and keep them in a safe place.
If you have any questions about this product or issues with installation
contact the help line before returning this product to the store.

Installation video guide and TV Height Calculator
tool at myTVMount.com

Help Line: **0333 320 8027**

Monday - Thursday 08:30 - 17:00 Friday 08:30 - 16:00
Calls charged at local rate



75 x 75mm
100 x 100mm
200 x 100mm
200 x 200mm

3 Deciding the correct screw and spacer combination

! When deciding which screw diameter and length is suitable for your TV it is important to **STOP** immediately as soon as you feel any resistance to prevent damage to your TV

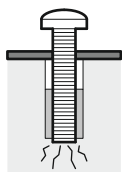

You are provided with 3 diameters of TV fixing screws, **M4**, **M6** and **M8**. Determine the screw diameter that fits and remember for the next step

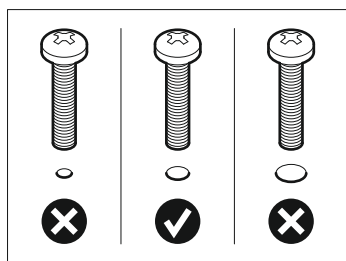
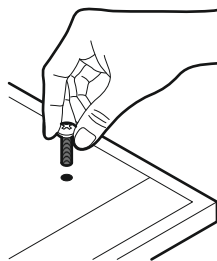

Do I need to use spacers T9 or T10?

Spacers are provided so that you can achieve the correct fit between the back of your TV and Mounting Plate, please see below for examples of when spacers are required

No
TV has flat back and flush fixing holes

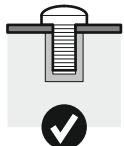
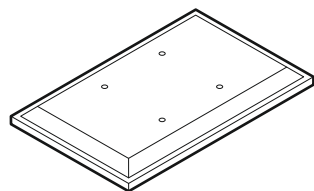

Maybe
TV has flat back with recessed fixing holes

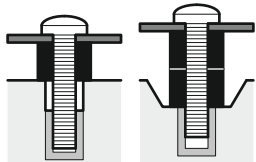
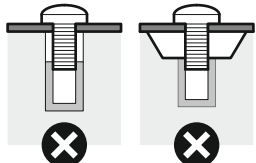
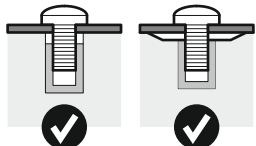
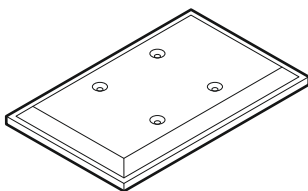

Yes
TV has irregular or obstructed back

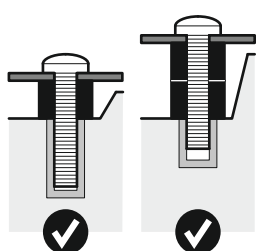
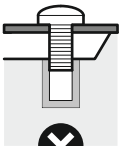
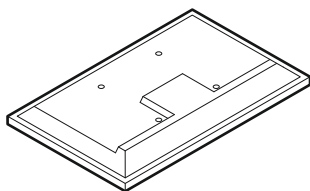

5 Solid Wall

! Get it right with our easy to use online TV Height Calculator at myTVMount.com

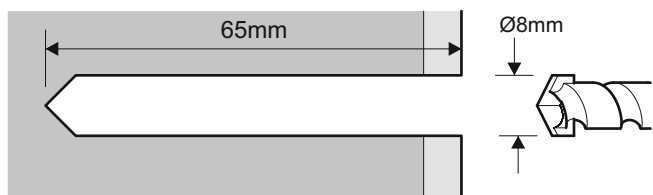
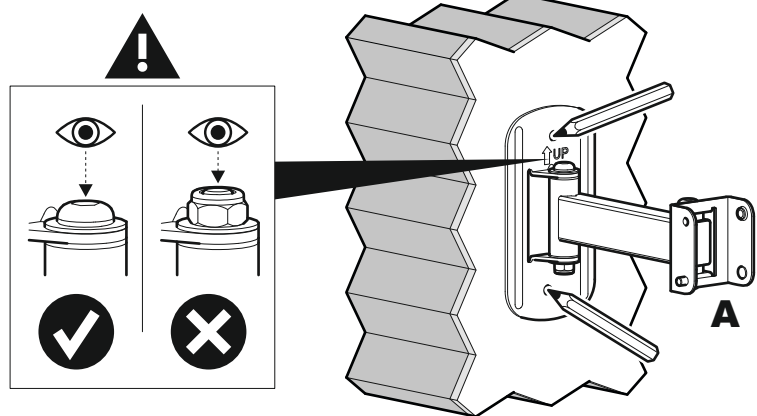
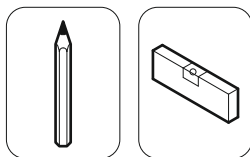

Remove dust from hole

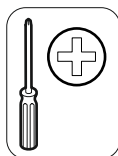
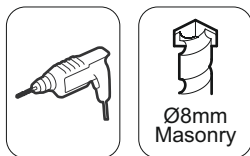

! Tighten with hand tools only

💡 Lubricate screw thread with soap

4 Fitting the TV Mounting Plate

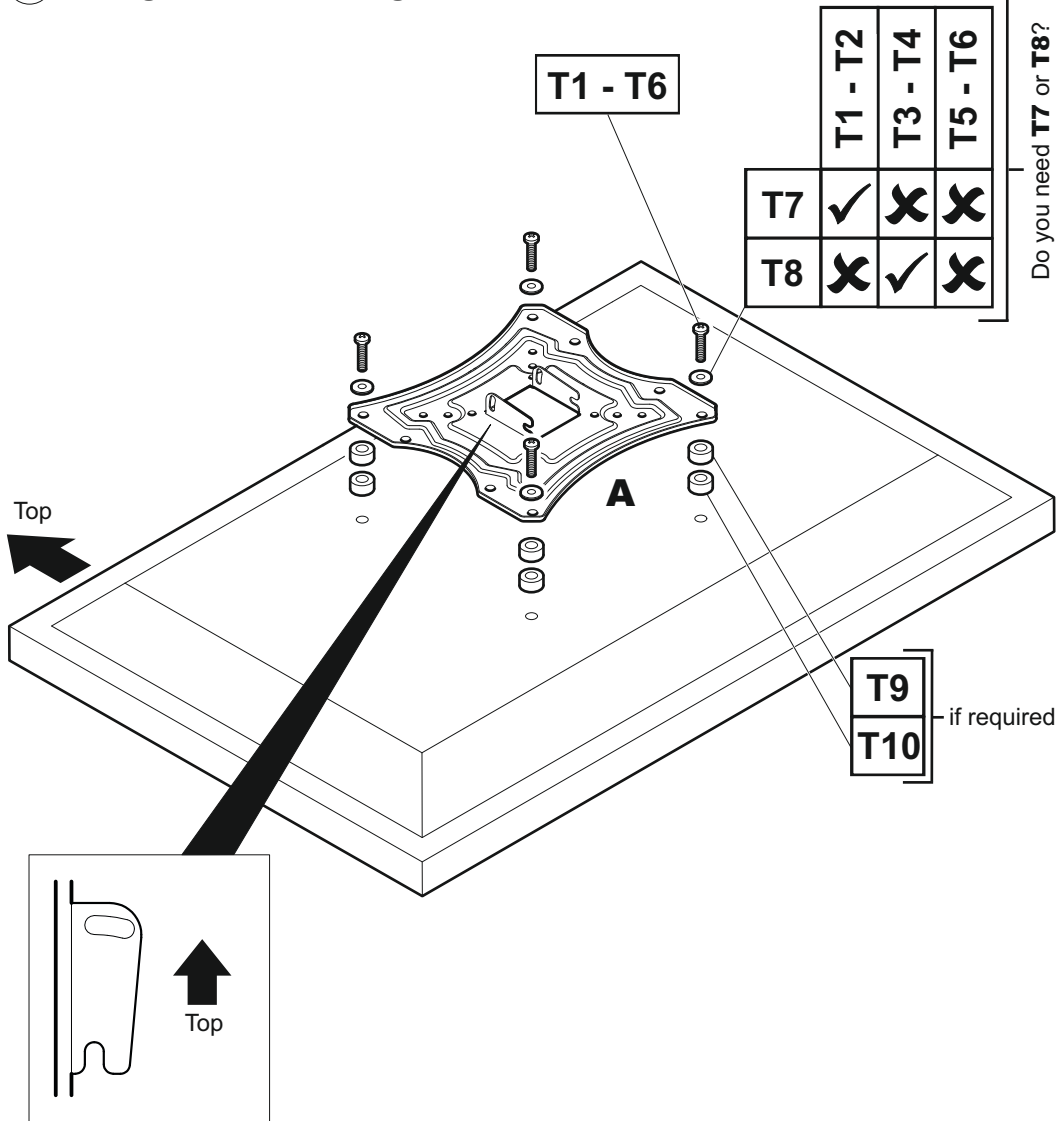

	T1 - T2	T3 - T4	T5 - T6
T7	✓	✗	✗
T8	✗	✓	✗

Do you need T7 or T8?

! Attach the bracket to the back of your TV using a suitable combination of screw, washer and spacer combinations. **DO NOT OVERTIGHTEN!**

💡 After completing step 4 you will have fittings left over, please keep in a safe place for future reference

5 Wood Stud

! Get it right with our easy to use online TV Height Calculator at myTVMount.com

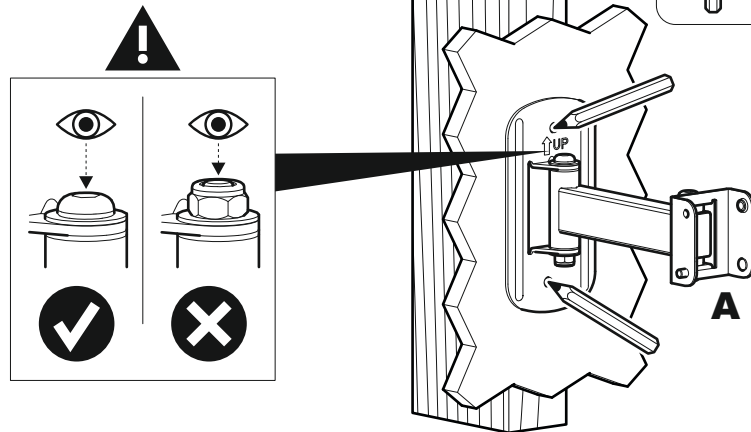
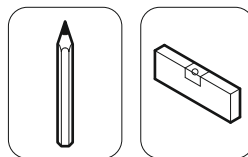

! Ensure drill marks are in the centre of the wood stud

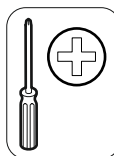
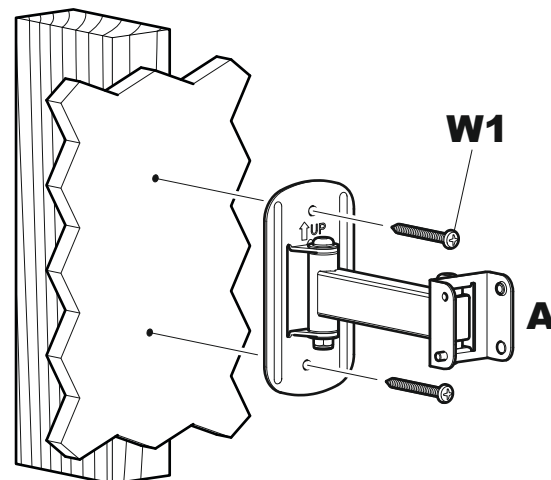
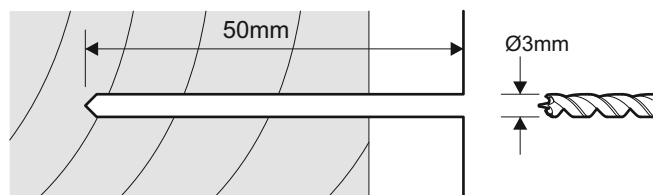

! Do not use W2 wall plugs in wood stud

! Tighten with hand tools only

💡 Lubricate screw thread with soap