

6 Connect TV

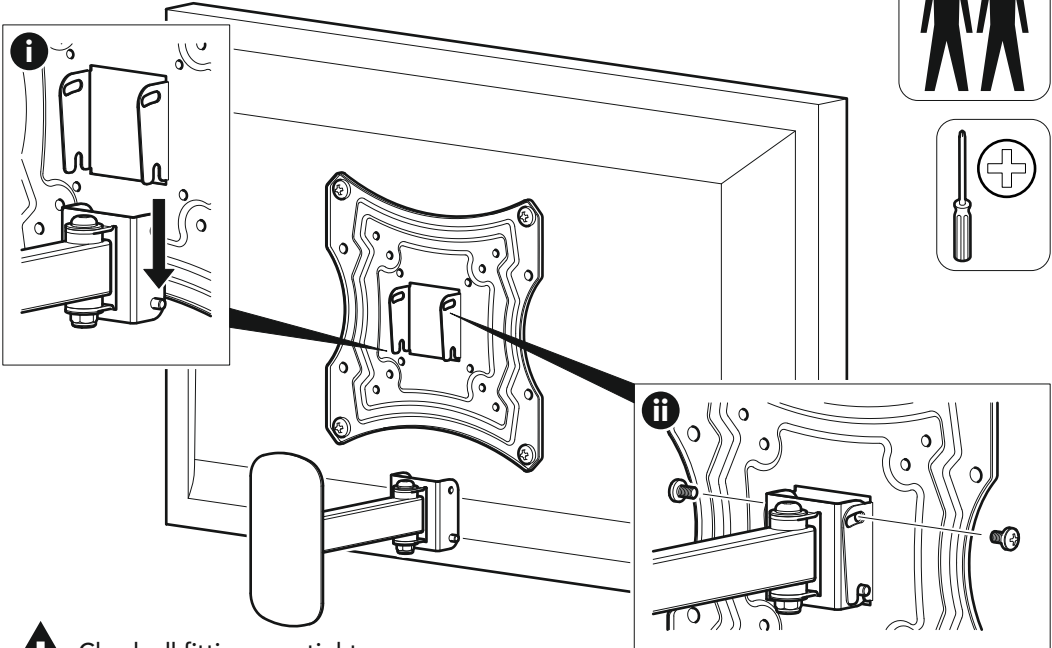

Lock tilt

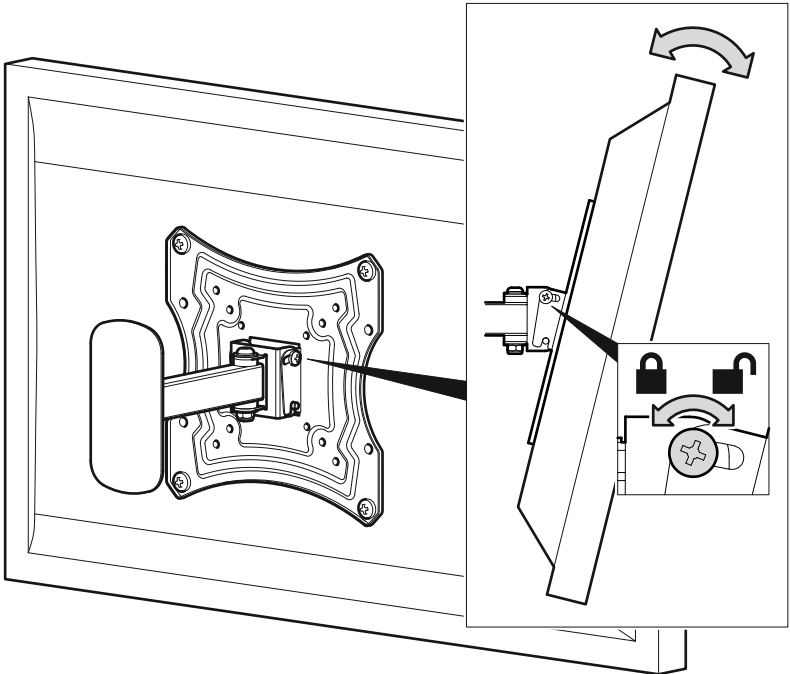

TC3

466323 rev01

TESCO

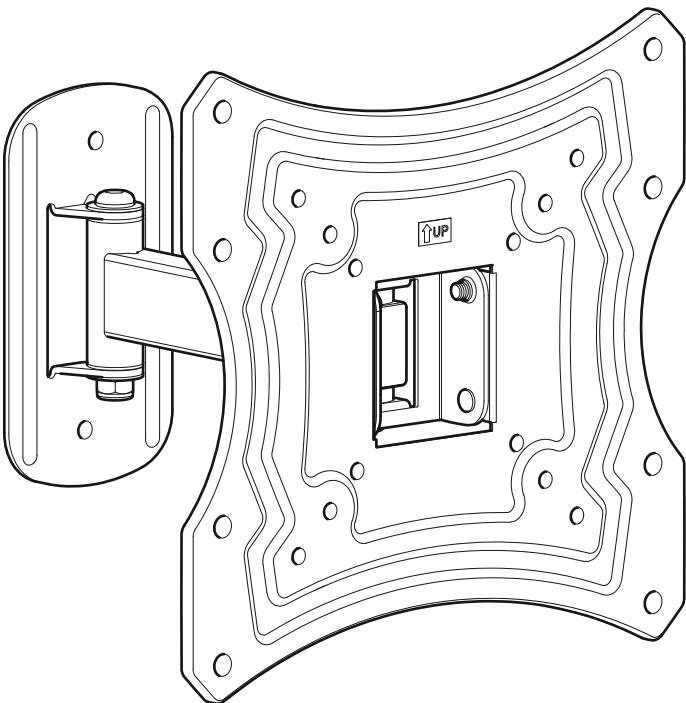

STOP

Read the operating instructions and keep them in a safe place.  
If you have any questions about this product or issues with installation  
contact the help line before returning this product to the store.

Help Line: 0333 320 8027

Monday - Thursday 08:30 - 17:00 Friday 08:30 - 16:00  
Calls charged at local rate

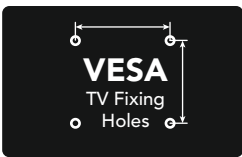

75 x 75mm  
100 x 100mm  
200 x 100mm  
200 x 200mm

IF YOU ARE IN ANY DOUBT, CONSULT A QUALIFIED CONTRACTOR

Periodically check all nuts and bolts are tight.  
standard wall.  
TESCO accept no responsibility for any damage or loss caused by installing this product in a sub  
void of any services (eg gas, electricity, water etc).  
It is the responsibility of the installer to ensure that the mounting wall is of a suitable standard and  
ensure the product is correctly installed.  
This product is sold as a home DIY product and as such, it is the responsibility of the installer to  
personal injury.  
This product is intended for indoor use only. Use of this product outdoors could lead to failure and  
specification of your TV.  
You will not need all these parts, so expect there to be some left over depending upon the  
Contents may vary from photography/ illustrations.  
Retain all packaging in case the bracket needs to be returned.

Tools Recommended

Box Contents

C1 x4 M4 12mm  
C2 x4 M4 30mm  
C3 x4 M6 12mm  
C4 x4 M6 30mm  
C5 x4 M8 12mm  
C6 x4 M8 30mm  
D x8  
B1 x4 M5  
B2 x4 M6  
E x2  
F x2 (for solid wall only)

Wood Ø3mm  
Masonry Ø8mm

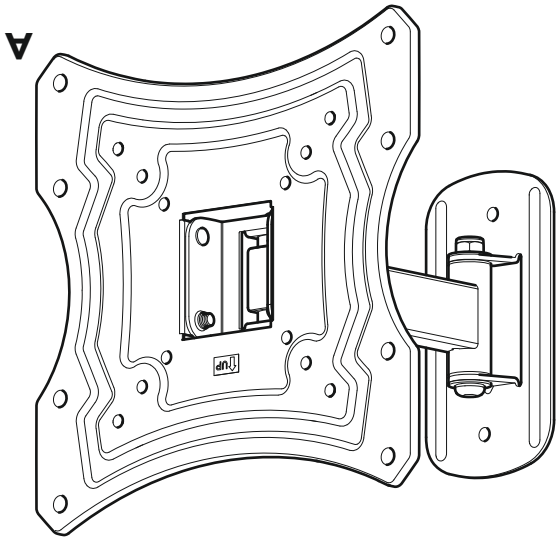

### 3 Deciding the correct screw and spacer combination

**!** When deciding which screw diameter and length is suitable for your TV it is important to **STOP** immediately as soon as you feel any resistance to prevent damage to your TV

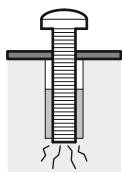

You are provided with 3 diameters of TV fixing screws, **M4**, **M6** and **M8**. Determine the screw diameter that fits and remember for the next step

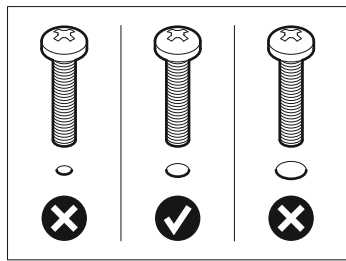
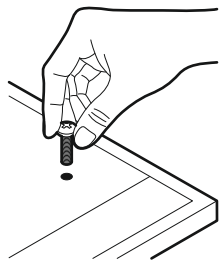

#### Do I need to use spacers D?

Spacers are provided so that you can achieve the correct fit between the back of your TV and Mounting Plate, please see below for examples of when spacers are required

**No**  
TV has flat back and flush fixing holes

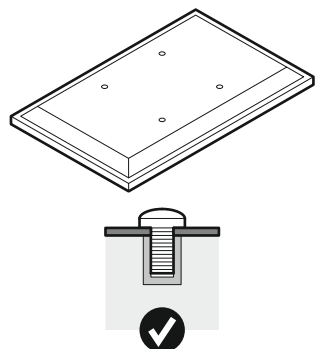

**Maybe**  
TV has flat back with recessed fixing holes

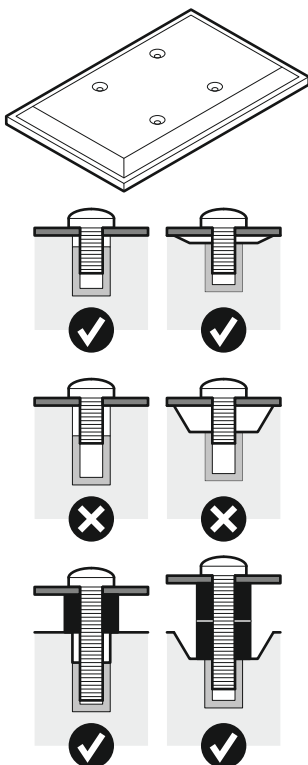

**Yes**  
TV has irregular or obstructed back

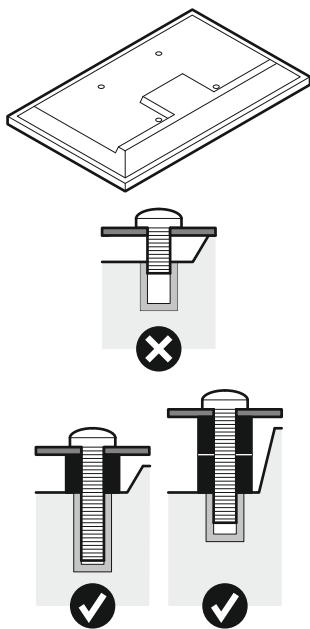

### 4 Fitting the TV Mounting Plate

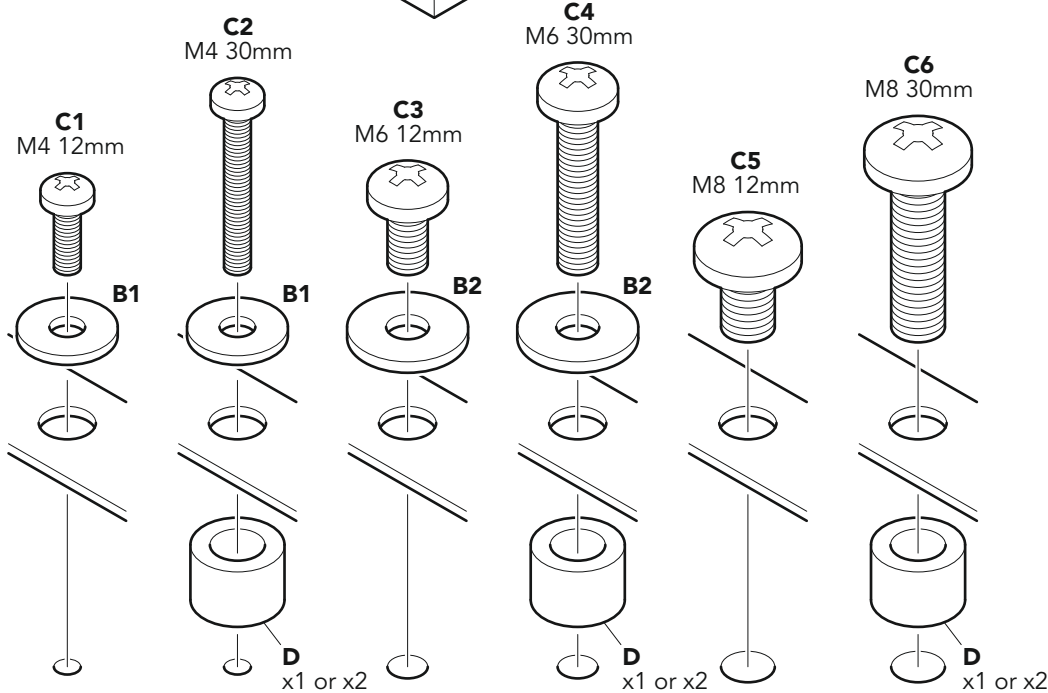
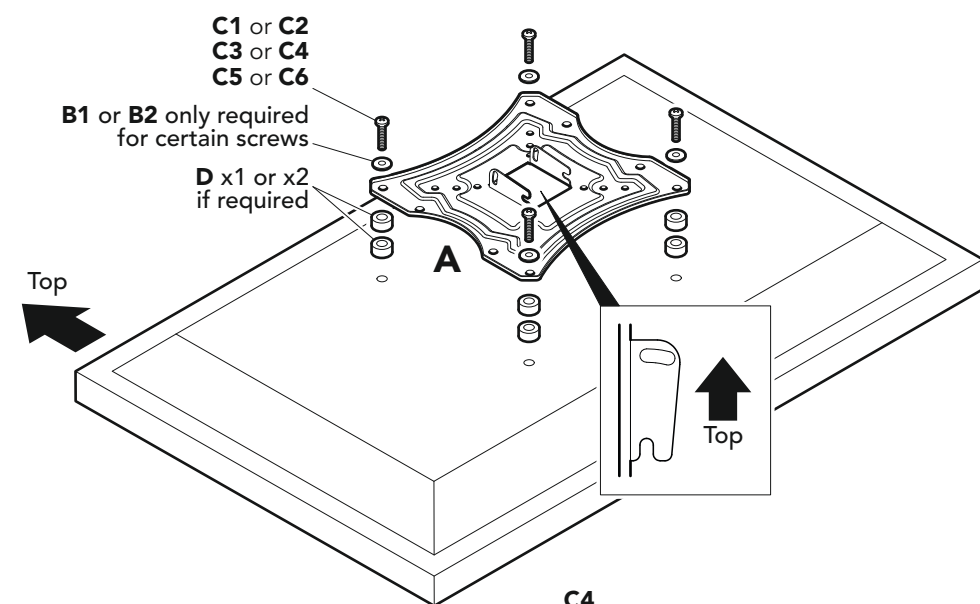

**!** Attach the bracket to the back of your TV using a suitable combination of screw, washer and spacer combinations. **DO NOT OVERTIGHTEN!**

**💡** After completing step 3 you will have fittings left over, please keep in a safe place for future reference

### 5 Solid Wall

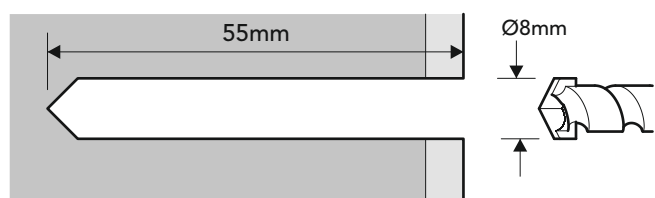
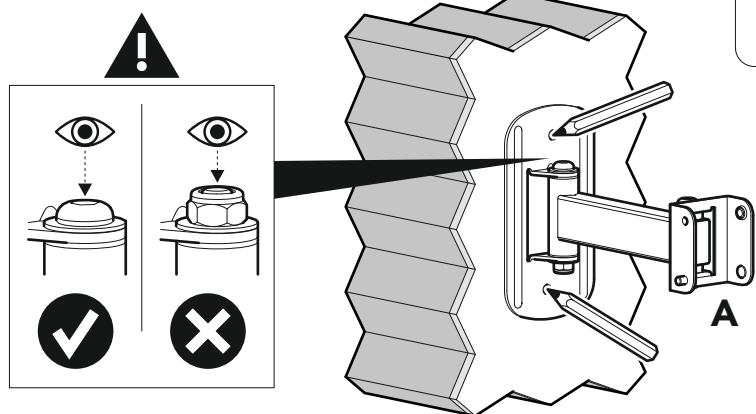

Remove dust from hole

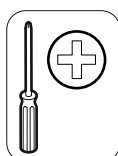
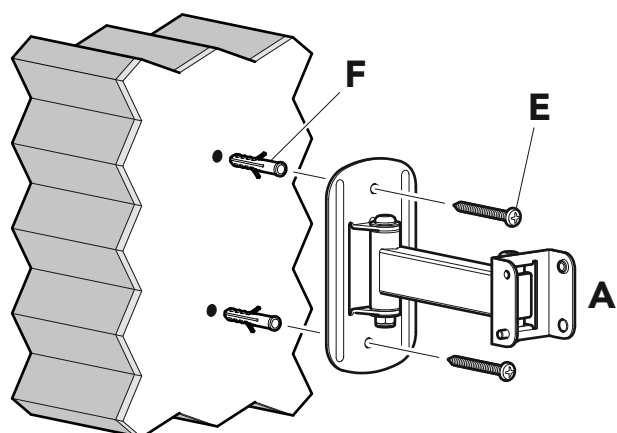
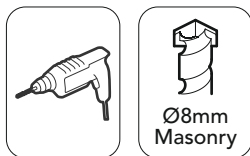

**!** Tighten with hand tools only

**💡** Lubricate screw thread with soap

### 5 Wood Stud

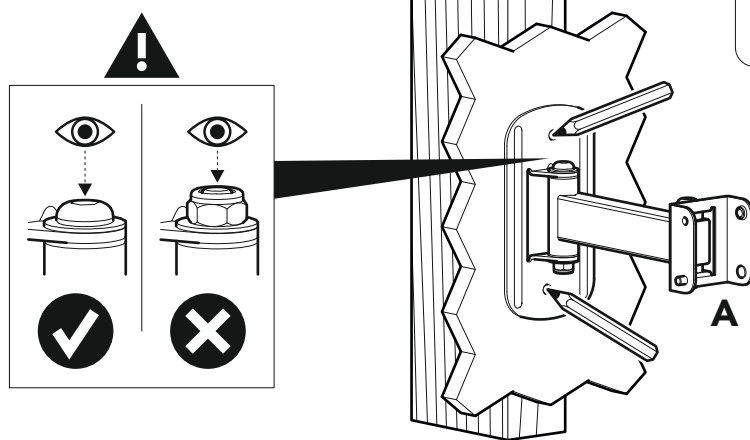

**!** Ensure drill marks are in the centre of the wood stud

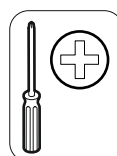
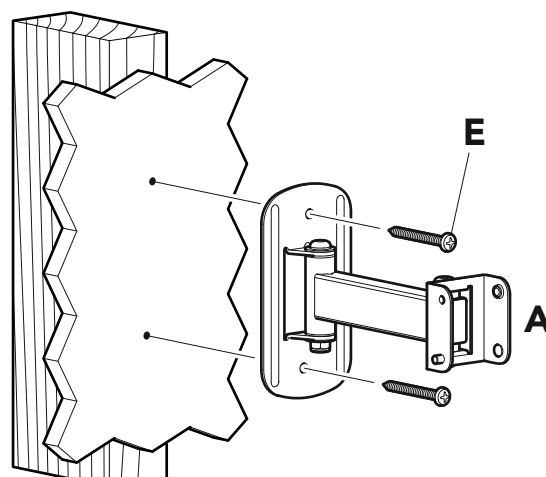
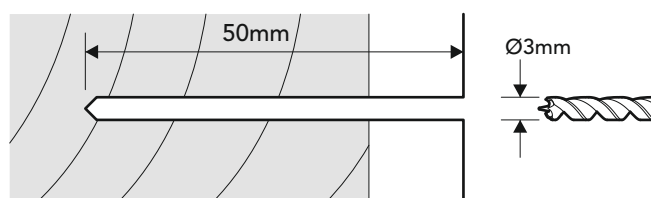

**!** Do not use **F** wall plugs in wood stud

**!** Tighten with hand tools only

**💡** Lubricate screw thread with soap