

John Lewis

Instruction manual

JL SCND 1200/15

Television stand

Glass door and drawer front
supplied separately:

Model number JLSCND DRS

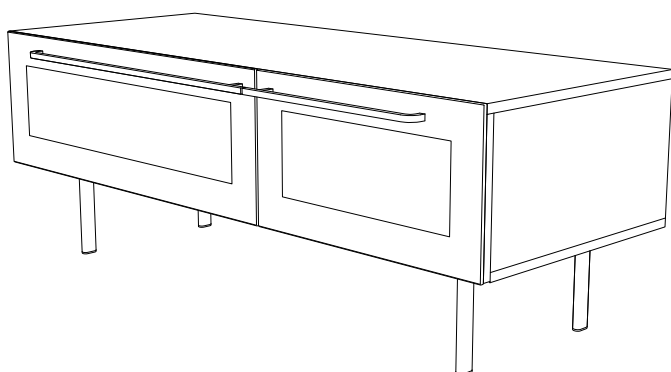

Important safety information

Thank you for purchasing this television stand. Please read the instructions and important information carefully to ensure safe and satisfactory use of this product.

1. Before starting assembly please take time to familiarise yourself with the instructions and the components listed in this manual, as this product could be unstable if incorrectly assembled.
2. Do not place hot or cold items against or in close proximity to any surface on this product.
3. Do not strike any glass with hard or pointed items.
4. When cleaning glass or high gloss panels use a clean damp cloth or leather with washing up liquid or soft soap if necessary. Do not use washing powders or other substances containing abrasives as these may scratch the glass. Dry with a soft cloth.
5. In order to maintain a high quality finish, when cleaning metal, painted or wooden parts please use a soft cloth with a suitable furniture polish if required.
6. Do not sit or stand on this product.
7. **Do not overtighten any part of this assembly.**

Note: Maximum load for this product should not exceed 85kg in total. This product must be assembled in accordance with these assembly instructions. Maximum load for top shelf is 50kg. Maximum load for other shelves is 10kg. Maximum load for drawer is 4kg.

Caution: Do not load drawer without TV in position

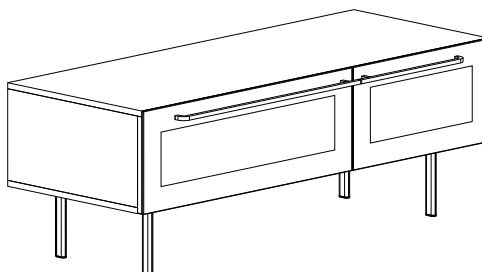
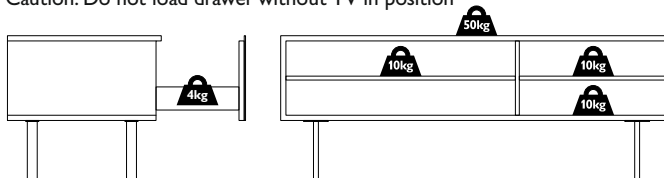

Drawer front and door front supplied separately
Model number JLSCND DRS

Parts list

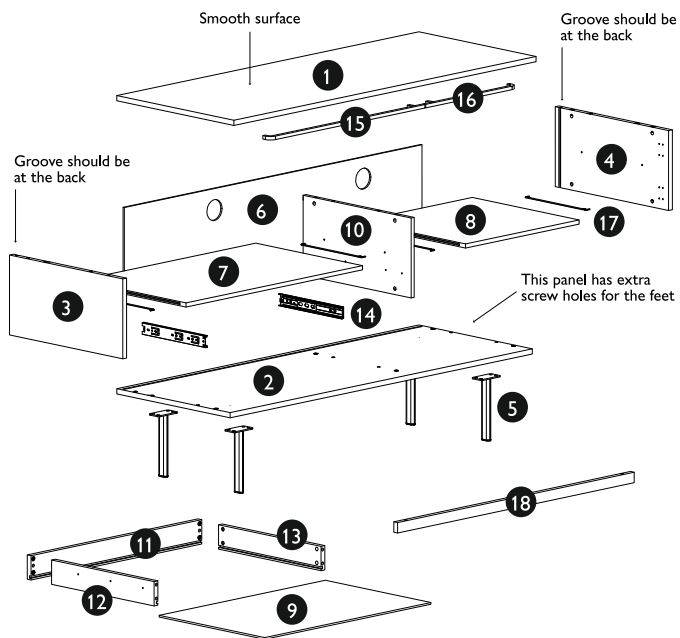

- | | |
|---------------------|----------------------|
| ① Top panel × 1 | ⑩ Dividing panel × 1 |
| ② Bottom panel × 1 | ⑪ Drawer back × 1 |
| ③ Left panel × 1 | ⑫ Drawer left × 1 |
| ④ Right panel × 1 | ⑬ Drawer right × 1 |
| ⑤ Leg × 4 | ⑭ Drawer runner × 2 |
| ⑥ Back panel × 1 | ⑮ Long handle × 2 |
| ⑦ Long shelf × 1 | ⑯ Short handle × 1 |
| ⑧ Short shelf × 1 | ⑰ Shelf support × 4 |
| ⑨ Drawer bottom × 1 | ⑱ Cross brace × 1 |

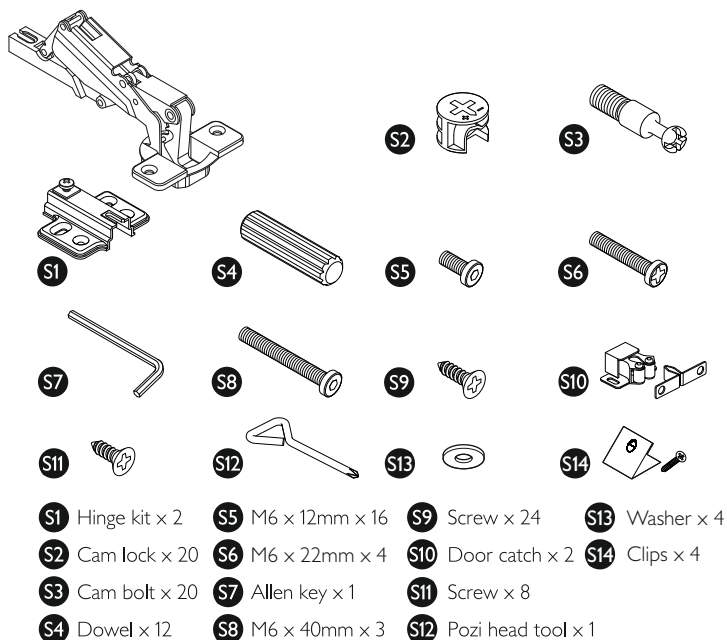

Assembly instructions

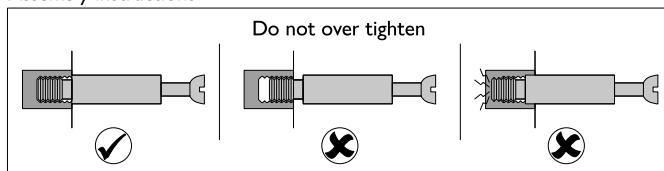

Put a piece of material underneath the panels to prevent damage.

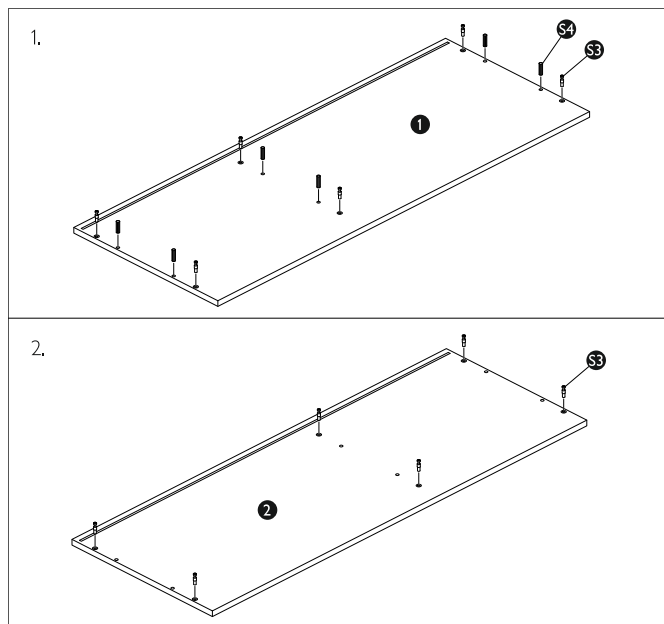

Separate drawer runners 14

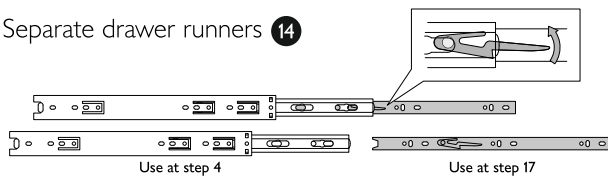

3.

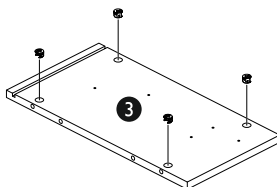
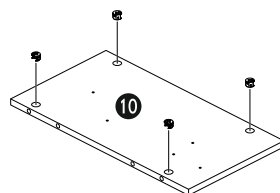
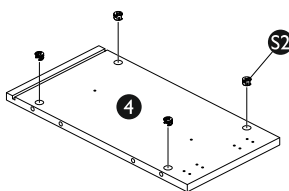
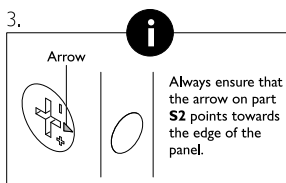

4.

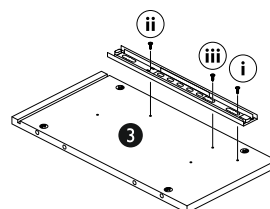
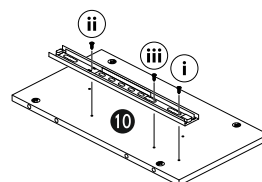
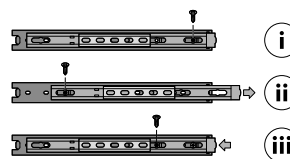
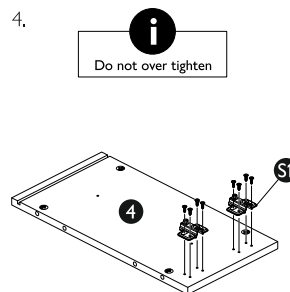

5.

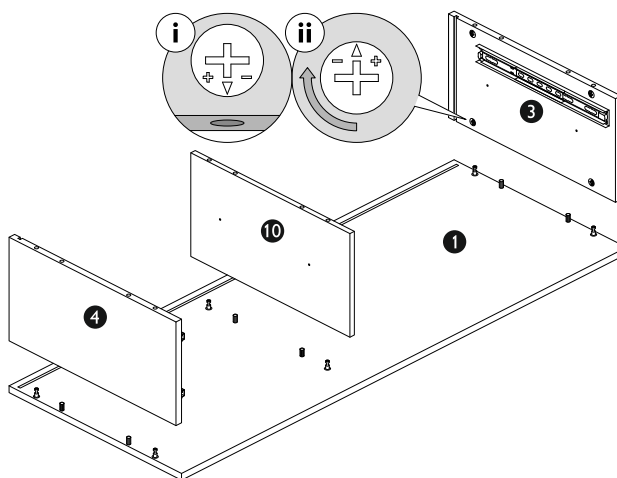

6.

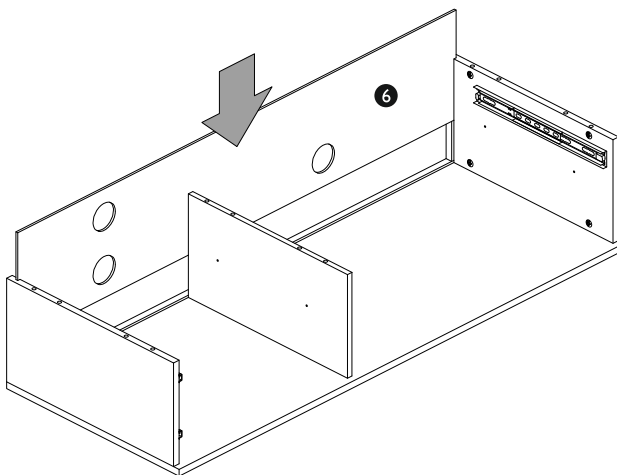

7.

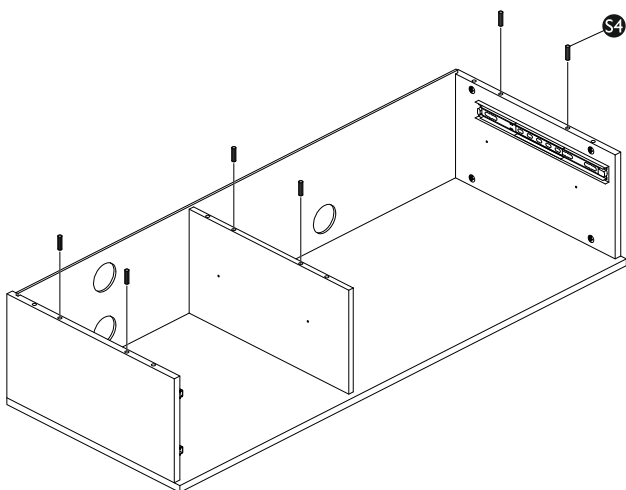

8.

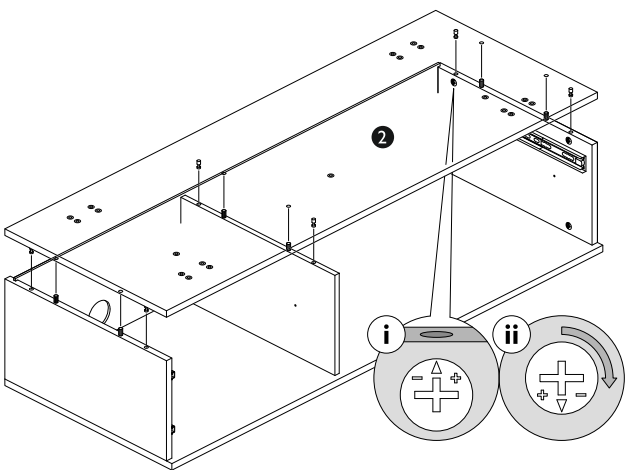

9.

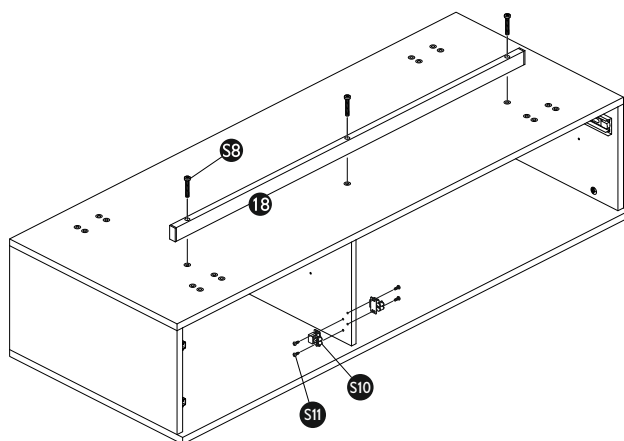

10.

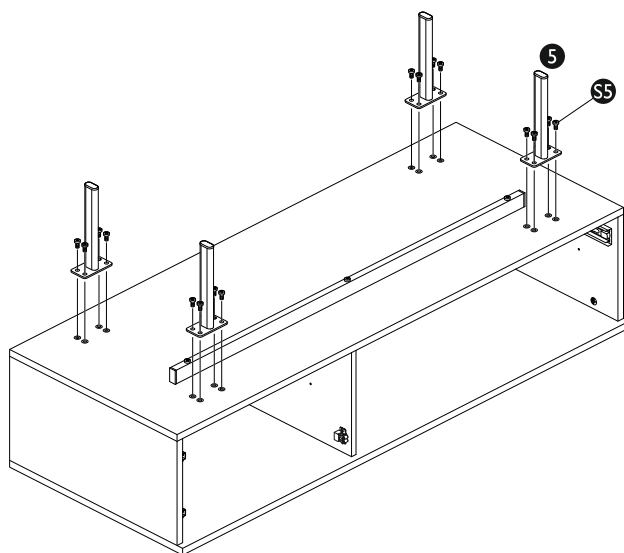

11.

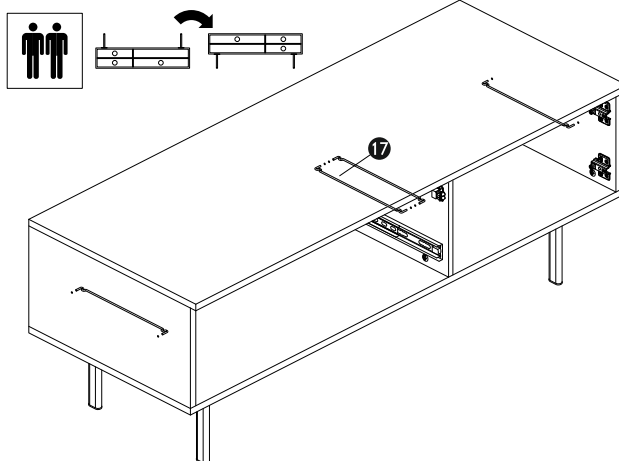

12.

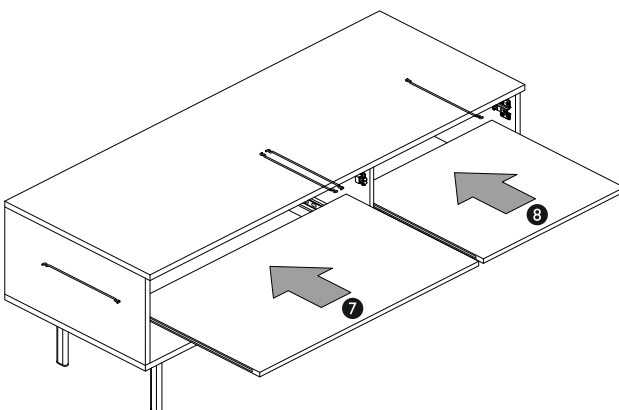

13.

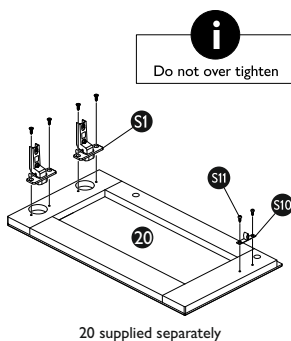

14.

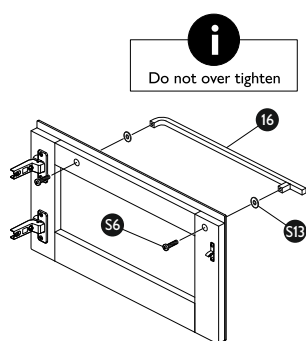

15.

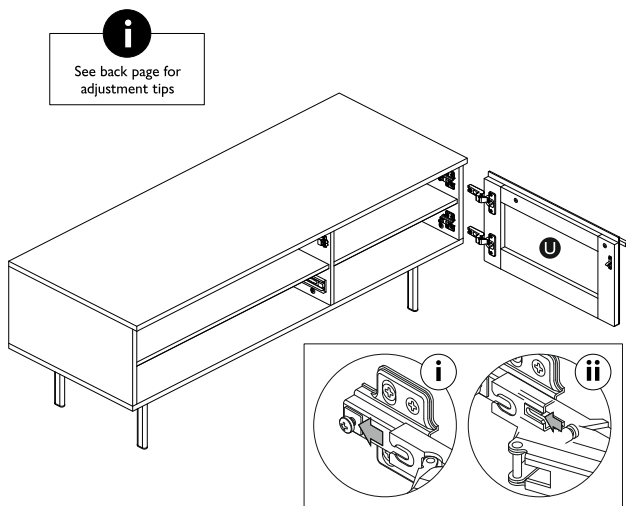

16.



Do not over tighten

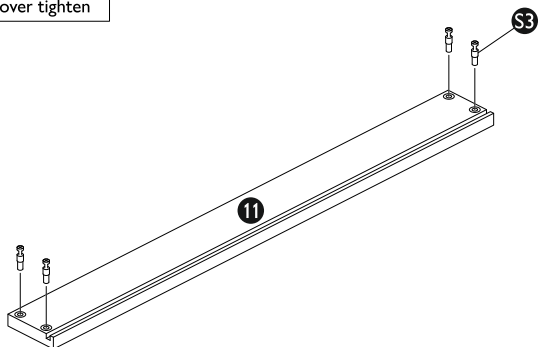

17.



Do not over tighten

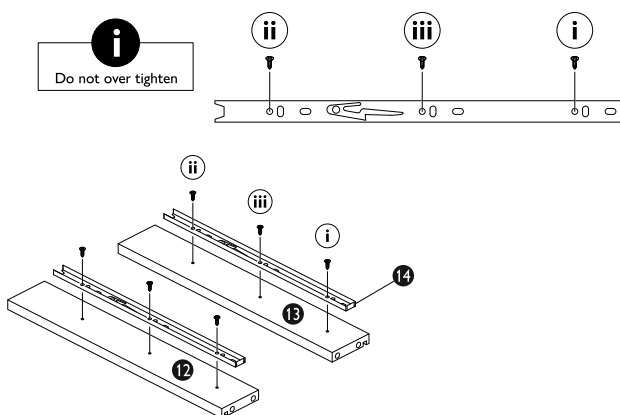

18.

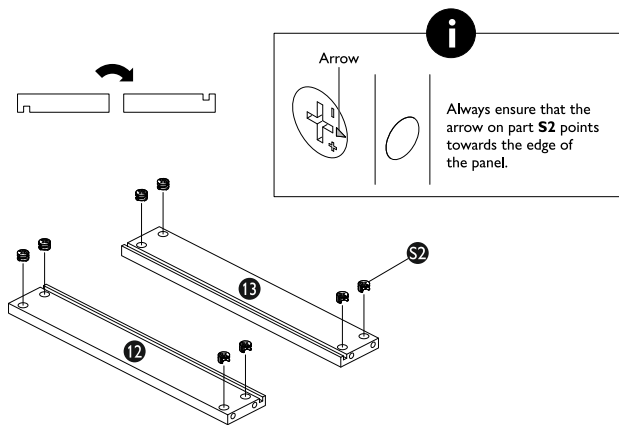

19.

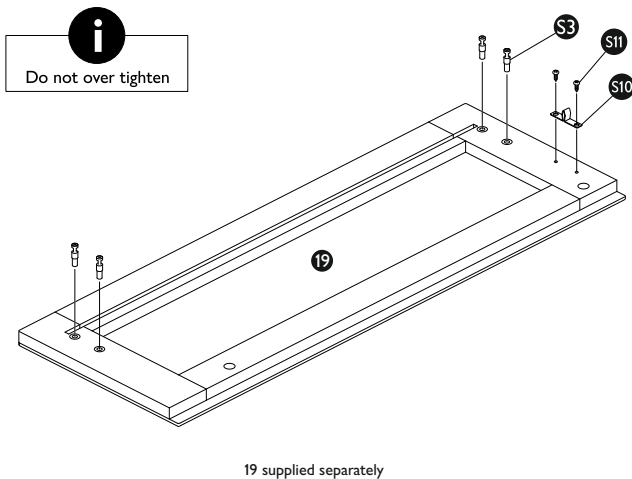

20.

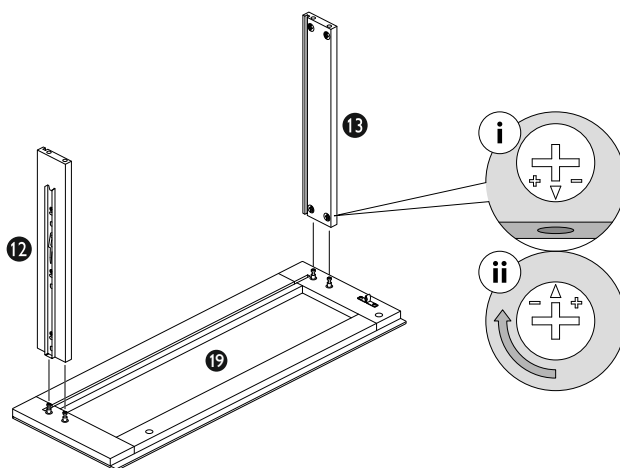

21.

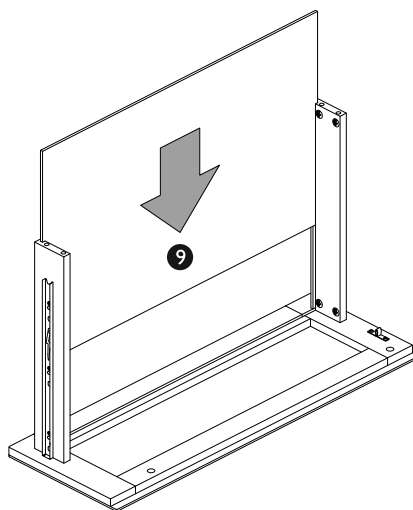

22.

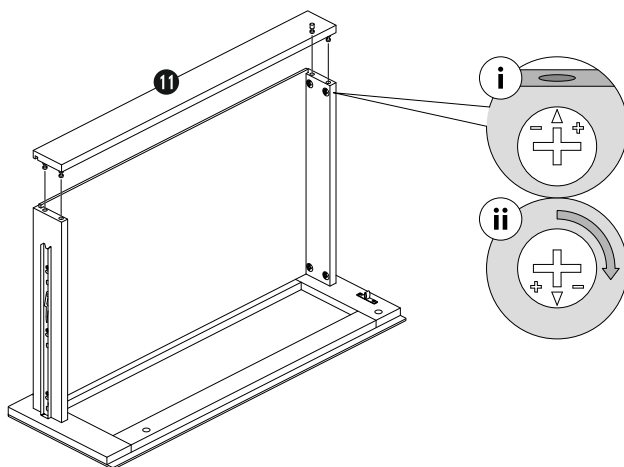

23.

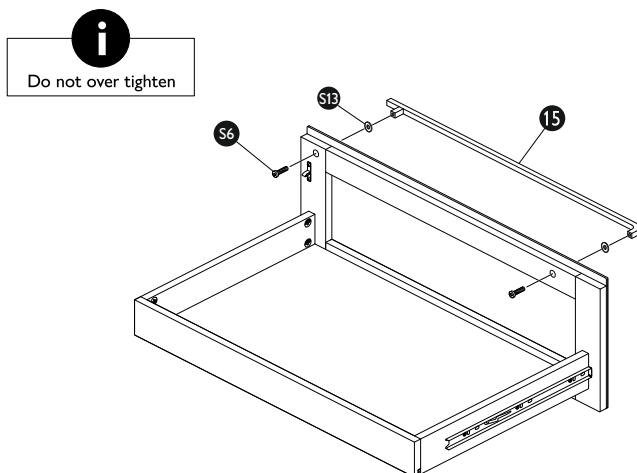

24.

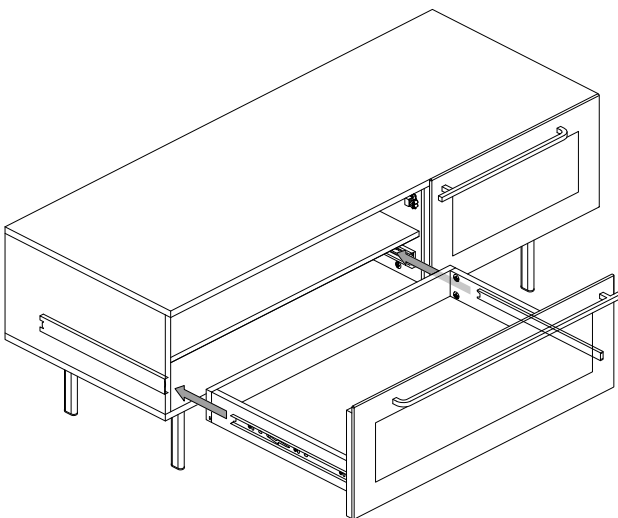

To remove drawer:

Push clip on left hand side up and push clip on right hand side down and slide the drawer out.

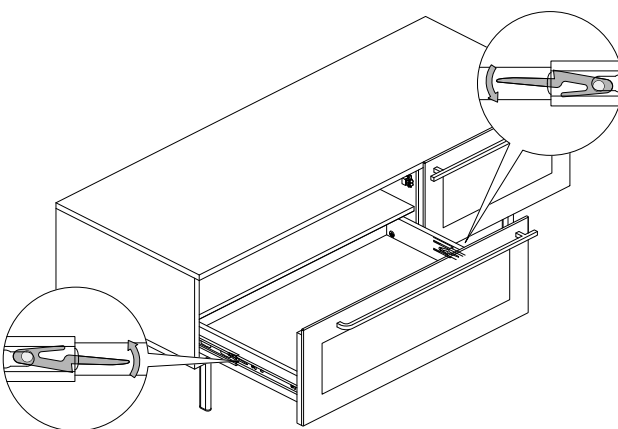

25.

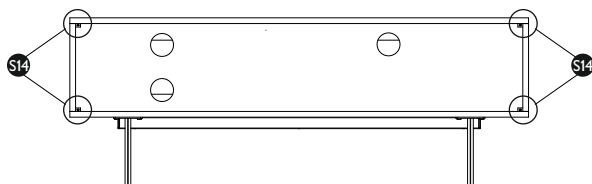
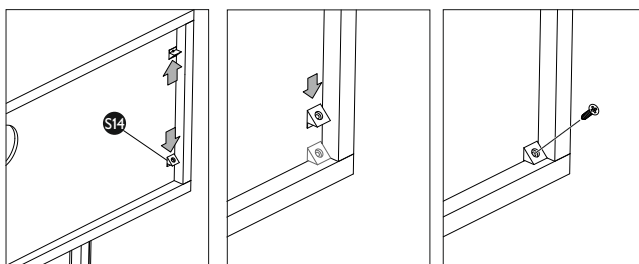

Door adjustment:

Screws A and B adjust the door to ensure it fits perfectly straight.

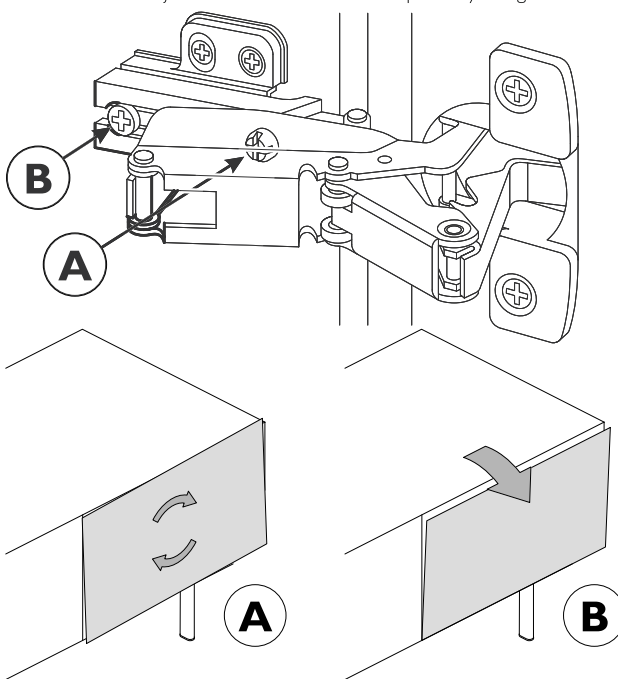

Retain these instructions for future reference. **CE**

John Lewis Partnership
171 Victoria Street
London SW1E 5NN
johnlewis.com

465766rev01