

P6441

Leaflet No. **464954** rev01

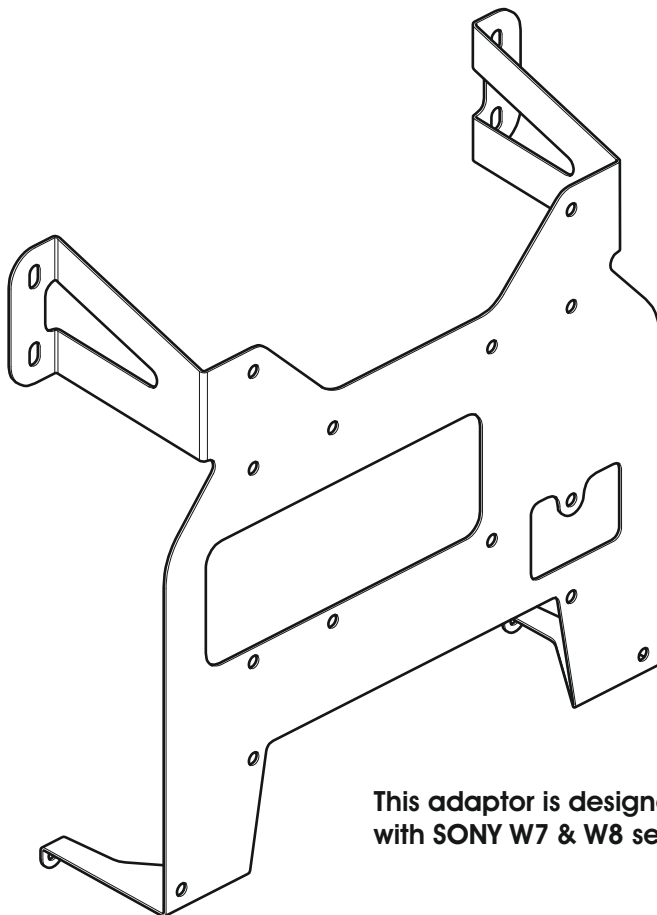

**This adaptor is designed for use
with SONY W7 & W8 series TVs only**



***Read through ALL instructions before commencing installation.
If you have any questions about this product or issues with installation
contact the customer services helpline before returning this product to
the store.***

CUSTOMER SERVICES HELP LINE NUMBER:

01952 670009

Please refer to AVF TV Mount
instructions for maximum
TV weight and size.
This adaptor is designed to
be used with all AVF TV Mounts.

AVF Group Ltd. Hortonwood 30, Telford, Shropshire, TF1 7YE, England

Tools Recommended

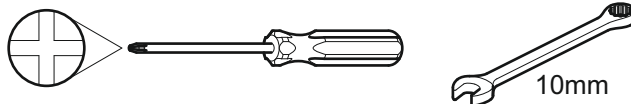

Boxed Parts

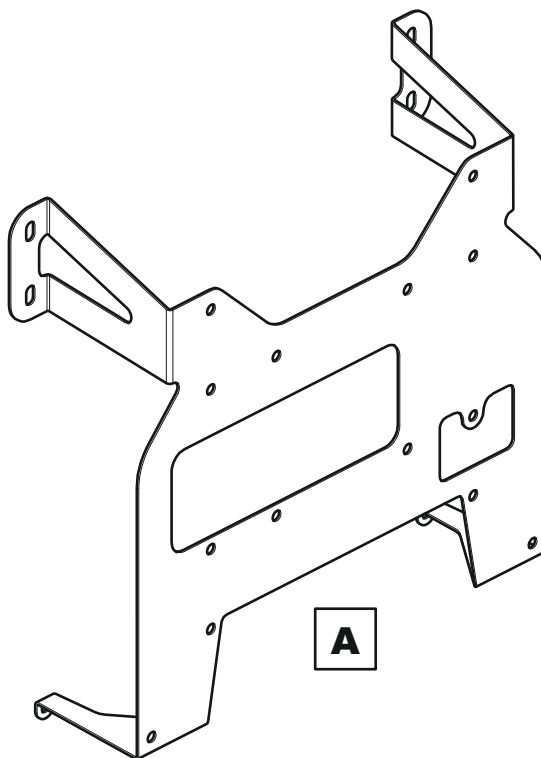

TV Screws and Reducers

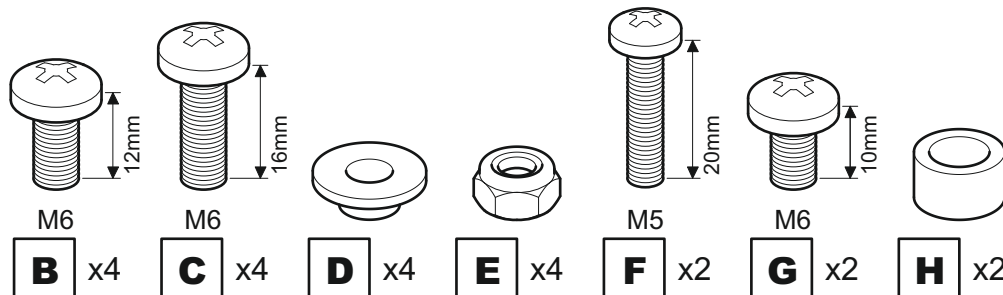

1

Attaching the Adaptor to the TV Mount

TV Mount shown is an example only. The adaptor is designed to fit all AVF TV Mounts

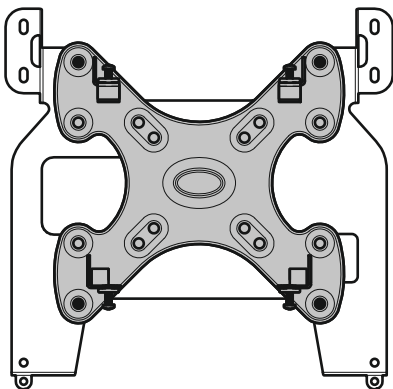

If you are mounting your TV using a **UNIMAX** product please make sure you use the holes highlighted.

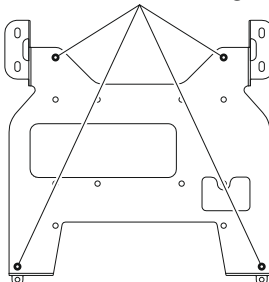

OPTION 1

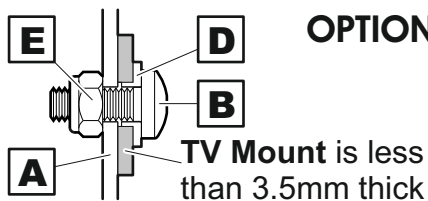

OPTION 2

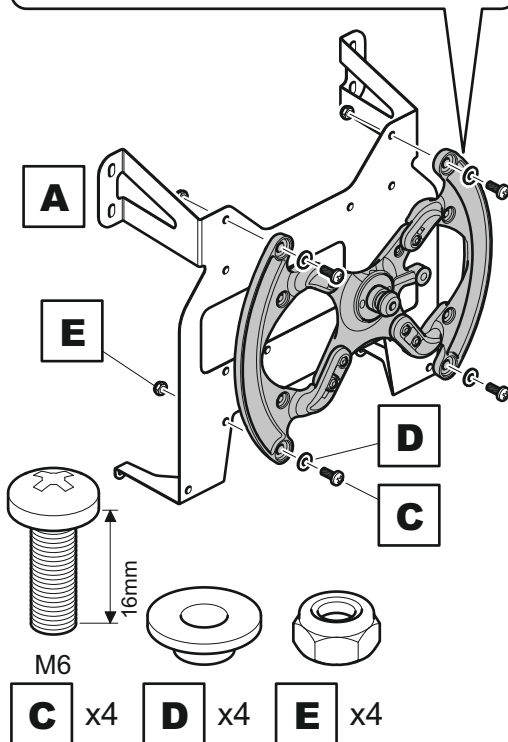
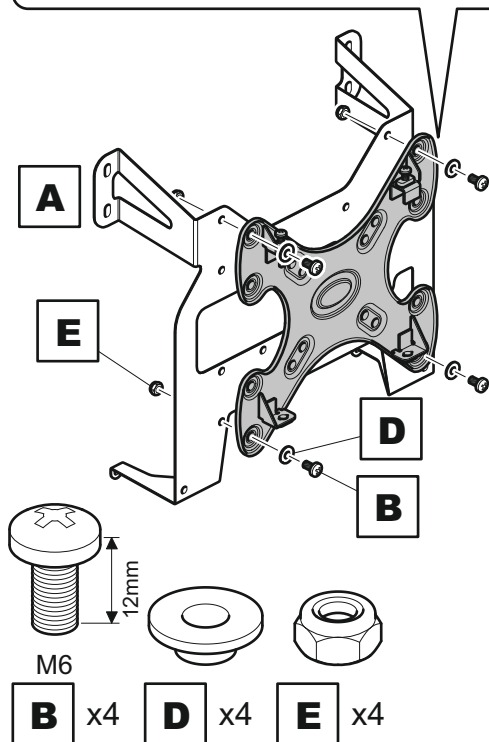
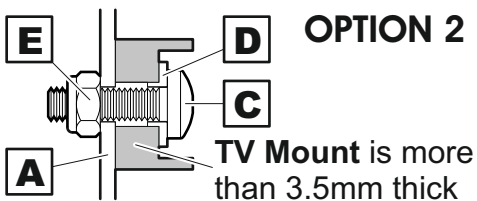

2

Attaching the Adaptor to the TV

The size of your TV will determine which hole you use.

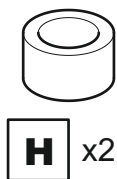
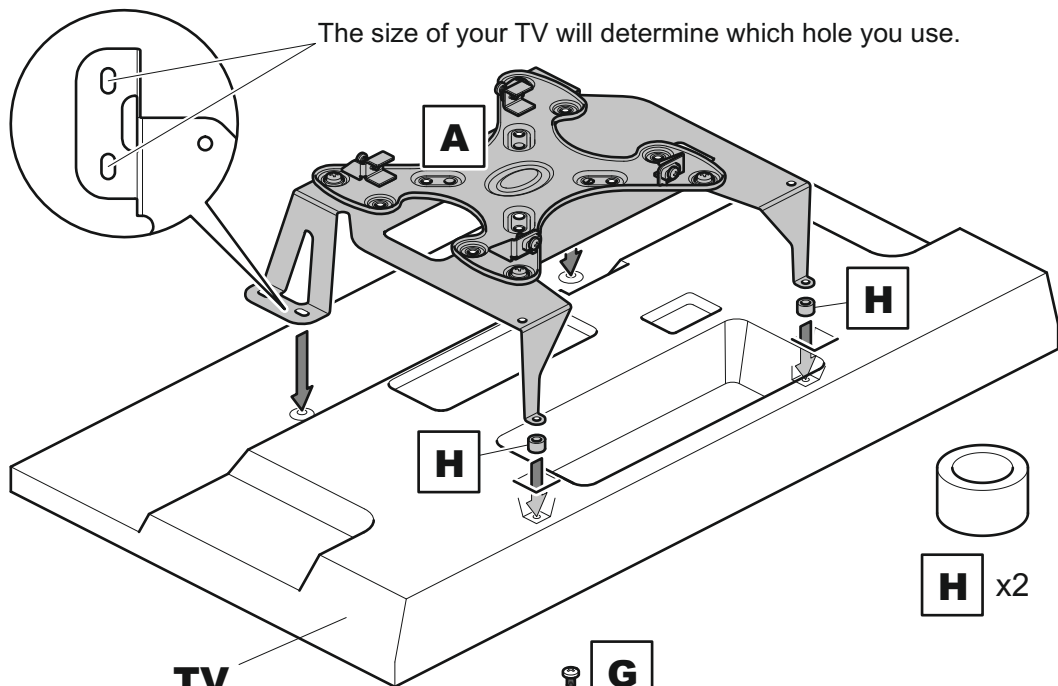

x2

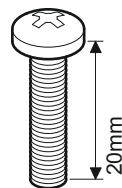
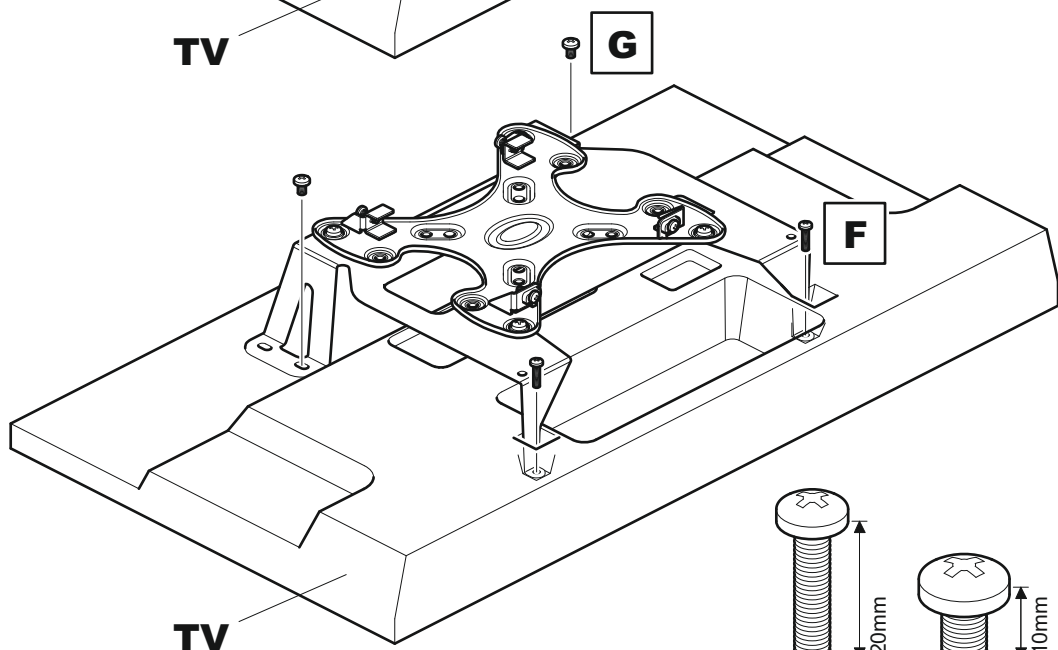

M5

F

x2

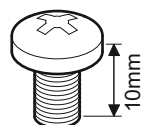

M6

G

x2