

EL404

464079 rev 00

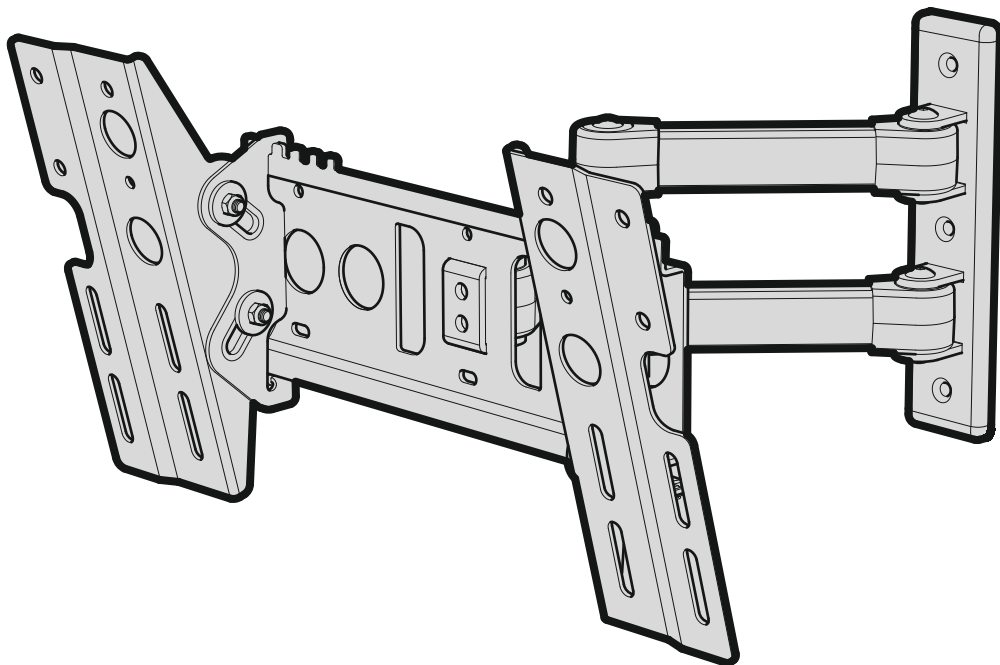

***Read through ALL instructions before commencing installation.
If you have any questions about this product or issues with installation
contact the customer services help line before returning this product to
the store.***

AVF Group Ltd.

Hortonwood 30, Telford, Shropshire, TF1 7YE, England.

+44 (0) 1952 670009 (UK)

AVF Incorporated.

3187, Cornerstone Drive, Eastvale, CA 91752, USA.

1-800 667 0808 (USA)

Orbital Holdings Inc.

3187, Cornerstone Drive, Eastvale, CA 91752, USA.

1-800 601 8450 (USA)

Assembly Overview

Fit the TV brackets

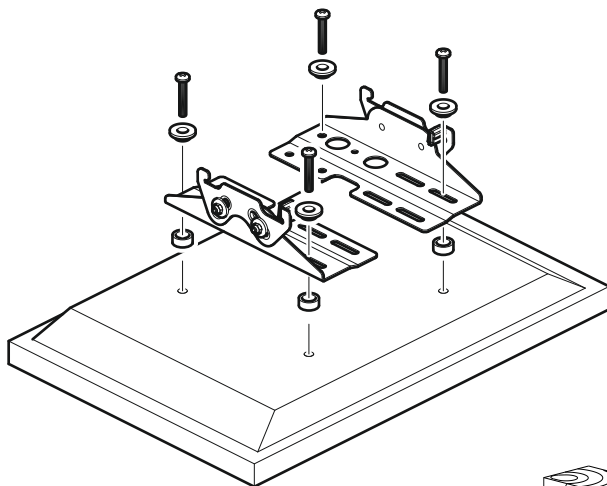

Fit the Wall Bracket

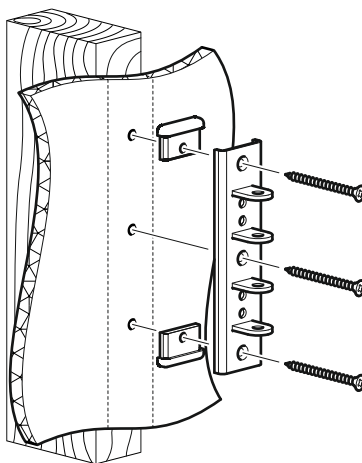

Attaching the TV

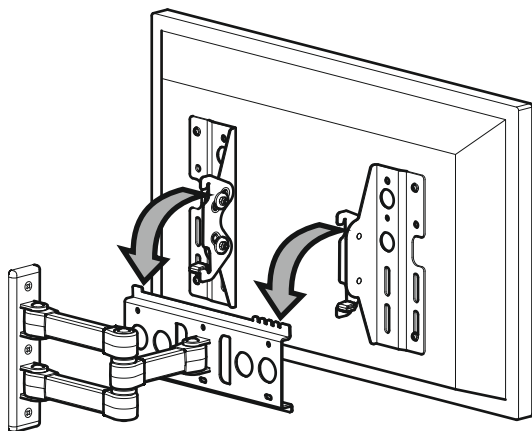

Index

1 Measure the TV fixing holes Width and Height

2 Preparing the TV brackets

3 Fitting the TV brackets

4 Fitting the Wall Bracket

5 Arm Assembly

6 Attaching the TV

Contents may vary from photography/ Illustrations.

You will not need all these parts, so expect there to be some left over depending upon the specification of your TV.

This product is intended for indoor use only. Use of this product outdoors could lead to failure and personal injury.

It is the responsibility of the installer to ensure that the mounting wall is of a suitable standard and void of any services (eg gas, electricity, water etc). AVF accept no responsibility for any damage or loss caused by installing this product in a sub standard wall.

Retain all packaging in case the bracket needs to be returned.

Tools Recommended

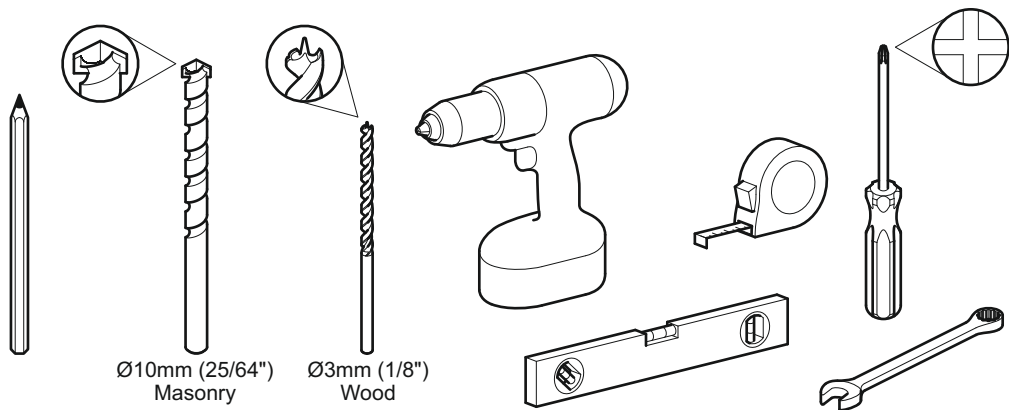

Boxed Parts

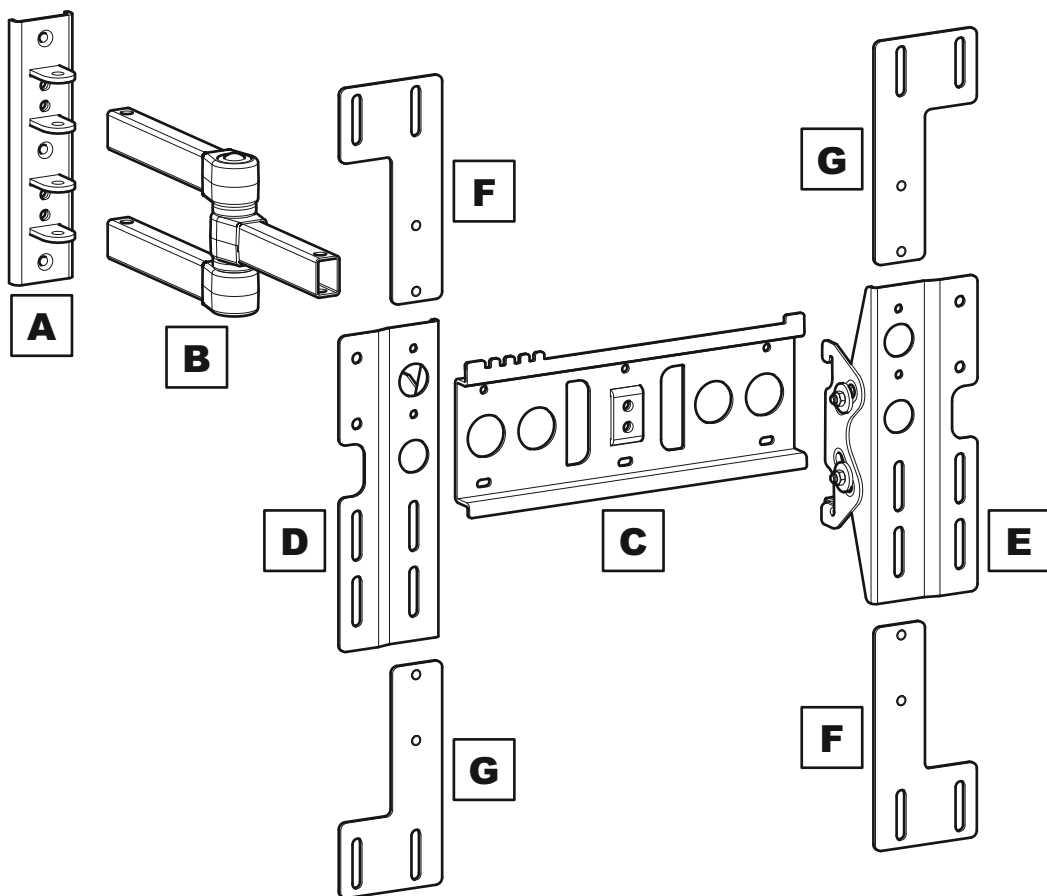

TV Screws, Reducers and Spacers

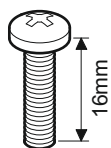

M4

H1

x4

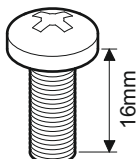

M6

H2

x4



I

x4



J

x4



K

x8

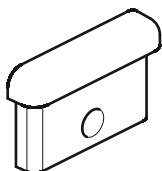

L

x2

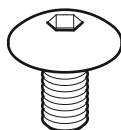

M

x6

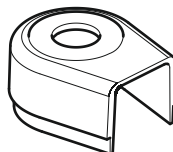

N

x3

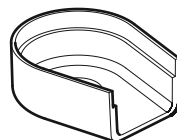

O

x3



P

x3

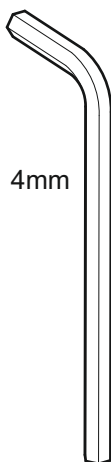

Q

x2

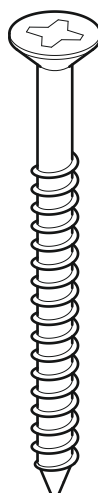

R

x3

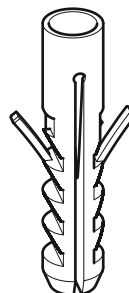

S

x3

TV Brackets **D** & **E**
 come with pre assembled
 yellow retaining clips.
 These can come loose
 during transit and if they
 have please re-attach as
 shown.

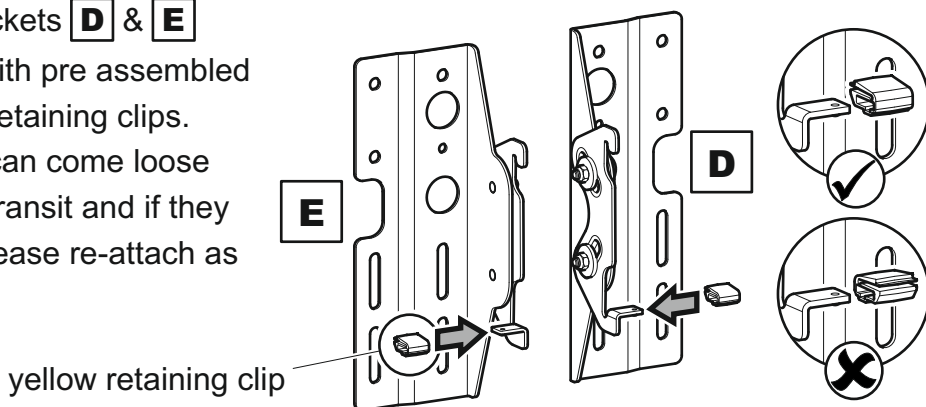

1 Measure the TV fixing holes Width and Height

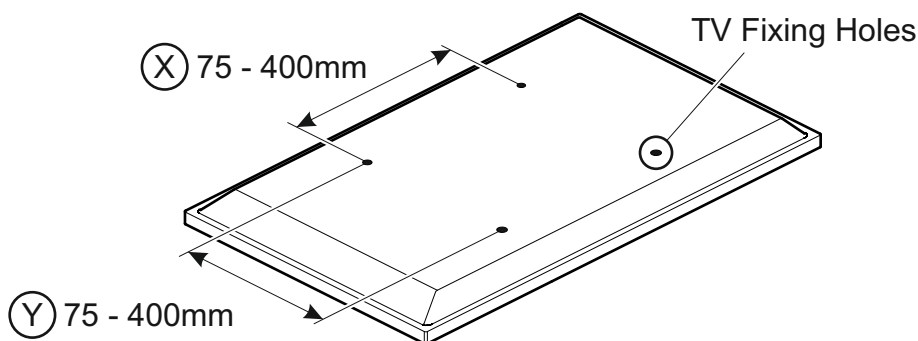

! If width (X) is greater than 400mm or height (Y) greater than 400mm
 STOP installation now and contact the customer help line

You are provided with 2 diameters of TV fixing screws, **M4** and **M6**.
 Determine the screw diameter that fits and remember for step 3.

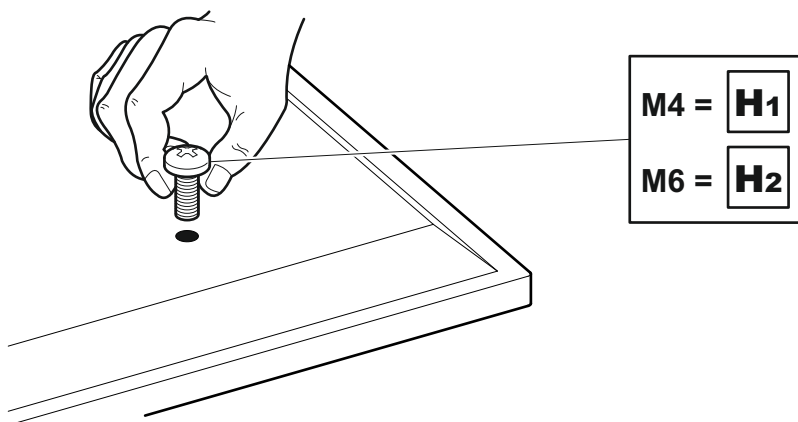

2

Preparing the TV Brackets

Use the option that fits your TV

OPTION 1

(X) = 75mm - 200mm

(Y) = 75mm - 200mm

OPTION 2

(X) = 200mm - 400mm

(Y) = 75mm - 200mm

OPTION 3

(X) = 200mm - 400mm

(Y) = 270mm - 300mm

OPTION 4

(X) = 200mm - 400mm

(Y) = 340mm - 400mm

OPTION 1

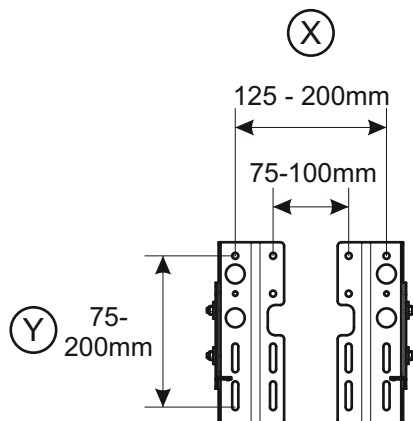
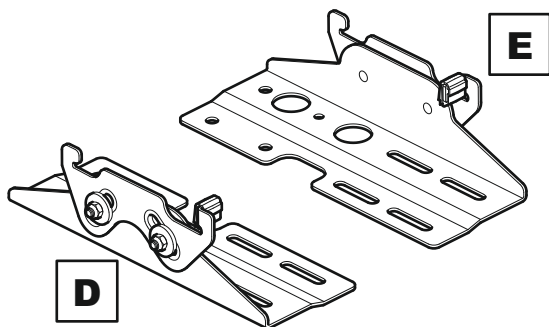

OPTION 2

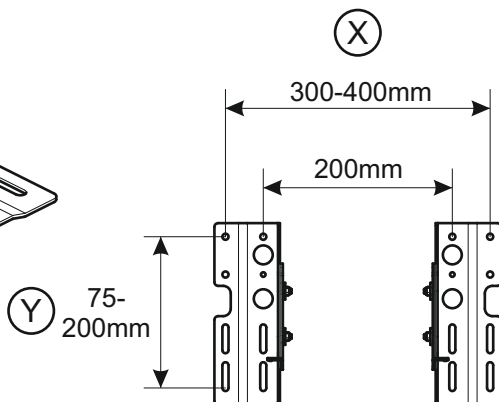
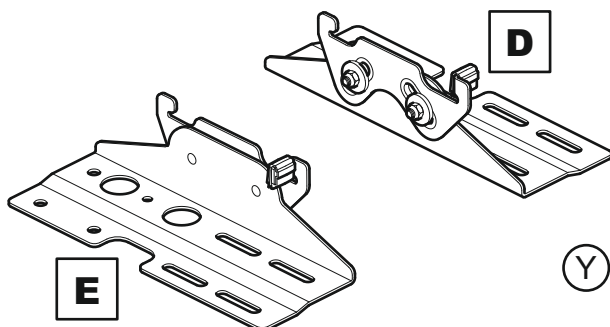

OPTION 3

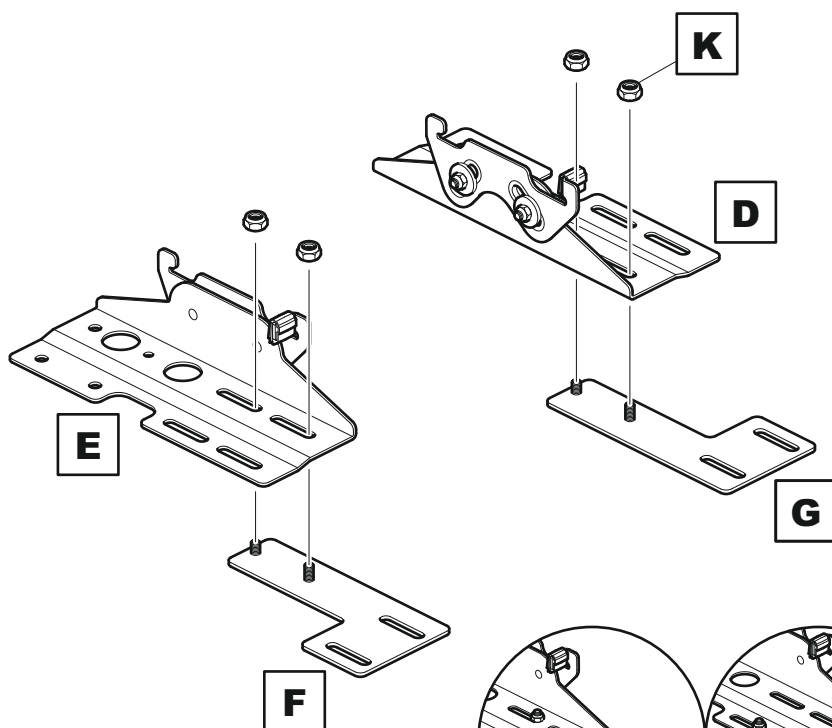
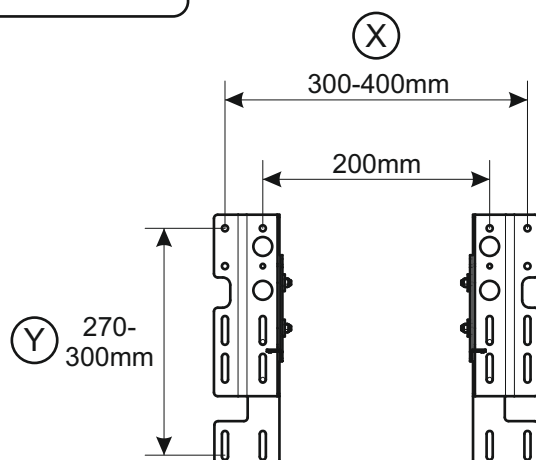

K x4

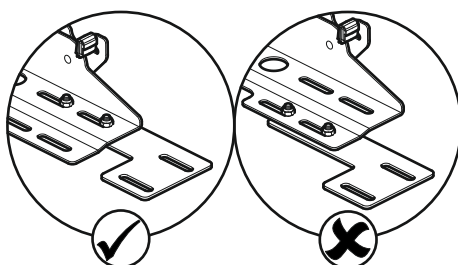

OPTION 4

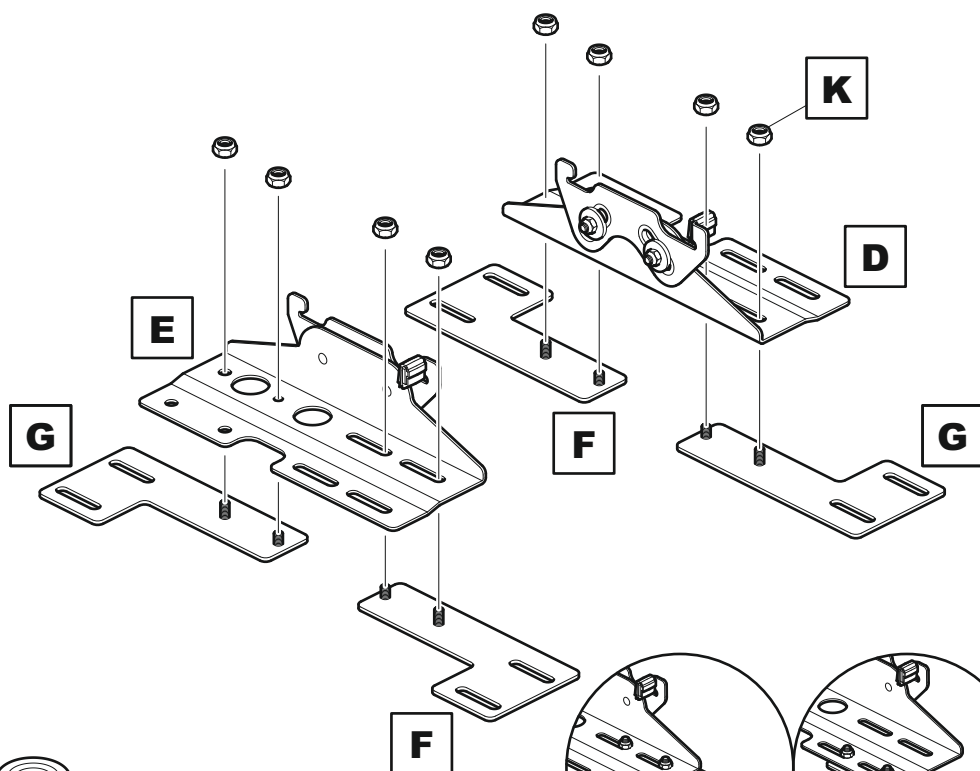
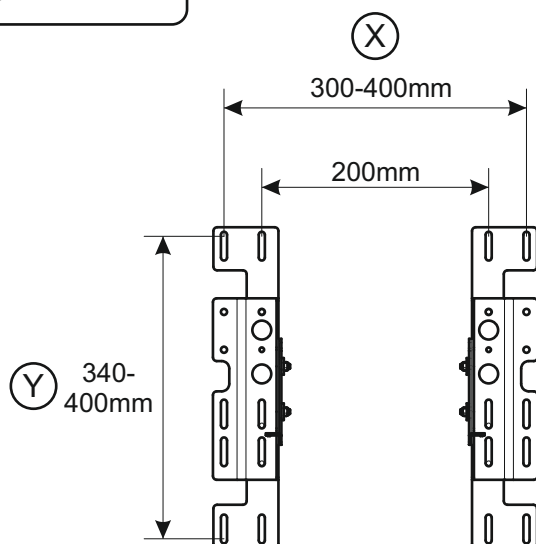

K x8

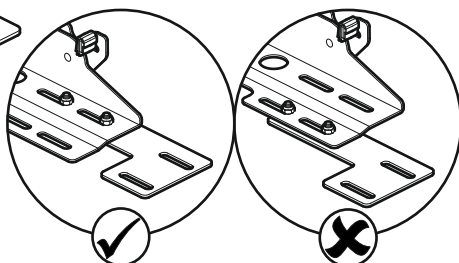

3 Fitting the TV Brackets

For TVs with irregular or obstructed back's you may require longer screws and spacers. If you require additional advice please call the AVF customer helpline.

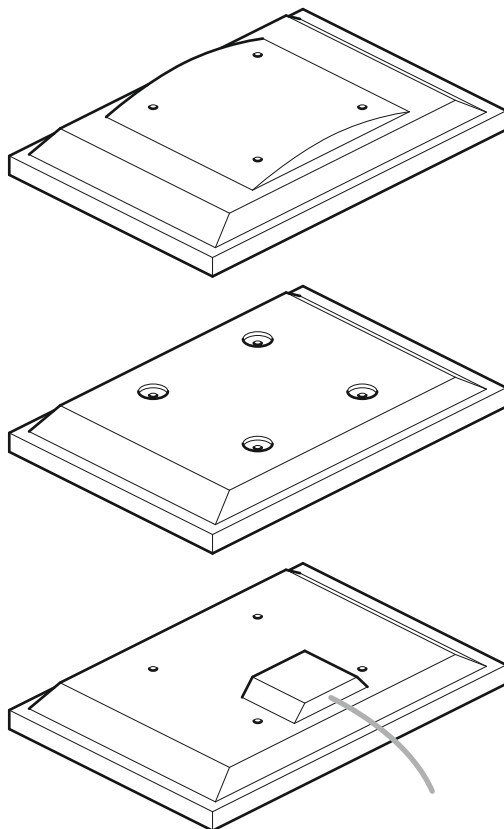

WARNING

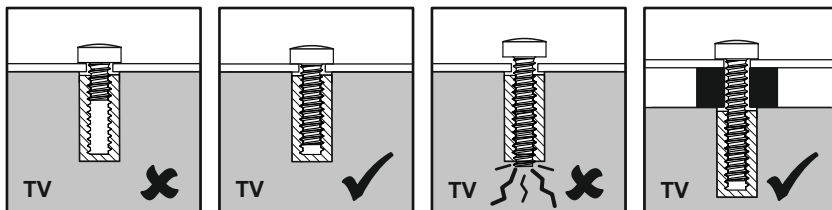

After completing step 3 you will have fittings left over, please keep for future reference.

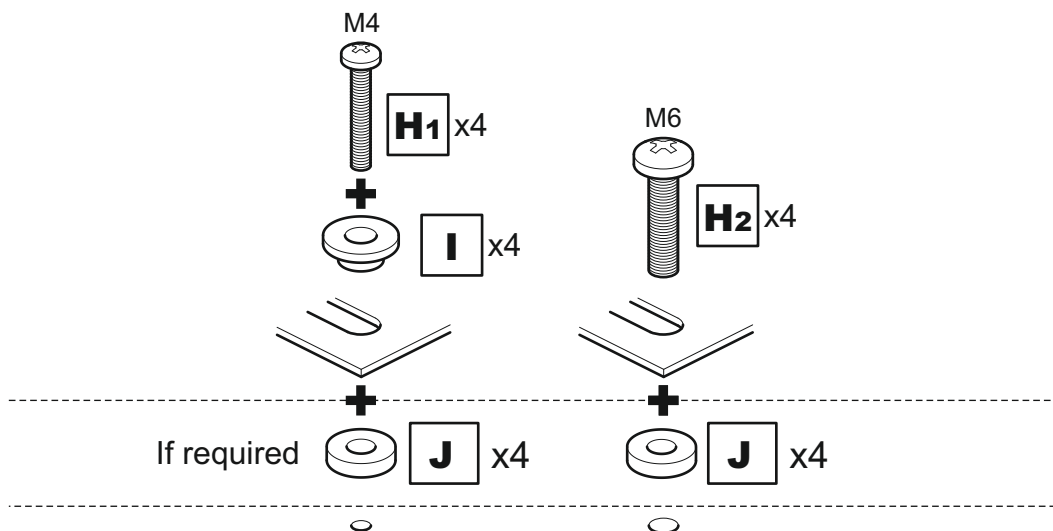
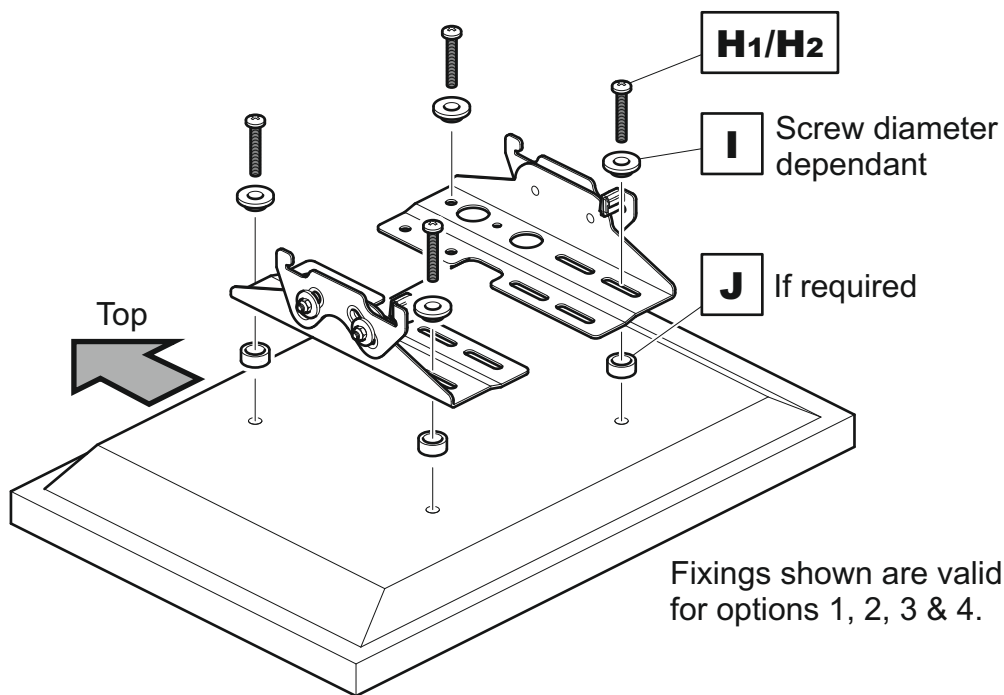

Attach the bracket to the back of your TV using suitable screw, reducer and spacer combinations.

If you have any issues fitting to the back of your TV with the screws supplied, please call the customer services helpline **01952 670009**

4 Fitting the Wall Bracket

Solid Wall

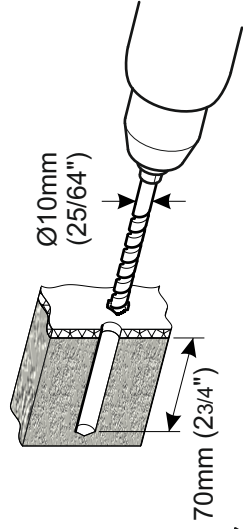
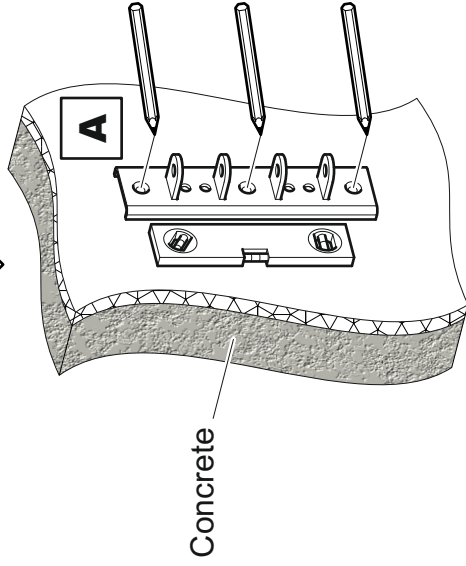

Remove dust from hole



Wood Stud

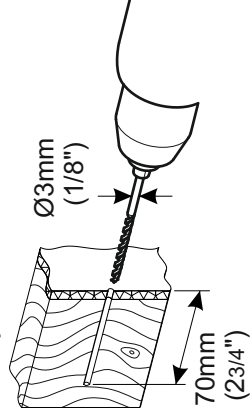
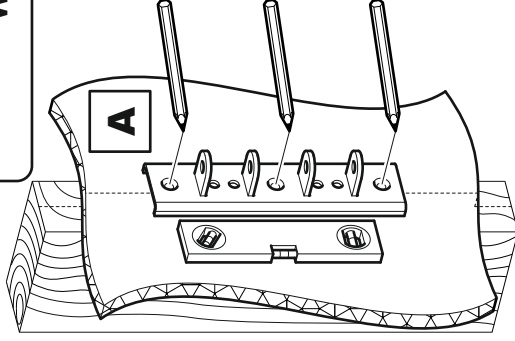

Ensure bracket is in the
centre of the wood stud

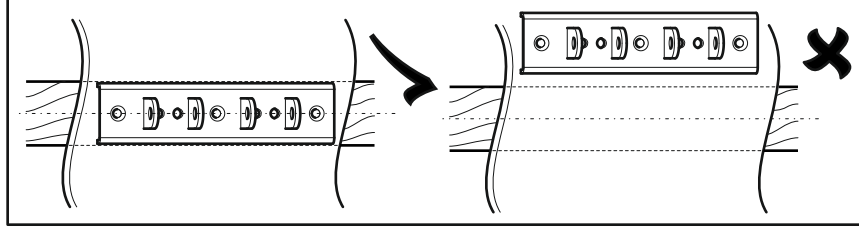

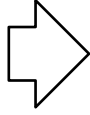

Lubricate screw
thread with soap

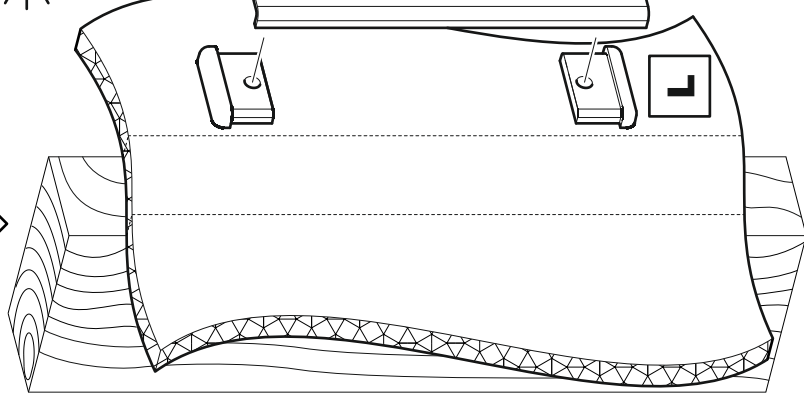

DO NOT over
tighten screws
Tighten screws
by hand only



L x2 **R** x3

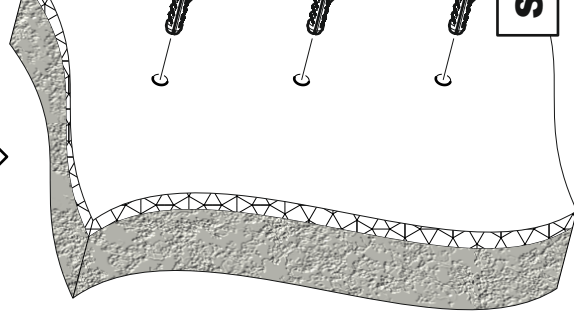
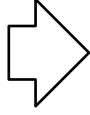
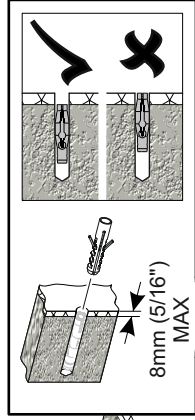

Lubricate screw
thread with soap

DO NOT over
tighten screws
Tighten screws
by hand only



L x2 **R** x3 **S** x3

5

Arm Assembly

i

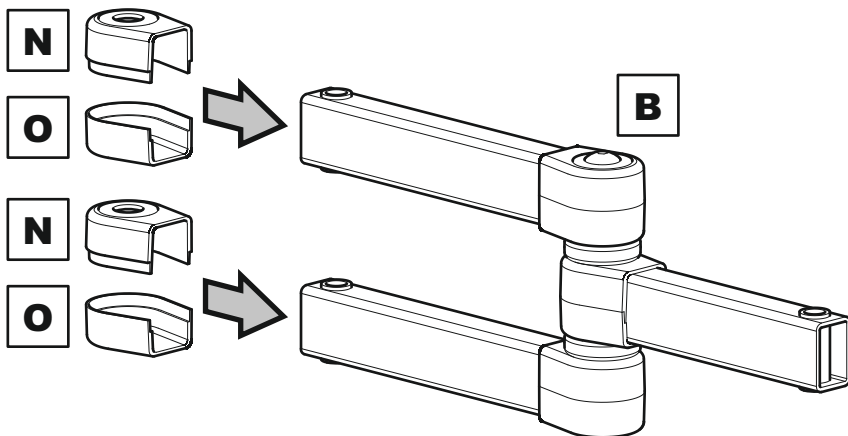

ii

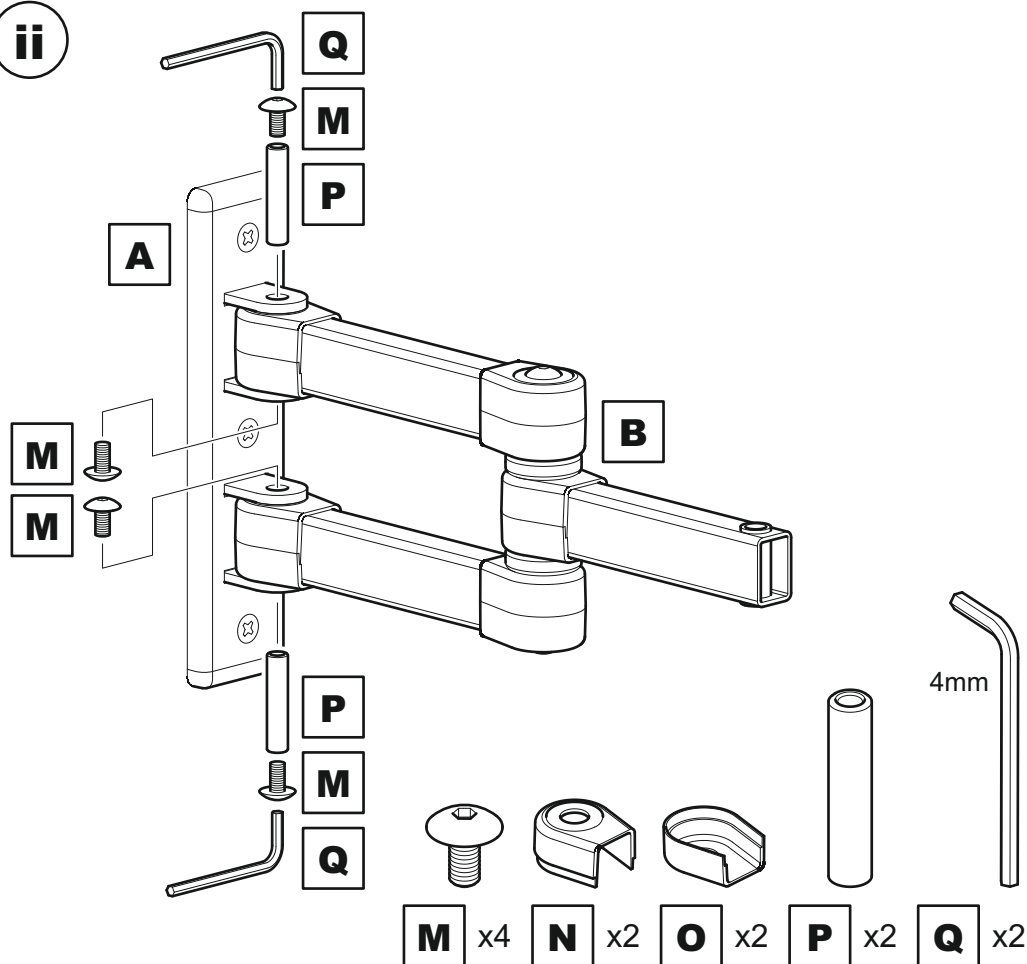

iii

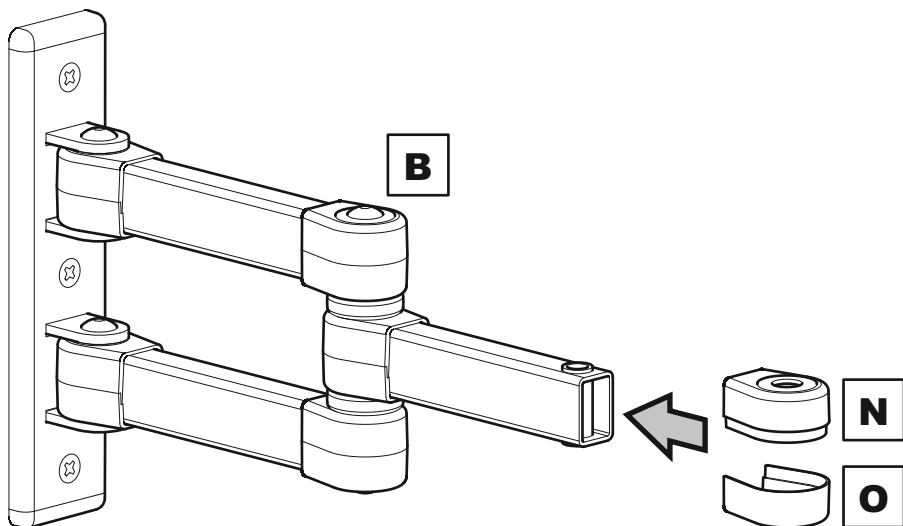

iv

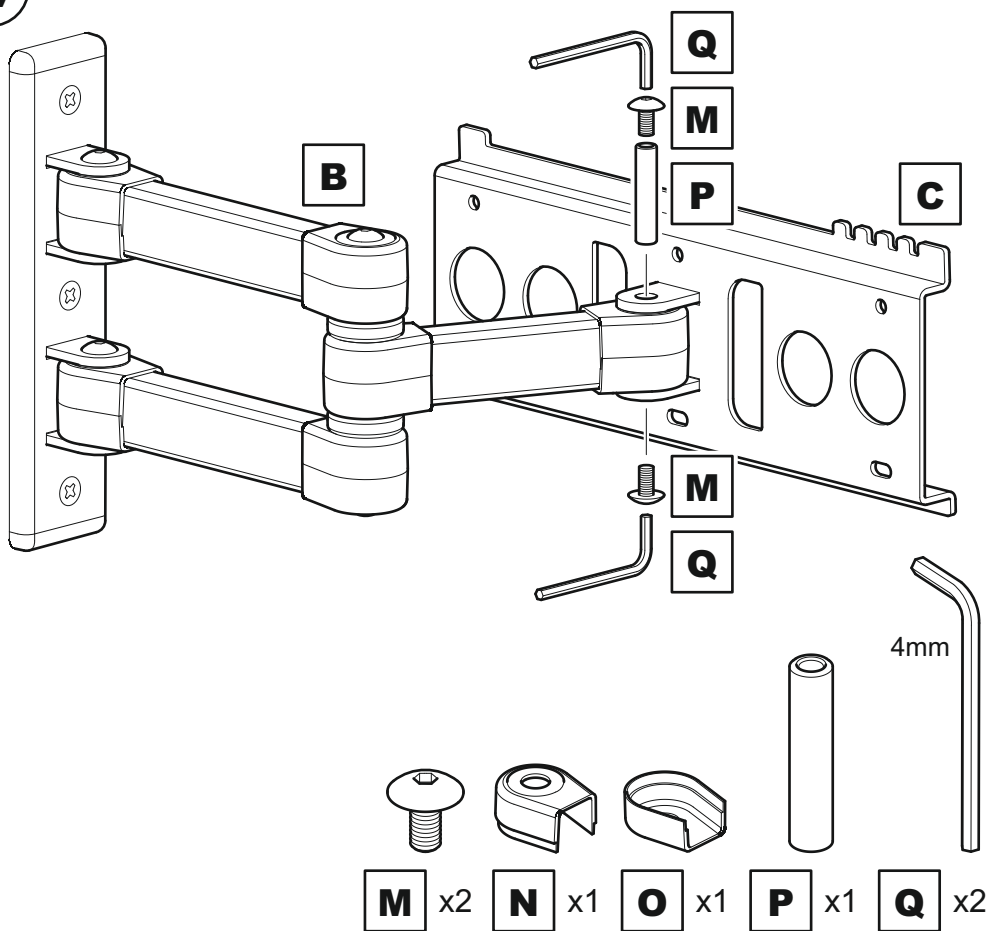

6

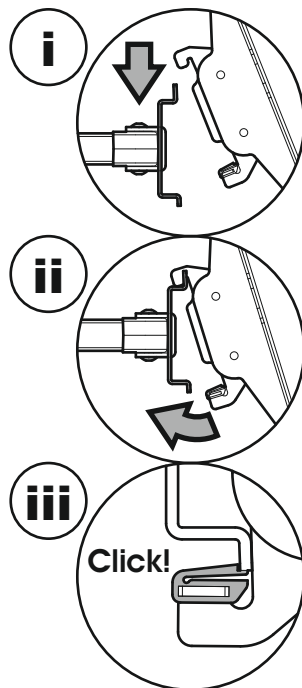

Optional

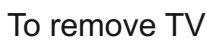
 x^2