

NUL201

Leaflet No. **464048** rev00

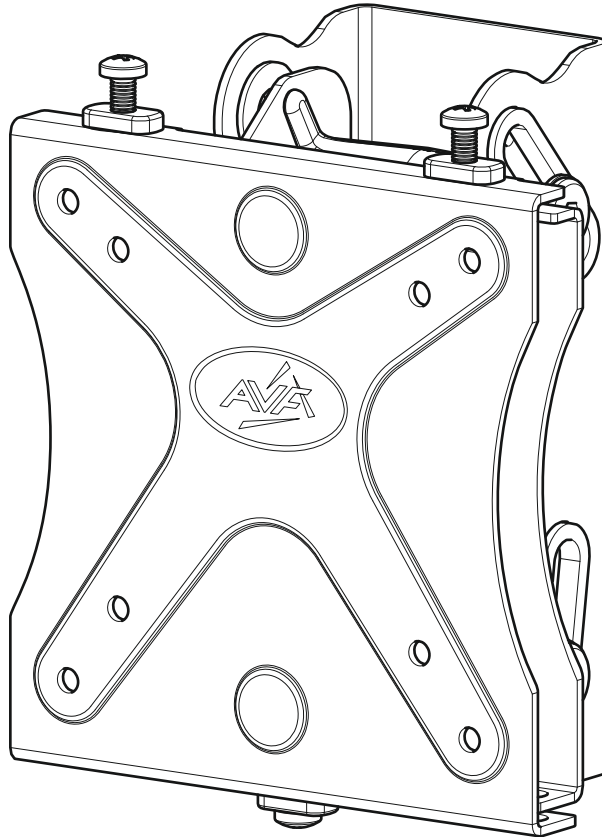

Read through ALL instructions before commencing installation.
If you have any questions about this product or issues with installation contact the customer services help line before returning this product to the store. Visit <http://te.avf.co.uk/p/nul201> for more information.

CUSTOMER SERVICES HELP LINE NUMBER:

01952 670009



AVF Group Ltd. Hortonwood 30, Telford, Shropshire, TF1 7YE, England

Assembly Overview

Fit the TV Mounting Plate

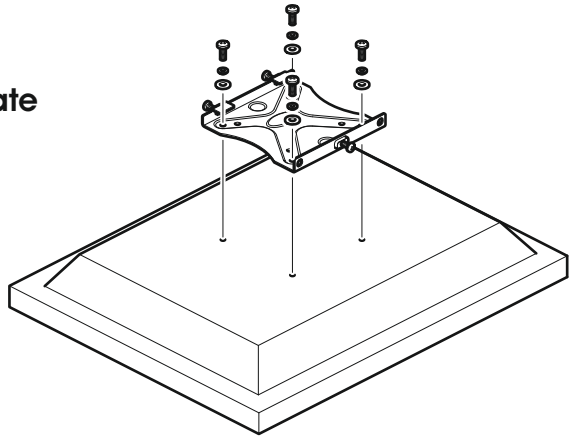

Fit the Wall Bracket

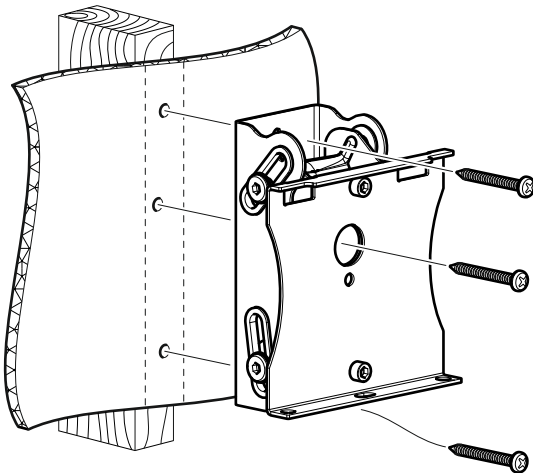

Attach the TV

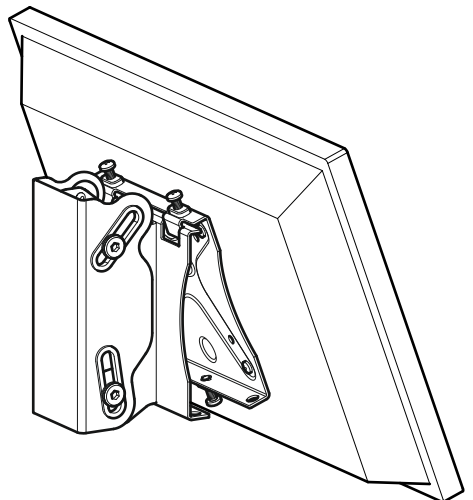

Index

1 Measure the TV fixing holes Width and Height

2 Preparing the TV Mounting Plate

3 Fitting the TV Mounting Plate

4 Fitting the Wall Bracket

5 Attach the TV

Retain all packaging in case the bracket needs to be returned.

Contents may vary from photography/ Illustrations.

You will not need all these parts, so expect there to be some left over depending upon the specification of your TV.

This product is intended for indoor use only. Use of this product outdoors could lead to failure and personal injury.

It is the responsibility of the installer to ensure that the mounting wall is of a suitable standard and void of any services (eg gas, electricity, water etc).

AVF accept no responsibility for any damage or loss caused by installing this product in a sub standard wall.

Tools Recommended

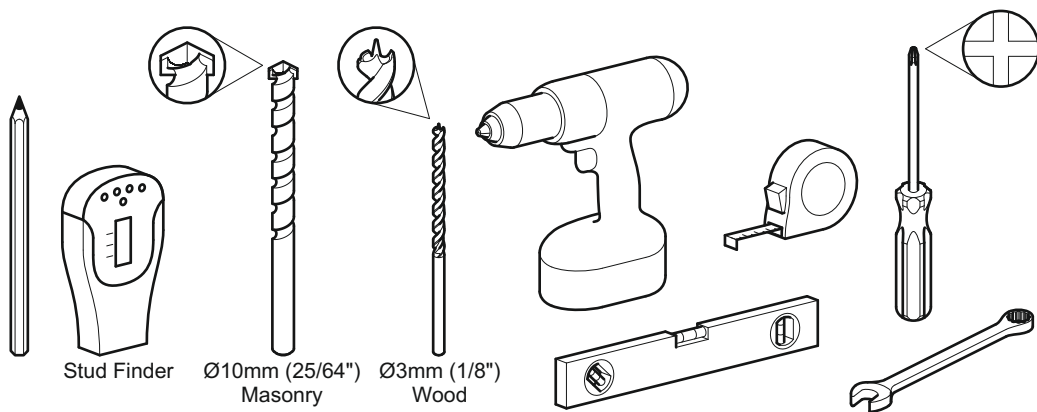

Boxed Parts

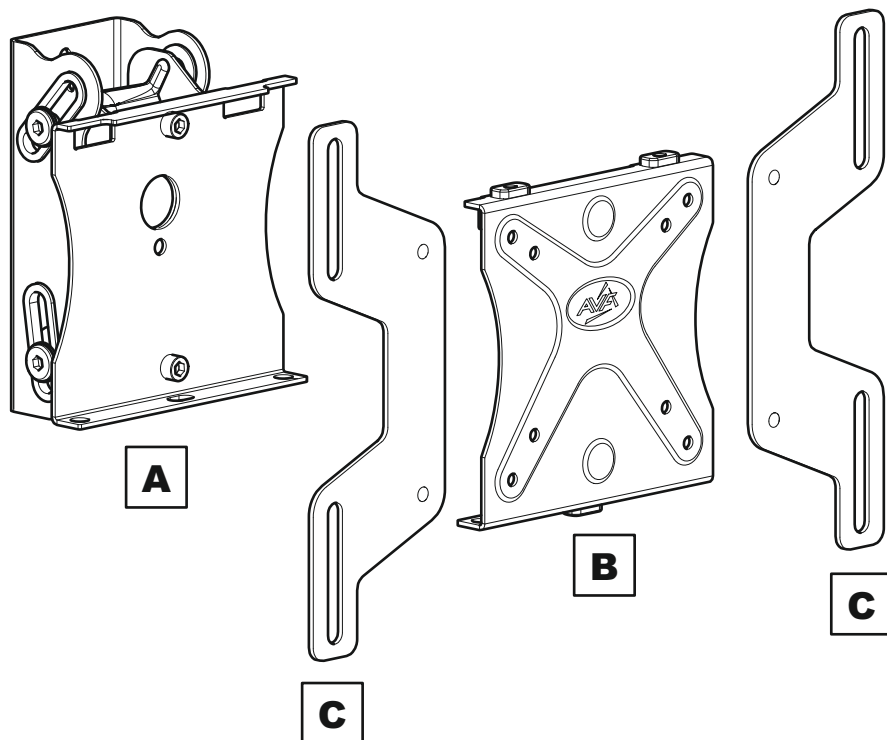

TV Screws and Reducers

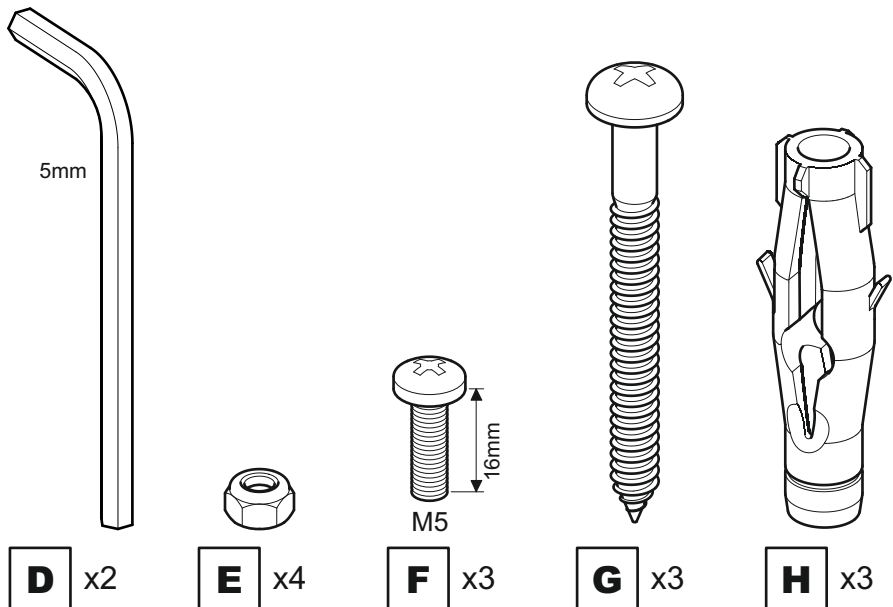
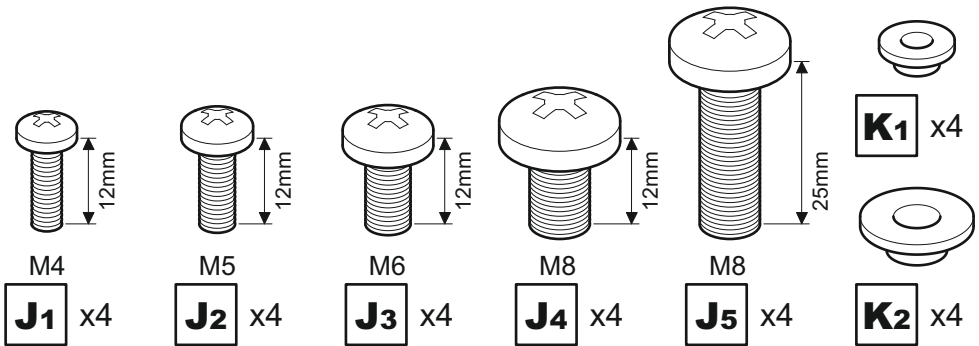

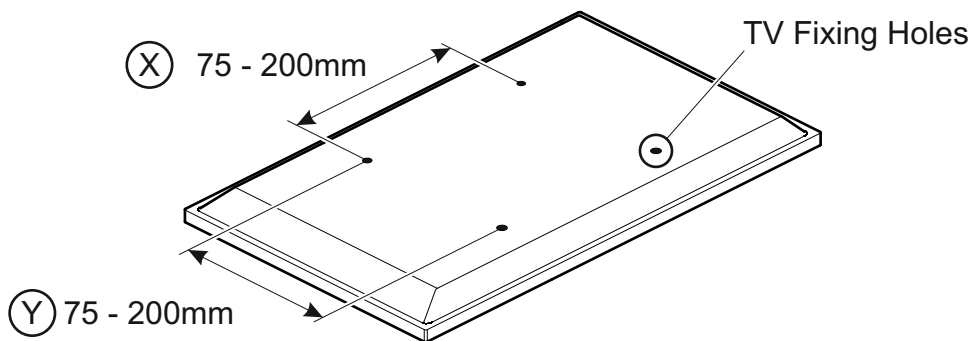
1**Measure the TV fixing holes Width and Height**

If width (X) is greater than 200mm or height (Y) greater than 200mm
STOP installation now and contact the customer help line

You are provided with 4 diameters of TV fixing screws, **M4**, **M5**, **M6** and **M8**. Determine the screw diameter that fits and remember for step 3.

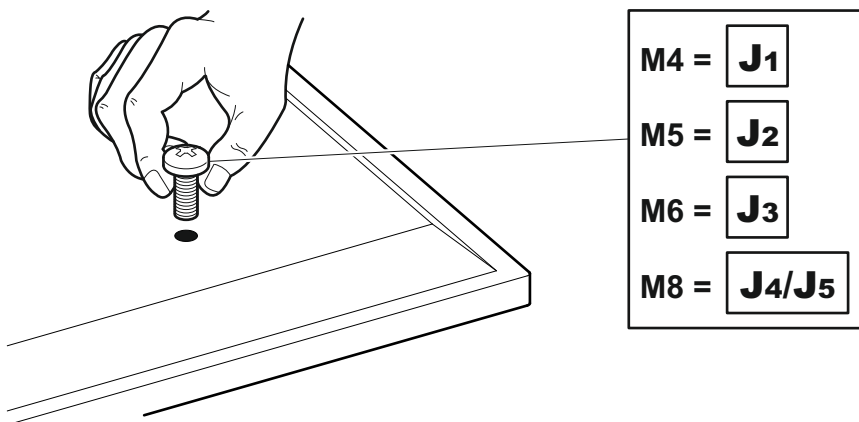

2

Preparing the TV Mounting Plate

Use the option that fits your TV

OPTION 1

TV Fixing Hole Sizes

- ⊗ 75mm x ⊙ 75mm
- ⊗ 100mm x ⊙ 100mm

OPTION 2

TV Fixing Hole Sizes

- ⊗ 200mm x ⊙ 100mm - 200mm

If in any doubt please call the customer help line.

OPTION 1

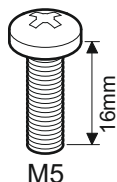
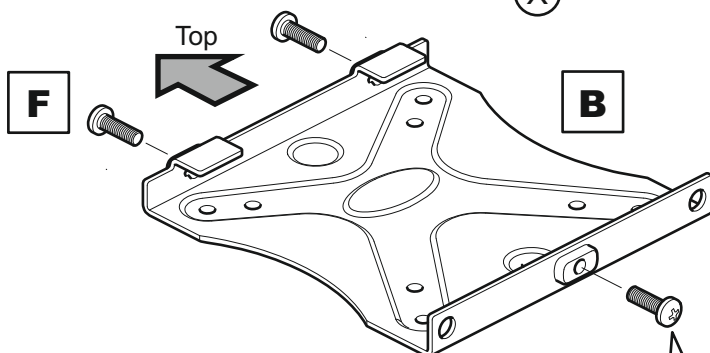
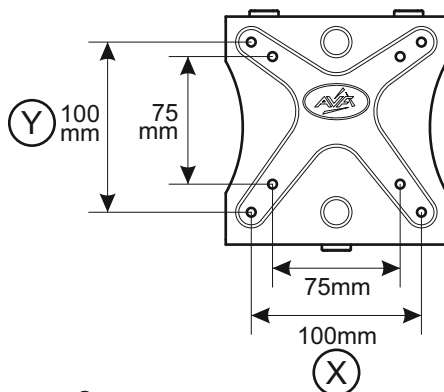

M5

F x3

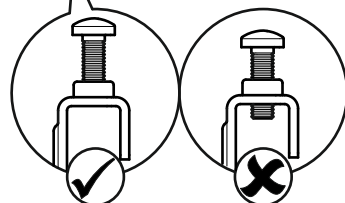

OPTION 2

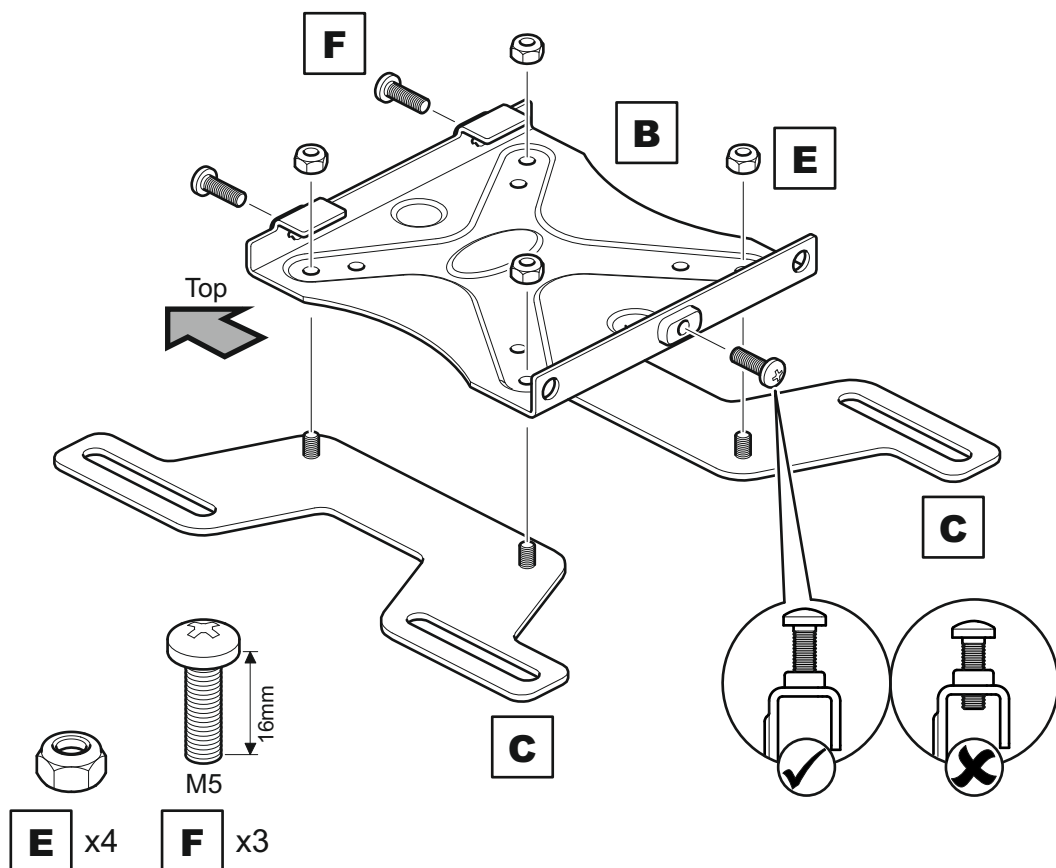
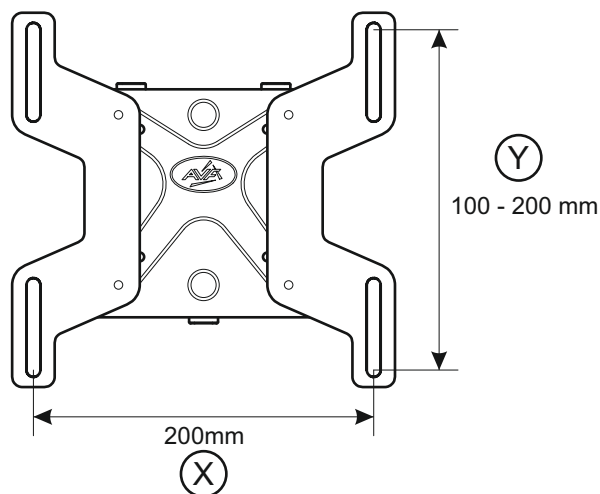

3

Fitting the TV Mounting Plate

OPTION 1

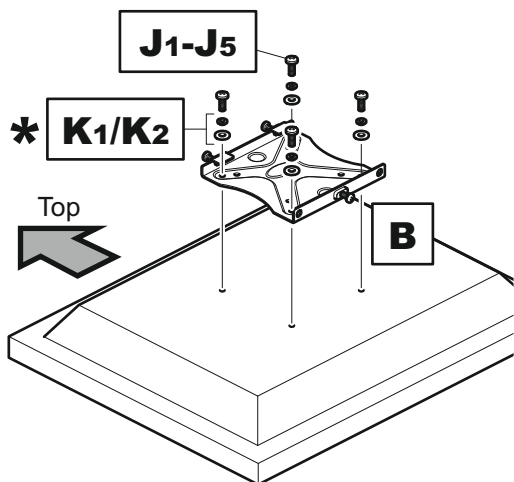

OPTION 2

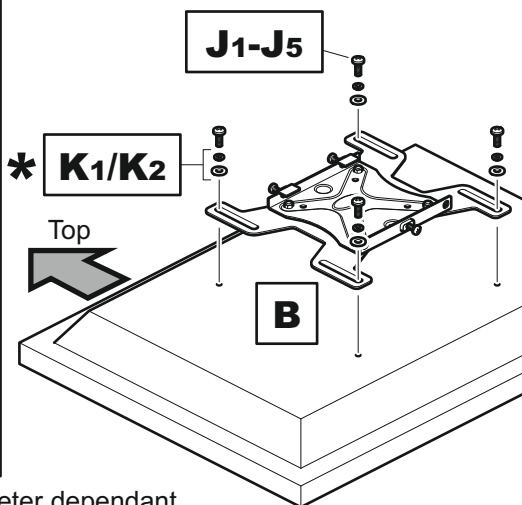

* Screw diameter dependant

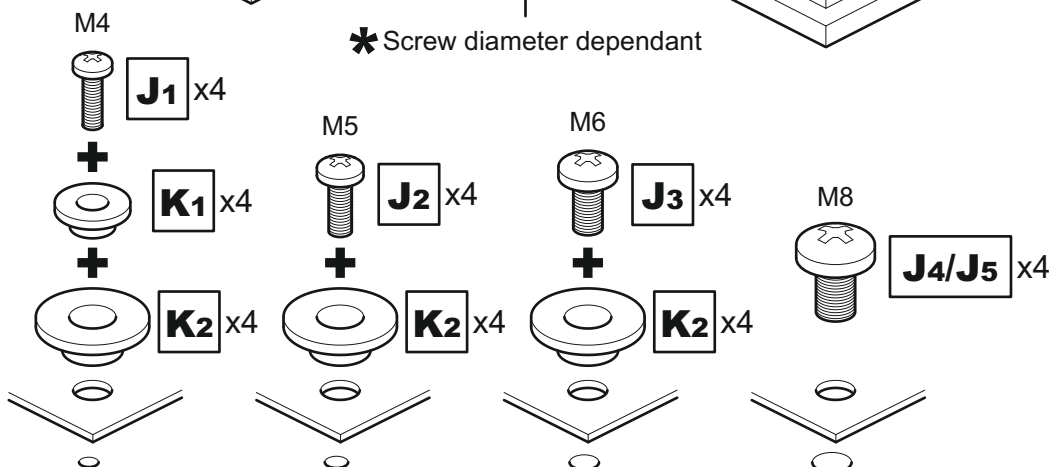

Attach the bracket to the back of your TV using suitable screw, and reducer combinations.

WARNING

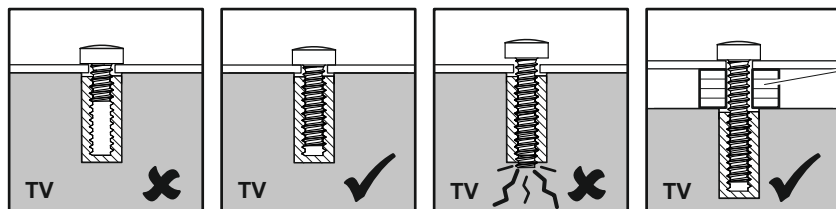

After completing step 3 you will have fittings left over, please keep for future reference

4

Fitting the Wall Bracket

Solid Wall

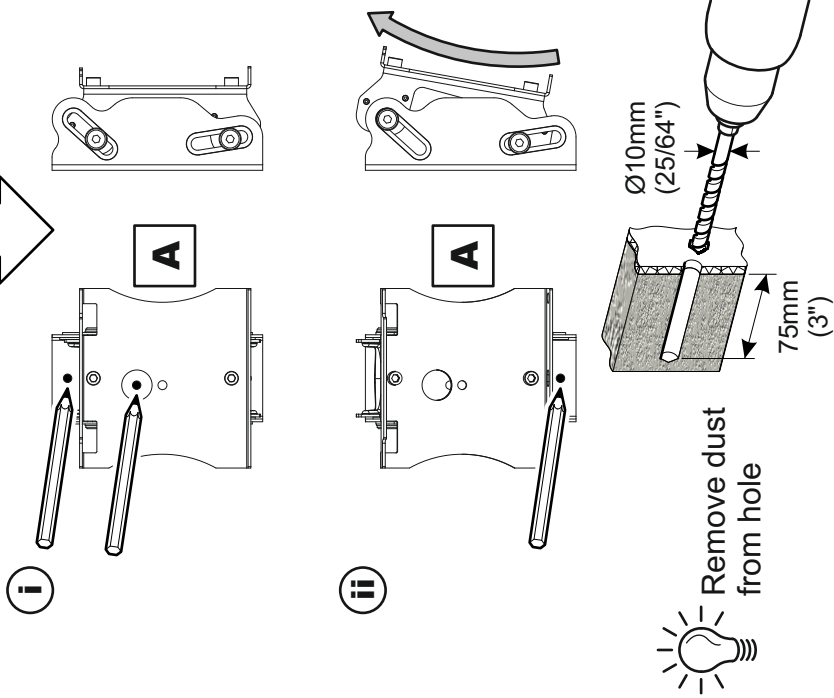

Wood Stud

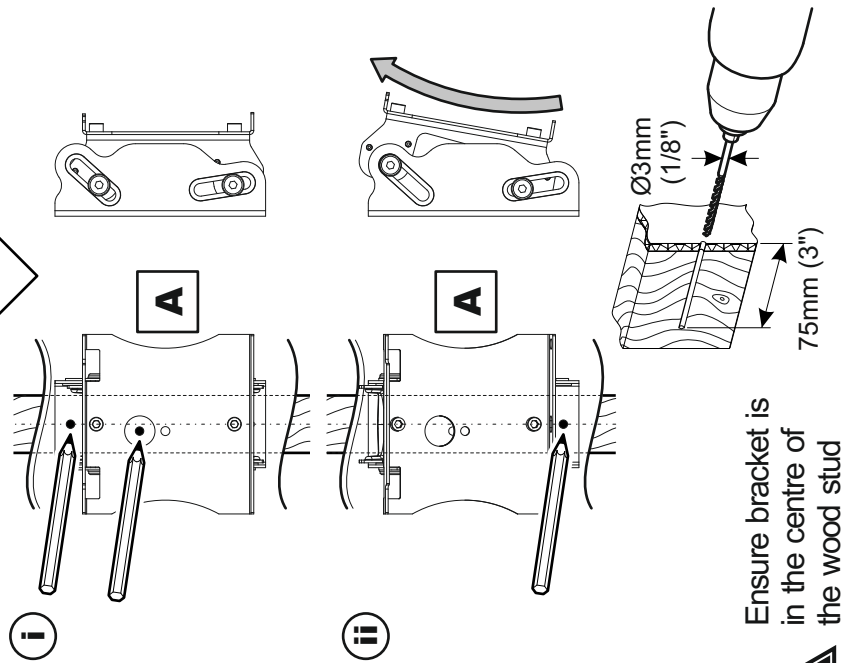

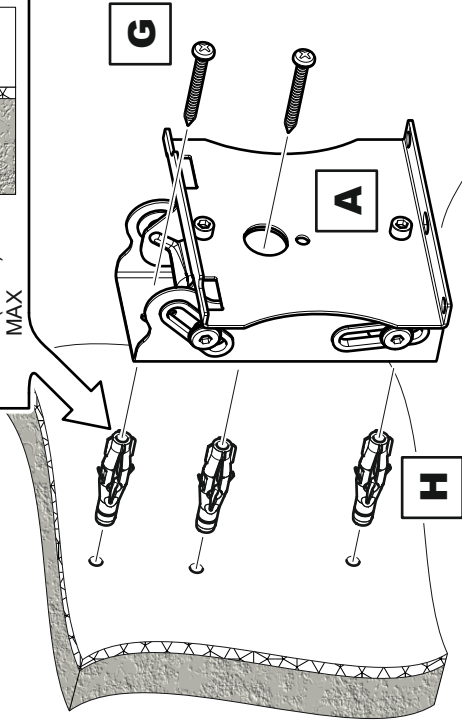
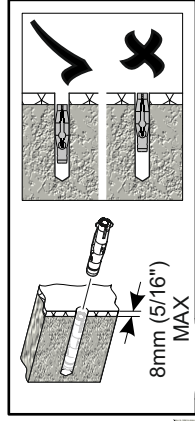
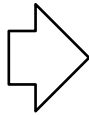

Lubricate screw
thread with soap



DO NOT over tighten screws
Tighten screws by hand only

G

x3

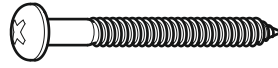

H

x3

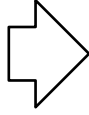
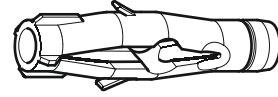

Lubricate screw
thread with soap

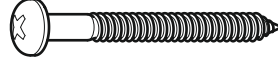
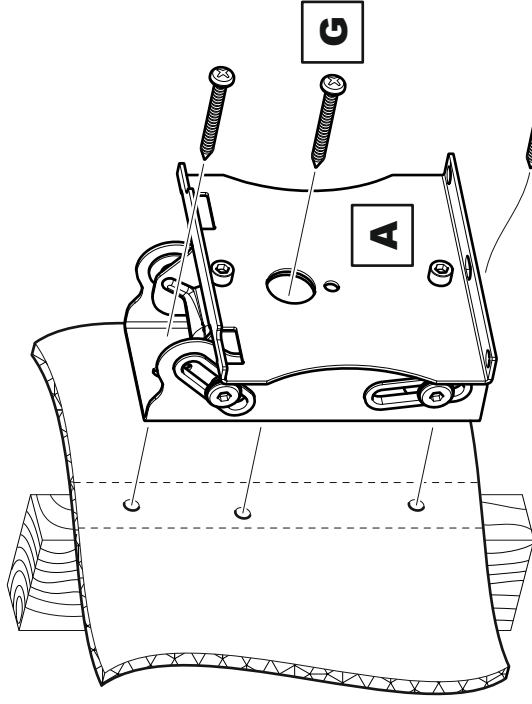

G

x3



DO NOT over tighten screws
Tighten screws by hand only

5

Attach the TV

Attaching

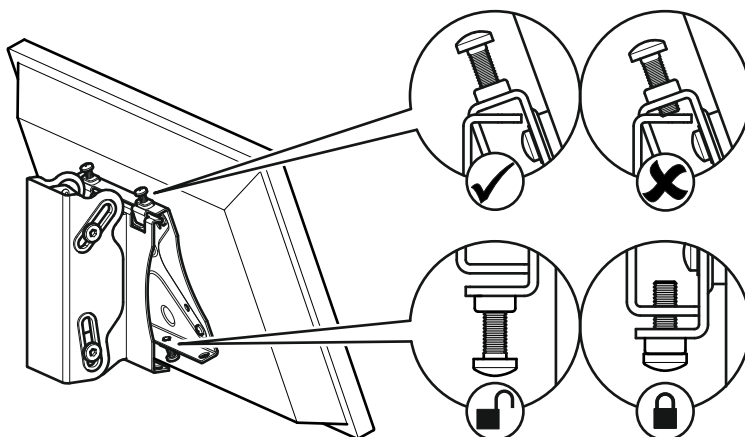

TV Levelling

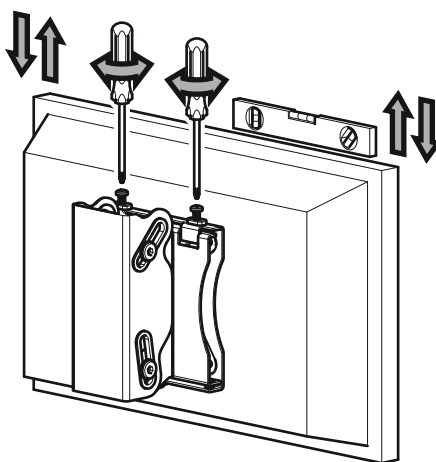

Optional

Lock Tilt

