

JML2400

463446 rev05

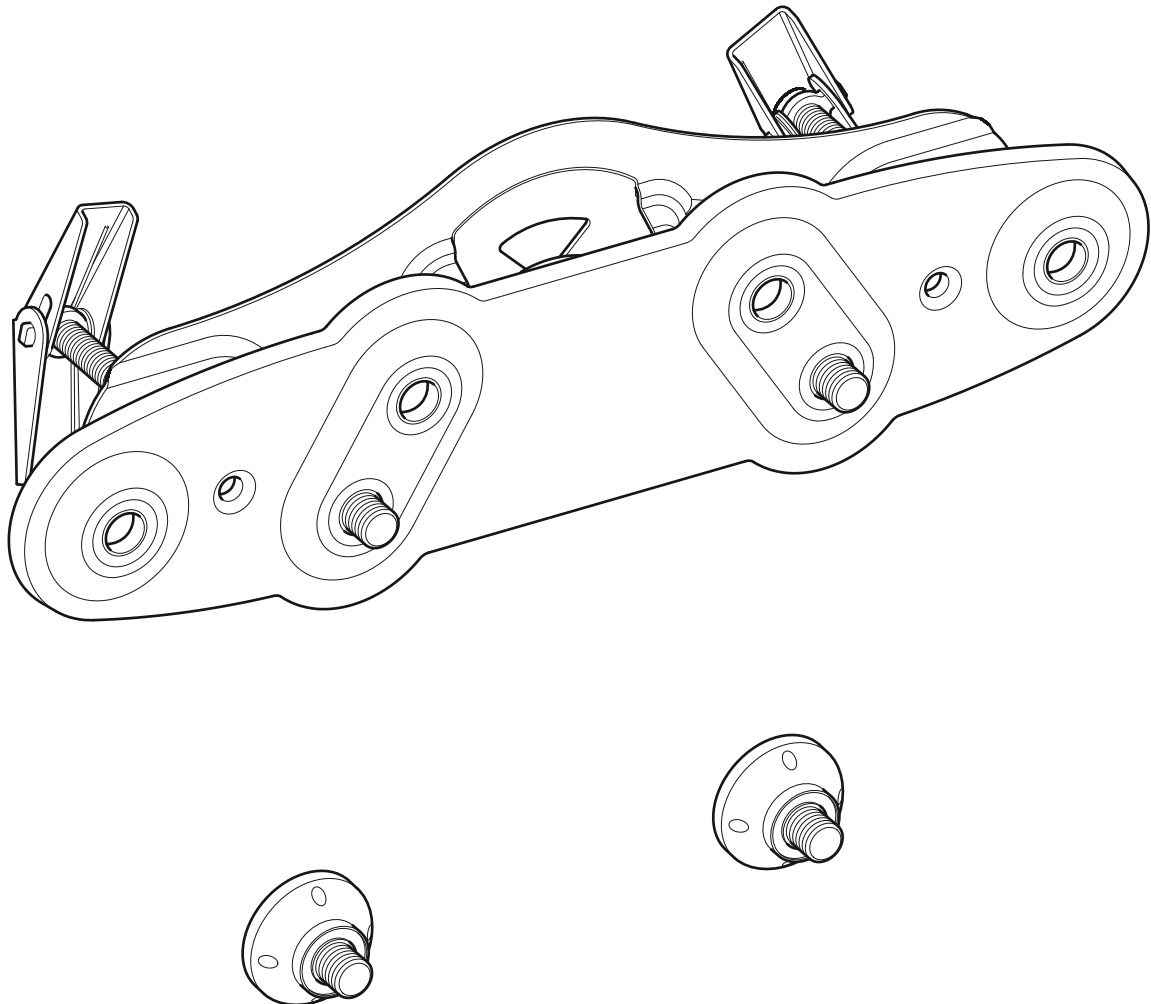

*Read through **ALL** instructions before commencing installation.
If you have any questions about this product or issues with installation
contact the customer services helpline before returning this product to
the store. See jl.avfgroup.com/p/jml2400 for more information.*

CUSTOMER SERVICES HELP LINE NUMBER:

0333 320 0463



AVF Group Ltd. Hortonwood 30, Telford, Shropshire, TF1 7YE, England

1 Boxed Parts

You will not need all these parts, so expect there to be some left over depending upon the specification of your TV.

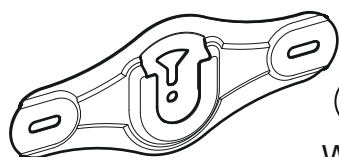

A - x1
Wall Bracket

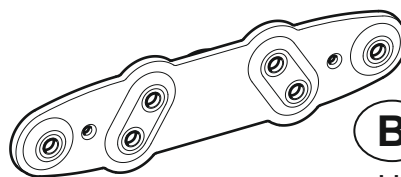

B - x1
Hanger



C - x2
Stand-off

TV Fixings: Parts go on the back of the TV (specification of your TV will determine which ones you require - see section 9).



D1 - x10
Spacer



D2 - x4
Spacer (Red)



E1 - x4
M4 Adaptor



E2 - x4
M5 Adaptor



E3 - x4
M6 Adaptor



F1 - x2
M4 16mm



F2 - x2
M4 25mm



F3 - x2
M4 35mm



F4 - x2
M4 50mm



F5 - x2
M4 60mm



F6 - x2
M5 16mm



F7 - x2
M5 25mm



F8 - x2
M5 35mm



F9 - x2
M5 50mm



F10 - x2
M6 16mm



F11 - x2
M6 25mm

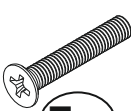

F12 - x2
M6 35mm

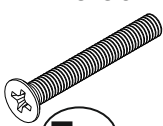

F13 - x2
M6 50mm



F14 - x2
M8 16mm



F15 - x2
M8 25mm

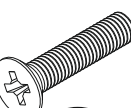

F16 - x2
M8 35mm

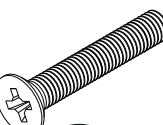

F17 - x2
M8 50mm

Wall Fixings: Parts to attach to the wall (type of wall will determine which fixings you require).



G - x2
Wall Fixing

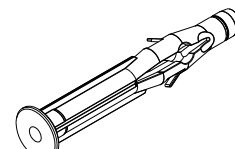

H - x2
Long Wall Plug



I - x4
Lock Nut

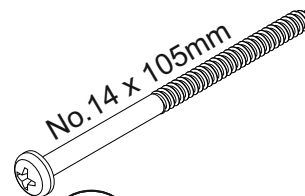

J - x2
Long Screw



K - x1
Metal Stud Screw

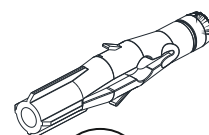

L - x2
Wall Plug

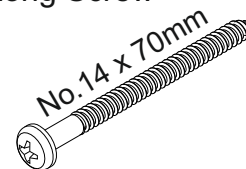

M - x2
Screw

Included Tools

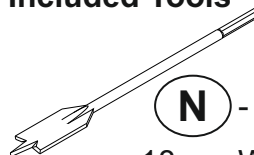

N - x1
18mm Wood Drill



O - x1
3mm Hex Key

2 Tools Required

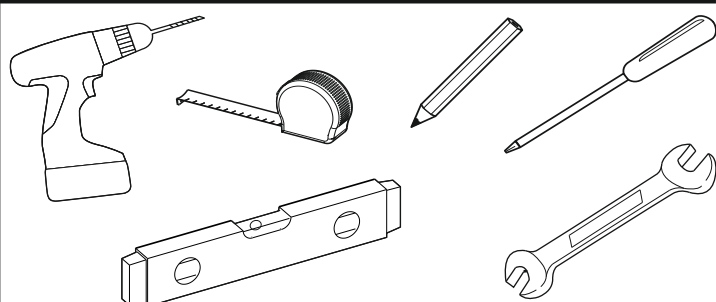

Wall Marking Template

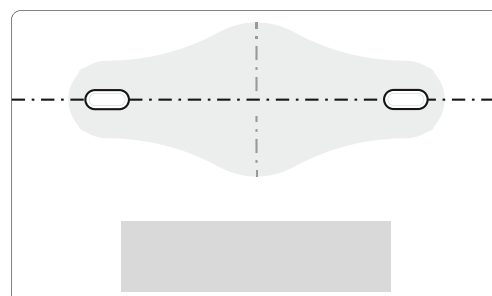

WT

3 Determine Correct TV Screw Size

Choose from the TV Fixings selection. You need to determine which length and diameter of screws fits your TV. To determine the correct screw diameter, try screwing (F₂), (F₇), (F₁₁) & (F₁₅) into one of the fixing holes on the back of the screen until you find the one that fits. Note the thread size and ensure you use the appropriate diameter screws.

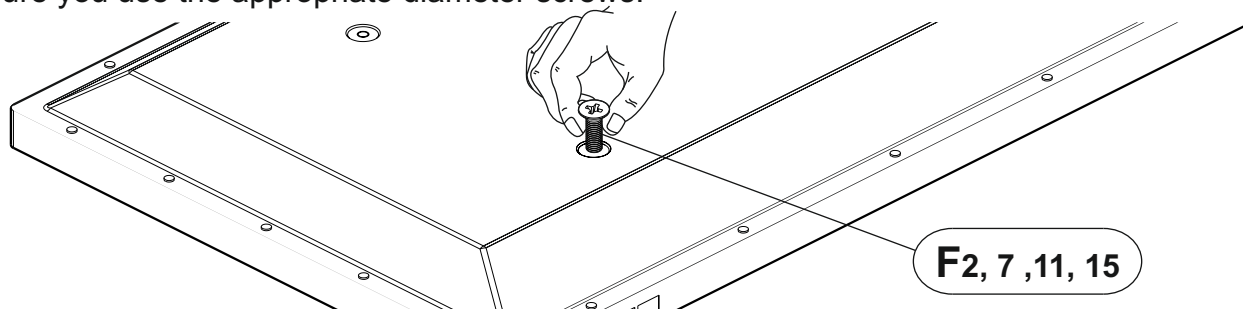

4 Fit Screen Hangers To TV

Once you have established which screws you need for your TV you can attach the Hanger (B) and Stand-offs (C) to the back of your TV.

Typical recommended examples shown are for fixings with the TV spaced 20mm from the wall. The TV Mount can position your TV between 20mm and 40mm from the wall. For alternative configurations see sections 9.

You might need to use spacers to increase the clearance of your TV from the wall in order to avoid cables coming out of your TV and improve access and ventilation to the back of your TV (spacers (D₁) allow you to have a gap of 30mm or 40mm, see section 9).

In certain circumstances it may be necessary to use red spacer (D₂) as either a replacement or addition to spacer (D₁) or use longer screws. For more information please see section 9.

If your TV fixing centres don't fit, STOP installation and contact the customer services helpline.

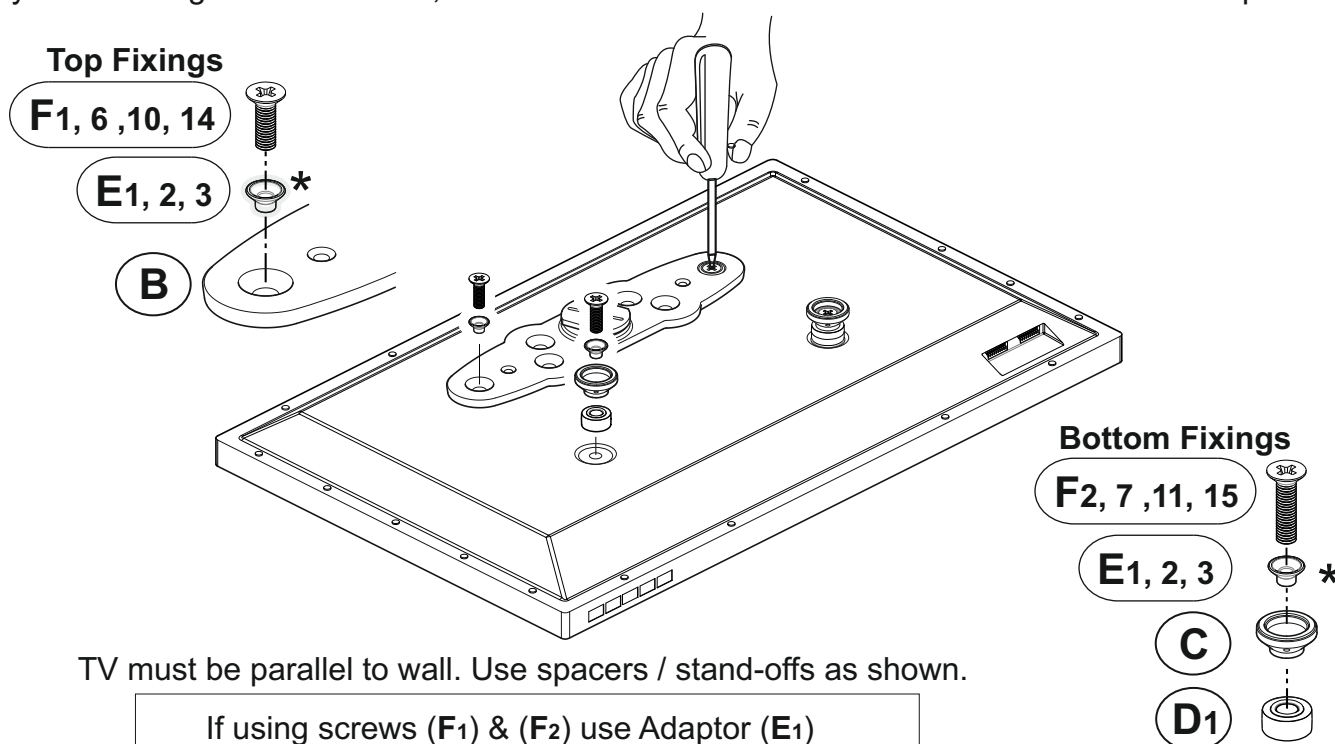

TV must be parallel to wall. Use spacers / stand-offs as shown.

- * If using screws (F₁) & (F₂) use Adaptor (E₁)
- * If using screws (F₆) & (F₇) use Adaptor (E₂)
- * If using screws (F₁₀) & (F₁₁) use Adaptor (E₃)
- * If using screws (F₁₄) & (F₁₅) no Adaptor required

5 Marking Wall For Drill Points



IMPORTANT:- When deciding where to locate your TV, remember clearance around your TV is required in order to fit the TV. See Section 8 “Hanging The TV”.



For this step you will need your Wall Marking Template **WT**.

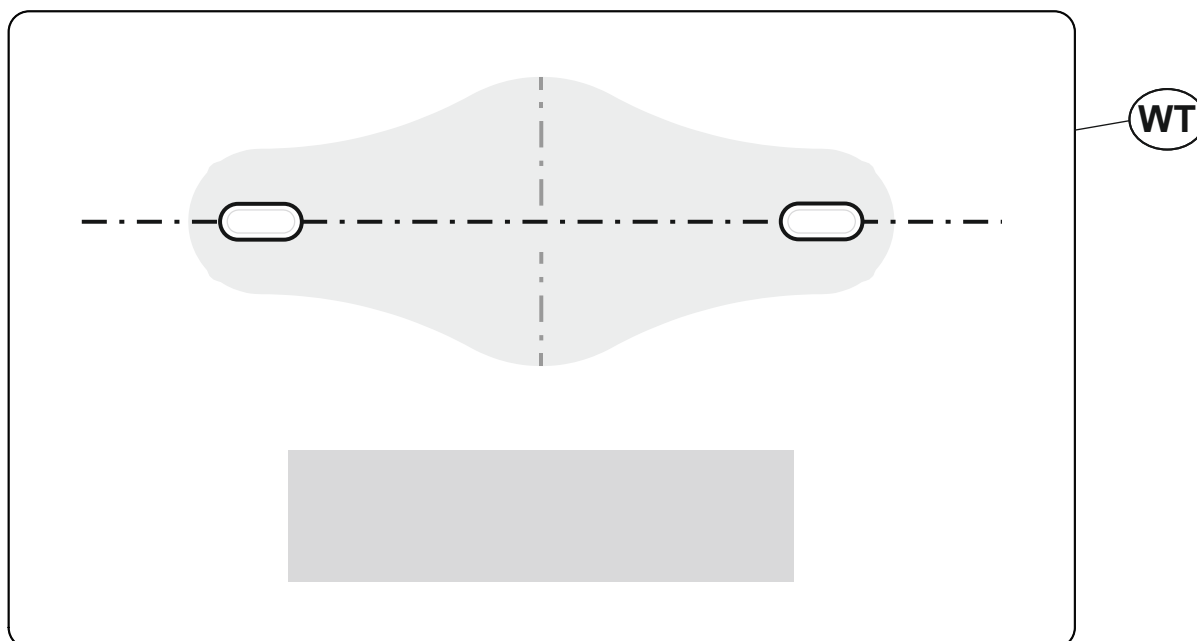

To determine the exact position for your drill points use the Height Calculator app. Follow the link to the app shown on your Wall Marking Template.

Before marking the wall, determine the wall type that you have (i.e. Solid Wall / Dot & Dab / Plasterboard / Wood Stud / Metal Stud). Ensure the drilling area is free from mains services (Gas / Electric / Water).

Before you drill make sure you are happy with the position and ensure template is level.

6 Planning & Preparation

Determine the wall type that you have (i.e. Brick/Stud/Plasterboard/Sheetrock).
Ensure the drilling area is free from mains services (Gas/Electric/Water).
Drill three 3mm diameter pilot holes to verify the wall type and select the appropriate fixings (See Section 7).

7 Install Wall Fixings

Use the correct fixings for your wall type. Mixing fixing types may be required for installations that span different wall types. **DO NOT OVER TIGHTEN SCREWS.**

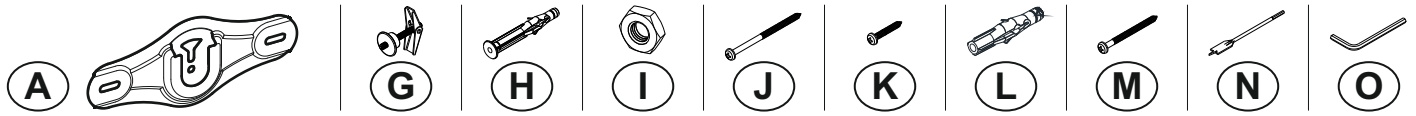

Solid Wall

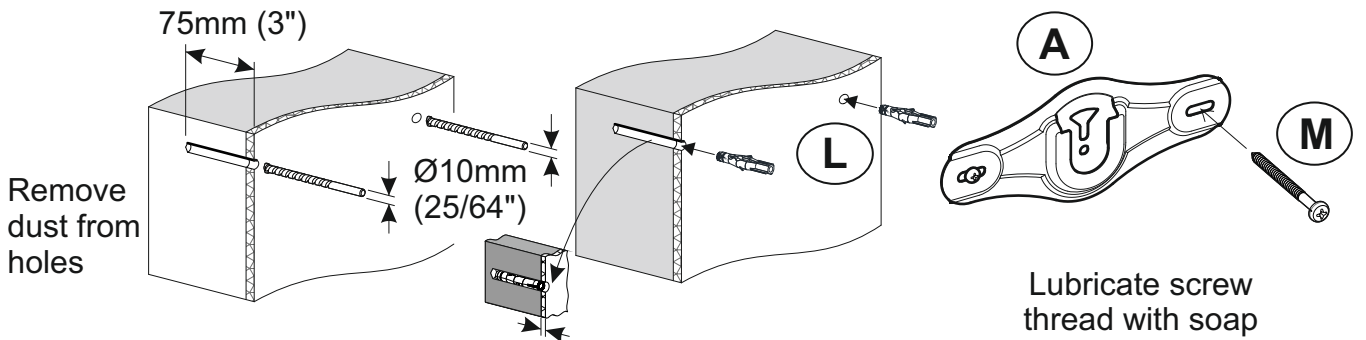

Dot & Dab

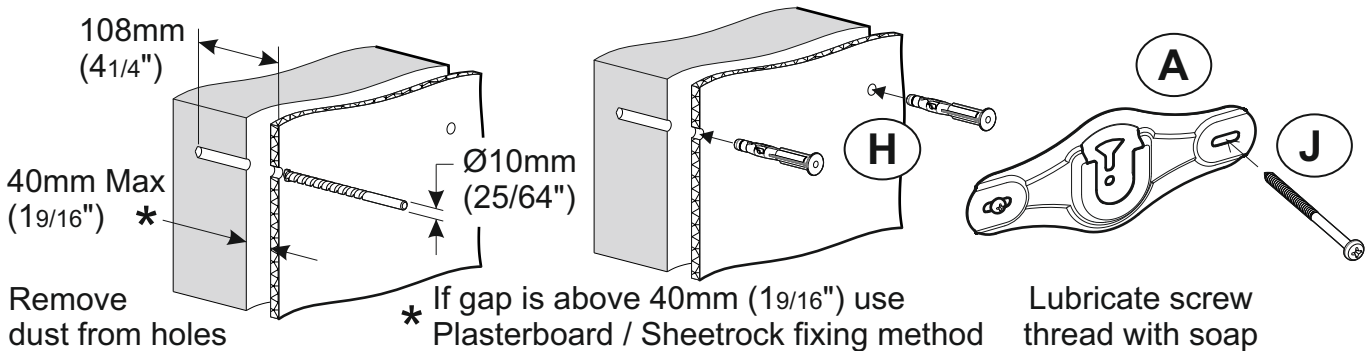

Plasterboard / Sheetrock

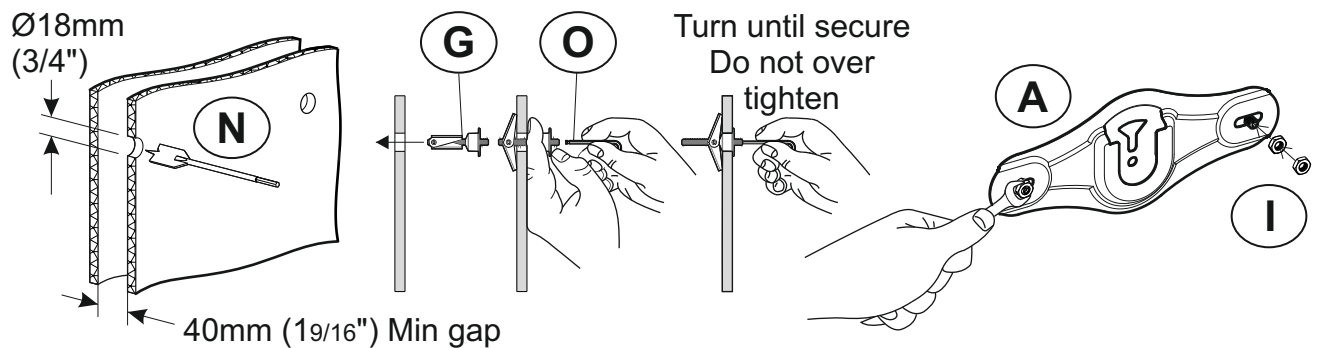

Wood Stud

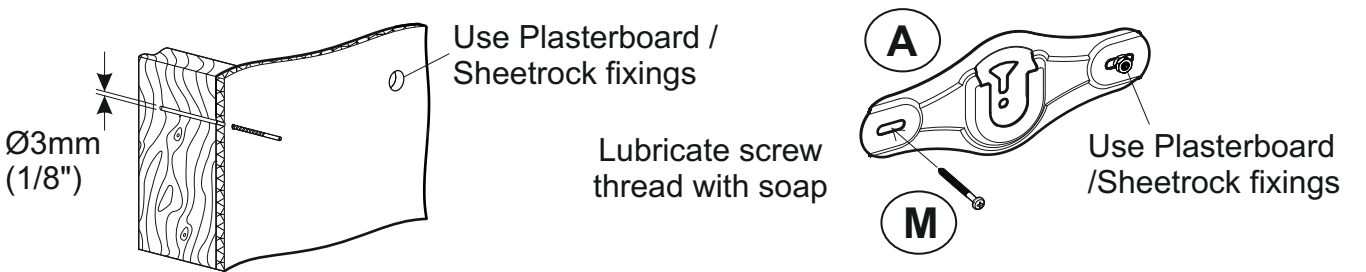

Only one fixing will be in the wood stud. The other fixings will be in plasterboard / sheetrock (see above).

Metal Stud

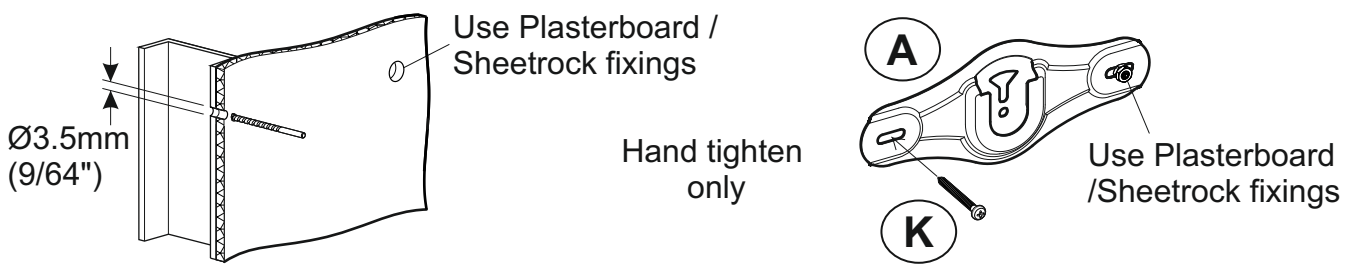

Only one fixing will be in the metal stud. The other fixings will be in plasterboard / sheetrock (see above).

8 Hanging The TV

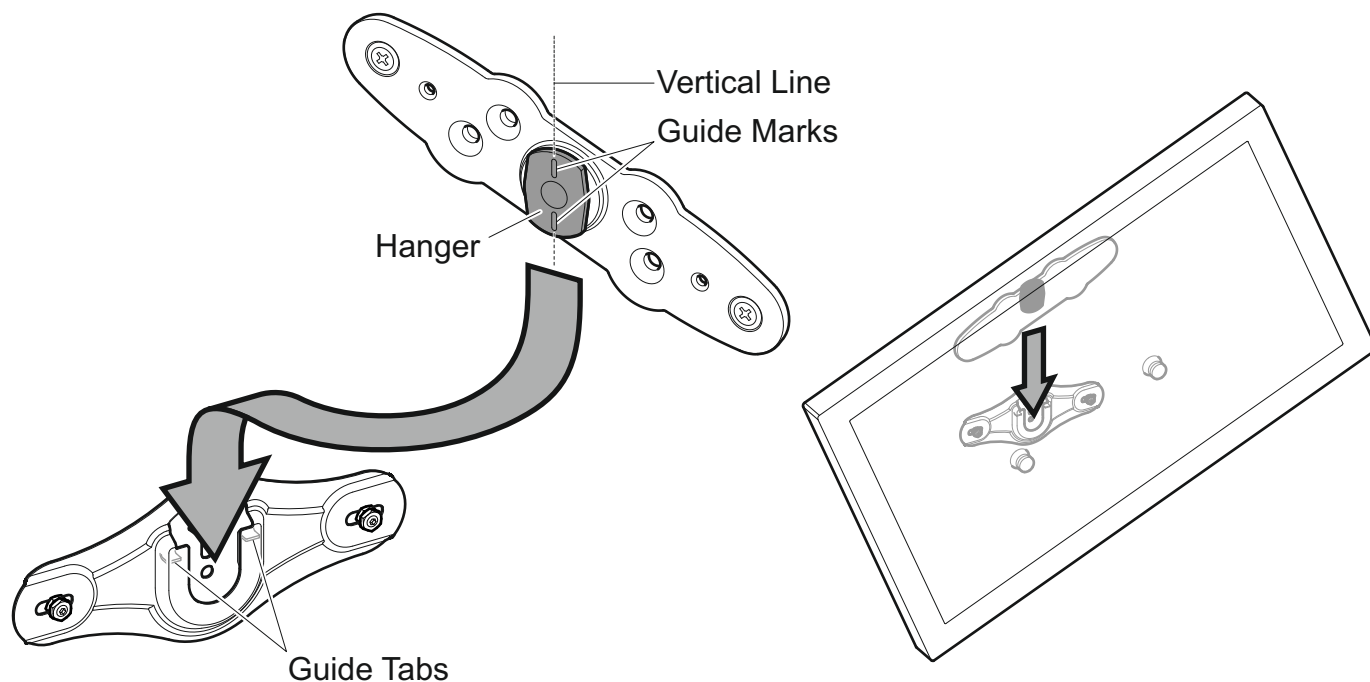

Rotate your TV so that the guide marks on the hanger are vertical. Next slide your TV down so that the hanger goes between the two guide tabs on the wall bracket. Ensure the hanger is fully engaged and rotate clockwise until your TV is level.

If cables from your TV prevent the TV resting against the wall then an alternative hanger configuration will be required (See Section 9).

TV must be parallel to wall. Use spacers / stand-offs as shown.

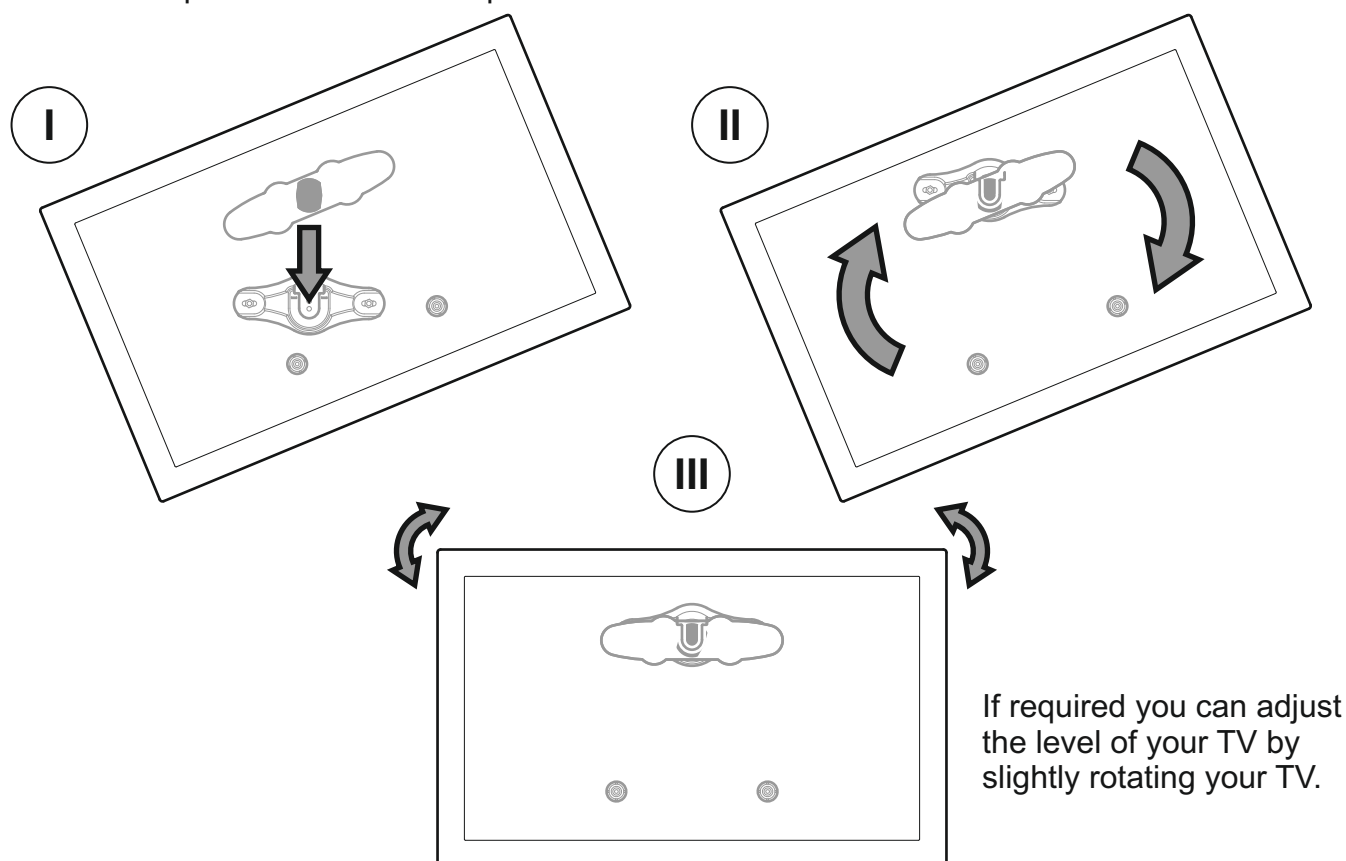

Removing the TV

This is a two person job. To remove the TV rotate anti-clockwise between 15-30° and lift TV up and out (ie reverse the movements as shown above).

9 Alternative Hanger Configurations

Alternative Wall spacings of 20mm, 30mm & 40mm can be achieved using the spacer / screw combinations listed in this section.

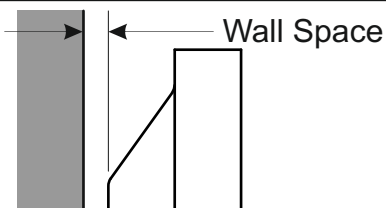

20mm Wall Space
(as shown in section 4)

Top Fixings

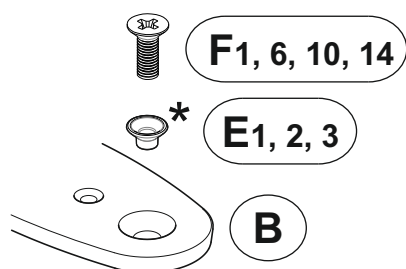

30mm Wall Space

Top Fixings

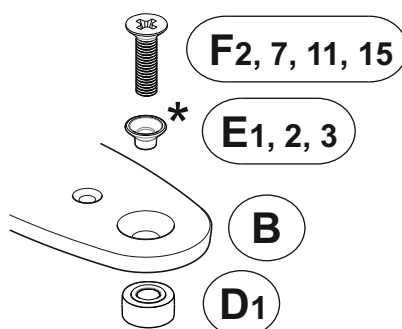

40mm Wall Space

Top Fixings

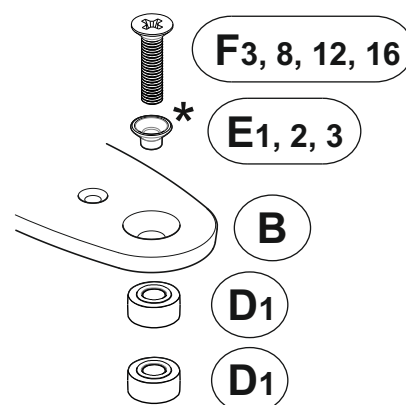

Bottom Fixings

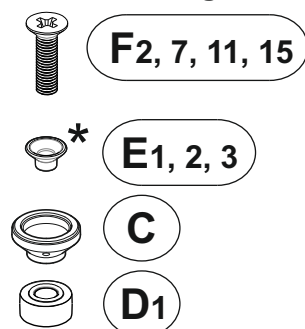

Bottom Fixings

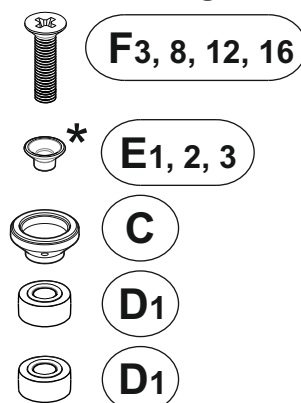

Bottom Fixings

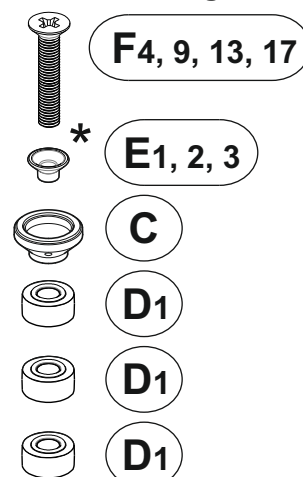

TV must be parallel to wall. Use spacers / stand-offs as shown.

- Use adaptor (E1) with screws (F1), (F2), (F3), (F4) & (F5)
 Use adaptor (E2) with screws (F6), (F7), (F8) & (F9)
 * Use adaptor (E3) with screws (F10), (F11), (F12) & (F13)
 No adaptor required with screws (F14), (F15), (F16) & (F17)



When is it necessary to use red spacers?



(D2) - x4

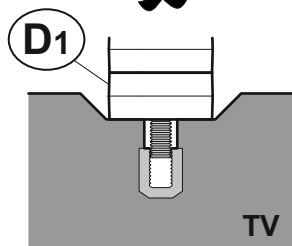

Problem
Not enough
screw engagement

It is recommended that when fitting Hanger (B) and Stand-offs (C) to your TV you have at least 5-10mm of screw engagement. In certain circumstances you may need to use red spacers (D2) as either a replacement, or together with spacers (D1) to achieve this. Whenever you use red spacers (D2) you must use all 4 provided. In some instances it may be necessary to step up a screw length, rather than remove spacers.

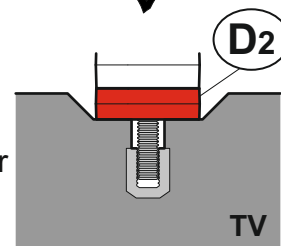

Solution
Red spacer (D2) has
replaced spacer (D1)

