

BLENHEIM

FS800BLE
463352rev01

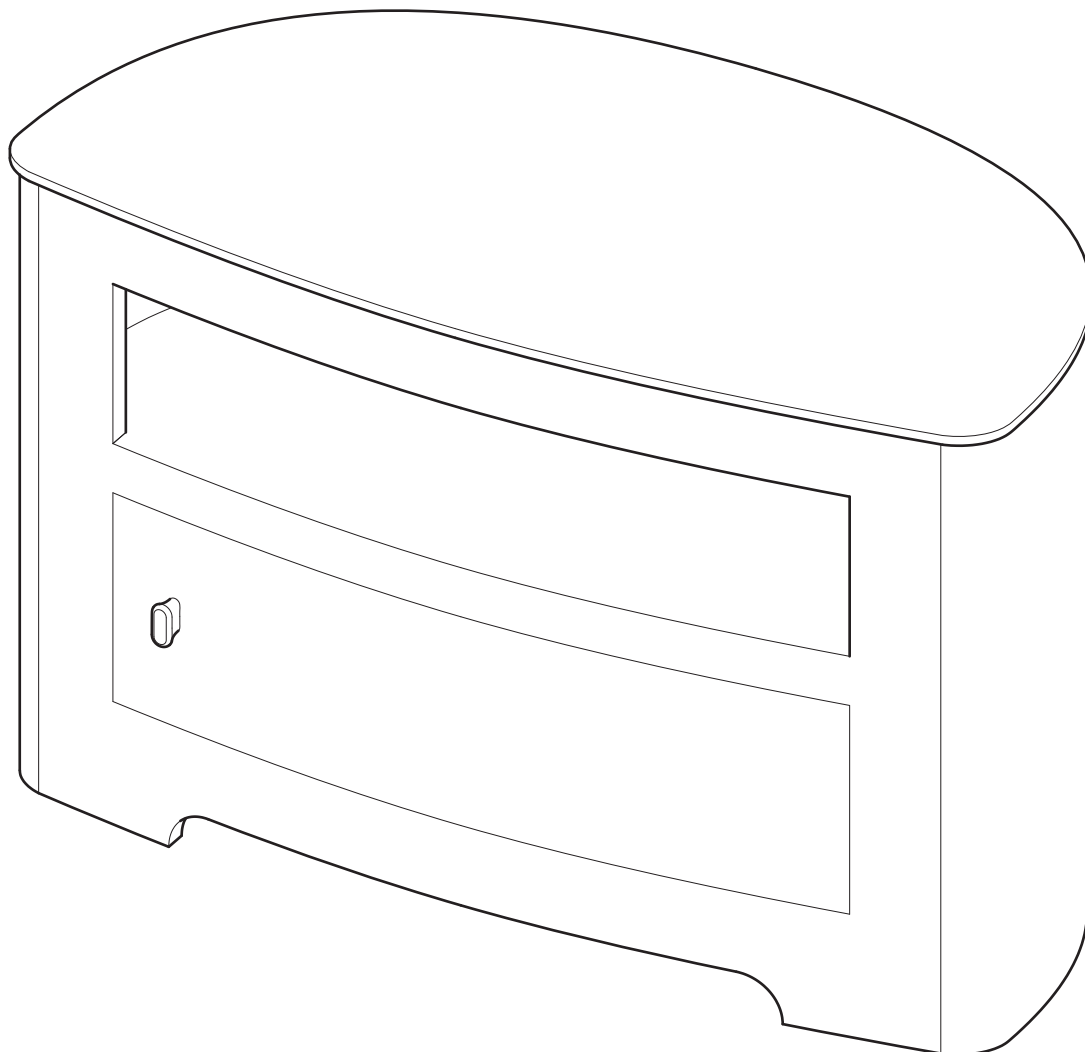

Read through ALL instructions before commencing assembly.
If you have any questions about this product or issues with
assembly contact the customer services help line before
returning this product to the store.

CUSTOMER SERVICES HELP LINE NUMBER:

01952 670009
0870 0609777 (UK)

AVF Group Ltd
Road 30. Hortonwood Ind Est,
Telford, Shropshire, TF1 7YE, England
www.avfgroup.com

IMPORTANT INFORMATION!

We advise that before starting the assembly of this product that you familiarise yourself with the instructions and the parts list in this leaflet.

Do not's

Do not over tighten any part of this assembly

Do not place hot or cold objects on to or close next to any glass surface unless the object is sufficiently insulated to prevent contact.

Do not strike the glass with hard or pointed items.

Do not sit or stand upon horizontal glass surfaces.

Do not use washing powders or other substances containing abrasives when cleaning the glass surfaces as these may scratch the glass.

Do's

Do use a damp cloth with diluted washing up liquid for cleaning the glass surfaces.

Do use a soft cloth with a suitable furniture polish when cleaning wooden panels.

Maximum TV size and weight capacity

The maximum TV size for this stand is 37" / 94cms.

TV weight must not exceed 81lbs / 37kgs.

The maximum load for the middle and bottom shelves is 55lbs / 25kgs each.

WARNING Wherever possible distribute weight evenly.

Boxed Parts

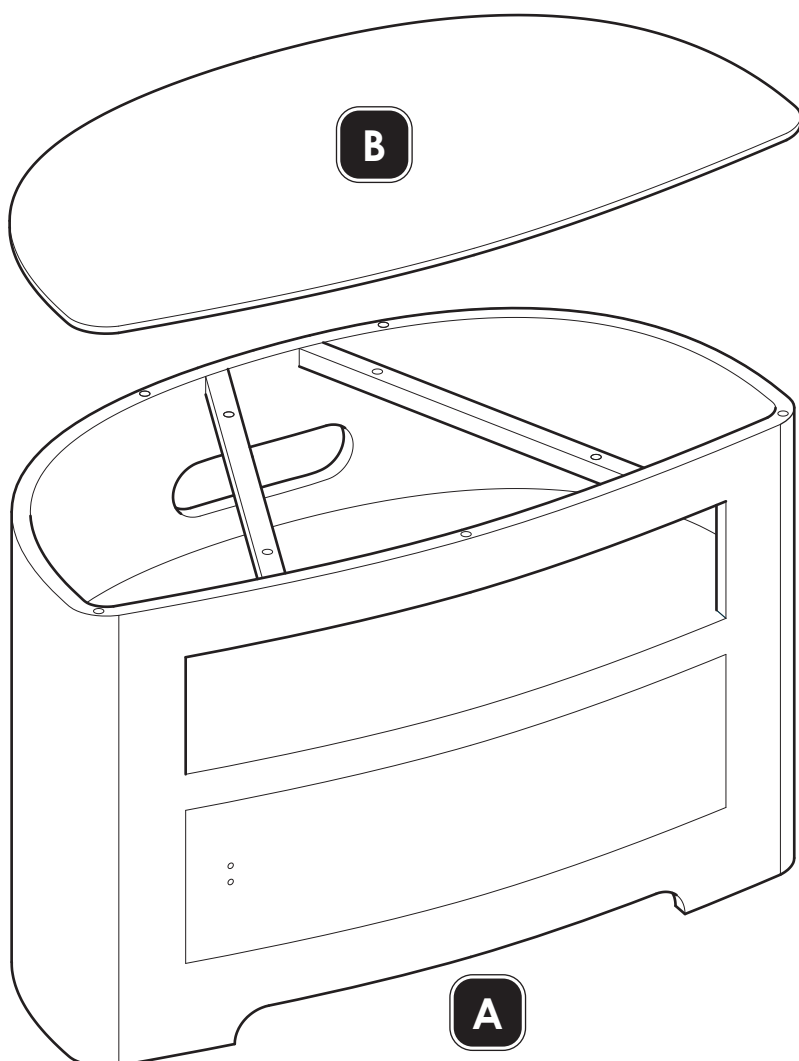

Tools Recommended

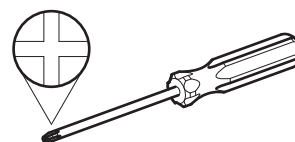

Step 1

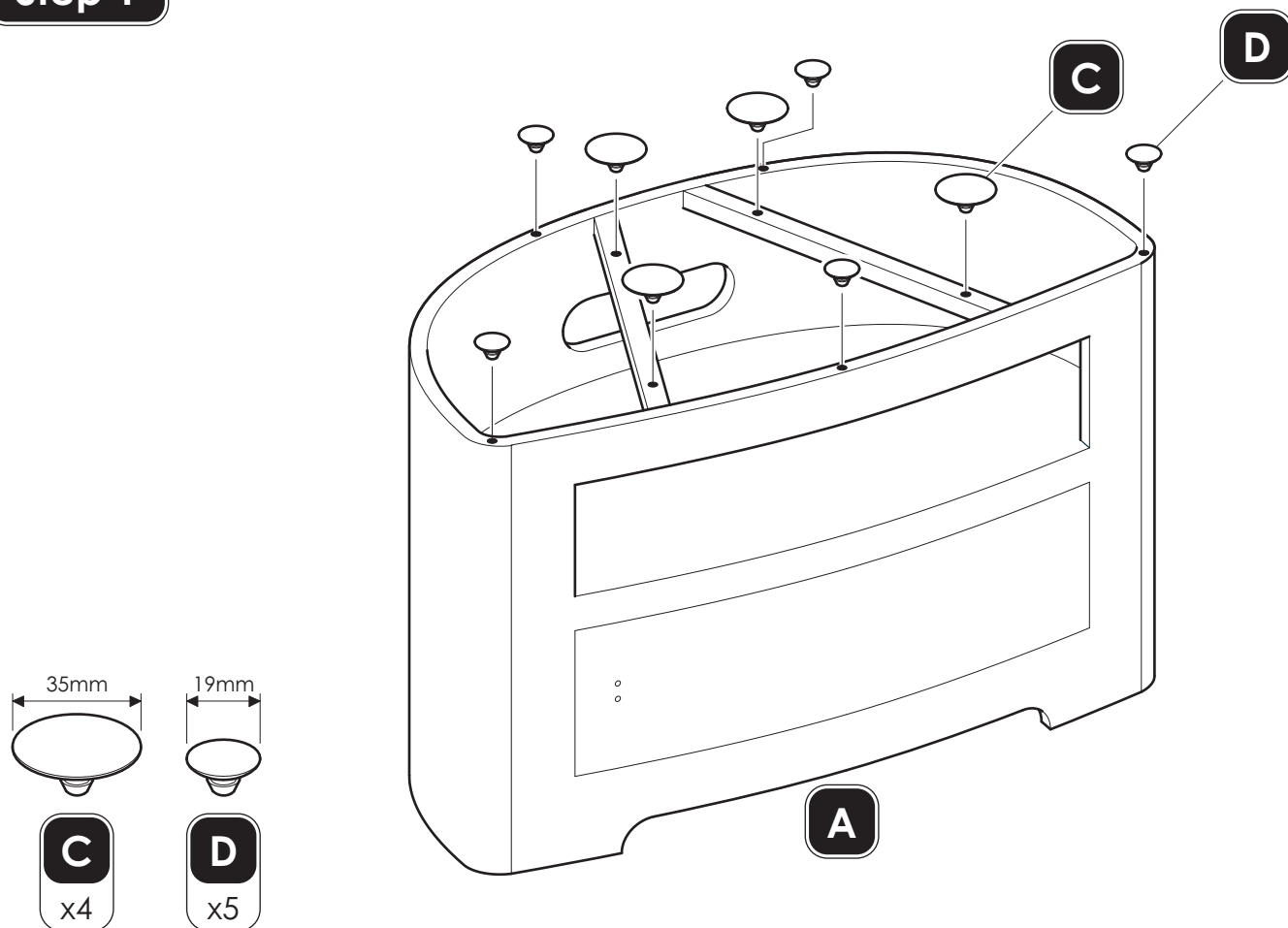

Step 2

