

L8500

English language

Leaflet No. **462983** rev 01

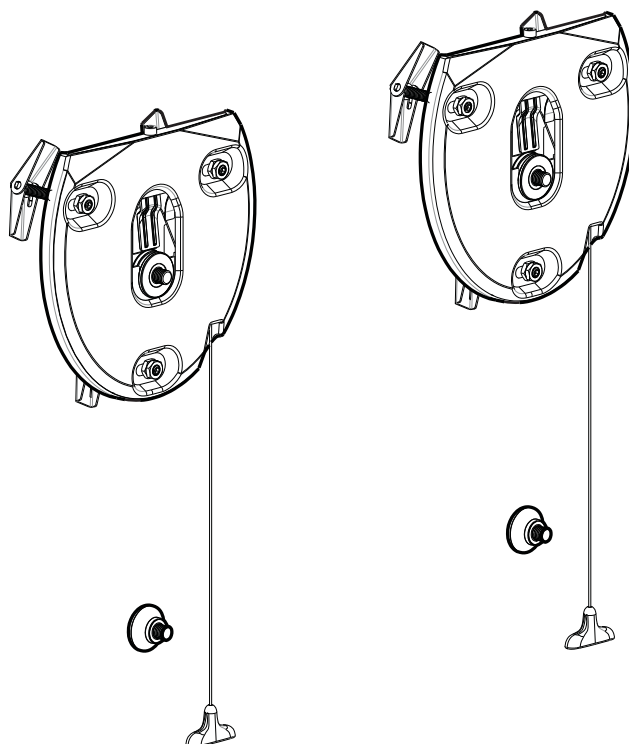

Read through all instructions before commencing installation.

If you have any questions about this product or issues with installation contact the customer services helpline before returning this product to the store.

See www.anywall.tv/vid for installation video.

AVF Group Ltd.

Road 30, Hortonwood Ind Est, Telford, Shropshire, TF1 7YE, England.

+44 (0) 1952 670009

0870 0609777 (UK)

AVF Incorporated.

3187, Cornerstone Drive, Mira Loma, CA 91752, USA.

1-800 667 0808 (USA)

Orbital Holdings Inc.

3187, Cornerstone Drive, Mira Loma, CA 91752, USA.

1-800 601 8450 (USA)

1 Boxed Parts

You will not need all these parts, so expect there to be some left over depending upon the specification of your TV.

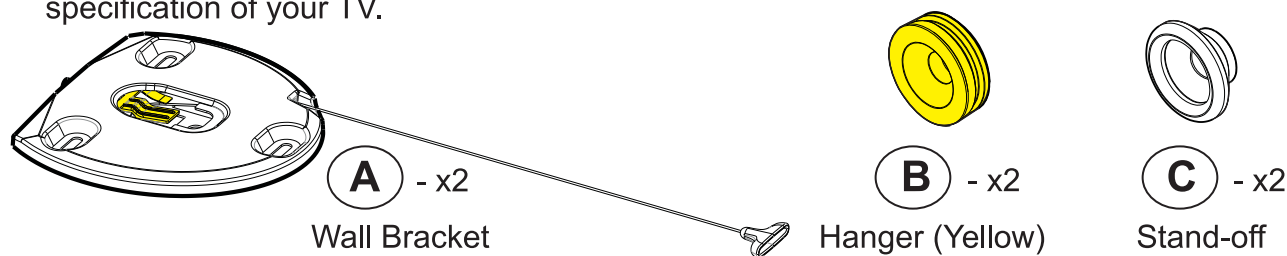

TV Fixings: Parts go on the back of the TV (specification of your TV will determine which ones you require - see section 11).

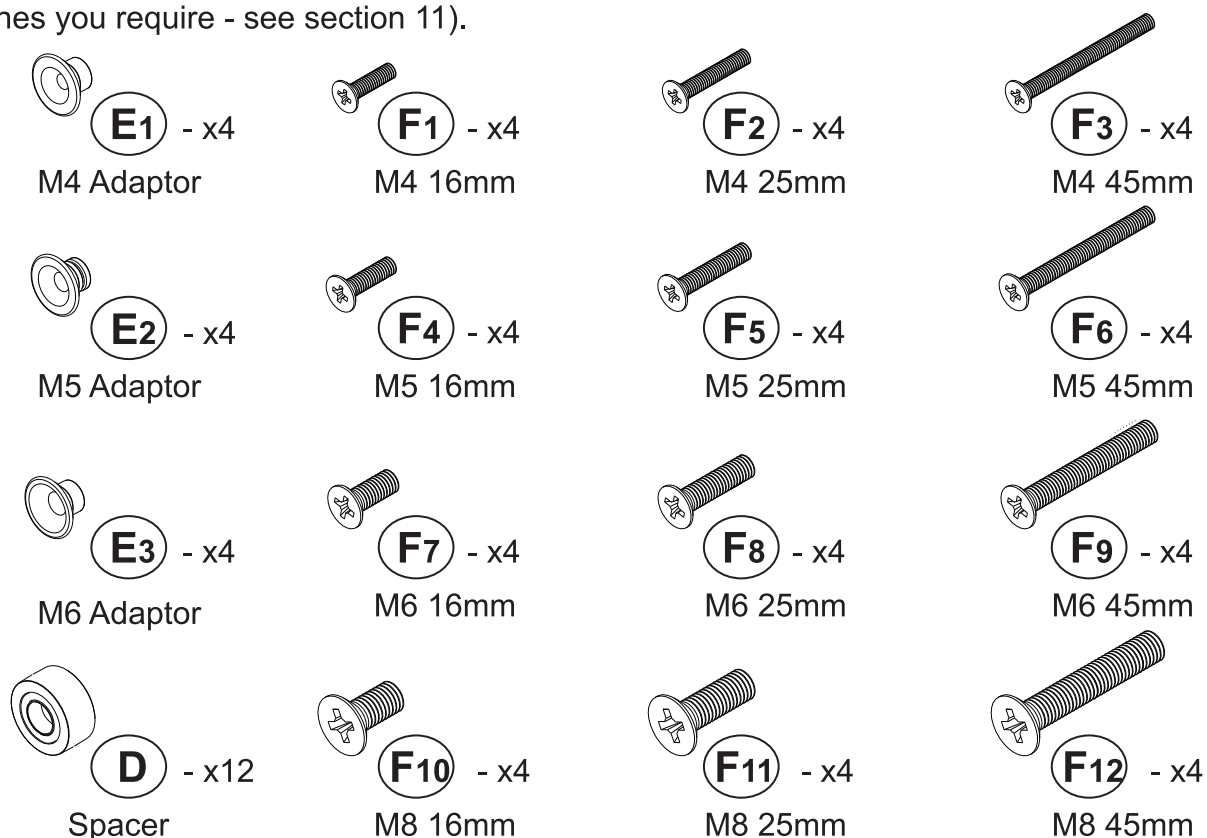

Wall Fixings: Parts to attach to the wall (type of wall will determine which fixings you require).

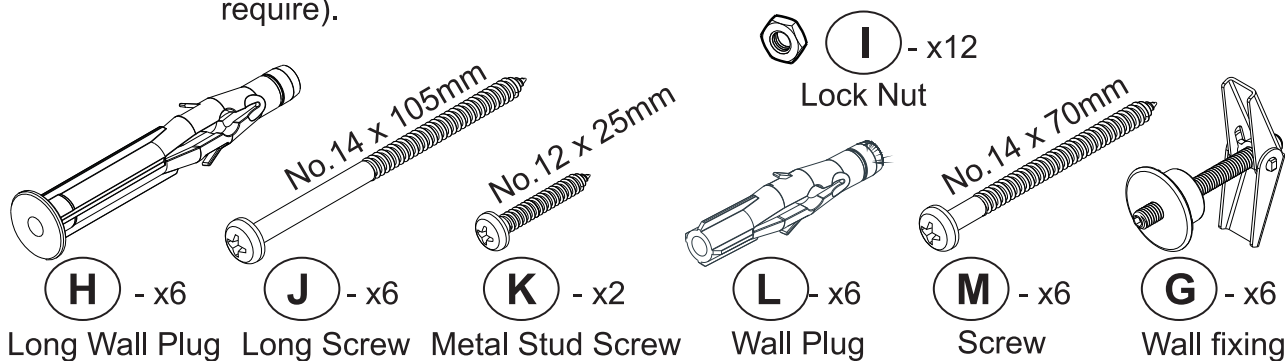

Included Tools

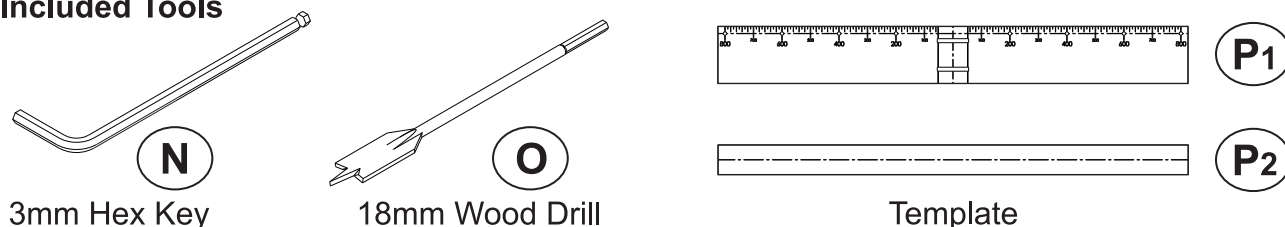

2 Tools Required

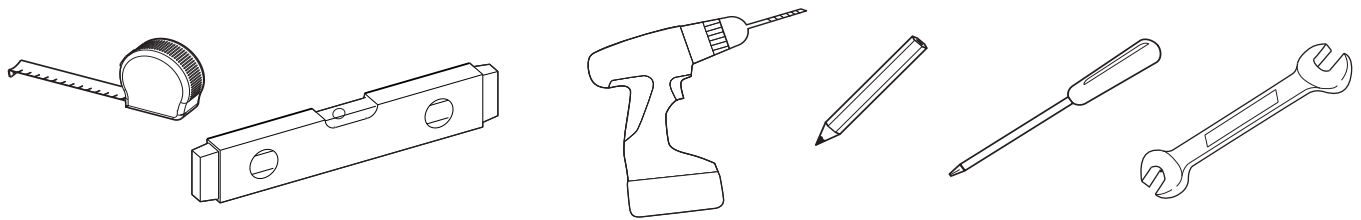

3 Determine Correct TV Screw Size

Choose from the TV Fixings selection. You need to determine which length and diameter of screws fits your TV. To determine the correct screw diameter, try screwing (F₂), (F₅), (F₈) & (F₁₁) into one of the fixing holes on the back of the screen until you find the one that fits.

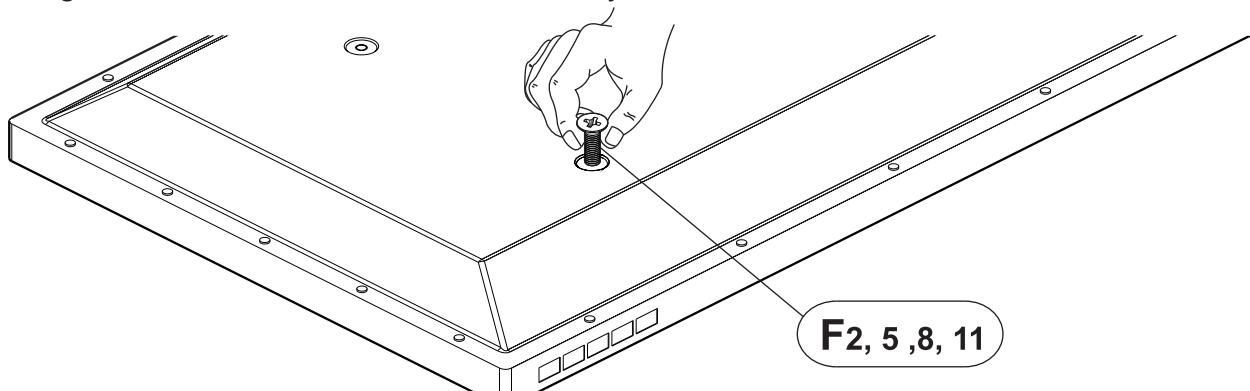

4 Fit Screen Hangers To TV

Once you have established which screws you need for your TV, you can attach the Hangers (B) and Stand-offs (C) to the back of your TV.

Typical recommended example shown is for fixings with the TV spaced 20mm from the wall. The TV Mount can position your TV between 12mm and 40mm from the wall. For alternative configurations see section 11.

You might need to use spacers to increase the clearance of your TV from the wall in order to avoid cables coming out of your TV and improve access and ventilation to the back of your TV (spacers (D) allow you to have a gap of 20mm or 40mm, see section 11).

Top Fixings

F₂, 5, 8, 11

E₁, 2, 3

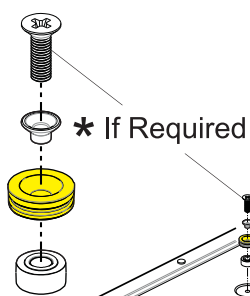

Bottom Fixings

F₂, 5, 8, 11

E₁, 2, 3

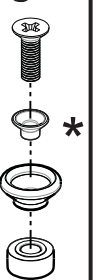

* If using screw (F₂) use Adapter (E₁)
If using screw (F₅) use Adapter (E₂)
If using screw (F₈) use Adapter (E₃)
If using screw (F₁₁) No Adapter required

5 Assemble Positioning Template

The horizontal part of the positioning template is used to mark out where you need to drill the mounting holes on your wall. The vertical part is just a guide to allow you to see how high up the wall your TV will be to help you find the perfect position for viewing your screen. Thread template (P₂) through template (P₁) as shown.

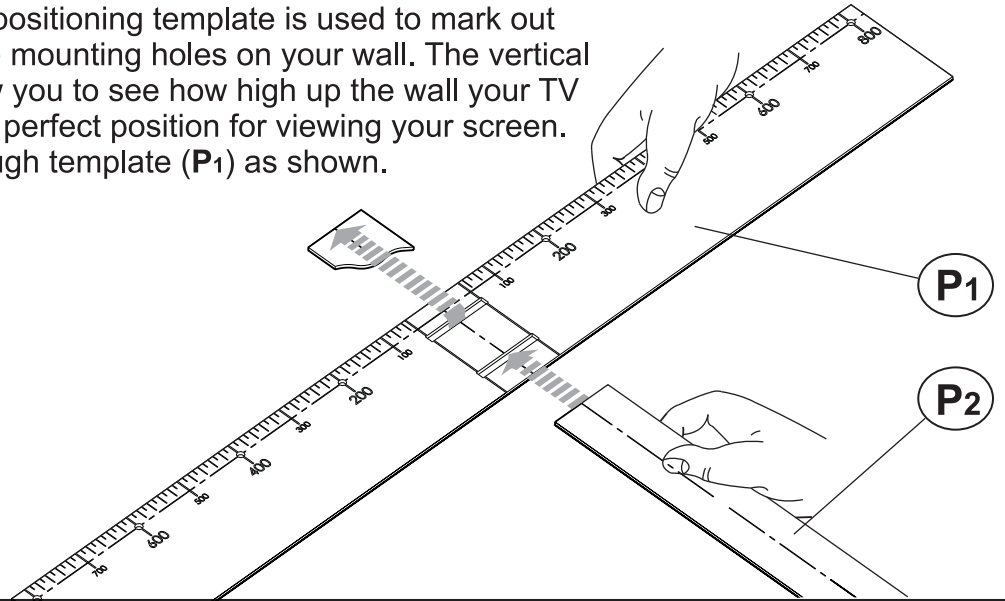

6 Determine Bracket Hole Centres

Lay the template on the back of the TV and follow the instructions below.

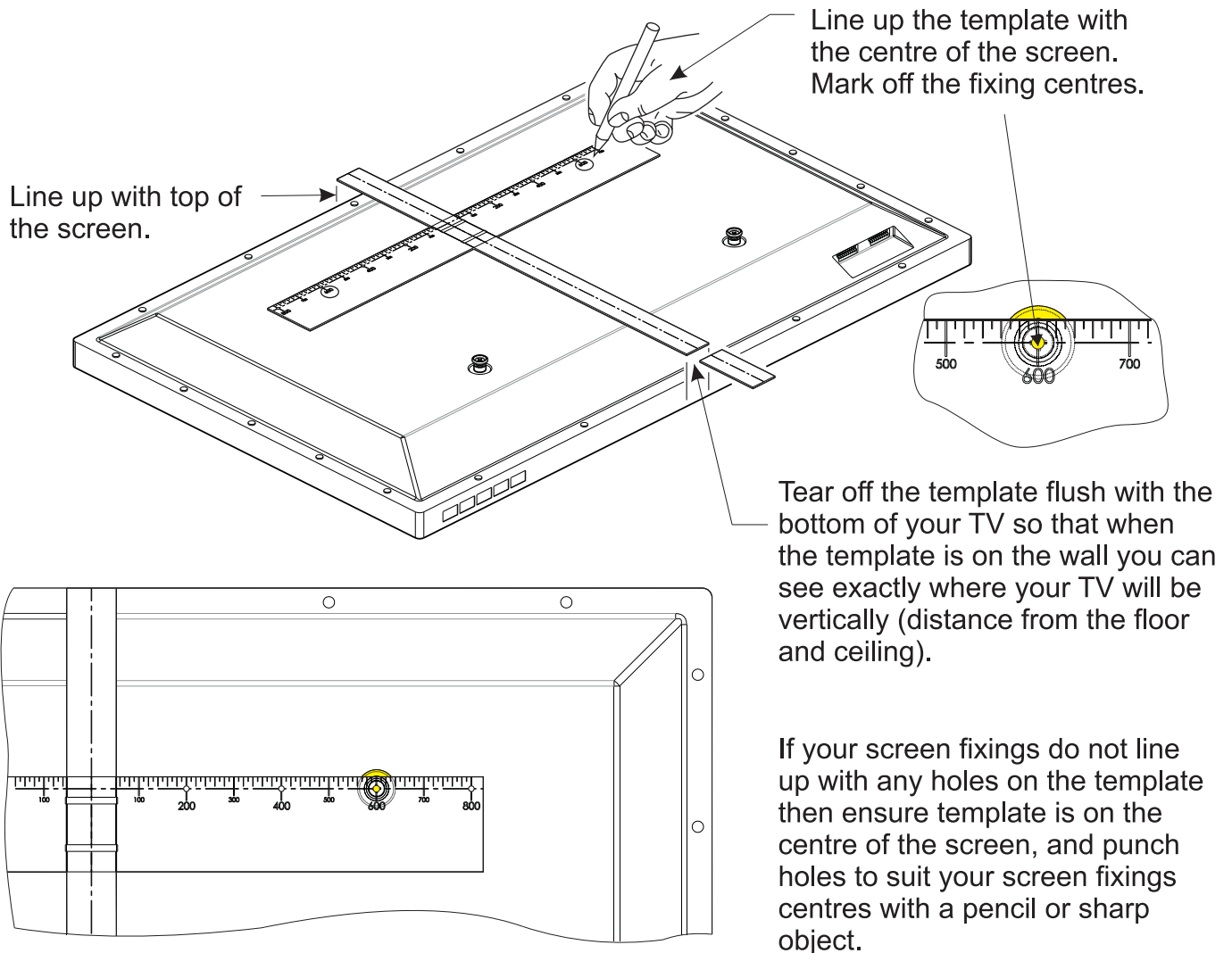

7 Marking Wall For Drill Points

Use your template to mark two points on the wall that correspond with the top fixing centres of your TV.

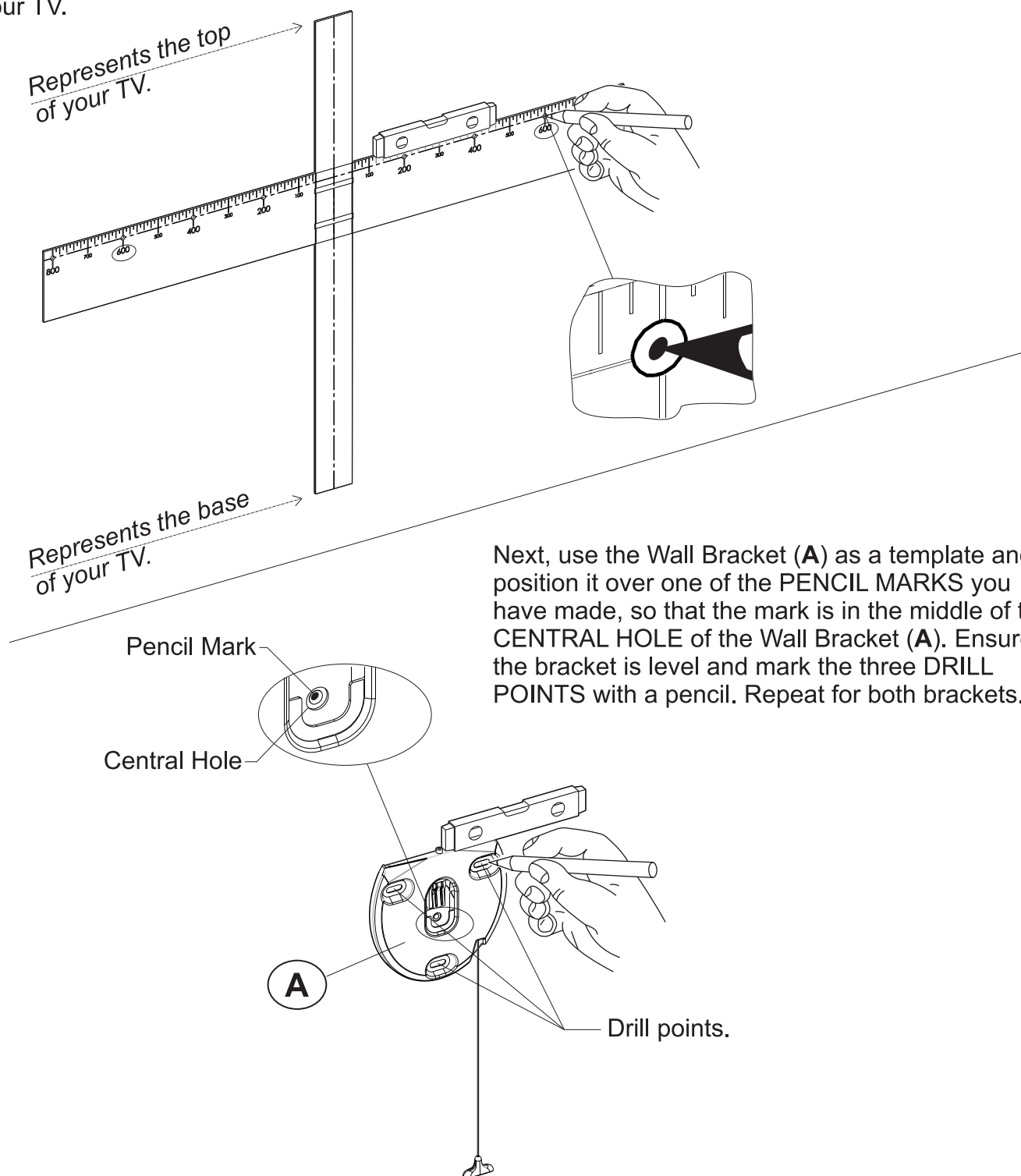

8 Planning & Preparation

Determine the wall type that you have (i.e. Brick/Stud/Plasterboard/Sheetrock).

Ensure the drilling area is free from mains services (Gas/Electric/Water).

Drill six 3mm diameter pilot holes to verify the wall type and select the appropriate fixings (See Section 9).

9 Install Wall Fixings

Use the correct fixings for your wall type. Mixing fixing types may be required for installations that span different wall types. **DO NOT OVER TIGHTEN SCREWS.**



Solid Wall

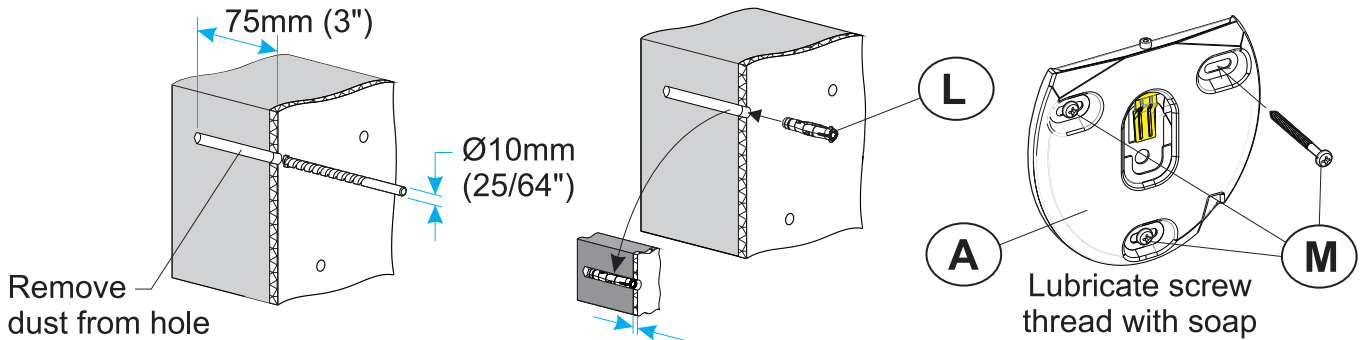

Dot & Dab

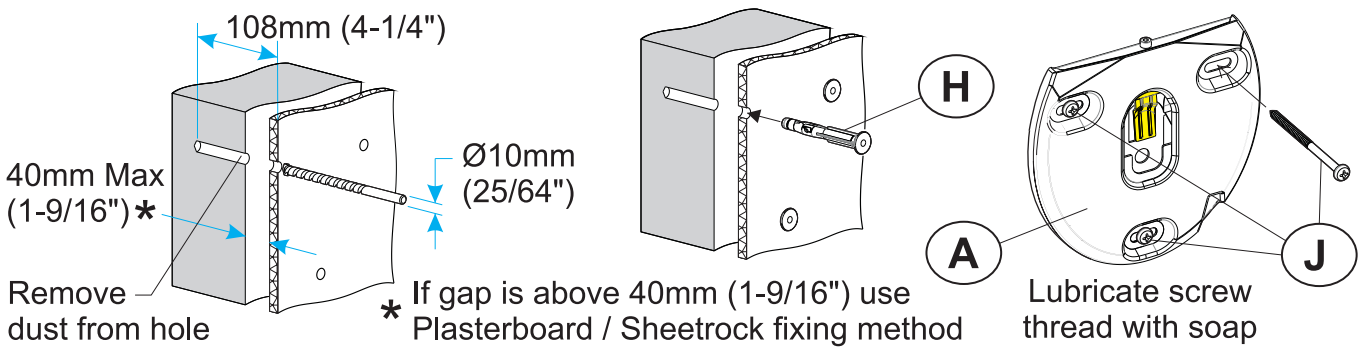

Plasterboard / Sheetrock

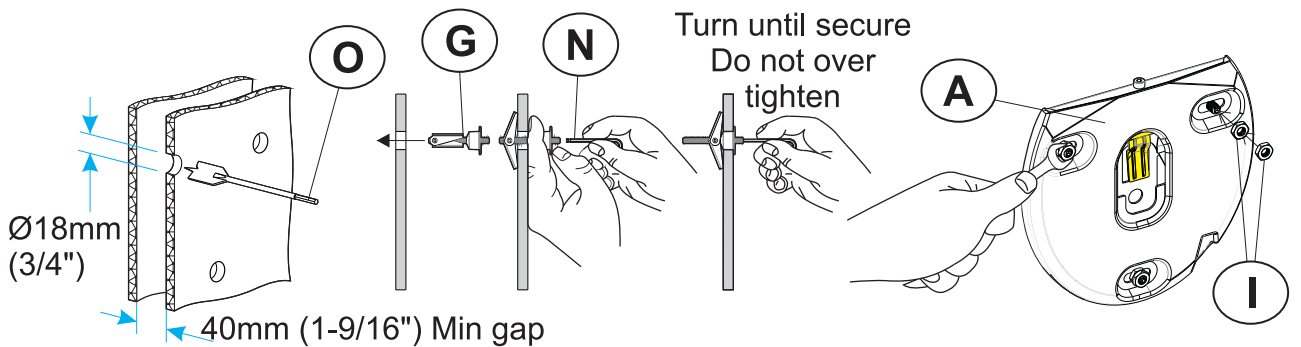

Wood Stud

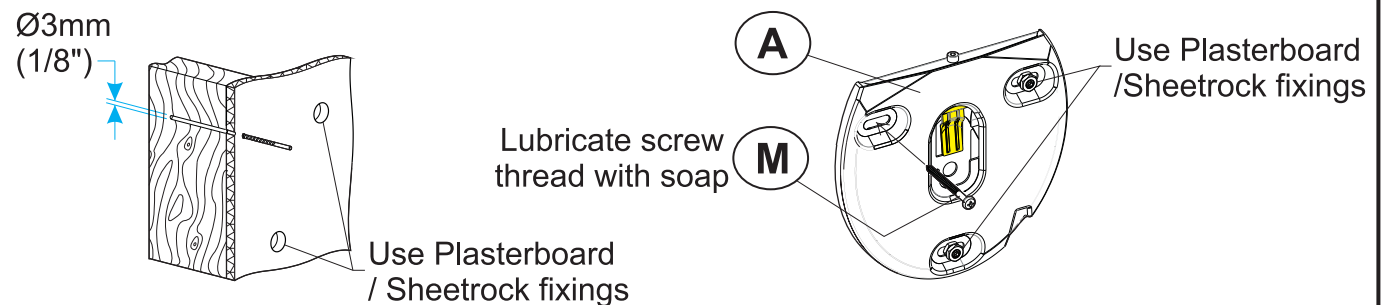

Metal Stud

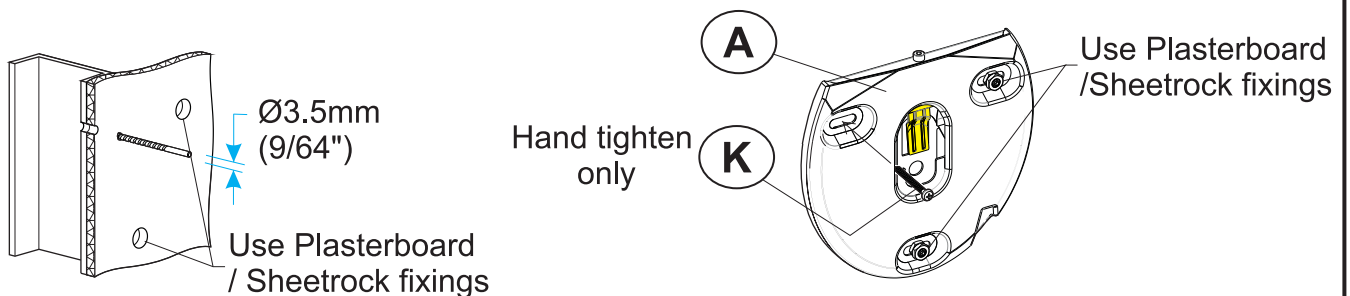

10 Hanging The TV

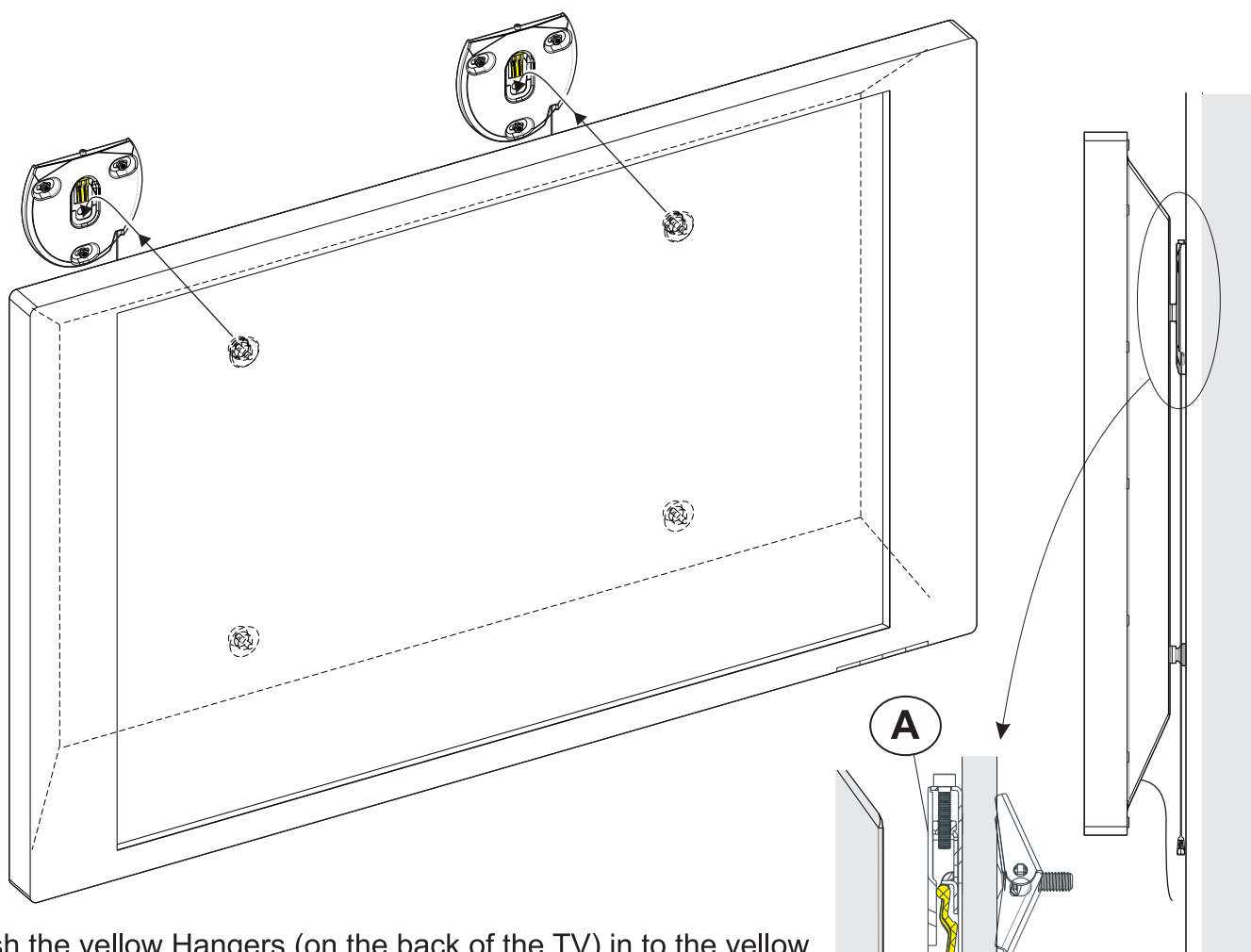

Push the yellow Hangers (on the back of the TV) in to the yellow receptor on the Wall Brackets. Slide down into place. Ensure both yellow Hangers are fully engaged. If cables from the TV prevent the TV resting against the wall then an alternative fixing configuration will be required (See Section 11).

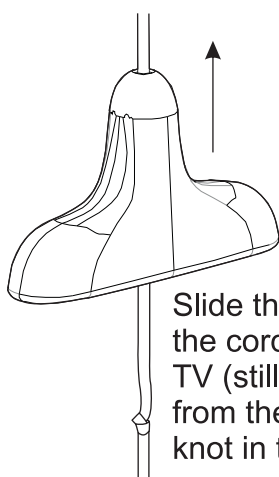

Slide the pull cord handles up the cord so they are behind the TV (still accessible but not visible from the front of the TV). Tie a knot in the cord and cut off the excess.

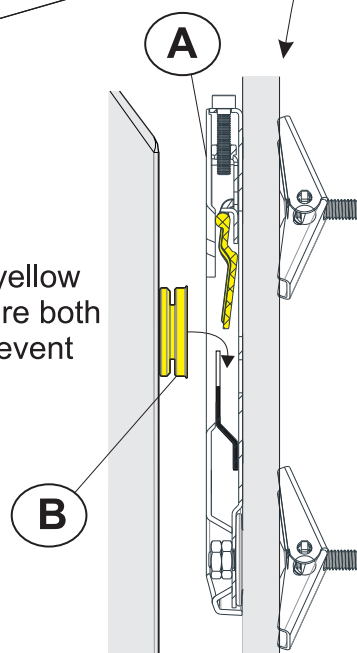

Use the 3mm hex key (N) to fine adjust the level of the TV once fitted to the wall.

Removing the TV:-

This is a two person job. To remove the TV, one person should pull both Pull Cords while another lifts the TV.

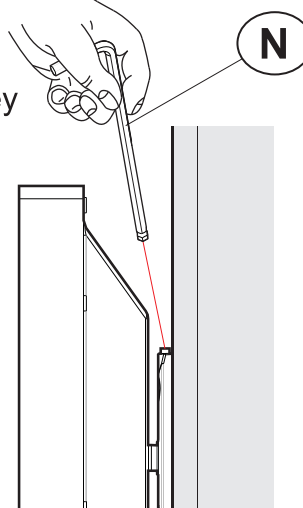

11 Alternative Hanger Configurations

Alternative wall spacing's of 12mm, 20mm & 40mm can be achieved using the spacer / screw combinations listed in this section.

Top Fixings

12mm
Wall Space

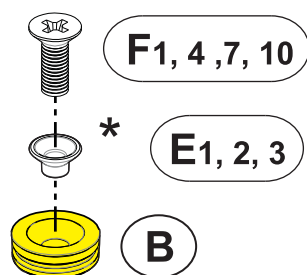

20mm
Wall Space
(as shown in section 4)

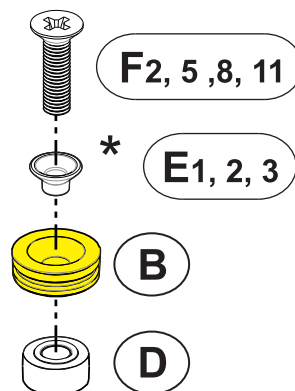

40mm
Wall Space

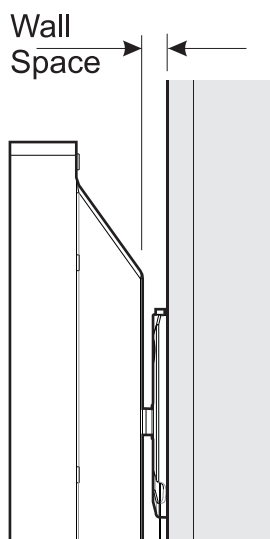
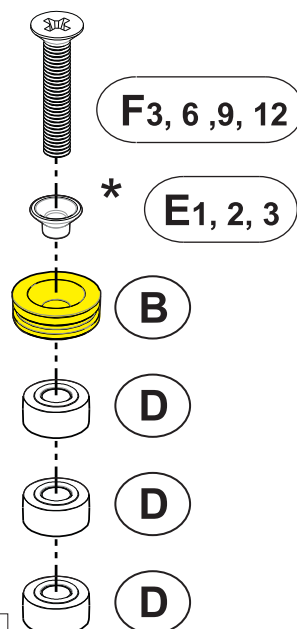

* If using screw (F₁),(F₂) or (F₃) use Adapter (E₁)
If using screw (F₄),(F₅) or (F₆) use Adapter (E₂)
If using screw (F₇),(F₈) or (F₉) use Adapter (E₃)
If using screw (F₁₀),(F₁₁) or (F₁₂) No Adapter required

Top Fixings

Bottom Fixings

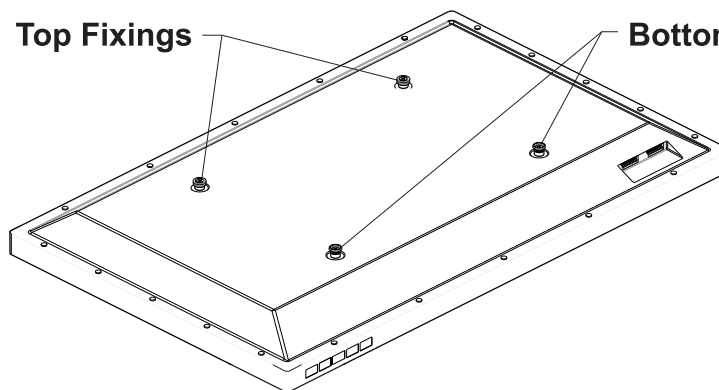

Bottom Fixings

